

NEW MEXICO OIL CONSERVATION COMMISSION
WELL LOCATION AND ACREAGE DEDICATION PLAT

FORM C-128
Revised 5/1/57

SEE INSTRUCTIONS FOR COMPLETING THIS FORM ON THE REVERSE SIDE

SECTION A

Operator CONTINENTAL OIL COMPANY		Lease GOEDEKE		Well No. 4
Unit Letter N	Section 10	Township 26 SOUTH	Range 33 EAST	County LEA
Actual Footage Location of Well: 660 feet from the SOUTH line and 1980 feet from the WEST line				
Ground Level Elev.	Producing Formation Balsam	Pool Salado Draw	Dedicated Acreage: 40 Acres	

1. Is the Operator the only owner in the dedicated acreage outlined on the plat below? YES ☒ NO ____ ("Owner" means the person who has the right to drill into and to produce from any pool and to appropriate the production either for himself or for himself and another. (65-3-29 (e) NMSA 1935 Comp.)
2. If the answer to question one is "no," have the interests of all the owners been consolidated by communitization agreement or otherwise? YES ____ NO ____ . If answer is "yes," Type of Consolidation ____
3. If the answer to question two is "no," list all the owners and their respective interests below:

Owner	Land Description

SECTION B

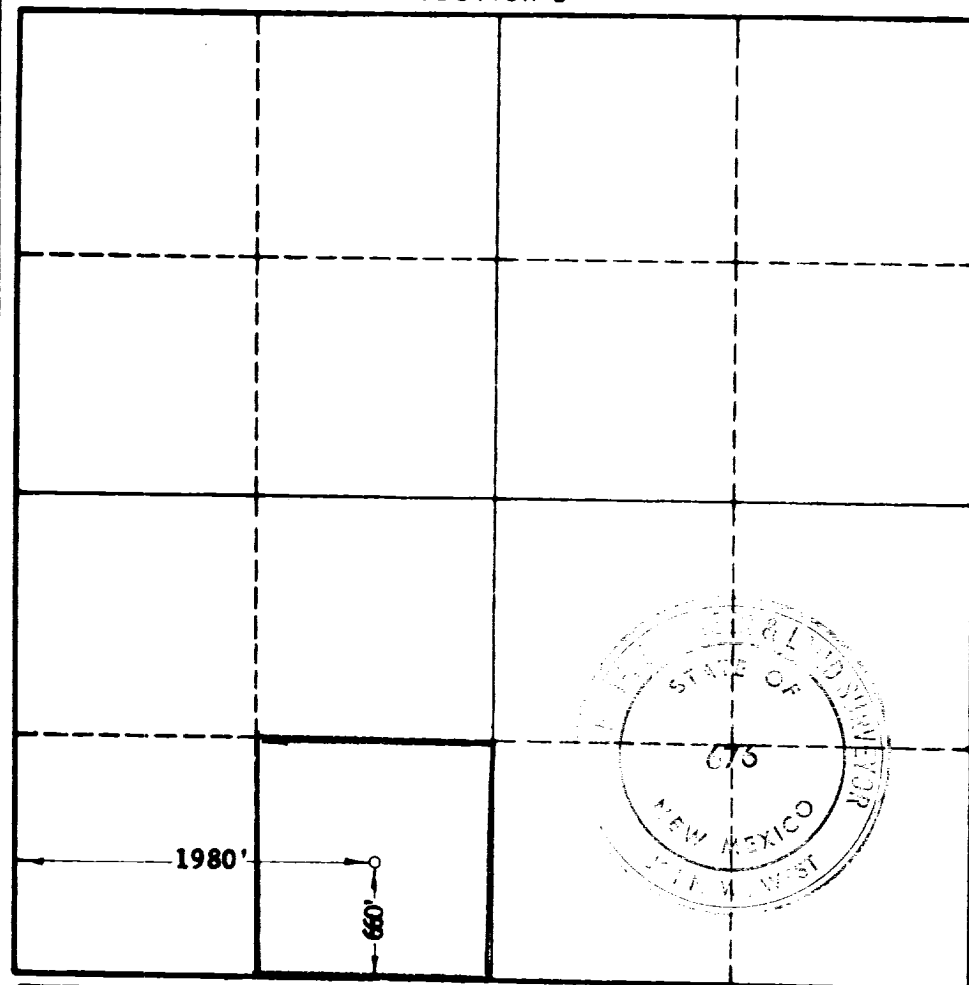

CERTIFICATION

I hereby certify that the information in SECTION A above is true and complete to the best of my knowledge and belief.

Name <i>C. M. White</i>
Position District Superintendent
Company Continental Oil Company
Date December 7, 1962

I hereby certify that the well location shown on the plat in SECTION B was plotted from field notes of actual surveys made by me or under my supervision, and that the same is true and correct to the best of my knowledge and belief.

Date Surveyed 12-5-62
Registered Professional Engineer and/or Land Surveyor, JOHN W. WEST <i>John W. West</i>
Certificate No. N. M. - P. E. & L. S. NO. 676

0 330 660 990 1320 1650 1980 2310 2640 2000 1500 1000 500

APPROVED

COPY TO O. C.

Bget Bureau No. 42-R358.4.
m Approved.Form 9-331a
(Feb. 1961)

DEC 10 1962

HOBBS

(SUBMIT IN TRIPLICATE)

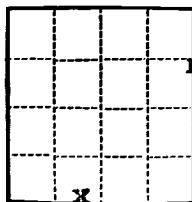
E. W. STANDLEY
DISTRICT ENGINEER

UNITED STATES

DEPARTMENT OF THE INTERIOR
GEOLOGICAL SURVEY

Land Office Las Cruces, N.M.

Lease No. 0127A

Unit RECEIVED

DEC 10 1962

1962 DEC 11 AM 10 02

SUNDRY NOTICES AND REPORTS ON WELLS

U.S. GEOLOGICAL SURVEY
HOBBS, NEW MEXICO

NOTICE OF INTENTION TO DRILL.....	X	SUBSEQUENT REPORT OF WATER SHUT-OFF.....	
NOTICE OF INTENTION TO CHANGE PLANS.....		SUBSEQUENT REPORT OF SHOOTING OR ACIDIZING.....	
NOTICE OF INTENTION TO TEST WATER SHUT-OFF.....		SUBSEQUENT REPORT OF ALTERING CASING.....	
NOTICE OF INTENTION TO RE-DRILL OR REPAIR WELL.....		SUBSEQUENT REPORT OF RE-DRILLING OR REPAIR.....	
NOTICE OF INTENTION TO SHOOT OR ACIDIZE.....		SUBSEQUENT REPORT OF ABANDONMENT.....	
NOTICE OF INTENTION TO PULL OR ALTER CASING.....		SUPPLEMENTARY WELL HISTORY.....	
NOTICE OF INTENTION TO ABANDON WELL.....			

(INDICATE ABOVE BY CHECK MARK NATURE OF REPORT, NOTICE, OR OTHER DATA)

December 7, 1962

Goodeke

Well No. 4 is located 660 ft. from [N] line and 1980 ft. from [E] line of sec. 10

SE/4 of SW/4 Sec. 10 26S 35E N7W
(1/4 Sec. and Sec. No.) (Twp.) (Range) (Meridian)Salado Draw Lea New Mexico
(Field) (County or Subdivision) (State or Territory)

The elevation of the derrick floor above sea level is _____ ft.

DETAILS OF WORK

(State names of and expected depths to objective sands; show sizes, weights, and lengths of proposed casings; indicate mudding jobs, cementing points, and all other important proposed work)

It is our intention to drill a well at the above location to an approximate depth of 5200', to attempt a completion in the Delaware horizon. All casing points will be cemented in accordance with approved methods of the USGS and any special requirements will be complied with.

It is planned to use following casing pattern: 11" hole, 7-5/8" casing to be set at 350' and cemented with 250 sacks cement. Cement is to circulate. 6-3/4" hole, 4-1/2" casing to be set at 5200' and cemented w/200 sacks cement. Cement is to return to 3900'.

Permission is requested to produce the well upon completion.

I understand that this plan of work must receive approval in writing by the Geological Survey before operations may be commenced.

Company Continental Oil Company

Address Box 427

Hobbs, New Mexico

By E. W. Standley

Title District Superintendent

USGS (5) NM003 (2) WAM FILE

GPO 914974