

	X	

(SUBMIT IN TRIPLICATE)

UNITED STATES
DEPARTMENT OF THE INTERIOR
GEOLOGICAL SURVEY

Land Office Las Cruces
Lease No. 030139 b
Unit C

SUNDRY NOTICES AND REPORTS ON WELLS

NOTICE OF INTENTION TO DRILL.....	<input checked="" type="checkbox"/>	SUBSEQUENT REPORT OF WATER SHUT-OFF.....
NOTICE OF INTENTION TO CHANGE PLANS.....		SUBSEQUENT REPORT OF SHOOTING OR ACIDIZING.....
NOTICE OF INTENTION TO TEST WATER SHUT-OFF.....		SUBSEQUENT REPORT OF ALTERING CASING.....
NOTICE OF INTENTION TO RE-DRILL OR REPAIR WELL.....		SUBSEQUENT REPORT OF RE-DRILLING OR REPAIR.....
NOTICE OF INTENTION TO SHOOT OR ACIDIZE.....		SUBSEQUENT REPORT OF ABANDONMENT.....
NOTICE OF INTENTION TO PULL OR ALTER CASING.....		SUPPLEMENTARY WELL HISTORY.....
NOTICE OF INTENTION TO ABANDON WELL.....		

(INDICATE ABOVE BY CHECK MARK NATURE OF REPORT, NOTICE, OR OTHER DATA)

Lynn B-26

April 9, 1963

Well No. 5 is located 660 ft. from N line and 1980 ft. from W line of sec. 26

NE/4 NW/4 Sec. 26 23-S 36-E NMPM
(1/4 Sec. and Sec. No.) (Twp.) (Range) (Meridian)

Langlie Mattix Lea New Mexico
(Field) (County or Subdivision) (State or Territory)

The elevation of the derrick floor above sea level is _____ ft.

DETAILS OF WORK

(State names of and expected depths to objective sands; show sizes, weights, and lengths of proposed casings; indicate mudding jobs, cementing points, and all other important proposed work)

It is intended to drill a well with rotary tools at the above location to an approximate total depth of 3700' in the Queen formation. Casing will be set in accordance with USGS regulations and other special requirements will be complied with.

The following casing pattern is planned: 7-5/8" OD 24# H-40 set at 300' with 150 sacks cement, cement to circulate, 4-1/2" OD 9.5# J-55 set at 3700' with 250 sacks cement; cement to return to 2600'.

Permission to produce this well upon completion is also requested.

I understand that this plan of work must receive approval in writing by the Geological Survey before operations may be commenced.

Company Continental Oil Company

Address Box 68

Sunice, New Mexico

By _____

USGS-5 N/5 plats; NMOCC W/2 plats; WAM Title District Superintendent
HER W/plat File Pan An-Hbs-3;
Atl-Ross-2 Calif.-Houst, Mid - 1 each

NEW MEXICO OIL CONSERVATION COMMISSION
WELL LOCATION AND ACREAGE DEDICATION PLAT

FORM C-128
 Revised 8/1/57

SEE INSTRUCTIONS FOR COMPLETING THIS FORM ON THE REVERSE SIDE

SECTION A

Operator CONTINENTAL OIL COMPANY		Lease LYNN B-26		APR 9 1963 5
Unit Letter C	Section 26	Township 23 SOUTH	Range 36 EAST	County LEA
Actual Footage Location of Well: 660 feet from the NORTH line and 1980 feet from the WEST line				
Ground Level Elev.	Producing Formation Queen	Pool Langlie-Mattix		Dedicated Acreage: 40 Acres

1. Is the Operator the only owner in the dedicated acreage outlined on the plat below? YES _____ NO _____. ("Owner" means the person who has the right to drill into and to produce from any pool and to appropriate the production either for himself or for himself and another. (65-3-29 (e) NMSA 1935 Comp.)
2. If the answer to question one is "no," have the interests of all the owners been consolidated by communization agreement or otherwise? YES _____ NO _____. If answer is "yes," Type of Consolidation _____
3. If the answer to question two is "no," list all the owners and their respective interests below:

Owner	Land Description

SECTION B

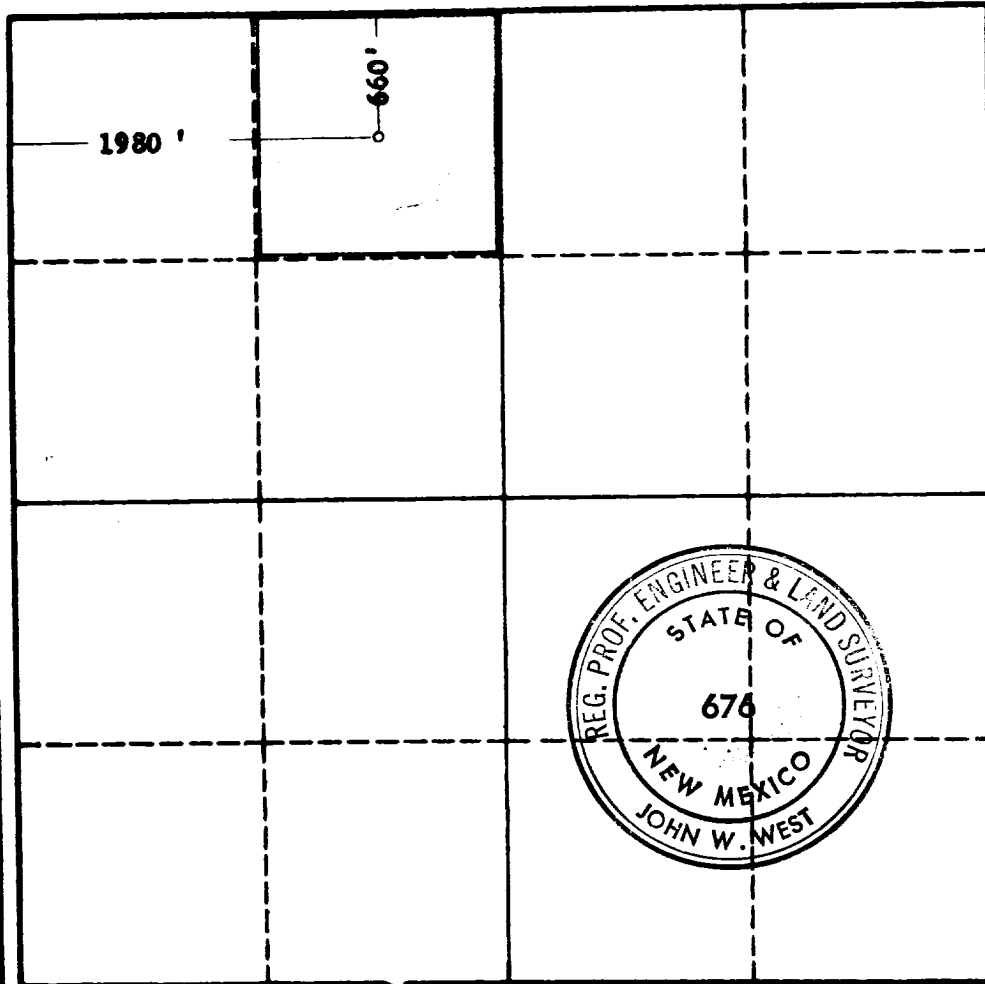

CERTIFICATION

I hereby certify that the information in SECTION A above is true and complete to the best of my knowledge and belief.

Name	SIGNED: J. R. PARKER
Position	District Superintendent
Company	Continental Oil Company
Date	4-8-63

I hereby certify that the well location shown on the plat in SECTION B was plotted from field notes of actual surveys made by me or under my supervision, and that the same is true and correct to the best of my knowledge and belief.

Date Surveyed	4-8-63
Registered Professional Engineer and/or Land Surveyor,	JOHN W. WEST
Certificate No.	N. M. - P. E. & L. S. NO. 676

0 330 660 990 1320 1650 1980 2310 2640 2000 1500 1000 500 0