

COPY

NEW MEXICO OIL CONSERVATION COMMISSION WELL LOCATION AND ACREAGE DEDICATION PLAT

 FORM C-128
Revised 3/1/57

SEE INSTRUCTIONS FOR COMPLETING THIS FORM ON THE REVERSE SIDE

Operator AZTEC OIL & GAS CO.				Lease STATE "SR"		Well No. 1
Unit Letter G	Section 16	Township 24 SOUTH	Range 36 EAST	County LEA		
Actual Footage Location of Well: 1980 feet from the NORTH line and 1980 feet from the EAST line						
Ground Level Elev. 3382	Producing Formation Seven Rivers		Pool Undesignated		Dedicated Acreage: 40 Acres	

1. Is the Operator the only owner in the dedicated acreage outlined on the plat below? YES ☒ NO ☐ ("Owner" means the person who has the right to drill into and to produce from any pool and to appropriate the production either for himself or for himself and another. (65-3-29 (e) NMSA 1935 Comp.)
2. If the answer to question one is "no," have the interests of all the owners been consolidated by communitization agreement or otherwise? YES ☐ NO ☐ If answer is "yes," Type of Consolidation _____
3. If the answer to question two is "no," list all the owners and their respective interests below:

Owner	Land Description

SECTION B

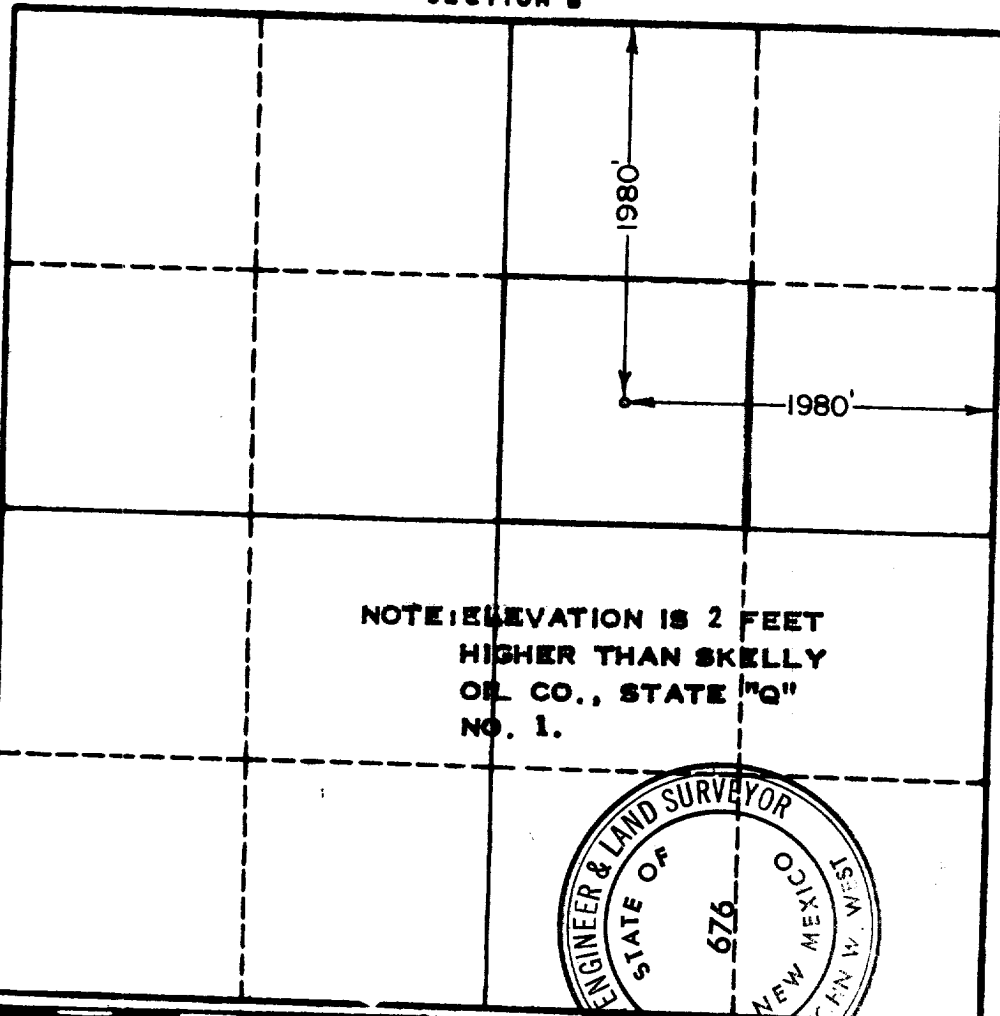

NOTE: ELEVATION IS 2 FEET
HIGHER THAN SKELLY
OIL CO., STATE "Q"
NO. 1.

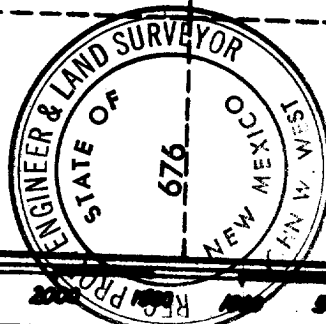

CERTIFICATION

I hereby certify that the information in SECTION A above is true and complete to the best of my knowledge and belief.

Name original signed by:
LESTER L DUKE
Position
District Superintendent
Company
Aztec Oil & Gas Company
Date
October 9, 1964

I hereby certify that the well location shown on the plat in SECTION B was plotted from field notes of actual surveys made by me or under my supervision, and that the same is true and correct to the best of my knowledge and belief.

Date Surveyed
10-8-64
Registered Professional Engineer and/or Land Surveyor, **JOHN W WEST**
John W West
Certificate No.
N.M. - P.E. & L.S. NO. 676

COPY