

LEA		FIELD Antelope Ridge		STATE NM	
SHELL OIL CO.				API MN 21037	
4 LEASE Antelope Ridge Unit				SERIAL OWDD	
Sec 4, T-24-S, R-34-E				MAP	
990' FNL, 2310' FEL of Sec				CO-ORD	
		CLASS DG		ELEV	
				L & S	
Re-10-5-72 Re-1-24-73		FORMATION		DATUM	
11 3/4" at 815' w/310 sx					
8 5/8" at 5167' w/400 sx					
5 1/2" at 12,005' w/50 sx					
4" lnr 11,923-12,375'					
3 1/2" lnr 11,296-13,317' w/150 sx					
		TD 13,320' (MRRW)		PBD 13,231'	

(Morrow) Perfs 12,759-13,208' SHUT IN GAS WELL

OPRS ELEV 3362' GL PD 13,320' TYPE RT

F.R. 10-9-72
(Morrow)
(Orig. comp 2-1-65 thru (Atoka) Perfs 12,212-341', OTD 12,375')
10-16-72 TD 12,375'; CO to 11,970'; Milling
10-20-72 TD 12,375'; CO to 12,018'; Fshg drill collars
10-30-72 TD 12,375'; Drlg by @ 11,659'
PE to 11,375'; Whipstock @ 11,664'
11-6-72 TD 12,375'; Drlg by @ 11,951' lm & sh
11-13-72 Drlg 12,381'
11-27-72 TD 12,707'; Fshg stuck DP
12-4-72 TD 12,797'; Cond mud
12-11-72 TD 12,846'; Pulling DP
12-18-72 Drlg 12,891'
Gas kick @ 12,875'
1-2-73 Drlg 13,215' sh, lm & sd

LEA
SHELL OIL CO.

Antelope Ridge
4 Antelope Ridge Unit
Sec 4, T-24-S, R-34-E

NM
Page #2

1-8-73 TD 13,320'; Circ
Deepened 12,375' to 13,320'
1-15-73 TD 13,320'; WOC
Ran 3½" Inr
1-22-73 TD 13,320'; SI
1-29-73 TD 13,320'; PBD 13,231'; Tstg
Perf @ 12,759', 12,762', 12,763', 12,780',
12,787', 12,789', 12,790', 12,792', 12,958',
12,961', 12,964', 12,967', 12,970', 12,972',
12,975', 12,977', 13,023', 13,025', 13,182',
13,206', 13,208' w/1 SPI
Acid (12,759-13,208') 2000 gals
Flwd 793 MCFGPD + 11 BO in 24 hrs, TP 600#
2-5-73 TD 13,320'; PBD 13,231'; SI

3-19-73 TD 13,320'; PBD 13,231'; SI
3-26-73 TD 13,320'; PBD 13,231'; SI
Flwd 627 MCFGPD + 14 B cond in 24 hrs thru 1"
chk; Grav (cond) 55.1; TP 600# (12,759-13,208')
4-23-73 TD 13,320'; PBD 13,231'; SI
Frac (12,759-13,208') 15,000 gals + 15,000# sd
Flwd @ 525 MCFGPD + 5 BO + 65 BLW in 21 hrs
thru 1/2" chk, TP 200#
4-30-73 TD 13,320'; PBD 13,231'; Tstg
Flwd @ 500 MCFGPD thru 1" chk in 24 hrs, TP
680#
7-2-73 TD 13,320'; PBD 13,231'; Tstg
7-13-73 TD 13,320'; PBD 13,231'; SI
9-18-73 TD 13,320'; PBD 13,231'; SI
9-28-73 TD 13,320'; PBD 13,231'; SI
10-4-73 TD 13,320'; PBD 13,231'; SI
10-24-73 TD 13,320'; PBD 13,231'; SI
9-9-74 TD 13,320'; PBD 13,231'; COMPLETE

Antelope Ridge
4 Antelope Ridge Unit
Sec 4, T24S, R34E

NM
Page #3

1-11-74

1-11-74

1-11-74

Continued

Flow 6/2 MCFGPD + 14 B Cond in 24 hrs, 1"
chk, TP 600# (12,759-13,208')
COMPLETION REPORTED

COUNTY	LEA	FIELD	Antelope Ridge	STATE	N.M.
OPR	SHELL OIL COMPANY				MAP
4-2 Antelope Ridge Unit					
Sec. 4, T-24-S, R-34-E				CO-ORD	
990' fr N Line & 2310' fr E Line of Sec.					
Spud 12-8-64		CLASS			
Comp. 2-1-65		EL 3562' 6			
		FORMATION	DATUM	FORMATION	DATUM
CSG & SX - TUBING	LOG:	DelSd 5158			
11 3/4" 815'	310	ESprg 8718			
8 5/8" 5167'	400	W.C. 11522			
5 1/2" 12005'	50	Penn 11903			
4" 11913-12075'		Sec 11989			
		Alaska 12135			
LOGS	EL GR RA IND HC A				
		12 123.5'			

IP Alaska Perfl. 12211-2411', GAOE 28' 2-0 M.5GPD, Pot. Based on 4-Point Test, 01 BHE 58997.

Distribution limited and publication prohibited by subscribers' agreement.
Reproduction rights reserved by Williams & Lee Scouting Service, Inc.

CONT. PROP DEPTH 12,400' TYPE
DATE

P. R. 12-17-64: Oper's R/w. 3562' DF.
 12-14-64: Drilg. 2940' anby.
 12-21-64: Drilg. 7300'.
 1-4-65: Drilg. 11,140' 1st. & 2d.
 1-11-65: GB 10,005', WCC.
 1-18-65: Drilg. 12,161'.
 1-25-65: IP 12,175', fike, pkr.
 2-1-65: 10 11,575', NO Rotary.
 4' 1/2" cas. drilled 12,175'.
 815' 1000' WCP/2 1/2" ann. for 1076' chkl.
 EOP 1600'.
 2-8-65: 10 11,275', COMPLETED

- cont'd -

LEA Antelope Ridge N.M. Sec. 4-24S-34E
SHEP COMPANY #4-2 Antelope Ridge Unit
Page #2

2-9-65

cont'd -
4 Point Test

MCF	Chk.	Cond.	Time	TP
4750	10/64"	8.77	2 hrs.	4155 $\frac{1}{2}$
5750	13/64"	11.7	2 hrs.	4090 $\frac{1}{2}$
7000	16/64"	15.0	2 hrs.	3974 $\frac{1}{2}$
10000	19/64"	22.5	2 hrs.	3717 $\frac{1}{2}$

**NEW MEXICO OIL CONSERVATION COMMISSION
WELL LOCATION AND ACREAGE DEDICATION PLAT**

Form C-102
Supersedes C-
Effective 1-1-6

All distances must be from the outer boundaries of the Section.

Operator Shell Oil Company			Lease Antelope Ridge Unit		Well No. 4
Unit Letter B	Section 4	Township 24S	Range 34E	County Lea	
Actual Footage Location of Well: <div style="display: flex; justify-content: space-between;"> 990 feet from the North line and 2310 feet from the East line </div>					
Ground Level Elev. 3562 DF	Producing Formation Antelope Ridge		Pool Morrow		Dedicated Acreage: 320 Acres

- Outline the acreage dedicated to the subject well by colored pencil or hachure marks on the plat below.
- If more than one lease is dedicated to the well, outline each and identify the ownership thereof (both as to working interest and royalty).
- If more than one lease of different ownership is dedicated to the well, have the interests of all owners been consolidated by communitization, unitization, force-pooling, etc?

☒ Yes ☐ No If answer is "yes," type of consolidation Unit Operating Agreement

If answer is "no," list the owners and tract descriptions which have actually been consolidated. (Use reverse side of this form if necessary.) _____

No allowable will be assigned to the well until all interests have been consolidated (by communitization, unitization, forced-pooling, or otherwise) or until a non-standard unit, eliminating such interests, has been approved by the Commission.

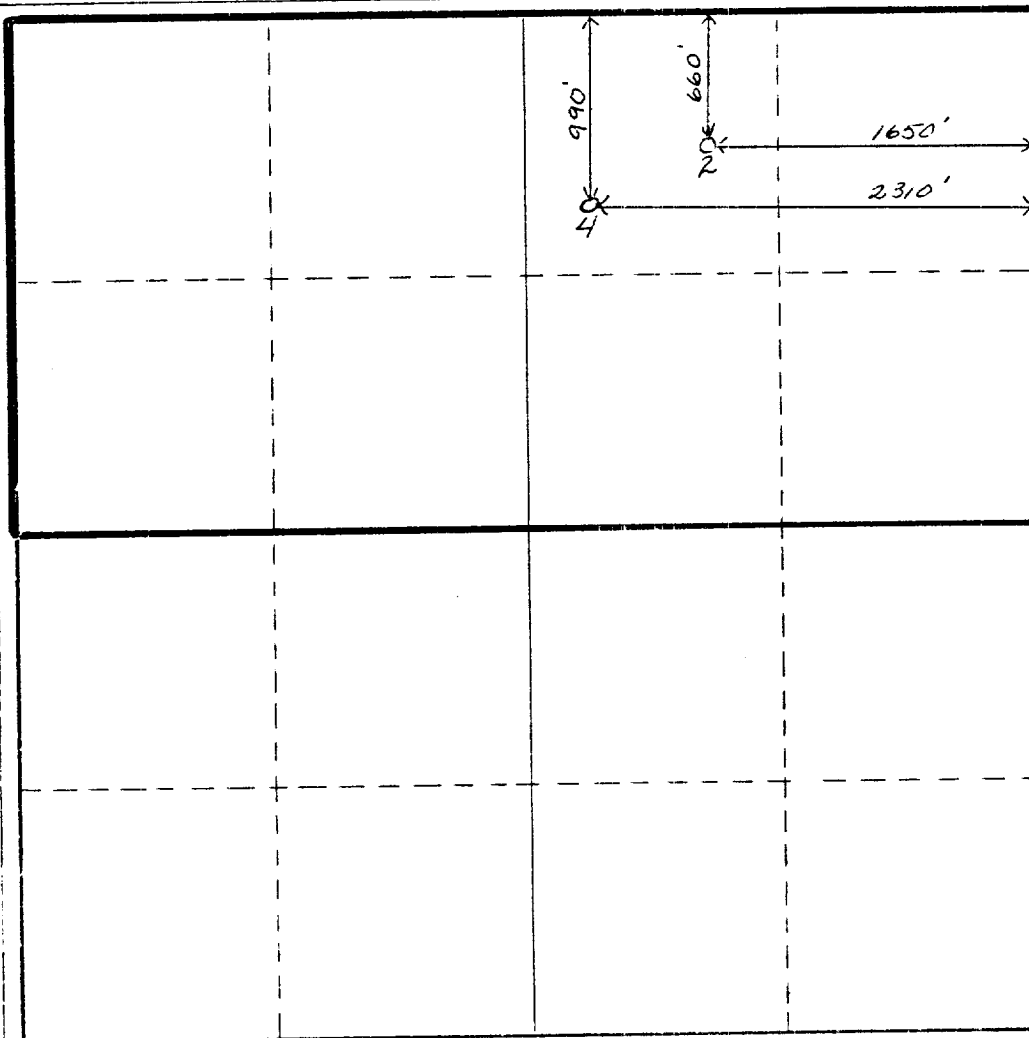

CERTIFICATION

I hereby certify that the information contained herein is true and complete to best of my knowledge and belief.

Name *James E. Sullivan*
A. E. Cordray

Position
Staff Engineer

Company
Shell Oil Company

Date
3-28-73

I hereby certify that the v shown on this plat was plott notes of actual surveys m under my supervision, and is true and correct to th knowledge and belief.

Date Surveyed _____

Registered Professional and/or Land Surveyor

Certificate No. _____

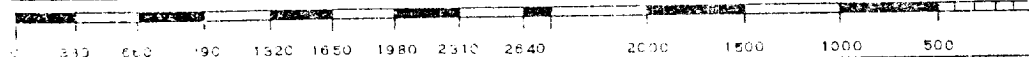

NEW MEXICO OIL CONSERVATION COMMISSION
WELL LOCATION AND ACREAGE DEDICATION PLAT

Form C 102
Supersedes C-128
Effective 1-1-65

HOBBS OFFICE D.C.C.

All distances must be from the outer boundaries of the Section.

Operator Shell Oil Company (Western Division)			Lease Antelope Ridge Unit		Well No. 4
Unit Letter B	Section 4	Township 24S	Range 34E	County Lea	
Actual Footage Location of Well: 990 feet from the north line and 2310 feet from the east line					
Ground Level Elev. Not Available	Producing Formation Atoka		Pool Antelope Ridge-Atoka Gas Pool		Dedicated Acreage: 320 Acres

1. Outline the acreage dedicated to the subject well by colored pencil or hachure marks on the plat below.
2. If more than one lease is dedicated to the well, outline each and identify the ownership thereof (both as to working interest and royalty).
3. If more than one lease of different ownership is dedicated to the well, have the interests of all owners been consolidated by communitization, unitization, force-pooling, etc?

☒ Yes ☐ No If answer is "yes," type of consolidation **Unitization**

If answer is "no," list the owners and tract descriptions which have actually been consolidated. (Use reverse side of this form if necessary.)

No allowable will be assigned to the well until all interests have been consolidated (by communitization, unitization, forced-pooling, or otherwise) or until a non-standard unit, eliminating such interests, has been approved by the Commission.

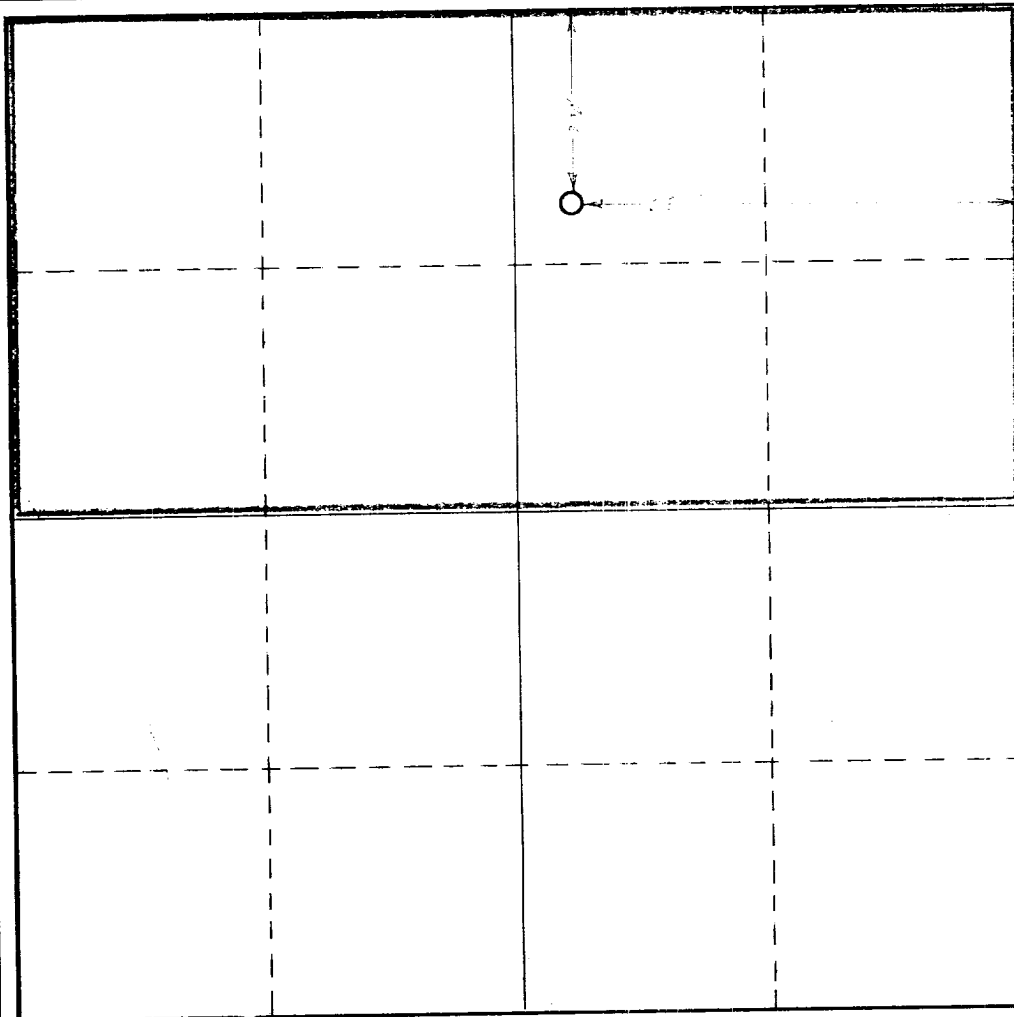

CERTIFICATION

I hereby certify that the information contained herein is true and complete to the best of my knowledge and belief.

Original Signed By
J. D. DUREN J. D. Duren
Name

Staff Exploitation Engineer
Position

Shell Oil Company
Company

March 28, 1966
Date

I hereby certify that the well location shown on this plat was plotted from field notes of actual surveys made by me or under my supervision, and that the same is true and correct to the best of my knowledge and belief.

Date Surveyed

Registered Professional Engineer
and/or Land Surveyor

Certificate No.

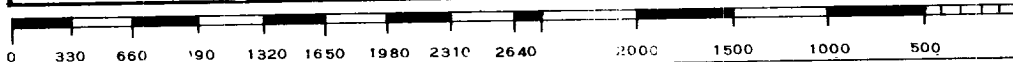

**NEW MEXICO OIL CONSERVATION COMMISSION
WELL LOCATION AND ACREAGE DEDICATION PLAT**

Form C-162
Supersedes C-128
Effective 1-1-65

All distances must be from the outer boundaries of the Section.

14-08-0001-8492

Operator Shell Oil Company			Lease Antelope Ridge Unit		Well No. 4-2
Unit Letter B	Section 4	Township 24S	Range 34E	County Lea	
Actual Footage Location of Well: 990 feet from the north line and 2310 feet from the east line					
Ground Level Elev. 3550'	Producing Formation Pennsylvanian		Pool Antelope Ridge	Dedicated Acreage: 320 Acres	

1. Outline the acreage dedicated to the subject well by colored pencil or hachure marks on the plat below.
2. If more than one lease is dedicated to the well, outline each and identify the ownership thereof (both as to working interest and royalty).
3. If more than one lease of different ownership is dedicated to the well, have the interests of all owners been consolidated by communitization, unitization, force-pooling, etc?

☒ Yes ☐ No If answer is "yes," type of consolidation **Unit Operating Agreement**

If answer is "no," list the owners and tract descriptions which have actually been consolidated. (Use reverse side of this form if necessary.) _____

No allowable will be assigned to the well until all interests have been consolidated (by communitization, unitization, forced-pooling, or otherwise) or until a non-standard unit, eliminating such interests, has been approved by the Commission.

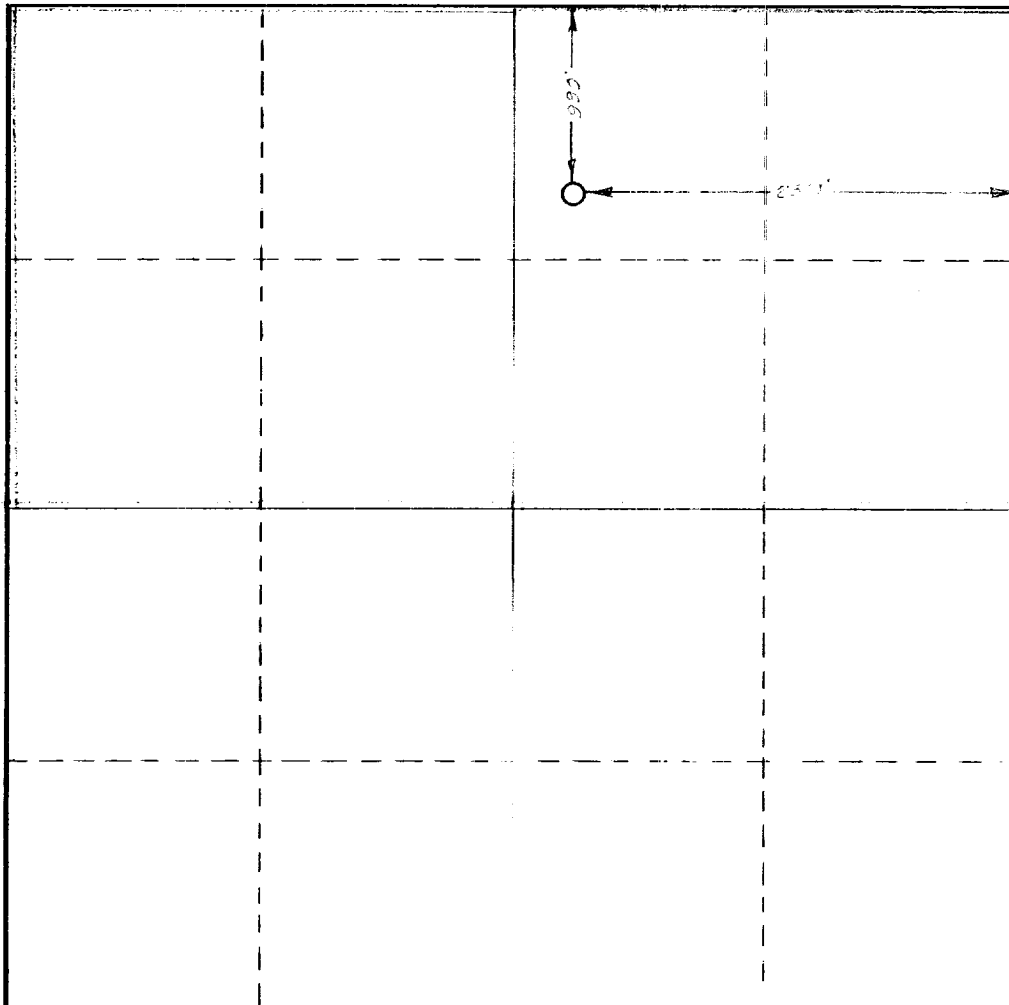

CERTIFICATION

I hereby certify that the information contained herein is true and complete to the best of my knowledge and belief.

Name
V. L. King *[Signature]*
 Position
Acting District Exploitation Engineer
 Company
Shell Oil Company
 Date
February 10, 1965

I hereby certify that the well location shown on this plat was plotted from field notes of actual surveys made by me or under my supervision, and that the same is true and correct to the best of my knowledge and belief.

Date Surveyed

 Registered Professional Engineer and/or Land Surveyor

Certificate No.

