

NO. OF COPIES RECEIVED	
DISTRIBUTION	
SANTA FE	
FILE	
U.S.G.S.	
LAND OFFICE	
OPERATOR	

NEW MEXICO OIL CONSERVATION COMMISSION

Form O-10
Revised 11-1-66

1. A. Indicate Type of Lease
STATE <input type="checkbox"/> FEE <input checked="" type="checkbox"/>
2. State Oil & Gas Lease No.

APPLICATION FOR PERMIT TO DRILL, DEEPEN, OR PLUG BACK

3. a. Type of Work		b. Type of Well		c. Name of Lessee		d. Name of Operator	
DRILL <input checked="" type="checkbox"/> DEEPEN <input type="checkbox"/> PLUG BACK <input type="checkbox"/>		WATER <input type="checkbox"/> GAS <input type="checkbox"/> OTHER <input checked="" type="checkbox"/> Water Supply		SINGLE ZONE <input checked="" type="checkbox"/> MULTIPLE ZONE <input type="checkbox"/>		Jal Water System	
4. Name of Lessee		5. Name of Operator		6. State Oil & Gas Lease No.		7. Name of Well	
SKELLY OIL COMPANY		P. O. Box 730 - Hobbs, New Mexico		3			
8. Section		9. Township		10. Range		11. County	
1327		West		4		Lea	
12. Proposed Depth		13. Formation		14. Rotary or Other			
4500'		Capitan Reef		Rotary			
15. Blanket Bond No. 1253688 for \$100,000.00 w/Fed. Ins. Co.		16. Drilling Company		17. Approx. Date Work will start			
Unknown		Leatherwood Drilling Co.		Immediately			

PROPOSED CASING AND CEMENT PROGRAM

SIZE OF HOLE	SIZE OF CASING	WEIGHT PER FOOT	SETTING DEPTH	SACKS OF CEMENT	EST. TOP
17-1/2"	13-3/8"	35.62#	350'	300	Surface
12-1/4"	9-5/8"	32.3-40#	3900'	300	2,740

The pump and plug process will be used in cementing all strings of casing and cement will be circulated to the surface on the 13-3/8"OD surface casing. The 9-5/8"OD casing will be set at 3900' and cemented with 300 sacks of cement. The open hole section 3900-4500' will be treated with 500 gallons 15% Regular Acid.

IN ABOVE SPACE DESCRIBE PROPOSED PROGRAM IF PROPOSAL IS TO DEEPEN OR PLUG BACK, OR DATA IN PRESENT PRODUCTION ZONE AND PROPOSED NEW PRODUCTION ZONE, OR PREVENTER PROGRAM, IF ANY.

I hereby certify that the information above is true and complete to the best of my knowledge and belief.

Signed V. E. Fletcher Title District Superintendent Date October 17, 1967
V. E. Fletcher
 (This space for State Use)

APPROVED BY [Signature] TITLE DATE
 CONDITIONS OF APPROVAL, IF ANY:

NEW MEXICO OIL CONSERVATION COMMISSION
WELL LOCATION AND ACREAGE DEDICATION PLAT

Form C-102
Supersedes C-128
Effective 1-1-65

All distances must be from the outer boundaries of the Section

Operator SKELLY OIL COMPANY		Lease JAL WATER SYSTEM		Well No. 3
Unit Letter M	Section 4	Township 24 SOUTH	Range 36 EAST	County LEA
Actual Footage Location of Well: 1313 feet from the SOUTH line and 1327 feet from the WEST line				
Ground Level Elev. _____	Producing Formation Capitan Reef	Perforations _____	Dedicated Acreage: _____ Acres	

1. Outline the acreage dedicated to the subject well by colored pencil or hatchure marks on the plat below.
2. If more than one lease is dedicated to the well, outline each and identify the ownership thereof (both as to working interest and royalty).
3. If more than one lease of different ownership is dedicated to the well, have the interests of all owners been consolidated by communitization, unitization, force-pooling, etc?

☐ Yes ☐ No If answer is "yes," type of consolidation _____

If answer is "no," list the owners and tract descriptions which have actually been consolidated. (Use reverse side of this form if necessary.) _____

No allowable will be assigned to the well until all interests have been consolidated (by communitization, unitization, forced-pooling, or otherwise) or until a non-standard unit, eliminating such interests, has been approved by the Commission.

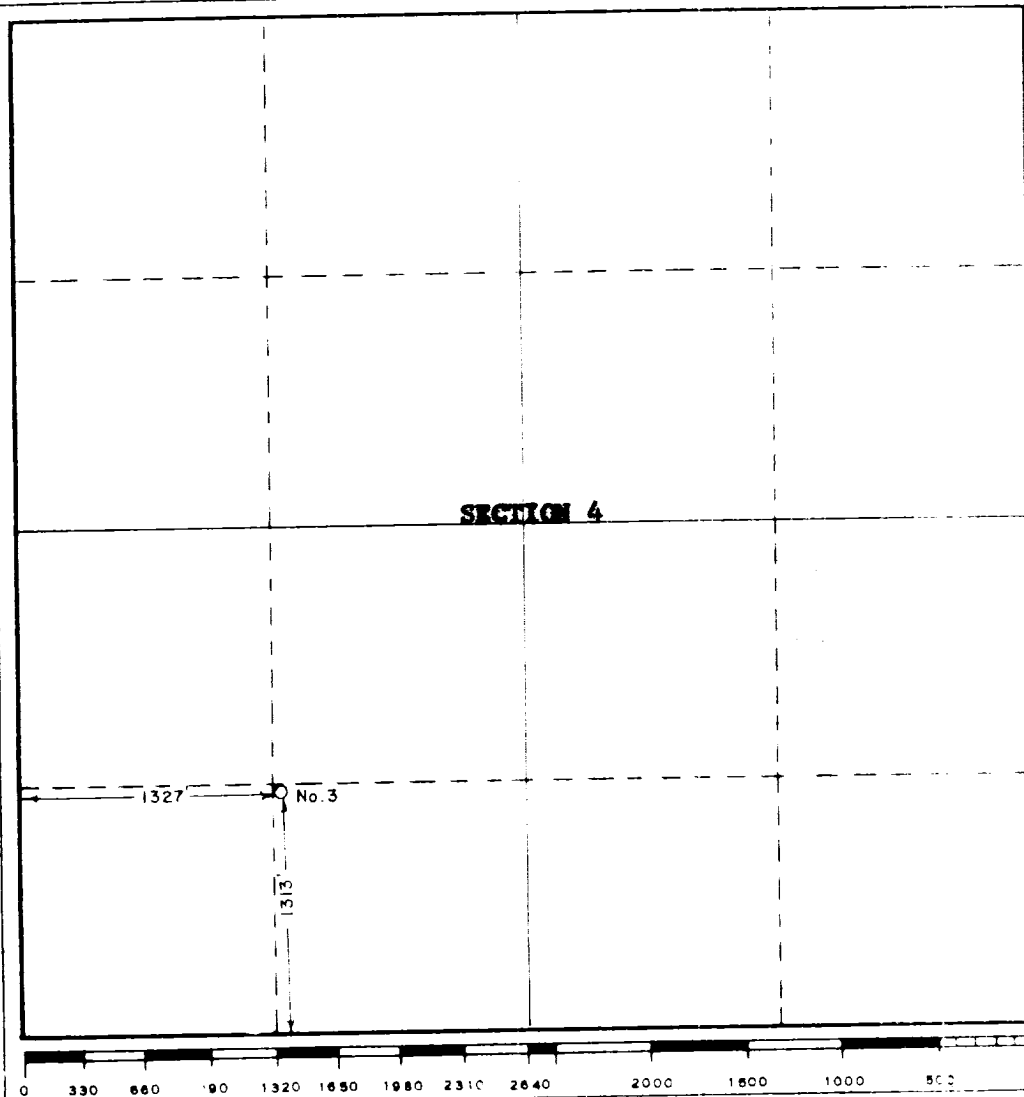

CERTIFICATION

I hereby certify that the information contained herein is true and complete to the best of my knowledge and belief.

ORIGINAL
Name **V. R. Fletcher**

V. R. Fletcher

Position

District Superintendent

Company

Skelly Oil Company

Date

October 16, 1967

I hereby certify that the well location shown on this plat was plotted from field notes of actual surveys made by me or under my supervision, and that the same is true and correct to the best of my knowledge and belief.

OCTOBER 13, 1967

Date Surveyed

Registered Professional Engineer
and/or Land Surveyor

John W. West
Certificate No. **676**