

UNITED STATES
DEPARTMENT OF THE INTERIOR
GEOLOGICAL SURVEY

APPLICATION FOR PERMIT TO DRILL, DEEPEN, OR PLUG BACK

1a. TYPE OF WORK
DRILL ☒ DEEPEN ☐ PLUG BACK ☐

b. TYPE OF WELL
OIL WELL ☒ GAS WELL ☐ OTHER ☐ SINGLE ZONE ☒ MULTIPLE ZONE ☐

2. NAME OF OPERATOR
Continental Oil Company

3. ADDRESS OF OPERATOR
Box 460 Hobbs, N. Mex.

4. LOCATION OF WELL (Report location clearly and in accordance with any State requirements.)
At surface *1980' FNL + 330' FEL of Sec. 25*

At proposed prod. zone *Same*

14. DISTANCE IN MILES AND DIRECTION FROM NEAREST TOWN OR POST OFFICE*

15. DISTANCE FROM PROPOSED* LOCATION TO NEAREST PROPERTY OR LEASE LINE, FT.
(Also to nearest drg. unit line, if any)

18. DISTANCE FROM PROPOSED LOCATION* TO NEAREST WELL, DRILLING, COMPLETED, OR APPLIED FOR, ON THIS LEASE, FT.

21. ELEVATIONS (Show whether DF, RT, GR, etc.)
Est. DF 2940'

23. PROPOSED CASING AND CEMENTING PROGRAM

SIZE OF HOLE	SIZE OF CASING	WEIGHT PER FOOT	SETTING DEPTH	QUANTITY OF CEMENT
<i>12 1/4</i>	<i>8 5/8</i>	<i>20</i>	<i>500</i>	<i>350</i>
<i>7 7/8</i>	<i>5 1/2</i>	<i>14</i>	<i>3330</i>	<i>100</i>

It is proposed to drill a straight hole to TD and complete this well as a Scarborough Yates Seven Rivers oil well.

5. LEASE DESIGNATION AND SERIAL NO.
LC-030167(2)

6. IF INDIAN, ALLOTTEE OR TRIBE NAME

7. UNIT AGREEMENT NAME
N M F U.

8. FARM OR LEASE NAME
McCollister A

9. WELL NO.
6

10. FIELD AND POOL, OR WILDCAT
Scarborough Yates 7 Rivers

11. SEC., T., R., S., OR B.L.K. AND SURVEY OR AREA
Sec. 25, T-26S, R-36E

12. COUNTY OR PARISH 13. STATE
Lea. N. Mex.

17. NO. OF ACRES ASSIGNED TO THIS WELL
40

20. ROTARY OR CABLE TOOLS
Rotary

22. APPROX. DATE WORK WILL START*
6-17-70

IN ABOVE SPACE DESCRIBE PROPOSED PROGRAM: If proposal is to deepen or plug back, give data on present productive zone and proposed new productive zone. If proposal is to drill or deepen directionally, give pertinent data on subsurface locations and measured and true vertical depths. Give blowout preventer program, if any.

24. SIGNATURE *[Signature]* TITLE *Adm. Section Chief* DATE *6-9-70*

(This space for Federal or State office use)

PERMIT NO. APPROVAL DATE

APPROVED BY TITLE

CONDITIONS OF APPROVAL, IF ANY:

*USGS-5
NMFU - Partners
E.I.*

*See Instructions On Reverse Side

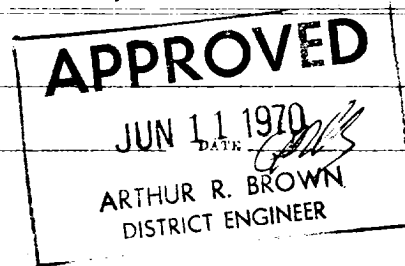

NEW MEXICO OIL CONSERVATION COMMISSION
WELL LOCATION AND ACREAGE DEDICATION PL

Form C-122
Supersedes C-128
Effective 1-1-65

All distances must be from the outer boundaries of the Section

Operator CONTINENTAL OIL COMPANY			Lease MCCALLISTER "A"		Well No. 6
Unit Letter H	Section 25	Township 26 SOUTH	Range 36 EAST	County LEA	
Actual Footage Location of Well:					
1980 feet from the NORTH line and		330 feet from the EAST line			
Ground Level Elev.	Producing Formation Yates	Pool McCallister Yates Pool	Dedicated Acreage: 4.0 Acres		

- Outline the acreage dedicated to the subject well by colored pencil or hatchure marks on the plat below.
- If more than one lease is dedicated to the well, outline each and identify the ownership thereof (both as to working interest and royalty).
- If more than one lease of different ownership is dedicated to the well, have the interests of all owners been consolidated by communitization, unitization, force-pooling, etc?

☐ Yes ☐ No If answer is "yes," type of consolidation _____

If answer is "no," list the owners and tract descriptions which have actually been consolidated. (Use reverse side of this form if necessary.) _____

No allowable will be assigned to the well until all interests have been consolidated (by communitization, unitization, forced-pooling, or otherwise) or until a non-standard unit, eliminating such interests, has been approved by the Commission.

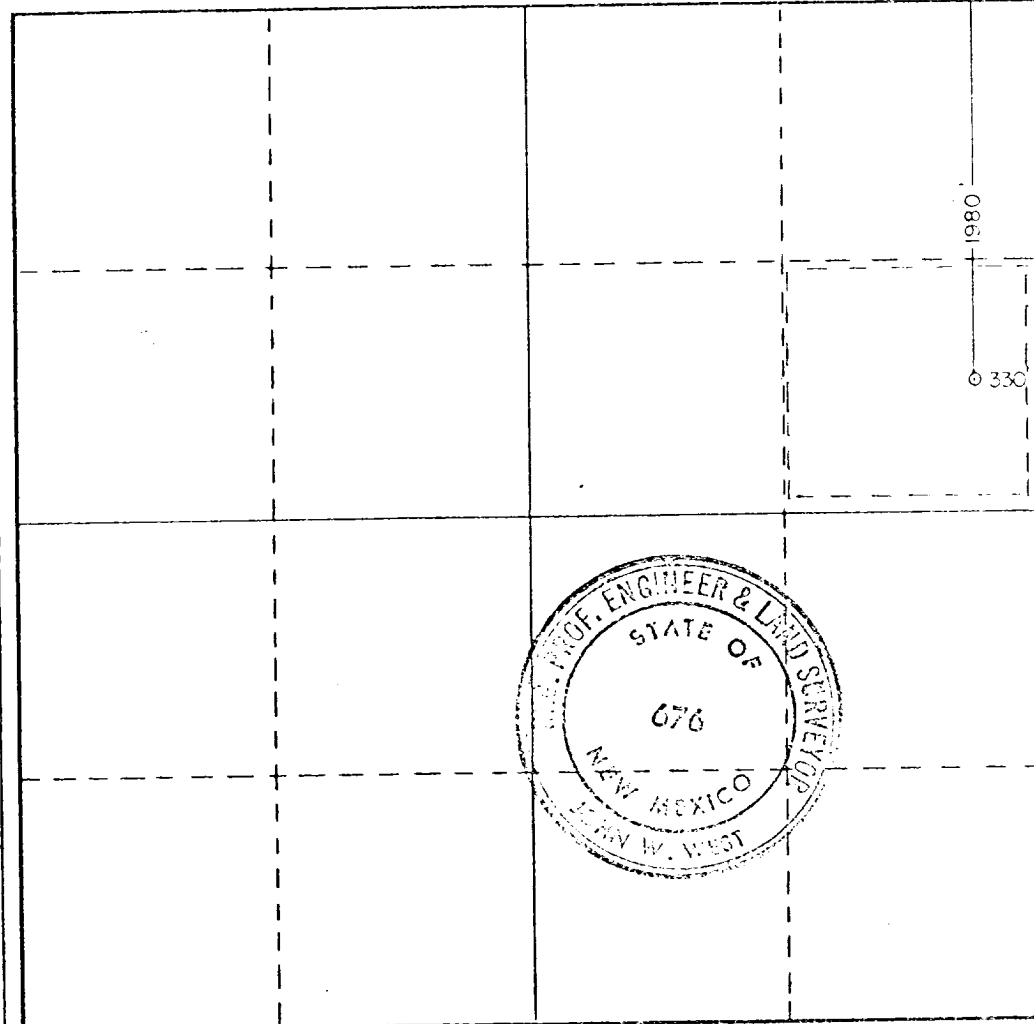

CERTIFICATION

I hereby certify that the information contained herein is true and complete to the best of my knowledge and belief.

Name *Hugh Ingram*
Position *Adm. Section Chief*
Company *Continental Oil Co.*
Date *6-9-70*

I hereby certify that the well location shown on this plat was plotted from field notes of actual surveys made by me or under my supervision, and that the same is true and correct to the best of my knowledge and belief.

Date Surveyed
JUNE 8, 1970

Registered Professional Engineer and/or Land Surveyor

Jerry W. West
Certificate No. **676**

0 330 660 990 1320 1650 1980 2310 2640 2970 3300 3630 3960 4290 4620 4950 5280 5610 5940 6270 6600