

DISTRICT I
P.O. Box 1980, Hobbs, NM 88241-1980

DISTRICT II
P.O. Drawer DD, Artesia, NM 88211-0719

DISTRICT III
1000 Rio Brazos Rd., Aztec, NM 87410

DISTRICT IV
P.O. BOX 2088, SANTA FE, N.M. 87504-2088

State of New Mexico
Energy, Minerals and Natural Resources Department

JOHN H. HENDRIX CORP.

RECEIVED

Form C-102

Revised February 10, 1994

Appropriate District Office

State Lease - 4 Copies

Fee Lease - 3 Copies

OIL CONSERVATION DIVISION

P.O. Box 2088

Santa Fe, New Mexico 87504-2088

MIDLAND, TX

WELL LOCATION AND ACREAGE DEDICATION PLAT

☐ AMENDED REPORT

API Number 30-025-23671	Pool Code 58300	Pool Name Teague - Paddock - Blinebry
Property Code 27141	Property Name EVA BLINEBRY "B"	Well Number 2
OGRID No. 012024	Operator Name JOHN H. HENDRIX CORP.	Elevation 3294'

Surface Location

UL or lot No. D	Section 34	Township 23S	Range 37 E	Lot Idn	Feet from the 1059	North/South line NORTH	Feet from the 330	East/West line WEST	County LEA
---------------------------	----------------------	------------------------	----------------------	---------	------------------------------	----------------------------------	-----------------------------	-------------------------------	----------------------

Bottom Hole Location If Different From Surface

UL or lot No.	Section	Township	Range	Lot Idn	Feet from the	North/South line	Feet from the	East/West line	County
Dedicated Acres 40	Joint or Infill	Consolidation Code	Order No.						

NO ALLOWABLE WILL BE ASSIGNED TO THIS COMPLETION UNTIL ALL INTERESTS HAVE BEEN CONSOLIDATED
OR A NON-STANDARD UNIT HAS BEEN APPROVED BY THE DIVISION

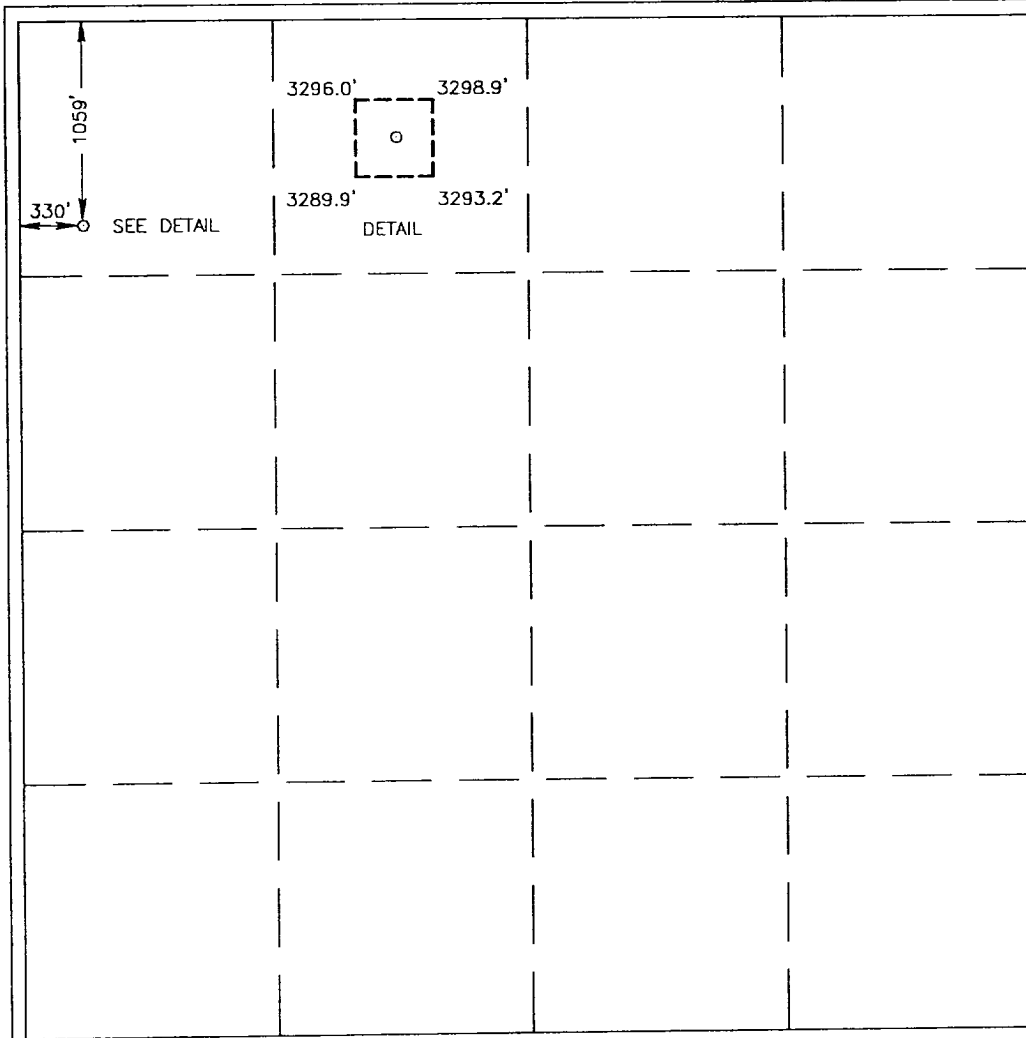

OPERATOR CERTIFICATION

I hereby certify the the information
contained herein is true and complete to the
best of my knowledge and belief.

Ronnie H. Westbrook

Signature

Ronnie H. Westbrook

Printed Name

Vice President

Title

12/28/01

Date

SURVEYOR CERTIFICATION

I hereby certify that the well location shown
on this plat was plotted from field notes of
actual surveys made by me or under my
supervision, and that the same is true and
correct to the best of my belief.

DECEMBER 19, 2001

Date Surveyed

AWB

Signature & Seal of
Professional Surveyor

Ronald L. Eidsen
3239
01-11-1162-1
12/20/01

Certificate No. **RONALD L. EIDSON** 3239
GARY EIDSON 12841

**JOHN H. HENDRIX CORPORATION
RE-ENTER & DEEPEN PROGRAM**

Attachment to Form 3160-3

Eva Blinebry B No. 2

Surface Location: 1059' FNL & 330' FWL, Unit Letter D, Section 34, T23S, R37E

Ground Elevation: 3294'

Bottom Hole Location: Same

Lea County, New Mexico

1. Geologic Name and Estimated Tops:

Anhydrite	1052'	Blinebry	5430'
Salt	1175'	Tubb	5900'
Yates	2400'		
Seven Rivers	2750'		
Queen	3225'		
Glorieta	4920'		

2. Estimated Depth to Fresh Water:

Possible fresh water from surface to 330'

Anticipated Possible Hydrocarbon Bearing Zones: Paddock, Blinebry, Tubb

The fresh water sands are protected by 8-5/8" casing at 918' with cement back to surface.

The 5-1/2" production string will be set at 6220' TD and cement back to 8-5/8" surface.

3. Proposed Casing Program:

Hole Size	Interval OD Casing	Weight, Grade, Jt Cond.
7-7/8"	0-6200' 5-1/2"	15.5#, K55, ST&C, New

4. Proposed Cementing Program:

5-1/2" Prod. Csg.: Lead Stage - Cement w/ 1300 sx. of Class "C" w/ 6% Gel, 5 lb/sx.
Salt
Tail Stage - Cement w/ 500 sx. Class "H" w/ 5 lb/sx. Salt, 9.6 lb/sx.
Silicalite
TOC @ 8-5/8" casing shoe TIE-BACK-OK

5. Minimum Specifications for Pressure Control:

The blowout preventer equipment (BOP) shown in the attachments will consist of a double ram-type (3000 psi WP) preventer. It will be equipped with pipe rams on top and blind rams on bottom. The BOP will be nipped up on the 8-5/8" casing and used continuously until TD is reached. Ram-type BOP and accessory equipment will be tested to 1000 psi.

2000