

Form 3160-5
(June 1990)

UNITED STATES
DEPARTMENT OF THE INTERIOR
BUREAU OF LAND MANAGEMENT

FORM APPROVED
Budget Bureau No. 1004-0135
Expires: March 31, 1993

SUNDRY NOTICES AND REPORTS ON WELLS

Do not use this form for proposals to drill or to deepen or reentry to a different reservoir.
Use "APPLICATION FOR PERMIT—" for such proposals

5. Lease Designation and Serial No.

NM-77064

6. If Indian, Allottee or Tribe Name

7. If Unit or CA, Agreement Designation

8. Well Name and No.

Mesa Verde "6" Fed No 11

9. API Well No.

30-025-32752

10. Field and Pool, or Exploratory Area
Mesa Verde Bone Spring/
Delaware

11. County or Parish, State

Lea, New Mexico

SUBMIT IN TRIPLICATE

1. Type of Well

☒ Oil Well ☐ Gas Well ☐ Other

2. Name of Operator

Santa Fe Energy Resources, Inc.

3. Address and Telephone No.

550 W. Texas, Suite 1330; Midland, TX 79701 (915) 682-6373

4. Location of Well (Footage, Sec., T., R., M., or Survey Description)

(E) 1650' FNL & 990' FWL Sec 6, T-24-S, R-32-E

12. CHECK APPROPRIATE BOX(s) TO INDICATE NATURE OF NOTICE, REPORT, OR OTHER DATA

TYPE OF SUBMISSION

☐ Notice of Intent
☒ Subsequent Report
☐ Final Abandonment Notice

TYPE OF ACTION

☐ Abandonment
☐ Recompletion
☐ Plugging Back
☐ Casing Repair
☐ Altering Casing
☒ Other Amend Location

☐ Change of Plans
☐ New Construction
☐ Non-Routine Fracturing
☐ Water Shut-Off
☐ Conversion to Injection
☐ Dispose Water

(Note: Report results of multiple completion on Well Completion or Recompletion Report and Log form.)

13. Describe Proposed or Completed Operations (Clearly state all pertinent details, and give pertinent dates, including estimated date of starting any proposed work. If well is directionally drilled, give subsurface locations and measured and true vertical depths for all markers and zones pertinent to this work.)*

Santa Fe Energy Resources, Inc. respectfully requests the surface location be moved from (E) 1980' FNL & 660' FWL to (E) 1650' FNL & 990' FWL of Sec 6, T-24-S, R-32-E.

A clearance report will be submitted by Desert West Archaeological Services.

14. I hereby certify that the foregoing is true and correct

Signed James O. Wilson

Title Agent for Santa Fe Energy

Date 6-15-95

(This space for Federal or State office use)

Approved by James O. Wilson
Conditions of approval, if any:

Title

Date

RECEIVED
JUN 1964
OCT 1964

DISTRICT I
P. O. Box 1980
Hobbs, NM 88241-1980

State of New Mexico
Energy, Minerals, and Natural Resources Department

Form C-102
Revised 02-10-94

Instructions on back

DISTRICT II
P. O. Drawer DD
Artesia, NM 88211-0719

OIL CONSERVATION DIVISION

P. O. Box 2088
Santa Fe, New Mexico 87504-2088

Submit to the Appropriate
District Office
State Lease - 4 copies
Fee Lease - 3 copies

DISTRICT III
1000 Rio Brazos Rd.
Aztec, NM 87410

☒ AMENDED REPORT

DISTRICT IV
P. O. Box 2088
Santa Fe, NM 87507-2088

WELL LOCATION AND ACREAGE DEDICATION PLAT

¹ API Number 30-025-32752	² Pool Code 96229	³ Pool Name Mesa Verde Bone Spring/Delaware
⁴ Property Code	⁵ Property Name MESA VERDE '6' FEDERAL	⁶ Well Number 11
⁷ OGRID No.	⁸ Operator Name SANTA FE ENERGY RESOURCES, INC.	⁹ Elevation 3539'

¹⁰ SURFACE LOCATION

UL or lot no. E	Section 6	Township 24 SOUTH	Range 32 EAST, N.M.P.M.	Lot Ida	Feet from the 1650	North/South line NORTH	Feet from the 990	East/West line WEST	County LEA
--------------------	--------------	----------------------	----------------------------	---------	-----------------------	---------------------------	----------------------	------------------------	---------------

"BOTTOM HOLE LOCATION IF DIFFERENT FROM SURFACE

UL or lot no.	Section	Township	Range	Lot Ida	Feet from the	North/South line	Feet from the	East/West line	County
---------------	---------	----------	-------	---------	---------------	------------------	---------------	----------------	--------

¹² Dedicated Acres 40	¹³ Joint or Infill	¹⁴ Consolidation Code	¹⁵ Order No.
-------------------------------------	-------------------------------	----------------------------------	-------------------------

NO ALLOWABLE WELL BE ASSIGNED TO THIS COMPLETION UNTIL ALL INTERESTS HAVE BEEN
CONSOLIDATED OR A NON-STANDARD UNIT HAS BEEN APPROVED BY THE DIVISION

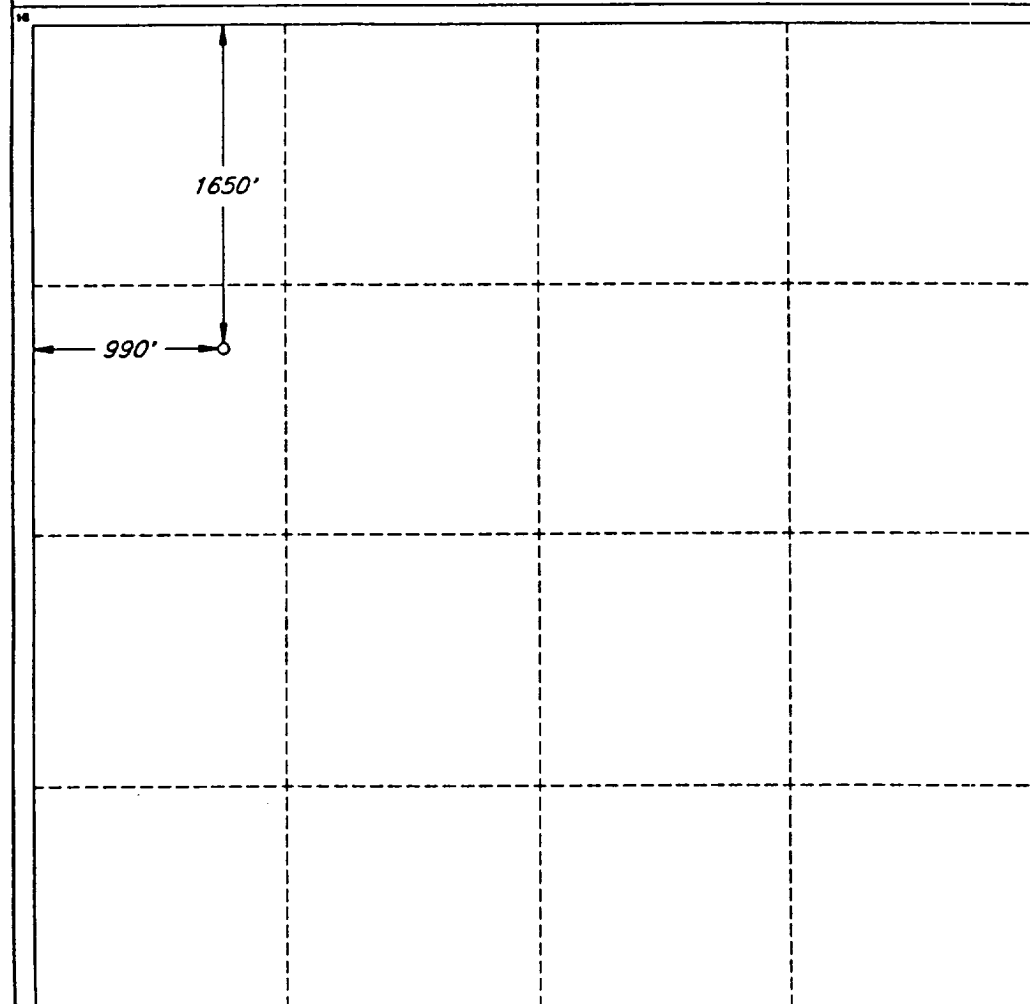

OPERATOR CERTIFICATION

I hereby certify that the information
contained herein is true and complete
to the best of my knowledge and belief.

Signature *James P. "Phil" Stinson*
Printed Name
James P. "Phil" Stinson
Title
Agent for Santa Fe Energy
Date
6-15-95

SURVEYOR CERTIFICATION

I hereby certify that the well
location shown on this plat was
plotted from field notes of actual
surveys made by me or under
my supervision, and that the
same is true and correct to the
best of my belief.

Date of Survey
JUNE 15, 1995
Signature and Seal of
Professional Surveyor
V. LYNN
BEZNER
NO. 7920
Certified
V. I. REVEREND

RECEIVED

JUN 30 1966

U.S. HOUSE
OFFICE