

NO. OF COPIES RECEIVED	
DISTRIBUTION	
SANTA FE	
FILE	
U.S.G.S.	
LAND OFFICE	
OPERATOR	

NEW MEXICO OIL CONSERVATION COMMISSION

Form C-101
Revised 1-1-65

5A. Indicate Type of Lease	
STATE <input checked="" type="checkbox"/>	FEE <input type="checkbox"/>
5. State Oil & Gas Lease No.	

APPLICATION FOR PERMIT TO DRILL, DEEPEN, OR PLUG BACK	
1a. Type of Work	
b. Type of Well DRILL <input checked="" type="checkbox"/> DEEPEN <input type="checkbox"/> PLUG BACK <input type="checkbox"/> OIL WELL <input checked="" type="checkbox"/> GAS WELL <input type="checkbox"/> OTHER <input type="checkbox"/> SINGLE ZONE <input checked="" type="checkbox"/> MULTIPLE ZONE <input type="checkbox"/>	
2. Name of Operator Continental Oil Company	
3. Address of Operator P. O. Box 460, Hobbs, New Mexico	
4. Location of Well UNIT LETTER <u>H</u> LOCATED <u>1980</u> FEET FROM THE <u>north</u> LINE AND <u>660</u> FEET FROM THE <u>East</u> LINE OF SEC. <u>6</u> TWP. <u>24S</u> RGE. <u>34E</u> NMPM	
5. Field and Lease Name <u>Bell Lake</u>	
6. Farm or Lease Name <u>Bell Lake Unit</u>	
7. Well No. <u>13</u>	
8. Field and Lease Name <u>Bell Lake Bone Springs</u>	
9. County <u>Lea</u>	
10. Proposed Depth <u>8880'</u>	
11. Formation <u>Bone Springs</u>	
12. Rotary or C.T. <u>Rotary</u>	
13. Elevations (Show whether DT, RT, etc.)	
14. Kind & Status Plug. Bond <u>Blanket Bond on file</u>	
15. Drilling Contractor <u>Marcum</u>	
16. Approx. Date Work will start <u>2-7-73</u>	

PROPOSED CASING AND CEMENT PROGRAM

SIZE OF HOLE	SIZE OF CASING	WEIGHT PER FOOT	SETTING DEPTH	SACKS OF CEMENT	EST. TOP
12 1/4"	8 5/8"	20#	1250'	1000 SKs	circ to surf
7 7/8"	5 1/2"	14#	8880'	475 SKs	5000'

It is proposed to drill a straight hole to a TD of 8880' and complete as a Bone Springs oil well.

APPROVAL VALID
FOR 90 DAYS UNLESS
DRILLING COMMENCED,

EXPIRES 5-5-73

IN ABOVE SPACE DESCRIBE PROPOSED PROGRAM: IF PROPOSAL IS TO DEEPEN OR PLUG BACK, GIVE DATA ON PRESENT PRODUCTIVE ZONE AND PROPOSED NEW PRODUCTIVE ZONE. GIVE BLOWOUT PREVENTER PROGRAM, IF ANY.

I hereby certify that the information above is true and complete to the best of my knowledge and belief.

Signed Robert Gault III Title Admin. Supervisor Date 2-2-73

(This space for State Use)

APPROVED BY [Signature] TITLE [Signature] DATE [Signature]

CONDITIONS OF APPROVAL, IF ANY:

NMOCC (5) File

FEB 5 1973

NEW MEXICO OIL CONSERVATION COMMISSION
WELL LOCATION AND ACREAGE DEDICATION PLAT

Form C-102
 Supersedes C-128
 Effective 1-1-65

All distances must be from the outer boundaries of the Section.

Operator CONTINENTAL OIL COMPANY			Lease Bell Lake		Well No. 13
Unit Letter H	Section 6	Township 24 South	Range 34 East	County Lea	
Actual Footage Location of Well: 1200 feet from the north line and 660 feet from the east line					
Ground Level Elev.	Producing Formation Bone Springs	Pool Bell Lake Bone Springs	Dedicated Acreage: 4-0		Acres

1. Outline the acreage dedicated to the subject well by colored pencil or hachure marks on the plat below.
2. If more than one lease is dedicated to the well, outline each and identify the ownership thereof (both as to working interest and royalty).
3. If more than one lease of different ownership is dedicated to the well, have the interests of all owners been consolidated by communitization, unitization, force-pooling, etc?

☐ Yes ☐ No If answer is "yes," type of consolidation _____

If answer is "no," list the owners and tract descriptions which have actually been consolidated. (Use reverse side of this form if necessary.) _____

No allowable will be assigned to the well until all interests have been consolidated (by communitization, unitization, forced-pooling, or otherwise) or until a non-standard unit, eliminating such interests, has been approved by the Commission.

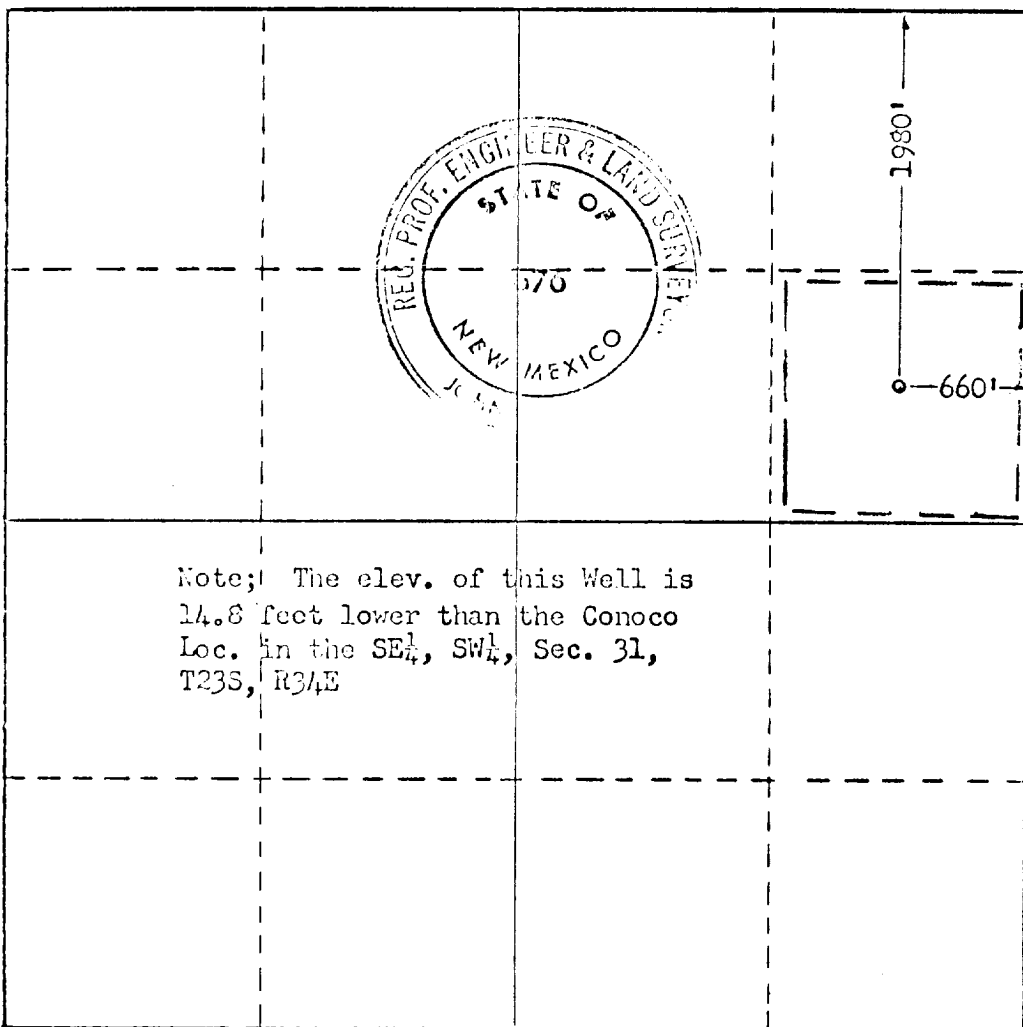

CERTIFICATION

I hereby certify that the information contained herein is true and complete to the best of my knowledge and belief.

Name Robert Gault
 Position Admin. Supervisor
 Company Continental Oil Co.
 Date February 2, 1973

I hereby certify that the well location shown on this plat was plotted from field notes of actual surveys made by me or under my supervision, and that the same is true and correct to the best of my knowledge and belief.

Date Surveyed
Feb. 1, 1973

Registered Professional Engineer
 and/or Land Surveyor

John W. West
 Certificate No. **676**

0 330 660 990 1320 1650 1980 2310 2640 2000 1800 1600 1400 1200 1000 800 0