

All distances must be from the outer boundaries of the Section.

Operator EL PASO NATURAL GAS COMPANY			Lease Rhodes Gas Storage Unit		Well No. 2
Unit Letter A	Section 8	Township 26 S	Range 37 E	County LEA	
Actual Footage Location of Well: 660 feet from the North line and 660 feet from the East line					
Ground Level Elev. 2985.2	Producing Formation YATES - 7 RIVERS		Pool RHODES YATES - 7 RIVERS		Dedicated Acreage 160 Acres

1. Outline the acreage dedicated to the subject well by colored pencil or hachure marks on the plat below.
2. If more than one lease is dedicated to the well, outline each and identify the ownership thereof (both as to working interest and royalty).
3. If more than one lease of different ownership is dedicated to the well, have the interests of all owners been consolidated by communitization, unitization, force-pooling, etc?

☐ Yes ☐ No If answer is "yes," type of consolidation _____

If answer is "no," list the owners and tract descriptions which have actually been consolidated. (Use reverse side of this form if necessary.) _____

No allowable will be assigned to the well until all interests have been consolidated (by communitization, unitization, forced-pooling, or otherwise) or until a non-standard unit, eliminating such interests, has been approved by the Commission.

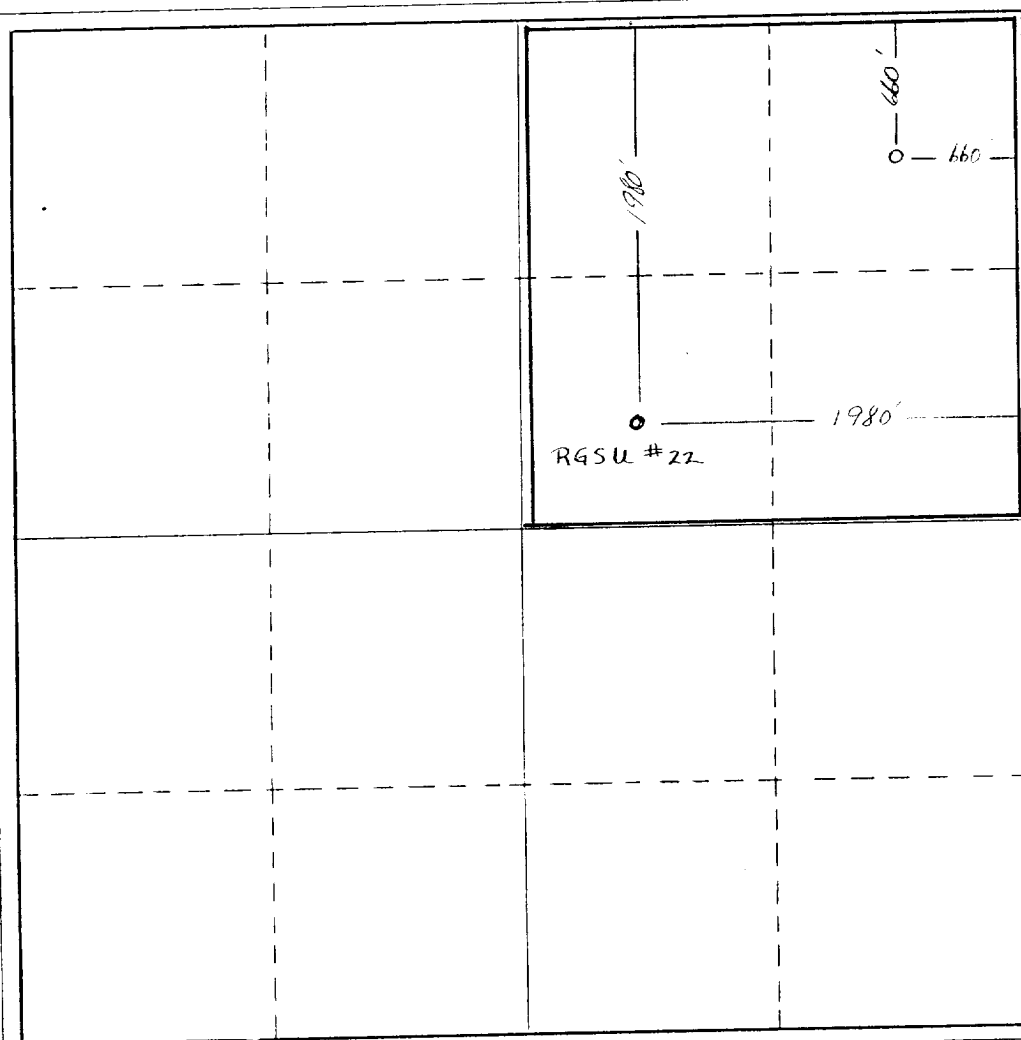

CERTIFICATION

I hereby certify that the information contained herein is true and complete to the best of my knowledge and belief.

John S. Delk

Name
JOHN S. DELK
Position
SUPERVISOR PROD. SVCS.
Company
EL PASO NATURAL GAS CO.
Date
MARCH 2, 1982

I hereby certify that the well location shown on this plat was plotted from field notes of actual surveys made by me or under my supervision, and that the same is true and correct to the best of my knowledge and belief.

Date Surveyed
May 17, 1973
Registered Professional Engineer
and/or Land Surveyor

Truman Gaskin
Certificate No.

2126

		CLASS		ELEV	L & S
SPD 7-23-73 CSG	CMP 9-7-73	FORMATION	DATUM	FORMATION	DATUM
		TD 3110'	PBD		

CONTR	Capitan	OPRS	ELEV	2985'	GL	PD	3250'	TYPE	RT
-------	---------	------	------	-------	----	----	-------	------	----

F.R. 6-4-73
(Yates) GAS STORAGE WELL
7-24-73 TD 621'; WOC
7-30-73 TD 2884'; Prep Core #4
Cored 2685-2735', rec 49', No descr
Cored 2735-2784', rec 49', No descr
Cored 2784-2834', rec 49', No descr
8-6-73 TD 3110'; MORT
Cored 2834-2884', rec 50', No descr
Cored 2884-2935', rec 50', No descr
Cored 2935-2975', rec 37', No descr
Cored 2975-3025', rec 48½', No descr
Cored 3025-3075', rec 50', No descr
Cored 3075-3110', rec 35', No descr
8-13-73 TD 3110'; WOCU

8-20-73 TD 3110'; WOCU
8-27-73 TD 3110'; WO Four Points
Perf 2822-3070'
Frac (2822-3070') 39,000 gals + 54,500# sd
9-5-73 TD 3110'; WO Four Points
9-11-73 TD 3110'; WO OCC Pot
CAOF 2249 MCEGPD
10-8-73 TD 3110'; COMPLETE
LOG TOPS: Yates 2804', Seven Rivers 3072'
10-13-73 COMPLETION REPORTED