

DISTRICT I
P.O. Box 1080, Hobbs, NM 88241-1080

State of New Mexico
Energy, Minerals and Natural Resources Department

Form C-102
Revised February 10, 1994
Submit to Appropriate District Office
State Lease - 4 Copies
Fee Lease - 3 Copies

DISTRICT II
P.O. Drawer 88, Artesia, NM 88211-0719

DISTRICT III
1000 Rio Brancos Rd., Asteo, NM 87410

DISTRICT IV
P.O. Box 2088, Santa Fe, NM 87504-2088

OIL CONSERVATION DIVISION

P.O. Box 2088
Santa Fe, New Mexico 87504-2088

☐ AMENDED REPORT

WELL LOCATION AND ACREAGE DEDICATION PLAT

API Number 30-025-24504	Pool Code 83810	Pool Name RHODES YATES 7R's GAS
Property Code 22874	Property Name RHODES STATE COM.	Well Number 18
OGRID No. 162683	Operator Name GRUY PETROLEUM MANAGEMENT CO.	Elevation 2977

Surface Location

UL or lot No. D	Section 16	Township 26 S	Range 37 E	Lot Idn	Feet from the 660	North/South line NORTH	Feet from the 860	East/West line WEST	County LEA
--------------------	---------------	------------------	---------------	---------	----------------------	---------------------------	----------------------	------------------------	---------------

Bottom Hole Location If Different From Surface

UL or lot No.	Section	Township	Range	Lot Idn	Feet from the	North/South line	Feet from the	East/West line	County
---------------	---------	----------	-------	---------	---------------	------------------	---------------	----------------	--------

Dedicated Acres 160	Joint or Infill	Consolidation Code	Order No. R-11476
------------------------	-----------------	--------------------	----------------------

NO ALLOWABLE WILL BE ASSIGNED TO THIS COMPLETION UNTIL ALL INTERESTS HAVE BEEN CONSOLIDATED
OR A NON-STANDARD UNIT HAS BEEN APPROVED BY THE DIVISION

	<p>OPERATOR CERTIFICATION</p> <p>I hereby certify the the information contained herein is true and complete to the best of my knowledge and belief.</p> <p><i>Joe T. Janica</i> Signature Joe T. Janica Printed Name Agent Title 06/12/98 Date</p> <p>SURVEYOR CERTIFICATION</p> <p>I hereby certify that the well location shown on this plat was plotted from field notes of actual surveys made by me or under my supervision, and that the same is true and correct to the best of my belief.</p> <p>JUNE 2, 1998 Date Surveyed Signature & Seal of Professional Surveyor NEW MEXICO W.O. Num 98-110860 Certification No. RONALD E. EIDSON, 3230 EIDSON, 12641 MCDONALD, 12165</p>
--	--

[illegible]

CONTR Captain Eric DESSAID 00 3250' TYPE RT

P.R. 9-3-73
(Yates)
GAS STORAGE WELL
10-3-73 TD 3230'; WOCU
10-25-73 TD 3230'; WO Four Points
Perf 2826-30, 2834-39, 2843-50, 2872-91, 2895-2900'
2911-24, 2927-32, 2951-56, 2966-85, 3015-21,
3068-73, 3084-92, 3096-3102' w/ 2 SPF
Frac (2326-3102') 42,000 gals + 44,200# sd
10-24-73 TD 3230'; COMPLETE
GAOF 3323 MCFCGPD
(Yates) FOUR POINT GAUGES:
Flow 380 MCFCGPD, Time NR, chk NR, TP 475#
Flow 518 MCFCGPD, Time NR, chk NR, TP 266#
Flow 671 MCFCGPD, Time NR, chk NR, TP 455#

LEA
EL PASO NATURAL GAS CO., LPG-18 Rhodes GSU

NM
Page #2

10-29-73

CONT'd

11-3-73

Flwd 879 MCFGPD, Time NR, chk NR, TP 400#
COMPLETION REPORTED

EL PASO NATURAL GAS COMPANY			Lease Rhodes Gas Storage Unit		Well No. 18
Unit Letter	Section	Township	Range	County	
D	16	26 S	37 E	LEA	
Actual Footage Location of Well:					
660 feet from the North line and		860 feet from the West line			
Ground Level Elev.	Producing Formation	Well	Dedicated Acreage		
2948.6	YATES - 7 RIVERS	RHODES YATES - 7 RIVERS	160	Acres	

1. Outline the acreage dedicated to the subject well by colored pencil or hatchure marks on the plat below.
2. If more than one lease is dedicated to the well, outline each and identify the ownership thereof (both as to working interest and royalty).
3. If more than one lease of different ownership is dedicated to the well, have the interests of all owners been consolidated by communitization, unitization, force-pooling, etc?

☐ Yes ☐ No If answer is "yes," type of consolidation _____

If answer is "no," list the owners and tract descriptions which have actually been consolidated. (Use reverse side of this form if necessary.) _____

No allowable will be assigned to the well until all interests have been consolidated (by communitization, unitization, forced-pooling, or otherwise) or until a non-standard unit, eliminating such interests, has been approved by the Commission.

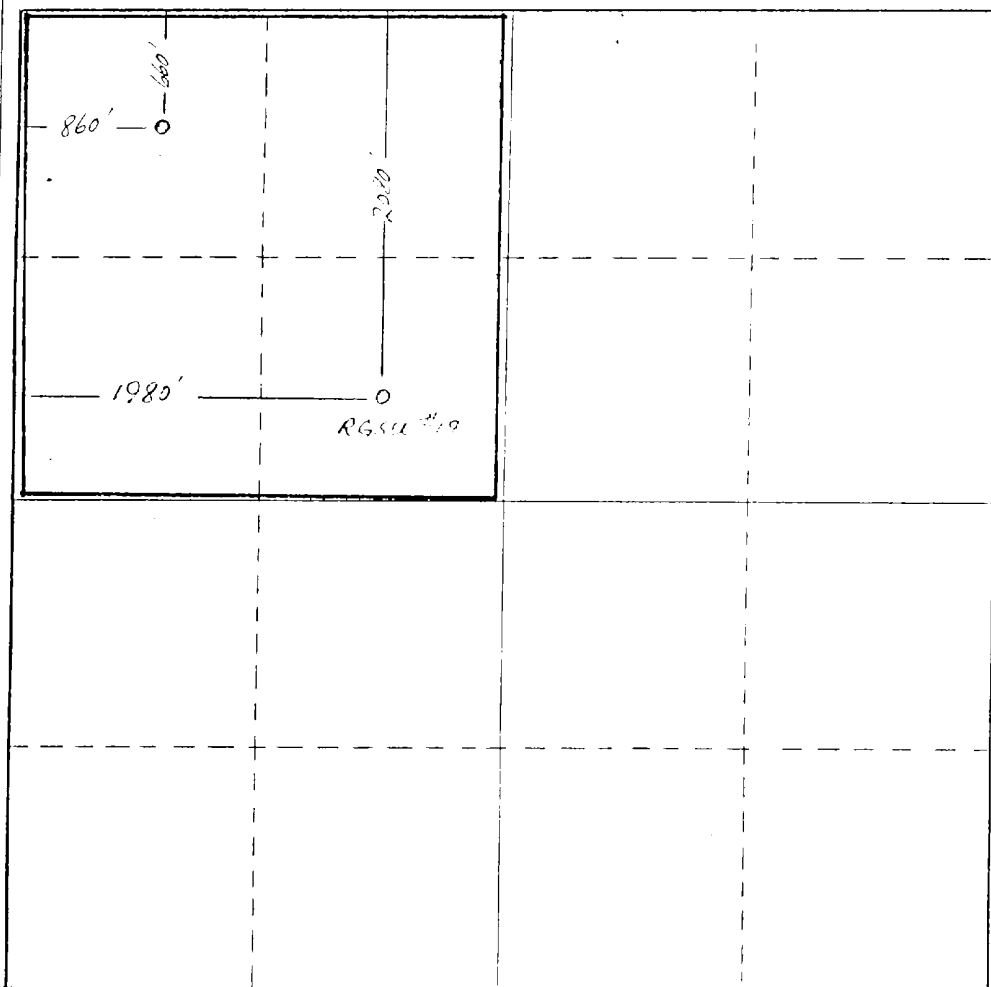

CERTIFICATION

I hereby certify that the information contained herein is true and complete to the best of my knowledge and belief.

John S. Delk

JOHN S. DELK

Position

SUPERVISOR PROD. SVCS.

Company

EL PASO NATURAL GAS CO.

Date

MARCH 2, 1982

I hereby certify that the well location shown on this plat was plotted from field notes of actual surveys made by me or under my supervision, and that the same is true and correct to the best of my knowledge and belief.

Date Surveyed

August 18, 1973

Registered Professional Engineer and/or Land Surveyor

Truman Gaskin

Certificate No.

2126

0 330 660 990 1320 1650 1980 2310 2640 2970 3300 3630 3960 4290 4620 4950 5280 5610 5940 6270 6600