

**NEW MEXICO OIL CONSERVATION COMMISSION
WELL LOCATION AND ACREAGE DEDICATION PLAT**

Form C-102
Supersedes C-128
Effective 1-1-65

All distances must be from the outer boundaries of the Section.

Operator JOHN H. HENDRIX			Lease ARCO STEELER		Well No. 1
Unit Letter 0	Section 19	Township 23 SOUTH	Range 37 EAST	County LEA	
Actual Footage Location of Well: 990 feet from the SOUTH line and 1980 feet from the EAST line					
Ground Level Elev. 3332.5	Producing Formation Seven Rivers-Queen		Pool Langlie-Mattix		Dedicated Acreage: 40 Acres

1. Outline the acreage dedicated to the subject well by colored pencil or hachure marks on the plat below.
2. If more than one lease is dedicated to the well, outline each and identify the ownership thereof (both as to working interest and royalty).
3. If more than one lease of different ownership is dedicated to the well, have the interests of all owners been consolidated by communitization, unitization, force-pooling, etc?

☐ Yes ☐ No If answer is "yes," type of consolidation _____

If answer is "no," list the owners and tract descriptions which have actually been consolidated. (Use reverse side of this form if necessary.) _____

No allowable will be assigned to the well until all interests have been consolidated (by communitization, unitization, forced-pooling, or otherwise) or until a non-standard unit, eliminating such interests, has been approved by the Commission.

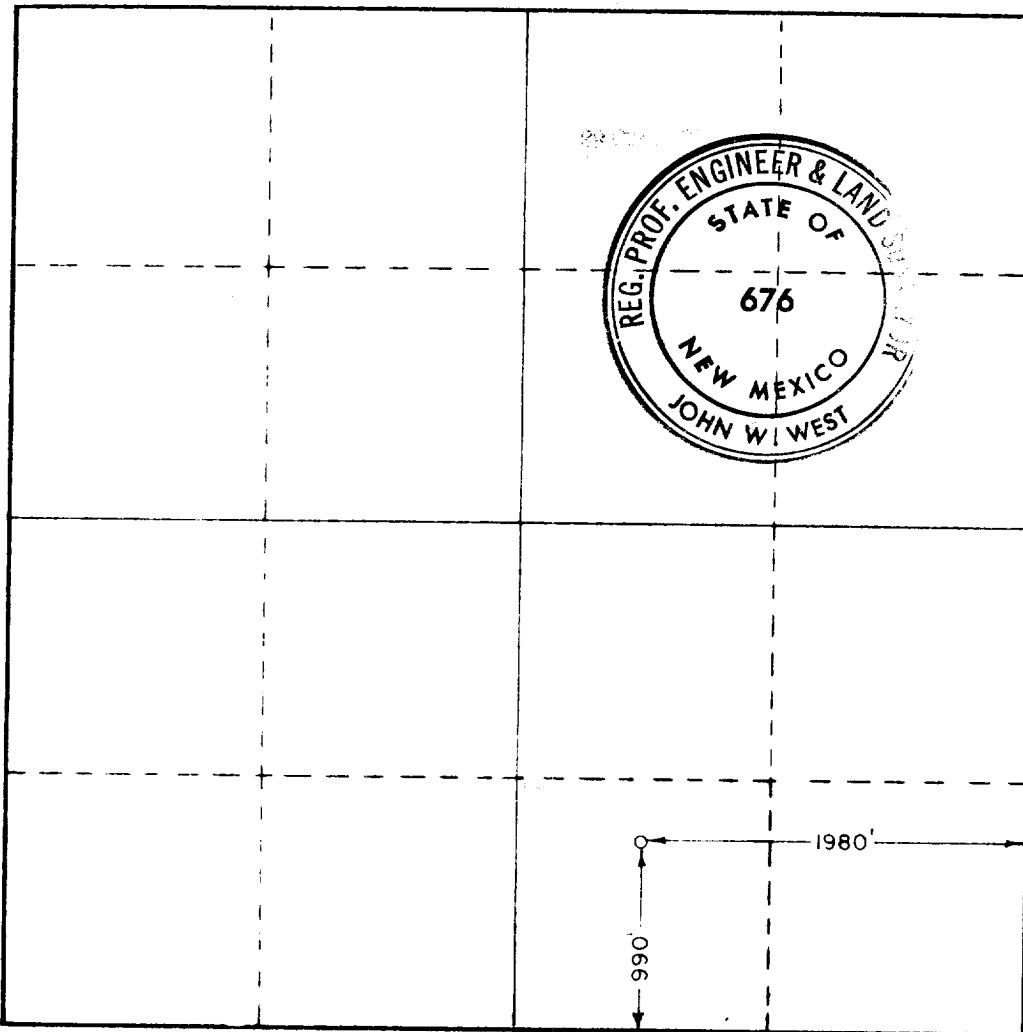

CERTIFICATION

I hereby certify that the information contained herein is true and complete to the best of my knowledge and belief.

Name *John H. Hendrix*
Position

Owner-Operator

Company
John H. Hendrix

Date
December 18, 1973

I hereby certify that the well location shown on this plat was plotted from field notes of actual surveys made by me or under my supervision, and that the same is true and correct to the best of my knowledge and belief.

Date Surveyed
December 11, 1973

Registered Professional Engineer and/or Land Surveyor

John W. West
Certificate No.

676



CLASS *GL* FLEV [REDACTED] LAS

IP (Seven Rivers-Queen) Perfs 3362-3625' P 29 BOPD + 24 BW.
Pot based on 24 hr test. GOR 7759; Grav 36

CONTR	Leatherwood	OPRS ELEV	3333' GL	PD	3799'	TYPE	RT
-------	-------------	-----------	----------	----	-------	------	----

F.R. 12-31-73
(Seven Rivers-Queen)
1-3-74 Drlg 3345' lm
1-9-74 TD 3700'; "Tight"
1-23-74 TD 3700'; RU Pulling Unit
Perf 3362-3625' w/36 shots (overall)
Acid (3362-3625') 3500 gals (15%)
Frac (3362-3625') 60,000 gals jelled wtr +
110,000# sd
Swbd 15 BO + 38 BW in 7 hrs (3362-3625')
1-30-74 TD 3700'; WO Pot
Ppd 29 BO + 24 BW in 24 hrs (3362-3625')
2-11-74 TD 3700'; COMPLETE
2-16-74 COMPLETION REPORTED