

1. OF COPIES RECEIVED		
DISTRIBUTION		
SANTA FE		
FILE		
U.S.G.S.		
LAND OFFICE		
OPERATOR		

# NEW MEXICO OIL CONSERVATION COMMISSION

Form C-101  
Revised 1-1-65

5A. Indicate Type of Lease STATE <input checked="" type="checkbox"/> FEE <input type="checkbox"/>
5. State Oil & Gas Lease No. K-3018
7. Unit Agreement Name
8. Farm or Lease Name STATE "P"
9. Well No. 1
10. Field and Pool, or Wildcat TRIPLE X DELAWARE
12. County Lea
19. Proposed Depth 5200
19A. Formation Delaware Sand
20. Rotary or C.T. Rotary
21. Elevations (Show whether DF, RT, etc.) 3594 GR
21A. Kind & Status Plug. Bond Statewide
21B. Drilling Contractor Cactus Drilling Co.
22. Approx. Date Work will start December 26, 1973

## APPLICATION FOR PERMIT TO DRILL, DEEPEN, OR PLUG BACK

1a. Type of Work b. Type of Well OIL WELL <input checked="" type="checkbox"/> GAS WELL <input type="checkbox"/> OTHER <input type="checkbox"/> DRILL <input checked="" type="checkbox"/> DEEPEN <input type="checkbox"/> PLUG BACK <input type="checkbox"/> SINGLE ZONE <input type="checkbox"/> MULTIPLE ZONE <input type="checkbox"/>	2. Name of Operator Tom L. Ingram	3. Address of Operator POB 1757, ROSWELL, NM 88201
4. Location of Well UNIT LETTER C LOCATED 330' FEET FROM THE North LINE AND 1750 FEET FROM THE West LINE OF SEC. 7 TWP. 24S RGE. 33E NMPM		
23. PROPOSED CASING AND CEMENT PROGRAM		

SIZE OF HOLE	SIZE OF CASING	WEIGHT PER FOOT	SETTING DEPTH	SACKS OF CEMENT	EST. TOP
11"	8-5/8	20#	400	400	Circ.
7-7/8"	4 1/2	10.5#	5200	300	2000

Propose to drill To TD, log, set casing, perforate and stimulate. Blow-out preventor will be used from surface casing to TD.

APPROVAL VALID  
FOR 90 DAYS UNLESS  
DRILLING COMMENCED,

EXPIRES 3-26-74

IN ABOVE SPACE DESCRIBE PROPOSED PROGRAM: IF PROPOSAL IS TO DEEPEN OR PLUG BACK, GIVE DATA ON PRESENT PRODUCTIVE ZONE AND PROPOSED NEW PRODUCTIVE ZONE. GIVE BLOWOUT PREVENTER PROGRAM, IF ANY.

I hereby certify that the information above is true and complete to the best of my knowledge and belief.

Signature Tom L. Ingram Title OPERATOR Date DECEMBER 20, 1973

(This space for State Use)

APPROVED BY [Signature] TITLE  DATE

CONDITIONS OF APPROVAL, IF ANY:

**NEW MEXICO OIL CONSERVATION COMMISSION  
WELL LOCATION AND ACREAGE DEDICATION PLAT**

Form O-102  
Supersedes O-128  
Effective 1-1-65

All distances must be from the outer boundaries of the Section

<b>TOM L. INGRAM</b>			Lessee		State <b>"p"</b>		Well No. <b>1</b>	
Section Center <b>C</b>	Section <b>7</b>	Township <b>24 South</b>	Range <b>33 East</b>	County <b>Lea</b>				
Area and Direction of Well <b>1750</b> feet from the <b>west</b> line and <b>330</b> feet from the <b>north</b> line								
Acres and Land Area <b>3594.4</b>		Producing Formation <b>Delaware Sand</b>		Pool <b>Triple X Delaware</b>		Dedicated Acreage <b>40</b>		

1. Outline the acreage dedicated to the subject well by colored pencil or hatchure marks on the plat below.
2. If more than one lease is dedicated to the well, outline each and identify the ownership thereof (both as to working interest and royalty)
3. If more than one lease of different ownership is dedicated to the well, have the interests of all owners been consolidated by communitization, unitization, force-pooling, etc?

Yes ☐ No ☒ If answer is "yes" type of consolidation \_\_\_\_\_

If answer is "no" list the owners and tract descriptions which have actually been consolidated. (Use reverse side of this form if necessary.) \_\_\_\_\_

No allowable will be assigned to the well until all interests have been consolidated (by communitization, unitization, force-pooling, or otherwise) or until a non-standard unit, eliminating such interests, has been approved by the Commission.

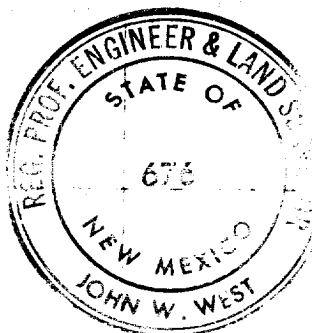
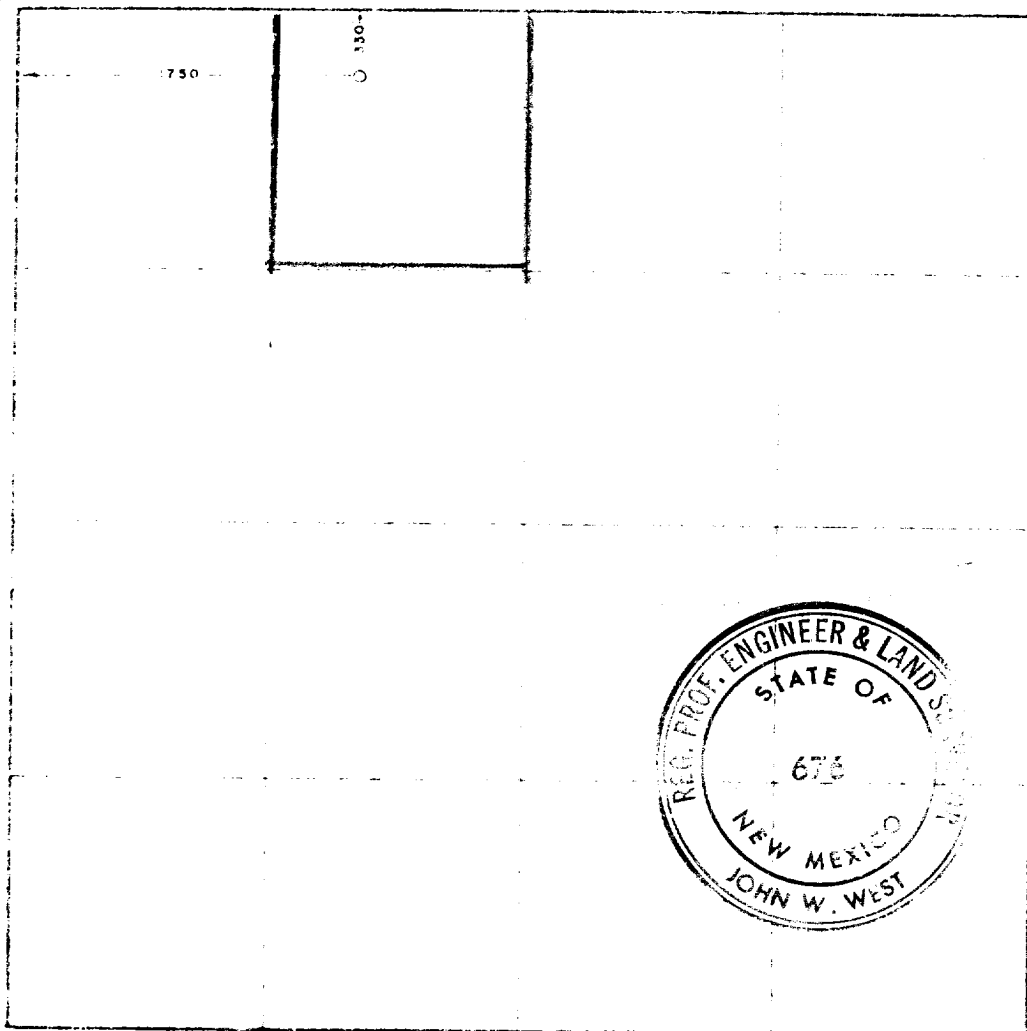

**CERTIFICATION**

I hereby certify that the information contained herein is true and complete to the best of my knowledge and belief.

*[Signature]*  
\_\_\_\_\_  
TOM L. INGRAM

**OPERATOR**

**TOM L. INGRAM**

**DECEMBER 20, 1973**

I hereby certify that the well location shown on this plat was plotted from field notes of actual surveys made by me or under my supervision, and that the same is true and correct to the best of my knowledge and belief.

\_\_\_\_\_  
Dec. 17, 1973

Registered Professional Engineer & Land Surveyor

*[Signature]*  
\_\_\_\_\_  
JOHN W. WEST