

NO. OF COPIES RECEIVED	
DISTRIBUTION	
SANTA FE	
FILE	
U.S.G.S.	
LAND OFFICE	
OPERATOR	

NEW MEXICO OIL CONSERVATION COMMISSION

Form C-131
Revised 1-1-65

5A. Indicate Type of Lease	
STATE <input type="checkbox"/>	FEE <input checked="" type="checkbox"/>
5. State Oil & Gas Lease No.	

APPLICATION FOR PERMIT TO DRILL, DEEPEN, OR PLUG BACK

1a. Type of Work		7. Unit Agreement Name	
b. Type of Well OIL WELL <input checked="" type="checkbox"/> GAS WELL <input type="checkbox"/> OTHER <input type="checkbox"/>		8. Firm or Lease Name Rutledge	
2. Name of Operator Armer Oil Company		9. Well No. 1	
3. Address of Operator 2110 Continental National Bank Bldg., Ft. Worth, Texas 76102		10. Field and Pool, or Wildcat Langlie-Mattix SR	
4. Location of Well UNIT LETTER D LOCATED 990 FEET FROM THE North LINE AND 660 FEET FROM THE West LINE OF SEC. 11 TWP. 23S RGT. 37E N.M.P.M.		12. County Lea	
19. Proposed Depth 3660'		19A. Formation Penrose Sand	20. Rotary or C.T. Rotary
21. Elevations (Show whether DE, RT, etc.)	21A. Kind & Status Plug. Bond Blanket #919A5228	21B. Drilling Contractor Cactus Drilling Co.	22. Approx. Date Work will start 2/27/74

PROPOSED CASING AND CEMENT PROGRAM

SIZE OF HOLE	SIZE OF CASING	WEIGHT PER FOOT	SETTING DEPTH	SACKS OF CEMENT	EST. TOP
12"	9-5/8" OD	36#	600'	150	Circulate
8-3/4"	5 1/2" OD	14#	3640'	350	2500'

Armer Oil Company proposes to drill its Rutledge #1 well to test the Penrose Sand, the top of which is expected at an approximate depth of 3560'.

Casing program will consist of 9-5/8" OD surface casing to be set at an approximate depth of 600' cemented to the surface and 5-1/2" OD production casing to be set at total depth and cement from total depth back to base of salt at approximately 2500'.

If water flow in Yates-Seven Rivers is encountered, open hole packers will be run in 5-1/2" OD production casing string to isolate this water flow for squeezing with cement.

The Penrose Sand will be perforated and fracture treated for production.

APPROVAL VALID
FOR 90 DAYS UNLESS
DRILLING COMMENCED,
EXPIRES 4-29-74

IN ABOVE DESCRIBE PROPOSED PROGRAM; IF PROPOSAL IS TO DEEPEN OR PLUG BACK, GIVE DATA ON PRESENT PRODUCTIVE ZONE AND PROPOSED NEW PRODUCTIVE ZONE. IF PROPOSAL IS TO DEEPEN OR PLUG BACK, GIVE DATA ON PRESENT PRODUCTIVE ZONE AND PROPOSED NEW PRODUCTIVE ZONE.

I hereby certify that the information above is true and complete to the best of my knowledge and belief.

Signed [Signature] Title Production Manager Date 2/22/74

This space for State Use

APPROVED [Signature] TITLE State Engineer DATE 2/22/74

CONDITIONS OF APPROVAL, IF ANY:

N. MEXICO OIL CONSERVATION COMMISSION
WELL LOCATION AND ACREAGE DEDICATION PLAT

Form C-102
Supersedes C-128
Effective 1-1-65

All distances must be from the outer boundaries of the Section

Operator ARMER OIL COMPANY			Lease RUTLEDGE		Well No. 1
Unit Letter D	Section 11	Township 23 SOUTH	Range 37 EAST	County LEA	
Actual Footage Location of Well: 660 feet from the WEST line and 990 feet from the NORTH line					
Ground Level Elev. 3298.8	Producing Formation <i>Pensacola</i>		Pool <i>Largely Matrix</i>	Dedicated Acreage: 40 Acres	

1. Outline the acreage dedicated to the subject well by colored pencil or hatchure marks on the plat below.
2. If more than one lease is dedicated to the well, outline each and identify the ownership thereof (both as to working interest and royalty)
3. If more than one lease of different ownership is dedicated to the well, have the interests of all owners been consolidated by communitization, unitization, force-pooling, etc?

☐ Yes ☐ No If answer is "yes," type of consolidation _____

If answer is "no," list the owners and tract descriptions which have actually been consolidated (Use reverse side of this form if necessary.) _____

No allowable will be assigned to the well until all interests have been consolidated (by communitization, unitization, forced-pooling, or otherwise) or until a non-standard unit, eliminating such interests, has been approved by the Commission.

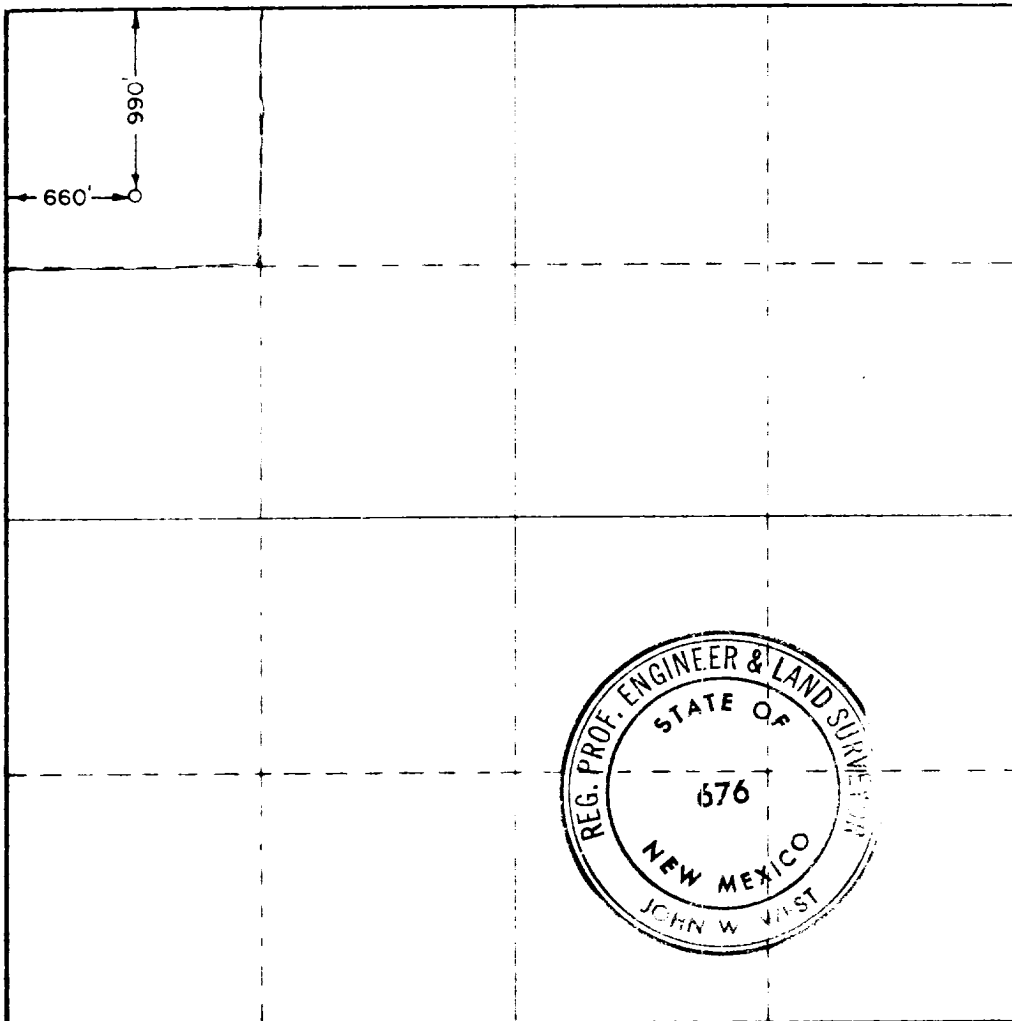

CERTIFICATION

I hereby certify that the information contained herein is true and complete to the best of my knowledge and belief.

Name *Chandler Haggard*
Position *Agent*
Company *Armer Oil Co.*
Date *2-25-74*

I hereby certify that the well location shown on this plat was plotted from field notes of actual surveys made by me or under my supervision, and that the same is true and correct to the best of my knowledge and belief.

Date Surveyed
FEBRUARY 23, 1974

Registered Professional Engineer
and/or Land Surveyor

John W. West
Certificate No. **676**