

**NEW MEXICO
OIL CONSERVATION COMMISSION**

Form C-128

Well Location and/or Gas Proration Plat

(Getty Oil Company - Owner)

Date July 17, 1956

Operator Getty Oil Company

Lease G. D. Riggs "B"

Well No. 4 Section 1 Township 26S Range 37-E NMPM

Located 660 Feet From North Line, 1980 Feet From East Line.

Lee County, New Mexico. G. L. Elevation To be run later

Name of Producing Formation Queens

Pool Langille-Hutton Dedicated Acreage 40

(Note: All distances must be from outer boundaries of Section)

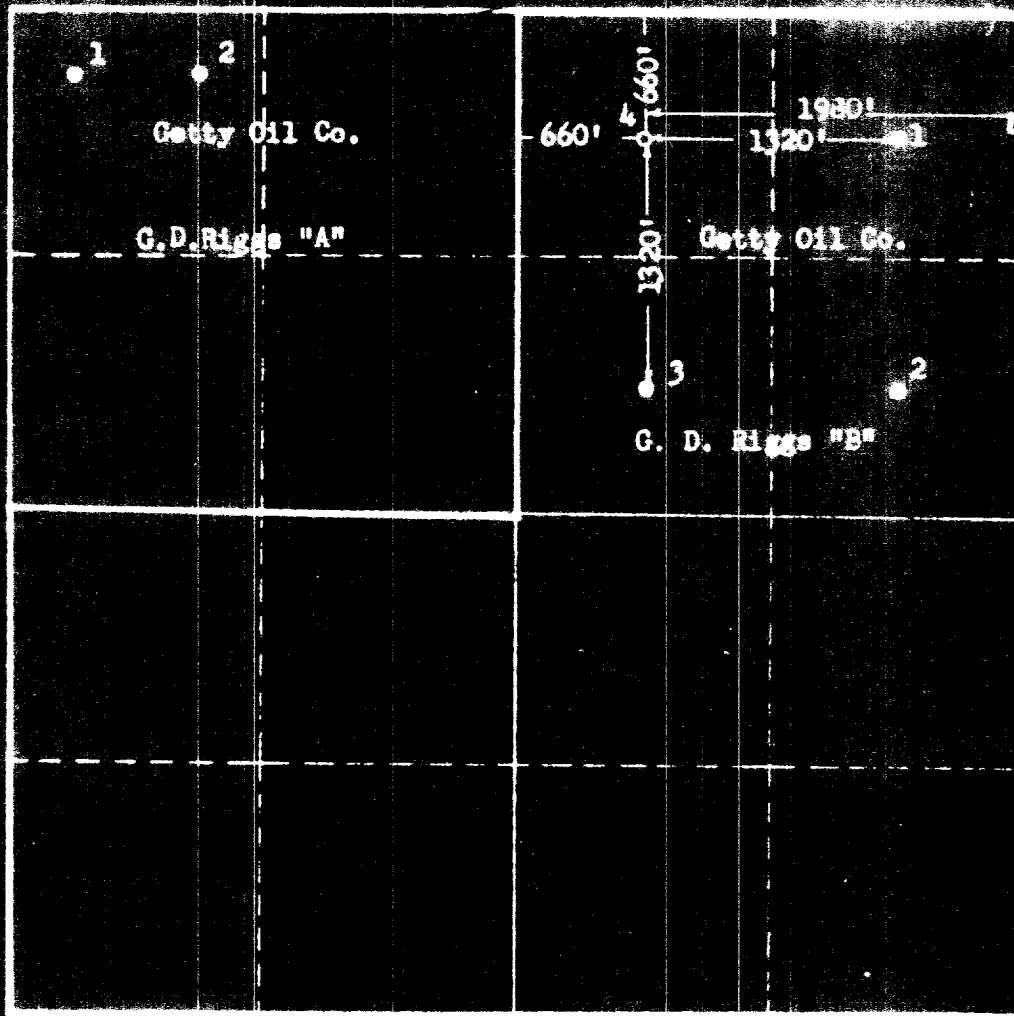

RECEIVED
JUL 23 1956
S. GEOLOGIC.
MOBBS, NEW

1. Is this Well a Dual Comp. ? Yes No x
2. If the answer to Question 1 is yes, are there any other dually completed wells within the dedicated acreage ? Yes No

This is to certify that the above plat was prepared from field notes of actual surveys made by me or under my supervision and that the same are true and correct to the best of my knowledge and belief.

Name
Position
Representing
Address

Date Surveyed July 16, 1956
[Signature]
Registered Professional Engineer and/or
Land Surveyor