

NO. OF COPIES RECEIVED	
DISTRIBUTION	
SANTA FE	
FILE	
U.S.G.S.	
LAND OFFICE	
OPERATOR	

NEW MEXICO OIL CONSERVATION COMMISSION

Form C-101
Revised 1-1-65

5A. Indicate Type of Lease	
STATE <input type="checkbox"/>	FEE <input checked="" type="checkbox"/>

5. State Oil & Gas Lease No.

APPLICATION FOR PERMIT TO DRILL, DEEPEN, OR PLUG BACK

1a. Type of Work		7. Unit Agreement Name	
b. Type of Well DRILL <input checked="" type="checkbox"/> DEEPEN <input type="checkbox"/> PLUG BACK <input type="checkbox"/> OIL WELL <input checked="" type="checkbox"/> GAS WELL <input type="checkbox"/> OTHER <input type="checkbox"/> SINGLE ZONE <input type="checkbox"/> MULTIPLE ZONE <input type="checkbox"/>		8. Farm or Lease Name S. R. Cooper "A"	
2. Name of Operator Texas Pacific Oil Company, Inc.		9. Well No. 2	
3. Address of Operator P. O. Box 4067, Midland, Texas 79701		10. Field and Pool, or Wildcat Jalmat	
4. Location of Well UNIT LETTER <u>0</u> LOCATED <u>330</u> FEET FROM THE <u>South</u> LINE AND <u>2310</u> FEET FROM THE <u>East</u> LINE OF SEC. <u>14</u> TWP. <u>24-S</u> RGE. <u>36-E</u> NMPM		12. County Lea	
19. Proposed Depth 3350		19A. Formation Seven Rivers	
20. Rotary or C.T. Rotary		21. Elevations (Show whether DE, RT, etc.) 3340 GR	
21A. Kind & Status Plug. Bond Blanket		21B. Drilling Contractor Norwood Drilling Co.	
22. Approx. Date Work will start			

PROPOSED CASING AND CEMENT PROGRAM

SIZE OF HOLE	SIZE OF CASING	WEIGHT PER FOOT	SETTING DEPTH	SACKS OF CEMENT	EST. TOP
17 1/2"	13 3/8"	48#	40'	Redi-Mix	Surface
12 1/4"	8 5/8"	24#	1300'	650 sxs.	Surface
7 7/8"	5 1/2"	14#	3350'	Determined by Caliper	

To drill and complete as a Jalmat oil well
B.O.P. w/double rams
Rotating head to be on conductor pipe

APPROVAL VALID
FOR 90 DAYS UNLESS
DRILLING COMMENCED,

EXPIRES 4-24-77

IN ABOVE SPACE DESCRIBE PROPOSED PROGRAM: IF PROPOSAL IS TO DEEPEN OR PLUG BACK, GIVE DATA ON PRESENT PRODUCTIVE ZONE AND PROPOSED NEW PRODUCTIVE ZONE. GIVE BLOWOUT PREVENTER PROGRAM, IF ANY.

I hereby certify that the information above is true and complete to the best of my knowledge and belief.

Signed B. J. Knight Title Drilling Coordinator Date 1-21-77
(This space for State Use)

SUPERVISOR DISTRICT

APPROVED BY [Signature] TITLE DATE
CONDITIONS OF APPROVAL, IF ANY:

RECEIVED

JAN 24 1977

OIL CONSERVATION COMM.
HOBBS, N. M.

**NEW MEXICO OIL CONSERVATION COMMISSION
WELL LOCATION AND ACREAGE DEDICATION PLAT**

Form C-102
Supersedes C-128
Effective 1-1-65

All distances must be from the outer boundaries of the Section

Operator TEXAS PACIFIC OIL COMPANY, INC.			Lease S. R. Cooper "A"		Acres 2
Unit Letter 0	Section 14	Township 24 South	Range 36 East	County Lea	
Actual Footage Location of Well: <div style="display: flex; justify-content: space-between; align-items: center;"> 330 feet from the south line and 2310 feet from the east line </div>					
Ground Level Elev. 3340.9	Producing Formation Seven Rivers	Pool Jalmat		Dedicated Acreage 40	

1. Outline the acreage dedicated to the subject well by colored pencil or hachure marks on the plat below.
2. If more than one lease is dedicated to the well, outline each and identify the ownership thereof (both as to working interest and royalty).
3. If more than one lease of different ownership is dedicated to the well, have the interests of all owners been consolidated by communitization, unitization, force-pooling, etc?

☐ Yes ☐ No If answer is "yes," type of consolidation _____

If answer is "no," list the owners and tract descriptions which have actually been consolidated (Use reverse side of this form if necessary.) _____

No allowable will be assigned to the well until all interests have been consolidated (by communitization, unitization, forced-pooling, or otherwise) or until a non-standard unit, eliminating such interests, has been approved by the Commission.

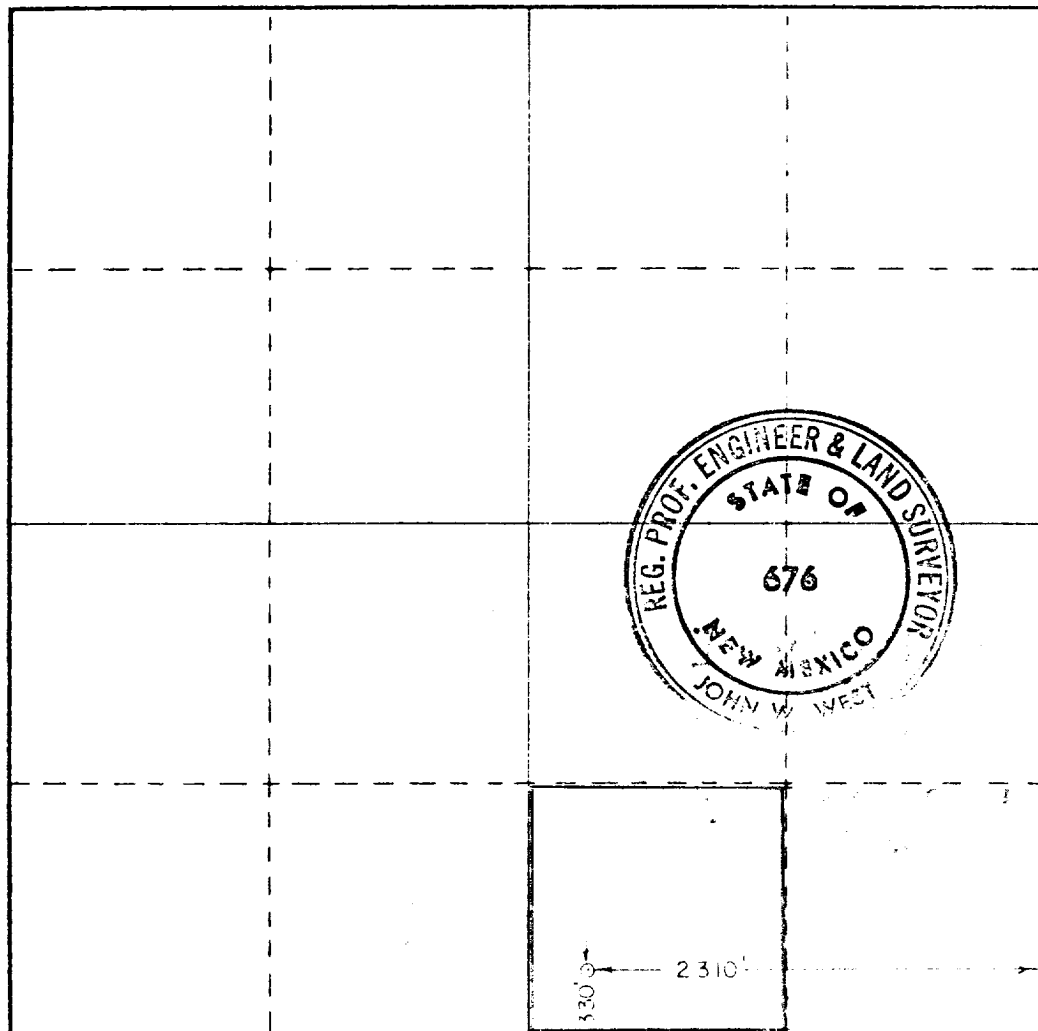

CERTIFICATION

I hereby certify that the information contained herein is true and complete to the best of my knowledge and belief.

B. J. Knight

Name
B. J. Knight

Position
Drilling Coordinator

Company
Texas Pacific Oil Co., Inc.

Date
1/21/77

I hereby certify that the well location shown on this plat was plotted from field notes of actual surveys made by me or under my supervision, and that the same is true and correct to the best of my knowledge and belief.

Date Surveyed

Jan. 19, 1977

Registered Professional Engineer and or Land Surveyor

John W. West

Certificate No.

676

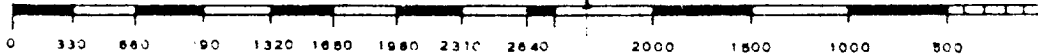

RECEIVED

JAN 24 1977

OIL CONSERVATION COMM.
HOBBS, N. M.

173