

NO. OF COPIES RECEIVED	
DISTRIBUTION	
SANTA FE	
FILE	
U.S.G.S.	
LAND OFFICE	
OPERATOR	

N. EXICO OIL CONSERVATION COMMISSION

Form C-101
Revised 1-1-75

5A. Initial Type of Lease	STATE <input checked="" type="checkbox"/> TEX <input type="checkbox"/>
5. Initial Lease No.	L 3002

APPLICATION FOR PERMIT TO DRILL, DEEPEN, OR PLUG BACK

1a. Type of Work		7. Unit Agreement Name	
b. Type of Well OIL WELL <input checked="" type="checkbox"/> GAS WELL <input type="checkbox"/> OTHER <input type="checkbox"/>		Capitan Oil Pool	
DRILL <input checked="" type="checkbox"/> DEEPEN <input type="checkbox"/> PLUG BACK <input type="checkbox"/>		8. Name of Lessee	
SINGLE ZONE <input type="checkbox"/> MULTIPLE ZONE <input type="checkbox"/>		Quanah Parker	
2. Name of Operator		9. Well No.	
Gifford, Mitchell & Wisenbaker		2	
3. Address of Operator		10. Field No. (If any)	
1280 Midland National Bank Tower Midland, Texas 79701		Undesignated	
4. Location of Well		11. County	
UNIT LETTER 0 - LOCATED 2310 FEET FROM THE East LINE		Lea	
AND 330 FEET FROM THE South LINE OF SEC. 28 T.26-S R.36-E			
21. Elevation (Show whether DT, RT, etc.)		22. Depth of Well	23. Formation
Gr= 2905'	3400'	Yates	Rotary
21A. Kind of casing (log, steel)	21B. Drilling Contractor	22. Approx. Date Work will start	
single well	J. A. Price & Co.	February 20, 1978	

PROPOSED CASING AND CEMENT PROGRAM

SIZE OF HOLE	SIZE OF CASING	WEIGHT PER FOOT	SETTING DEPTH	SACKS OF CEMENT	EST. TOP surface
12 1/4"	8 5/8"	24#	1408'	900	1900'
7 7/8"	5 1/2"	14#	3300'	350	

The Blow Out Preventor Program will consist of one 10" 3000 psi WP double BOP (1 pipe ram, 1 blind ram). The BOP will be installed when 8 5/8" casing is set and cemented.

APPROVAL VALID
FOR 90 DAYS UNLESS
DRILLING COMMENCED,

EXPIRES May 23, 1978

IN ABOVE SPACE DESCRIBE PROPOSED PROGRAM; IF PROPOSAL IS TO DEEPEN OR PLUG BACK, GIVE DATA ON PRESENT PRODUCTIVE ZONE AND PROPOSED NEW PRODUCTIVE ZONE. GIVE BLOWOUT PREVENTER PROGRAM, IF ANY.

I hereby certify that the information above is true and complete to the best of my knowledge and belief.

Signed Richard H. H. H. H. Production Clerk Date 2/15/78

(This space for State Use)

APPROVED BY John W. Runyan TITLE State Engineer DATE FEB 22 1978

CONDITIONS OF APPROVAL, IF ANY:

NEW MEXICO OIL CONSERVATION COMMISSION
WELL LOCATION AND ACREAGE DEDICATION PLAT

Form C-122
Supersedes C-128
Effective 1-1-65

All distances must be from the outer boundaries of the Section.

Operator GIFFORD, MITCHELL & WISENBAKER		Lease QUANAH PARKER		Well No. 2
Unit Letter A	Section 28	Township 26 South	Range 36 East	County Lea
Actual Footage Location of Well: 2970 feet from the south line and 2310 feet from the east line				
Ground Level Elev. 2905'	Producing Formation Yates	Pool Capitan Oil Pool	Dedicated Acreage: 40 Acres	

1. Outline the acreage dedicated to the subject well by colored pencil or hatchure marks on the plat below.
2. If more than one lease is dedicated to the well, outline each and identify the ownership thereof (both as to working interest and royalty).
3. If more than one lease of different ownership is dedicated to the well, have the interests of all owners been consolidated by communitization, unitization, force-pooling, etc?

☐ Yes ☐ No If answer is "yes," type of consolidation _____

If answer is "no," list the owners and tract descriptions which have actually been consolidated. (Use reverse side of this form if necessary.) _____

No allowable will be assigned to the well until all interests have been consolidated (by communitization, unitization, forced-pooling, or otherwise) or until a non-standard unit, eliminating such interests, has been approved by the Commission.

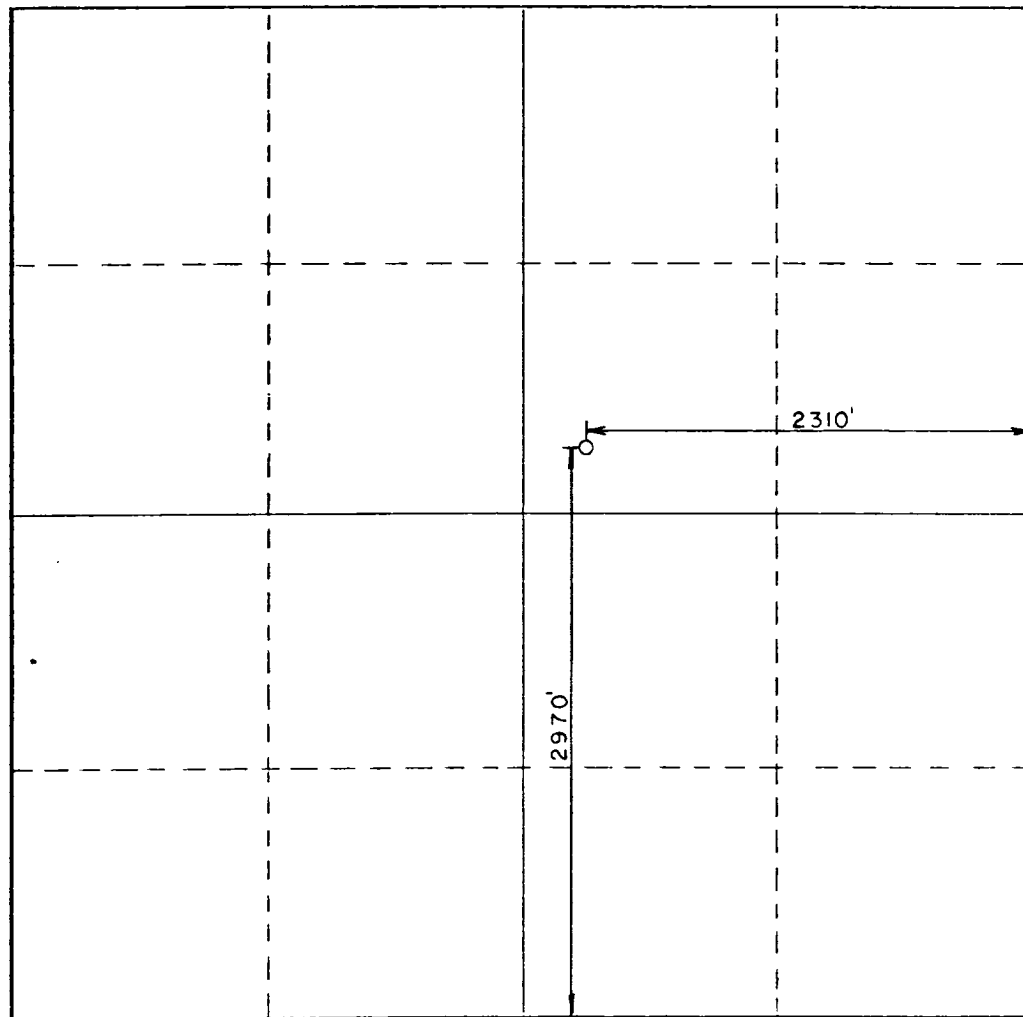

CERTIFICATION

I hereby certify that the information contained herein is true and complete to the best of my knowledge and belief.

Name Gifford, Mitchell & Wisenbaker
Position
Production Clerk
Company
Gifford, Mitchell & Wisenbaker

Date
2/15/78

I hereby certify that the well location shown on this plat was plotted from field notes of actual surveys made by me or under my supervision, and that the same is true and correct to the best of my knowledge and belief.

February 2, 1978

Date Surveyed
Gary N. Hanger
Registered Professional Engineer
and/or Land Surveyor

Gary N. Hanger
Certificate No.
5657