

NO. OF COPIES RECEIVED

## DISTRIBUTION

SANTA FE

FILE

U.S.G.S.

LAND OFFICE

OPERATOR

## NEW MEXICO OIL CONSERVATION COMMISSION

Form C-103  
Supersedes Old  
C-102 and C-103  
Effective 1-1-85

## SUNDRY NOTICES AND REPORTS ON WELLS

(DO NOT USE THIS FORM FOR PROPOSALS TO DRILL OR TO DEEPEN OR PLUG BACK TO A DIFFERENT RESERVOIR.  
USE "APPLICATION FOR PERMIT" (FORM C-101) FOR SUCH PROPOSALS.)

|   |  |  |
|---|--|--|
| 1. OIL WELL <input checked="" type="checkbox"/> GAS WELL <input type="checkbox"/> OTHER <input type="checkbox"/>                            |  | 5a. Indicate Type of Lease<br>State <input checked="" type="checkbox"/> Fee <input type="checkbox"/> |
| 2. Name of Operator<br>O. H. Berry  |  | 5. State Oil & Gas Lease No.<br>L1102  |
| 3. Address of Operator<br>188 One Marienfeld Place, Midland, TX 79701   |  | 7. Unit Agreement Name   |
| 4. Location of Well<br>UNIT LETTER B 800 FEET FROM THE North LINE AND 1650 FEET FROM East THE LINE, SECTION 36 TOWNSHIP 24S RANGE 35E NMPM. |  | 8. Farm or Lease Name<br>Amoco State   |
| 15. Elevation (Show whether DF, RT, GR, etc.)<br>3367' G.R.   |  | 9. Well No.<br>1   |
|   |  | 10. Field and Pool, or Wildcat<br>No Custer Yates Seven-Rivers                                       |
|   |  | 12. County<br>Lea  |

Check Appropriate Box To Indicate Nature of Notice, Report or Other Data  
NOTICE OF INTENTION TO:

SUBSEQUENT REPORT OF:

|  |  |  |   |
|--|--|--|---|
| PERFORM REMEDIAL WORK <input type="checkbox"/> | PLUG AND ABANDON <input checked="" type="checkbox"/> | REMEDIAL WORK <input type="checkbox"/>               | ALTERING CASING <input type="checkbox"/>      |
| TEMPORARILY ABANDON <input type="checkbox"/>   | CHANGE PLANS <input type="checkbox"/>                | COMMENCE DRILLING OPNS. <input type="checkbox"/>     | PLUG AND ABANDONMENT <input type="checkbox"/> |
| PULL OR ALTER CASING <input type="checkbox"/>  | OTHER <input type="checkbox"/>                       | CASING TEST AND CEMENT JOBS <input type="checkbox"/> | OTHER <input type="checkbox"/>                |

17. Describe Proposed or Completed Operations (Clearly state all pertinent details, and give pertinent dates, including estimated date of starting any proposed work) SEE RULE 1103.

The subject well is a non-commercial oil well (1-1/4 BOPD and 5 BWPD) from perforations 3668'-3692' (Capitan Reef). We propose to:

- 1.) Set a C.I.B.P. at 3650' with 100' cement on top
  - 2.) Plug 1600'-1800' top of salt. Recover 5-1/2" casing at top of cement.
  - 3.) 100' plug at stub.
  - 4.) 100' cement plug at shoe 50' in and 50' out.
  - 5.) Cement plug surface to 100'.
- Weld plate and dry hole marker on top of weld.

THE COMMISSION MUST BE NOTIFIED 24 HOURS PRIOR TO THE BEGINNING OF DRILLING OPERATIONS FOR THE C-103 PERMIT.

8. I hereby certify that the information above is true and complete to the best of my knowledge and belief.

SIGNED O. H. Berry TITLE Operator DATE 5-16-85  
ORIGINAL SIGNED BY JERRY SEXTON  
DISTRICT I SUPERVISOR  
APPROVED BY \_\_\_\_\_ TITLE \_\_\_\_\_ DATE MAY 20 1985  
CONDITIONS OF APPROVAL, IF ANY:

**NEW MEXICO OIL CONSERVATION COMMISSION  
WELL LOCATION AND ACREAGE DEDICATION PLAT**

Form C-101  
Superseding C-100  
Effective 1-1-78

All distances must be from the outer boundaries of the Section

|   |                      |                            |                             |                      |                                    |
|---|----------------------|----------------------------|-----------------------------|----------------------|------------------------------------|
| Operator<br><b>O. H. Berry</b>  |                      |                            | Lease<br><b>Amoco State</b> |                      | Well No.<br><b>1</b>               |
| Unit Letter<br><b>B</b>   | Section<br><b>36</b> | Township<br><b>24South</b> | Range<br><b>35East</b>      | County<br><b>Lea</b> |                                    |
| Actual Footage Location of Well:<br><b>800</b> feet from the <b>North</b> line and <b>1650</b> feet from the <b>East</b> line |                      |                            |                             |                      |                                    |
| Ground Level Elev.<br><b>3366.7</b>   | Producing Formation  |                            | Pool                        |                      | Dedicated Acreage:<br><b>Acres</b> |

1. Outline the acreage dedicated to the subject well by colored pencil or hachure marks on the plat below.
2. If more than one lease is dedicated to the well, outline each and identify the ownership thereof (both as to working interest and royalty).
3. If more than one lease of different ownership is dedicated to the well, have the interests of all owners been consolidated by communitization, unitization, force-pooling, etc?

☐ Yes    ☐ No    If answer is "yes," type of consolidation \_\_\_\_\_

If answer is "no," list the owners and tract descriptions which have actually been consolidated. (Use reverse side of this form if necessary.) \_\_\_\_\_

No allowable will be assigned to the well until all interests have been consolidated (by communitization, unitization, forced-pooling, or otherwise) or until a non-standard unit, eliminating such interests, has been approved by the Commission.

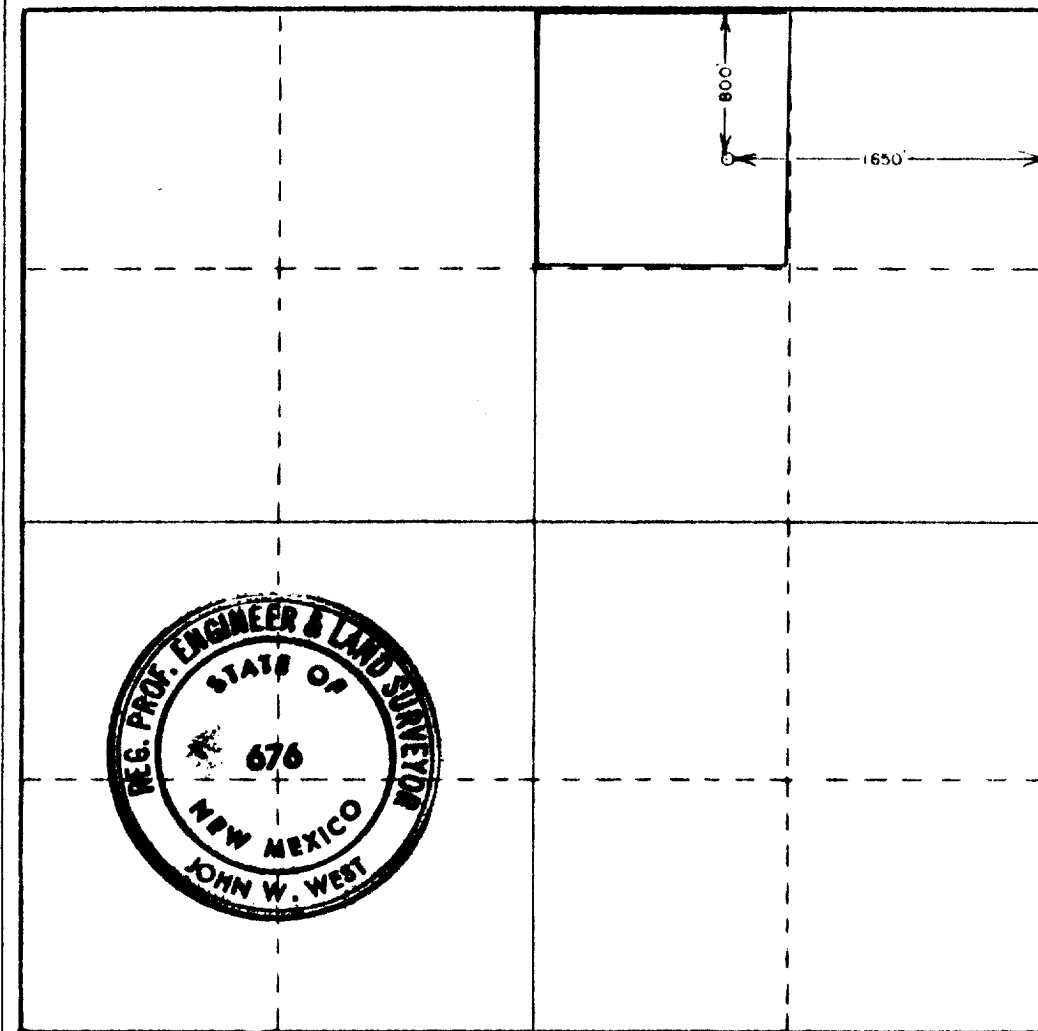

**CERTIFICATION**

I hereby certify that the information contained herein is true and complete to the best of my knowledge and belief.

**B. W. Roberts**

Name

Agent

Position

**O. H. Berry**

Company

**31 May 1978**

Date

I hereby certify that the well location shown on this plat was plotted from field notes of actual surveys made by me or under my supervision, and that the same is true and correct to the best of my knowledge and belief.

Date Surveyed

**May 27, 1978**

Registered Professional Engineer  
and/or Land Surveyor

*John W. West*

Certificate No. **John W. West**

**676**

**Ronald J. Eldon 3239**

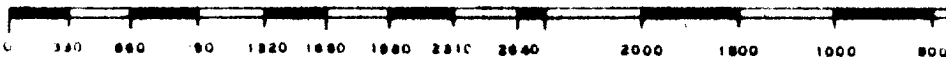

**RECEIVED**

**MAY 20 1985**

**O.C.D.  
HOBBS CRIME**