

COPIES RECEIVED	
TRIBUTION	
AT FE	
FILE	
U.S.G.S.	
LAND OFFICE	
OPERATOR	

NEW MEXICO OIL CONSERVATION COMMISSION

Form C-103
Supersedes Old
C-102 and C-103
Effective 1-1-65

5a. Indicate Type of Lease	
State <input checked="" type="checkbox"/>	Fee <input type="checkbox"/>
5. State Oil & Gas Lease No.	
L-1102	

SUNDRY NOTICES AND REPORTS ON WELLS (DO NOT USE THIS FORM FOR PROPOSALS TO DRILL OR TO DEEPEN OR PLUG BACK TO A DIFFERENT RESERVOIR. USE "APPLICATION FOR PERMIT -" (FORM C-101) FOR SUCH PROPOSALS.)

1. OIL WELL <input checked="" type="checkbox"/> GAS WELL <input type="checkbox"/> OTHER- <input type="checkbox"/>		7. Unit Agreement Name
2. Name of Operator O. H. Berry		8. Farm or Lease Name Amoco-State
3. Address of Operator 188 One Marienfeld Place, Midland, Texas 79701		9. Well No. 1
4. Location of Well UNIT LETTER B 800 FEET FROM THE North LINE AND 1650 FEET FROM THE East LINE, SECTION 36 TOWNSHIP 24 RANGE 35 NMPM.		10. Field and Pool, or Wildcat
15. Elevation (Show whether DF, RT, GR, etc.) 3366.7		12. County Lea

Check Appropriate Box To Indicate Nature of Notice, Report or Other Data

NOTICE OF INTENTION TO:

PERFORM REMEDIAL WORK ☐
TEMPORARILY ABANDON ☐
PULL OR ALTER CASING ☐
OTHER ☐

PLUG AND ABANDON ☒
CHANGE PLANS ☐
OTHER ☐

SUBSEQUENT REPORT OF:

REMEDIAL WORK ☐
COMMENCE DRILLING OPNS. ☐
CASING TEST AND CEMENT JOBS ☐
OTHER ☐

ALTERING CASING ☐
PLUG AND ABANDONMENT ☐
OTHER ☐

17. Describe Proposed or Completed Operations (Clearly state all pertinent details, and give pertinent dates, including estimated date of starting any proposed work) SEE RULE 1103.

Drilled to 207' and mudded in 8-5/8", continued drilling to 700'; did not encounter Santa Rosa water.

18. I hereby certify that the information above is true and complete to the best of my knowledge and belief.

SIGNED O. H. Berry TITLE Operator DATE 4 August 1978

APPROVED BY Jerry Beason TITLE SUPERVISOR DISTRICT 1 DATE AUG 9 1978

CONDITIONS OF APPROVAL, IF ANY:

RECEIVED

AUG 8 1978

OIL CONSERVATION TEAM
ROBBS, H. M.

NEW MEXICO OIL CONSERVATION COMMISSION
WELL LOCATION AND ACREAGE DEDICATION PLAT

Form C-102
Supersedes C-128
Effective 1-1-65

All distances must be from the outer boundaries of the Section

Operator O.H. Berry		Lease Amoco State		Well No. 1
Section B	Section 36	Township 24South	Range 35East	County Lea
Area, Fixing Location of Well: 800 feet from the North line and 1650 feet from the East line				
Ground Level Elev. 3366.7	Producing Formation	Pool	Dedicated Acreage: Acres	

1. Outline the acreage dedicated to the subject well by colored pencil or hachure marks on the plat below.
2. If more than one lease is dedicated to the well, outline each and identify the ownership thereof (both as to working interest and royalty).
3. If more than one lease of different ownership is dedicated to the well, have the interests of all owners been consolidated by communitization, unitization, force-pooling, etc?

☐ Yes ☐ No If answer is "yes," type of consolidation _____

If answer is "no," list the owners and tract descriptions which have actually been consolidated. (Use reverse side of this form if necessary.) _____

No allowable will be assigned to the well until all interests have been consolidated (by communitization, unitization, forced-pooling, or otherwise) or until a non-standard unit, eliminating such interests, has been approved by the Commission.

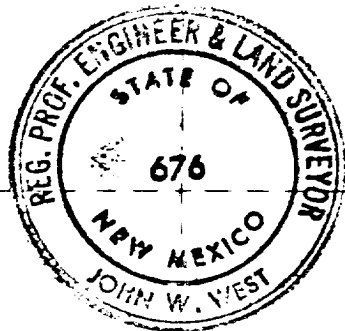
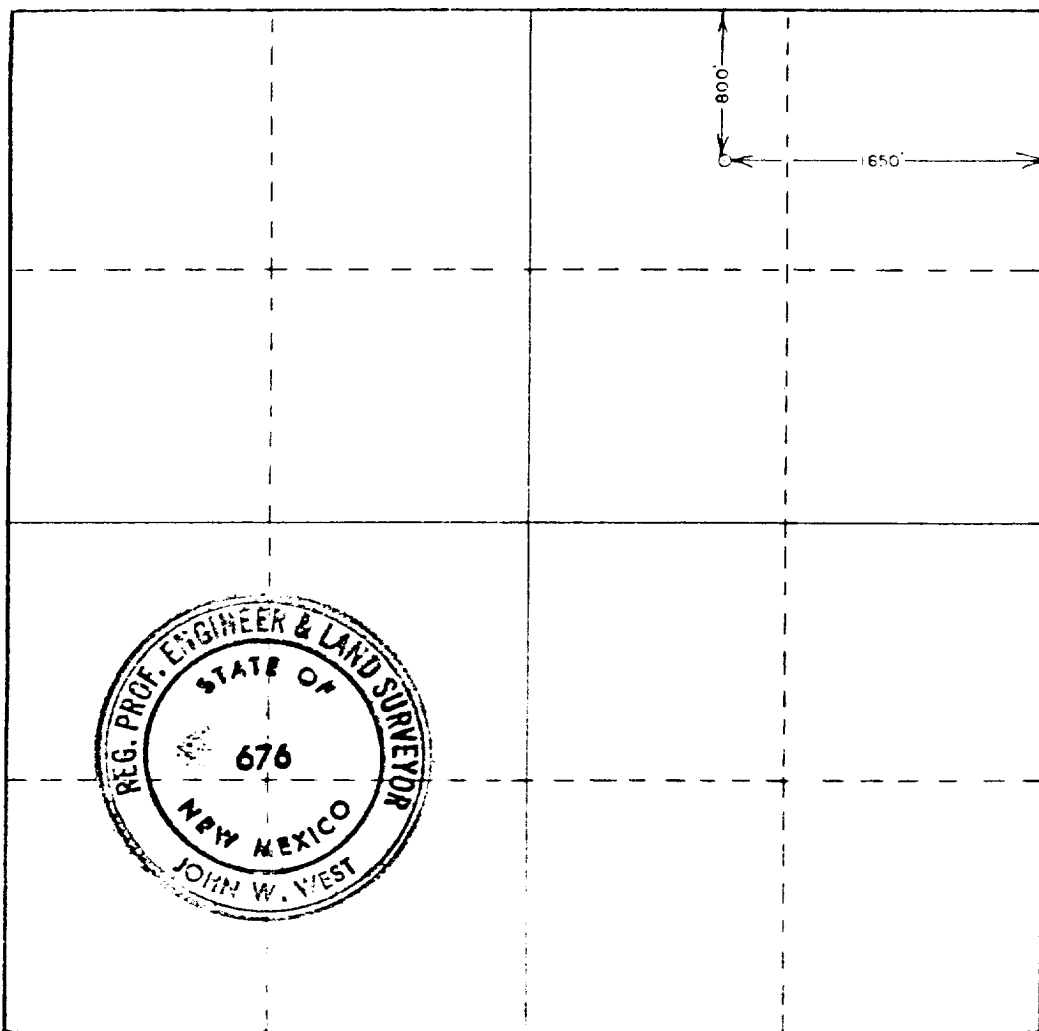

CERTIFICATION

I hereby certify that the information contained herein is true and complete to the best of my knowledge and belief.

B. W. Roberts

Name

Agent

Position

O. H. Berry

Company

31 May 1978

Date

I hereby certify that the well location shown on this plat was plotted from field notes of actual surveys made by me or under my supervision, and that the same is true and correct to the best of my knowledge and belief.

Date Surveyed

May 27, 1978

Registered Professional Engineer and/or Land Surveyor

John W. West

Certificate No. **John W. West**

676

Boyd J. Elders

2272

RECEIVED

AUG 8 1978

OIL COMPANY
DUNSMITH, N. H.