

UNITED STATES
DEPARTMENT OF THE INTERIOR
GEOLOGICAL SURVEY

APPLICATION FOR PERMIT TO DRILL, DEEPEN, OR PLUG BACK

1a. TYPE OF WORK

DRILL ☒DEEPEN ☐PLUG BACK ☐

b. TYPE OF WELL

OIL
WELL ☒GAS
WELL ☐OTHER ☐SINGLE
ZONE ☐MULTIPLE
ZONE ☐

2. NAME OF OPERATOR

HNG Oil Company

3. ADDRESS OF OPERATOR

P.O. Box 2267, Midland, Texas 79702

4. LOCATION OF WELL (Report location clearly and in accordance with any State requirements.)*

At surface

990' FWL 1700' FNL of Section 21, Township 26S, Range 36E

At proposed prod. zone

Same

14. DISTANCE IN MILES AND DIRECTION FROM NEAREST TOWN OR POST OFFICE*

7 miles S/W of Jal, New Mexico

10. DISTANCE FROM PROPOSED*

LOCATION TO NEAREST

PROPERTY OR LEASE LINE, FT.

(Also to nearest drlg. unit line, if any)

990'

18. DISTANCE FROM PROPOSED LOCATION*

TO NEAREST WELL, DRILLING, COMPLETED,
OR APPLIED FOR, ON THIS LEASE, FT.

1034'

16. NO. OF ACRES IN LEASE

320

19. PROPOSED DEPTH

3300

17. NO. OF ACRES ASSIGNED

TO THIS WELL

40

20. ROTARY OR CABLE TOOLS

Rotary

21. ELEVATIONS (Show whether DF, RT, GR, etc.)

2934' GR

22. APPROX. DATE WORK WILL START*

12-27-78

23.

PROPOSED CASING AND CEMENTING PROGRAM

SIZE OF HOLE	SIZE OF CASING	WEIGHT PER FOOT	SETTING DEPTH	QUANTITY OF CEMENT
12 1/4"	9-5/8"	36 lbs.	800'	600 sacks
8-3/4"	7"	20 lbs.	3300'	1000 sacks

Pressure Control Program:

A double blow-out preventer and rotating head w/a choke manifold will be installed at the 9-5/8" casing setting point. The drill string will be equipped with a safety valve. All equipment will be tested to 3000 lbs. after installation.

DRILLING OPERATIONS AUTHORIZED ARE
SUBJECT TO COMPLIANCE WITH ATTACHED
"GENERAL REQUIREMENTS"

IN ABOVE SPACE DESCRIBE PROPOSED PROGRAM: If proposal is to deepen or plug back, give data on present productive zone and proposed new productive zone. If proposal is to drill or deepen directionally, give pertinent data on subsurface locations and measured and true vertical depths. Give blowout preventer program, if any.

24. Betty A. Gildon Betty A. Gildon TITLE Regulatory Clerk DATE 9/18/78

(This space for Federal or State office use)

PERMIT NO. _____

APPROVAL DATE _____

APPROVED BY _____

TITLE _____

CONDITIONS OF APPROVAL, IF ANY: _____

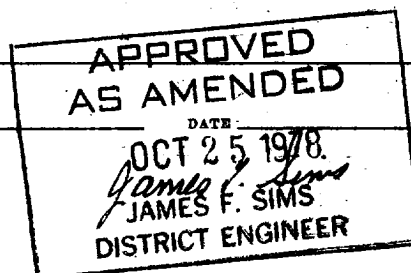

*See Instructions On Reverse Side

RECEIVED

OCT 31 1978

CONSERVATION COMM.
OCT 14 62

NEW MEXICO OIL CONSERVATION COMMISSION
WELL LOCATION AND ACREAGE DEDICATION PLAT

Form C-102
Supersedes C-126
Effective 1-1-65

All distances must be from the outer boundaries of the Section.

Operator H. N. G. OIL COMPANY			Lease Wilson 21 Federal		Well No. 6
Unit Letter	Section 21	Township 26-S	Range 36-E	County Lea	
Actual Footage Location of Well: 1700 feet from the North line and 990' feet from the West line					
Ground Level Elev. 2934'	Producing Formation <i>Gates</i>		Pool <i>Comanche State Line</i>	Dedicated Acreage: 40 Acres	

1. Outline the acreage dedicated to the subject well by colored pencil or hatchure marks on the plat below.
2. If more than one lease is dedicated to the well, outline each and identify the ownership thereof (both as to working interest and royalty).
3. If more than one lease of different ownership is dedicated to the well, have the interests of all owners been consolidated by communitization, unitization, force-pooling, etc?

☐ Yes ☐ No If answer is "yes," type of consolidation _____

If answer is "no," list the owners and tract descriptions which have actually been consolidated. (Use reverse side of this form if necessary.) _____

No allowable will be assigned to the well until all interests have been consolidated (by communitization, unitization, forced-pooling, or otherwise) or until a non-standard unit, eliminating such interests, has been approved by the Commission.

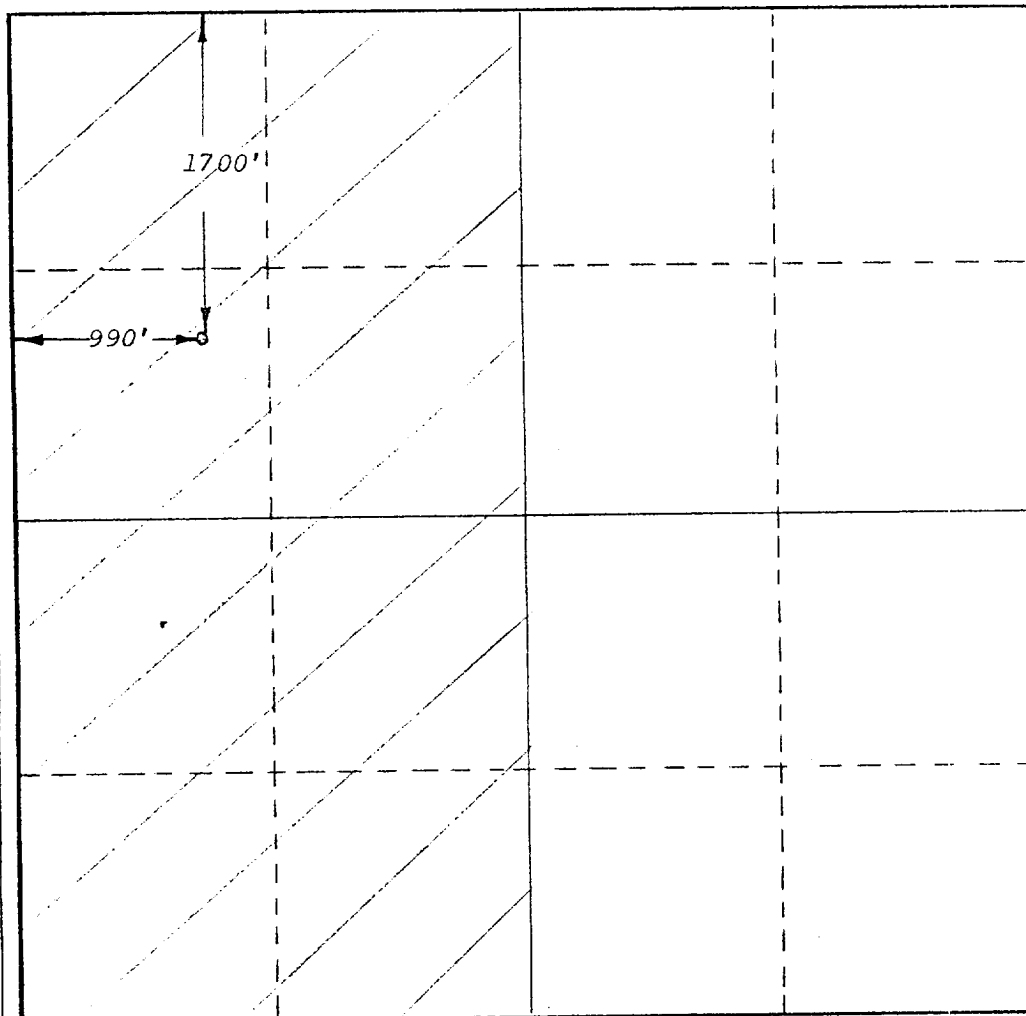

CERTIFICATION

I hereby certify that the information contained herein is true and complete to the best of my knowledge and belief.

Name: *Betty A. Seiden*
 Position: *Regulatory Clerk*
 Company: *HNB Oil Company*
 Date: *9-19-78*

I hereby certify that the well location shown on this plat was plotted from field notes of actual surveys made by me or under my supervision, and that the same is true and correct to the best of my knowledge and belief.

NEW MEXICO
 September 7, 1978
 Date Employed
Gary D. Boswell
 Registered Professional Engineer
 and/or Land Surveyor
NO. 6689
Gary D. Boswell
 Certified LAND SURVEYOR
6689

0 330 660 990 1320 1650 1980 2310 2640 2000 1500 1000 500 0

ALL INFORMATION CONTAINED
HEREIN IS UNCLASSIFIED

DATE 11/18/78
BY CONSERVATION COMM.
11/18/78