

Submit to Appropriate
District Office
State Lease - 6 copies
Fee Lease - 5 copies

State of New Mexico
Energy, Minerals and Natural Resources Department

Form C-101
Revised 1-1-89

OIL CONSERVATION DIVISION

DISTRICT I
P.O. Box 1980, Hobbs, NM 88240

DISTRICT II
P.O. Drawer DD, Artesia, NM 88210

DISTRICT III
1000 Rio Brazos Rd., Aztec, NM 87410

P.O. Box 2088
Santa Fe, New Mexico 87504-2088

API NO. (assigned by OCD on New Wells)

30-025-26369

5. Indicate Type of Lease

STATE ☐

FEE ☒

6. State Oil & Gas Lease No.

APPLICATION FOR PERMIT TO DRILL, DEEPEN, OR PLUG BACK

1a. Type of Work:

DRILL ☐

RE-ENTER ☐

DEEPEN ☐

PLUG BACK ☒

b. Type of Well:

OIL
WELL ☐

GAS
WELL ☒

OTHER

SINGLE
ZONE ☒

MULTIPLE
ZONE ☐

7. Lease Name or Unit Agreement Name

Government L Com.

2. Name of Operator

Enron Oil & Gas Company

8. Well No.

2

3. Address of Operator

P. O. Box 2267, Midland, Texas 79702

9. Pool name or Wildcat *West Pitchfork*
Bell Lake, South Ranch-Atoka

4. Well Location

Unit Letter K : 1980 Feet From The south Line and 1800 Feet From The west Line

Section 18 Township 24S Range 34E NMPM Lea County

10. Proposed Depth
PBD 13,735

11. Formation
Atoka

12. Rotary or C.T.
-

13. Elevations (Show whether DF, RT, GR, etc.)

3573' GR

14. Kind & Status Plug. Bond

Blanket-Active

15. Drilling Contractor

-

16. Approx. Date Work will start

When permitted

17. PROPOSED CASING AND CEMENT PROGRAM

SIZE OF HOLE	SIZE OF CASING	WEIGHT PER FOOT	SETTING DEPTH	SACKS OF CEMENT	EST. TOP
	20"	94#	61'		
17-1/2"	13-3/8"	48#	608'	575 sacks	circulated
12-1/4"	10-3/4"	55.5# & 60.7#	5500'	1275 sacks	600'
9-7/8"	7-5/8"	33.7, 26.4 & 29.7#	12800'	630 sacks	10800'
6-1/2"	5-1/2" Liner	23#	14108'	270 sacks	12491'
4-1/2"	3-1/2" Liner	10.3#	14696'	56 sacks	13781'

PLUG-BACK PROCEDURE:

TIH w/3-1/2" CIBP and set at 14,350'. Dump 35 feet of cement on top.

TIH w/5-1/2" CIBP and set at 13,770'. Dump 35 feet of cement on top.

Morrow perfs 14,401' - 14,446'

TIH w/seal assembly, SN & 2-7/8" 6.5# N-80 nulock tubing. Test in hole to 10,000 psi.

Perf Atoka 13,496-13,508 & 13,514-13,530' w/1 spf, total of 30-0.33" holes. Flow test.

If necessary, acidize Atoka w/3000 gals 15% NeFe + additives, and flow test.

IN ABOVE SPACE DESCRIBE PROPOSED PROGRAM: IF PROPOSAL IS TO DEEPEN OR PLUG BACK, GIVE DATA ON PRESENT PRODUCTIVE ZONE AND PROPOSED NEW PRODUCTIVE ZONE. GIVE BLOWOUT PREVENTER PROGRAM, IF ANY.

I hereby certify that the information above is true and complete to the best of my knowledge and belief.

SIGNATURE Betty Gildon TITLE Regulatory Analyst DATE 2/6/89

TYPE OR PRINT NAME Betty Gildon TELEPHONE NO. _____

(This space for State Use)

ORIGINAL SIGNED BY JERRY SEXTON
DISTRICT I SUPERVISOR

APPROVED BY _____ TITLE _____ DATE _____

CONDITIONS OF APPROVAL, IF ANY:

Permit Expires 6 Months From Approval
Date Unless Drilling Underway

FEB 08 1989

RECEIVED

FEB 7 1989

**JCB
HOBBS OFFICE**

Submit to Appropriate
District Office
State Lease - 4 copies
Fee Lease - 3 copies

State of New Mexico
Energy, Minerals and Natural Resources Department

Form C-102
Revised 1-1-89

OIL CONSERVATION DIVISION

DISTRICT I
P.O. Box 1980, Hobbs, NM 88240

P.O. Box 2088

Santa Fe, New Mexico 87504-2088

DISTRICT II
P.O. Drawer DD, Artesia, NM 88210

DISTRICT III
1000 Rio Brazos Rd., Aztec, NM 87410

WELL LOCATION AND ACREAGE DEDICATION PLAT

All Distances must be from the outer boundaries of the section

Operator Enron Oil & Gas Company			Lease Government L Com.		Well No. 2
Unit Letter K	Section 18	Township 24S	Range 34E	County Lea	
Actual Footage Location of Well: 1980 feet from the south line and 1800 feet from the west line					
Ground level Elev. 3573.1' GR	Producing Formation Atoka		Pool Bell Lake, South	Dedicated Acreage: $W\frac{1}{2}$ 320 Acres	

1. Outline the acreage dedicated to the subject well by colored pencil or hatchure marks on the plat below.
2. If more than one lease is dedicated to the well, outline each and identify the ownership thereof (both as to working interest and royalty).
3. If more than one lease of different ownership is dedicated to the well, have the interest of all owners been consolidated by communitization, unitization, force-pooling, etc.?
☒ Yes ☐ No If answer is "yes" type of consolidation Communitization
If answer is "no" list the owners and tract descriptions which have actually been consolidated. (Use reverse side of this form if necessary.)
No allowable will be assigned to the well until all interests have been consolidated (by communitization, unitization, forced-pooling, or otherwise) or until a non-standard unit, eliminating such interest, has been approved by the Division.

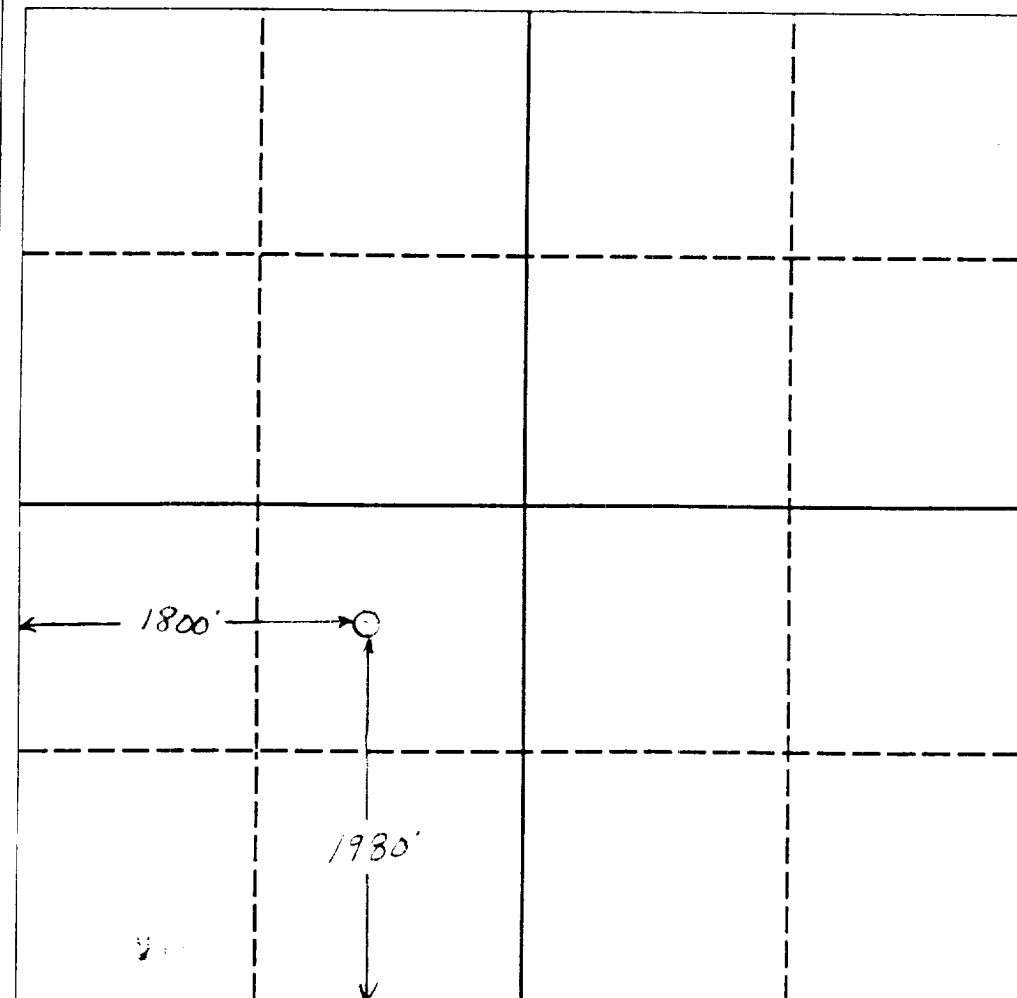

OPERATOR CERTIFICATION

I hereby certify that the information contained herein is true and complete to the best of my knowledge and belief.

Signature
Betty Gildon
Printed Name
Betty Gildon
Position
Regulatory Analyst
Company
Enron Oil & Gas Company
Date
2/6/89

SURVEYOR CERTIFICATION

I hereby certify that the well location shown on this plat was plotted from field notes of actual surveys made by me or under my supervision, and that the same is true and correct to the best of my knowledge and belief.

Date Surveyed
SEE ATTACHED
Signature & Seal of
Professional Surveyor

Certificate No.