

**(T W ME) OIL CONSERVATION COMM (ON
WELL LOCATION AND ACREAGE DEDICATION PLA**

Form C-102
Supersedes C-128
Effective 1-1-65

All distances must be from the outer boundaries of the Section

Operator Maralo Inc.		Lease Maralo 16		Well No. 3
Tract Letter C	Section 16	Township 26 South	Range 36 East	County Lea
Actual Well Location of Well:				
660	feet from the North	line and	1980	feet from the West
Ground Level Elev 2949.3	Producing Formation Tansill Yates 7 Rivers	Pools Sioux Yates Pool	Dedicated Acreage 40	

1. Outline the acreage dedicated to the subject well by colored pencil or hatchure marks on the plat below.
2. If more than one lease is dedicated to the well, outline each and identify the ownership thereof both as to working interest and royalty.
3. If more than one lease of different ownership is dedicated to the well, have the interests of all owners been consolidated by communitization, unitization, force-pooling, etc?

☐ Yes ☐ No If answer is "yes," type of consolidation _____

If answer is "no," list the owners and tract descriptions which have actually been consolidated. (Use reverse side of this form if necessary.) _____

No allowable will be assigned to the well until all interests have been consolidated (by communitization, unitization, forced-pooling, or otherwise) or until a non-standard unit, eliminating such interests, has been approved by the Commission.

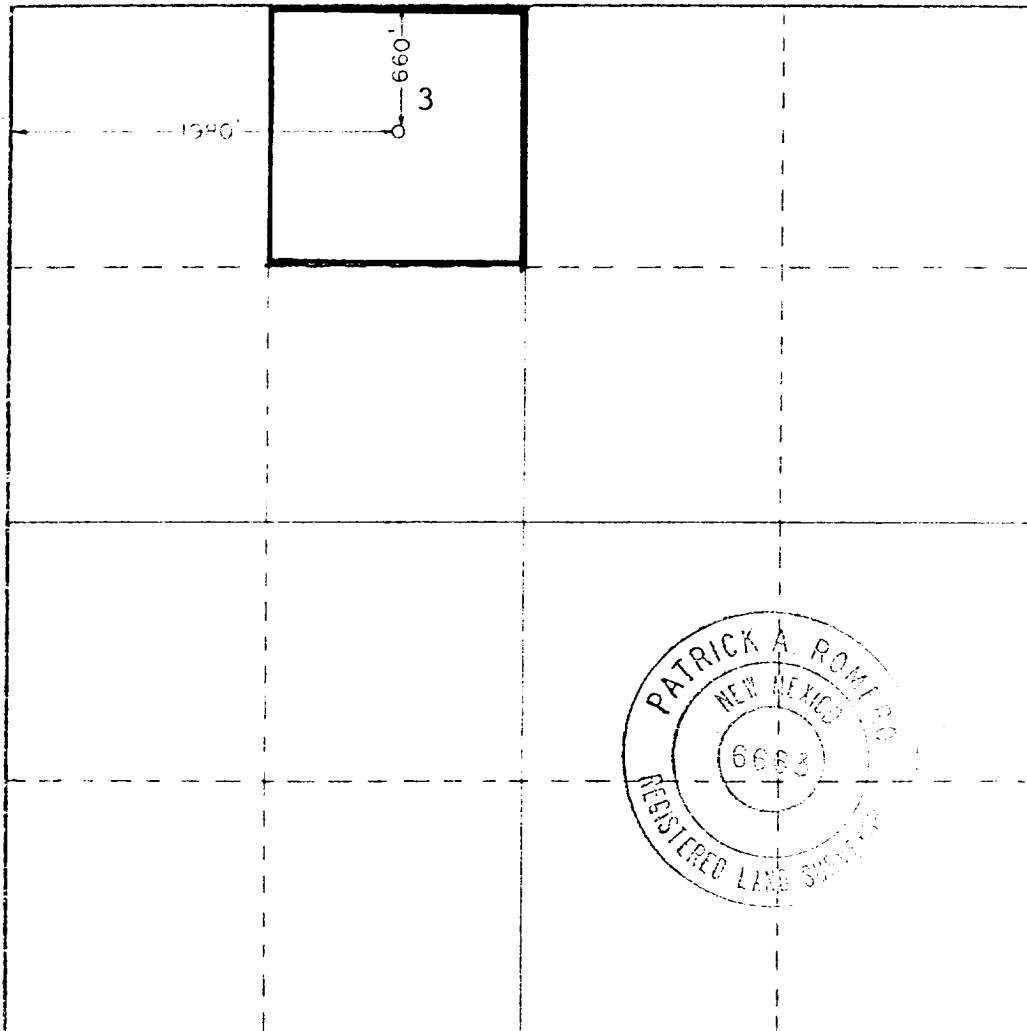

CERTIFICATION

I hereby certify that the information contained herein is true and complete to the best of my knowledge and belief.

Jan Davis

Name
Jan Davis

Position
Production Clerk

Company
Maralo, Inc.

Date
January 21, 1980

I hereby certify that the well location shown on this plat was plotted from field notes of actual surveys made by me or under my supervision, and that the same is true and correct to the best of my knowledge and belief.

Date Surveyed
January 15, 1980

Registered Professional Engineer
and Registered Surveyor

Patrick A. Romero

Certificate No. **JOHN W. WEST 673**
PATRICK A. ROMERO 6663
Ronald J. Eidson 3239

