

NEW MEXICO OIL CONSERVATION COMMISSION
WELL LOCATION AND ACREAGE DEDICATION AT

Form C-102
Supersedes C-128
Effective 1-1-65

All distances must be from the outer boundaries of the Section.

Operator H.N.G. OIL COMPANY		Lease Wilson Federal 17		Well No. 3
Unit Letter P	Section 17	Township 26-S	Range 36-E	County Lea
Actual Footage Location of Well:				
660' feet from the South line and		660' feet from the East line		
Ground Level Elev. 2935'	Producing Formation Yates	Pool Sioux	Dedicated Acreage: 40 Acres	

1. Outline the acreage dedicated to the subject well by colored pencil or hatchure marks on the plat below.
2. If more than one lease is dedicated to the well, outline each and identify the ownership thereof (both as to working interest and royalty).
3. If more than one lease of different ownership is dedicated to the well, have the interests of all owners been consolidated by communitization, unitization, force-pooling, etc?

☐ Yes ☐ No If answer is "yes," type of consolidation _____

If answer is "no," list the owners and tract descriptions which have actually been consolidated. (Use reverse side of this form if necessary.) _____

No allowable will be assigned to the well until all interests have been consolidated (by communitization, unitization, forced-pooling, or otherwise) or until a non-standard unit, eliminating such interests, has been approved by the Commission.

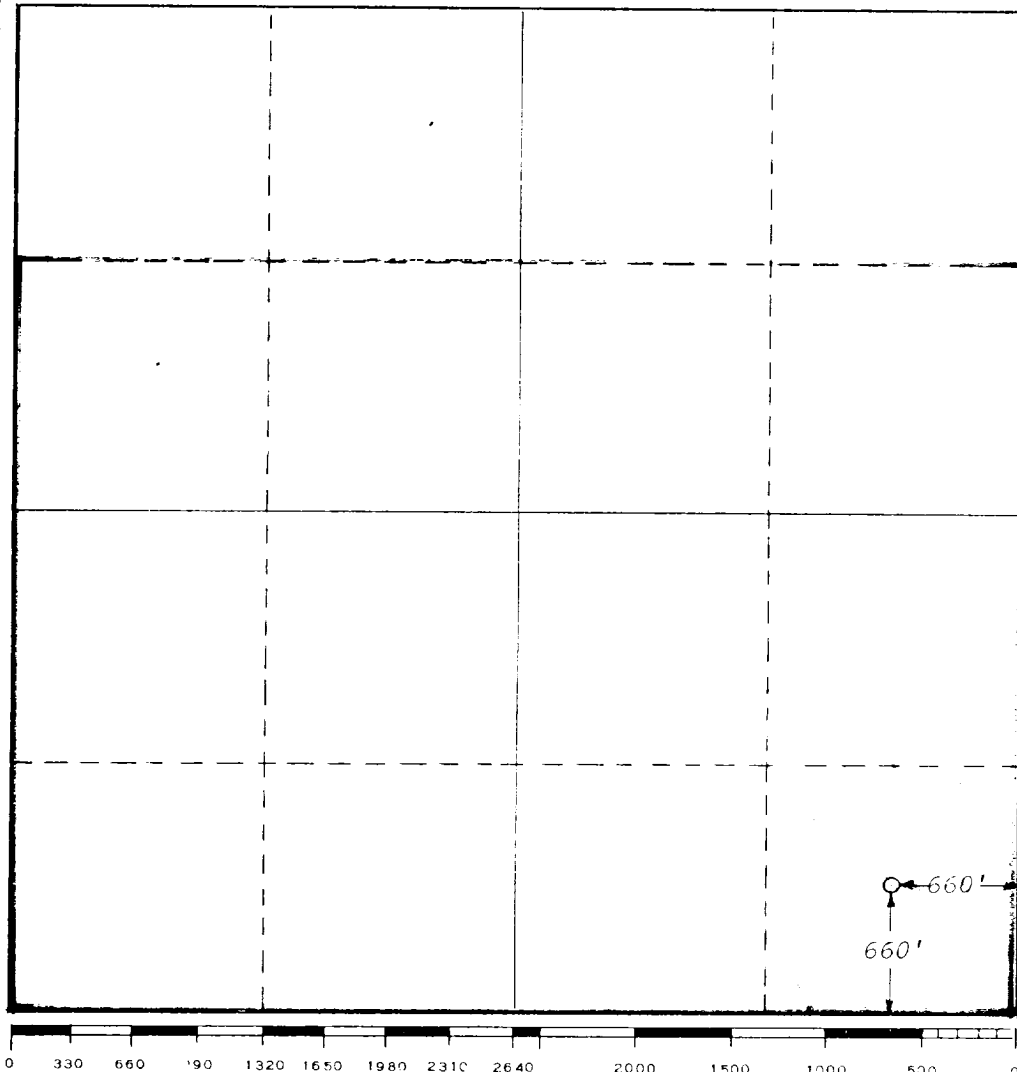

CERTIFICATION

I hereby certify that the information contained herein is true and complete to the best of my knowledge and belief.

Betty A. Gildon

Name
Betty A. Gildon

Position
Regulatory Clerk

Company
HNG Oil Company

Date
April 16, 1980

I hereby certify that the well location shown on this plat was plotted from field notes of actual surveys made by me or under my supervision, and that the same is true and correct to the best of my knowledge and belief.

March 21, 1980

Date Surveyed
Gary D. Boswell

Registered Professional Engineer
and/or Land Surveyor

Gary D. Boswell

Certificate No.
6689