

NO. OF COPIES RECEIVED	
DISTRIBUTION	
SANTA FE	
FILE	
U.S.G.S.	
LAND OFFICE	
OPERATOR	

# NEW MEXICO OIL CONSERVATION COMMISSION

Form C-103  
Supersedes Old  
C-102 and C-103  
Effective 1-1-65

**SUNDRY NOTICES AND REPORTS ON WELLS**  
(DO NOT USE THIS FORM FOR PROPOSALS TO DRILL OR TO REFINISH WELLS BACK TO A DIFFERENT RESERVOIR. USE APPLICATION FOR REFINISH WELLS (FORM C-101) FOR SUCH PROPOSALS.)

OIL WELL ☐ GAS WELL ☒ OTHER ☐

2. Name of Operator  
The Superior Oil Company

3. Address of Operator  
P.O. Box 3901, Midland, Texas 79702

4. Location of Well  
UNIT LETTER H 1980 FEET FROM THE North LINE AND 800 FEET FROM South Bell Lake  
THE East LINE, SECTION 13 TOWNSHIP 24S RANGE 33E NMPM.

5a. Indicate Type of Lease  
State ☐ Fee ☒

5. State Oil & Gas Lease No.

7. Unit Agreement Name

8. Farm or Lease Name  
Sims

9. Well No.  
1

10. Field and Pool, or Wildcat  
South Bell Lake

12. County  
Lea

15. Elevation (Show whether DF, RT, GR, etc.)  
3601.2 KB, 3580' GR

16. Check Appropriate Box To Indicate Nature of Notice, Report or Other Data

NOTICE OF INTENTION TO:		SUBSEQUENT REPORT OF:	
PERFORM REMEDIAL WORK <input type="checkbox"/>	PLUG AND ABANDON <input type="checkbox"/>	REMEDIAL WORK <input type="checkbox"/>	ALTERING CASING <input type="checkbox"/>
TEMPORARILY ABANDON <input type="checkbox"/>	CHANGE PLANS <input type="checkbox"/>	COMMENCE DRILLING OPNS. <input type="checkbox"/>	PLUG AND ABANDONMENT <input type="checkbox"/>
PULL OR ALTER CASING <input type="checkbox"/>	OTHER <input type="checkbox"/> Plug back & Perf. middle morrow.	CASING TEST AND CEMENT JOB <input type="checkbox"/>	
		OTHER <input type="checkbox"/>	

17. Describe Proposed or Completed Operations (Clearly state all pertinent details, and give pertinent dates, including estimated date of starting any proposed work) SEE RULE 1193.

- Kill well w/9 PPG brine, NU BOP & test.
- Mill over & retrieve pkr.
- Set 15.10 # CIBP @ 14,625 w/20' cmt on top.
- Perf. @ 14,502' - 14,510', 14,546' - 14,572' and 14,580' - 14,592'.
- Restore well to production.

18. I hereby certify that the information above is true and complete to the best of my knowledge and belief.

SIGNED G. E. Tate G. E. Tate TITLE Production Superintendent DATE 3/2/82

APPROVED BY JERRY SEXTON TITLE  DATE APR 2 1982

CONDITIONS OF APPROVAL: 15122

RECEIVED

APR 1 1982

O.C.D.  
HOBBS OFFICE

NE 30 OIL CONSERVATION COMMISS'  
WELL LOCATION AND ACREAGE DEDICATION PLAT

Form C-102  
Superseded C-128  
Effective 1-1-65

All distances must be from the outer boundaries of the Section

Operator <b>The Superior Oil Co.</b>			Lease <b>Sims</b>		Well No. <b>1</b>
Unit Letter <b>H</b>	Section <b>13</b>	Township <b>24 South</b>	Range <b>33 East</b>	County <b>Lea</b>	
Actual Footage Location of Well: <b>1980</b> feet from the <b>North</b> line and <b>800</b> feet from the <b>East</b> line					
Ground Level Elev. <b>3580.3</b>	Producing Formation <b>Morrow</b>	Pool <b>South Bell Lake</b>		Dedicated Acreage: <b>320</b> Acres	

1. Outline the acreage dedicated to the subject well by colored pencil or hachure marks on the plat below.
2. If more than one lease is dedicated to the well, outline each and identify the ownership thereof (both as to working interest and royalty).
3. If more than one lease of different ownership is dedicated to the well, have the interests of all owners been consolidated by communitization, unitization, force-pooling, etc?

☐ Yes ☐ No If answer is "yes," type of consolidation \_\_\_\_\_

If answer is "no," list the owners and tract descriptions which have actually been consolidated. (Use reverse side of this form if necessary.) \_\_\_\_\_

No allowable will be assigned to the well until all interests have been consolidated (by communitization, unitization, forced-pooling, or otherwise) or until a non-standard unit, eliminating such interests, has been approved by the Commission.

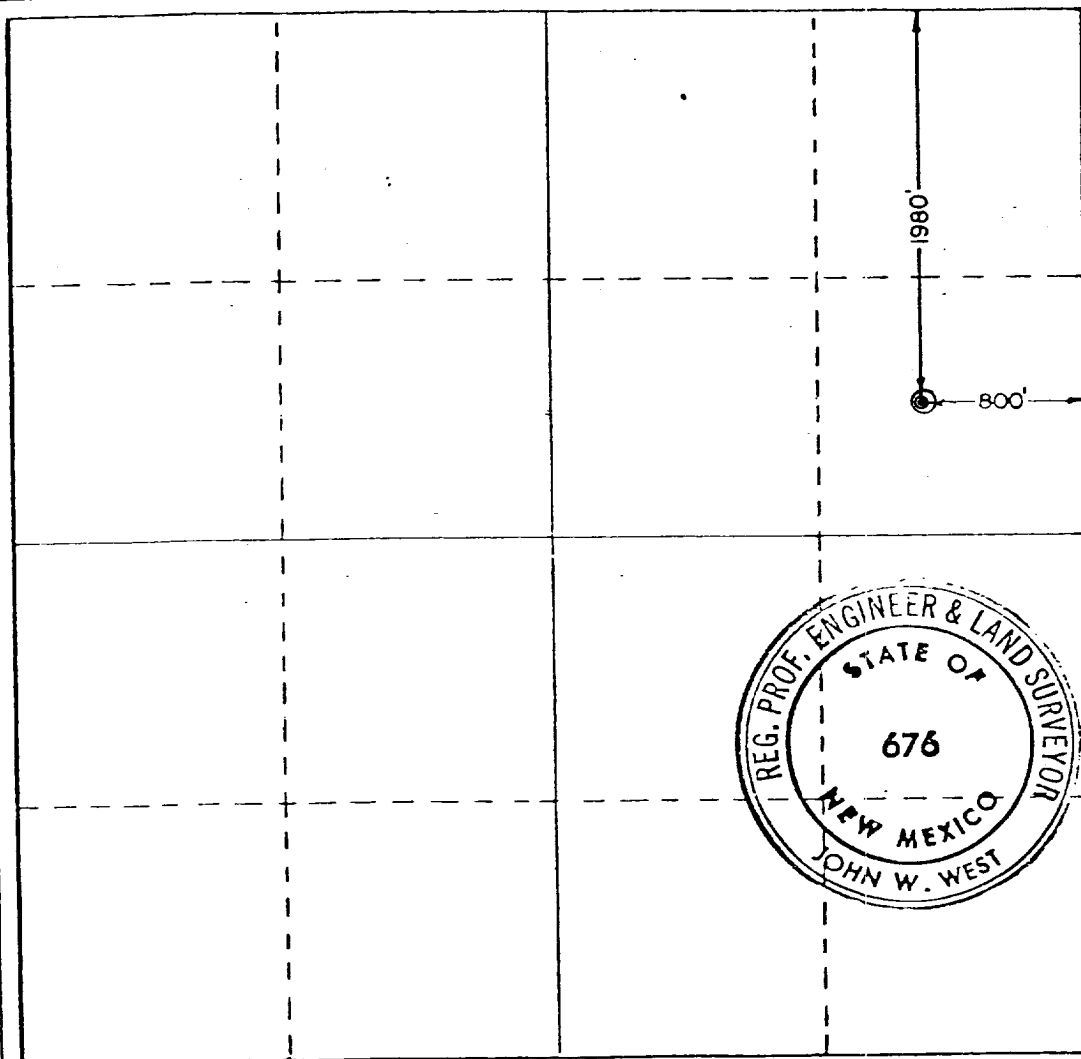

CERTIFICATION

I hereby certify that the information contained herein is true and complete to the best of my knowledge and belief.

*G. E. Tate*  
Name

**G. E. Tate**  
Position  
Production Superintendent

Company  
**The Superior Oil Company**

Date  
**3/29/82**

I hereby certify that the well location shown on this plat was plotted from field notes of actual surveys made by me or under my supervision, and that the same is true and correct to the best of my knowledge and belief.

Date Surveyed  
**June 30, 1980**

Registered Professional Engineer and/or Land Surveyor

*John W. West*

Certificate No **JOHN W. WEST 676**  
**PATRICK A. ROMERO 6682**  
**Ronald J. Eidson 3235**

0 330 660 990 1320 1650 1980 2310 2640 2970 3300 3630 3960 4290 4620 4950 5280 5610 5940 6270 6600 6930 7260 7590 7920 8250 8580 8910 9240 9570 9900

**RECEIVED**

APR 1 1982

O.C.D.  
**HOBBS OFFICE**