

STATE OF NEW MEXICO
ENERGY AND MINERALS DEPARTMENT

OIL CONSERVATION DIVISION

P. O. BOX 2088
SANTA FE, NEW MEXICO 87501

Form C-101
Revised 10-1-78

| | |
|------------------------|--|
| NO. OF COPIES RECEIVED | |
| DISTRIBUTION | |
| SANTA FE | |
| FILL | |
| U.S.G.S. | |
| LAND OFFICE | |
| OPERATOR | |

5A. Indicate Type of Lease
STATE ☐ FEE ☒

5. State Oil & Gas Lease No.

APPLICATION FOR PERMIT TO DRILL, DEEPEN, OR PLUG BACK

1a. Type of Work

DRILL ☒

DEEPEN ☐

PLUG BACK ☐

1b. Type of Well

OIL WELL ☐

GAS WELL ☒

OTHER

SINGLE ZONE ☐

MULTIPLE ZONE ☐

2. Name of Operator

The Superior Oil Company

3. Address of Operator

P.O. Box 4500 Woodlands, Texas 77380

4. Location of Well

UNIT LETTER H LOCATED 1980 FEET FROM THE North LINE

AND 800' FEET FROM THE East LINE OF SEC. 13 TWP. 24 S. R. 33 E. N.M.P.M.

7. Unit Agreement Name

8. Farm or Lease Name

Sims

9. Well No.

1

10. Field Name
UNDESIGNATED
South Bell Lake Field

12. County

Lea

19. Proposed Depth

15,000'

19A. Formation

Morrow

20. Rotary or C.T.

Rotary

21. Elevations (Show whether D.F., H.T., etc.)

+ 3580 G.L.

21A. Kind & Status Plug. Bond

Blanket

21B. Drilling Contractor

Loffland Bros.

22. Approx. Date Work will start

Dec. 15, 1980

23.

PROPOSED CASING AND CEMENT PROGRAM

| SIZE OF HOLE | SIZE OF CASING | WEIGHT PER FOOT | SETTING DEPTH | SACKS OF CEMENT | EST. TOP |
|--------------|----------------|-----------------|---------------|-----------------|----------|
| 36" | 30" | | 50' | Redi-Mix | Surface |
| 26" | 20" | 94# | 600' | 1,250 | Surface |
| 17 1/2" | 13 3/8" | 68# | 5,300' | 3,000 | Surface |
| 12 1/4" | 10 3/4" | 55.5 # | 12,900' | 1,750 | 10,900' |
| 9 1/2" | 7 5/8" | 29.7 # | 14,100' | 600 | 12,600' |
| 6 1/2" | 5" | 23.2 # | 15,000' | 250 | 13,800' |

Gas not dedicated

APPROVAL VALID FOR 180 DAYS
PERMIT EXPIRES 8/27/81
UNLESS DRILLING UNDERWAY

IN ABOVE SPACE DESCRIBE PROPOSED PROGRAM; IF PROPOSAL IS TO DEEPEN OR PLUG BACK, GIVE DATA ON PRESENT PRODUCTIVE ZONE AND PROPOSED NEW PRODUCTIVE ZONE. GIVE BLOWOUT PREVENTER PROGRAM, IF ANY.

hereby certify that the information above is true and complete to the best of my knowledge and belief.

Signed G. Bannantine G. Bannantine, Regulatory Group Manager Date February 23, 1980

(This space for State Use)

APPROVED BY [Signature] TITLE SUPERVISOR DISTRICT DATE FEB 27 1981

CONDITIONS OF APPROVAL, IF ANY:

CC: RRC (5), EAR PFP, RG, GLS, RAC, BJW, CF, PRB, JWH

NE1 CO OIL CONSERVATION COMMISSION
WELL LOCATION AND ACREAGE DEDICATION PLAT

Form C-102
Supersedes C-128
Effective 1-1-65

All distances must be from the outer boundaries of the Section.

| | | | | |
|---|--------------------------------------|------------------------------|-------------------------|--|
| Operator The Superior Oil Co. | | Lease Sims | | Well No. 1 |
| Unit Letter H | Section 13 | Township 24 South | Range 33 East | County Lea |
| Actual Footage Location of Well: 1980 feet from the North line and 800 feet from the East line | | | | |
| Ground Level Elev. 3580.3 | Producing Formation Morrow | Pool UNDDESIGNATED | | Dedicated Acreage: 320 Acres |

1. Outline the acreage dedicated to the subject well by colored pencil or hatchure marks on the plat below.
2. If more than one lease is dedicated to the well, outline each and identify the ownership thereof (both as to working interest and royalty).
3. If more than one lease of different ownership is dedicated to the well, have the interests of all owners been consolidated by communitization, unitization, force-pooling, etc?

☒ Yes ☐ No If answer is "yes," type of consolidation Communitization in process

If answer is "no," list the owners and tract descriptions which have actually been consolidated. (Use reverse side of this form if necessary.)

No allowable will be assigned to the well until all interests have been consolidated (by communitization, unitization, forced-pooling, or otherwise) or until a non-standard unit, eliminating such interests, has been approved by the Commission.

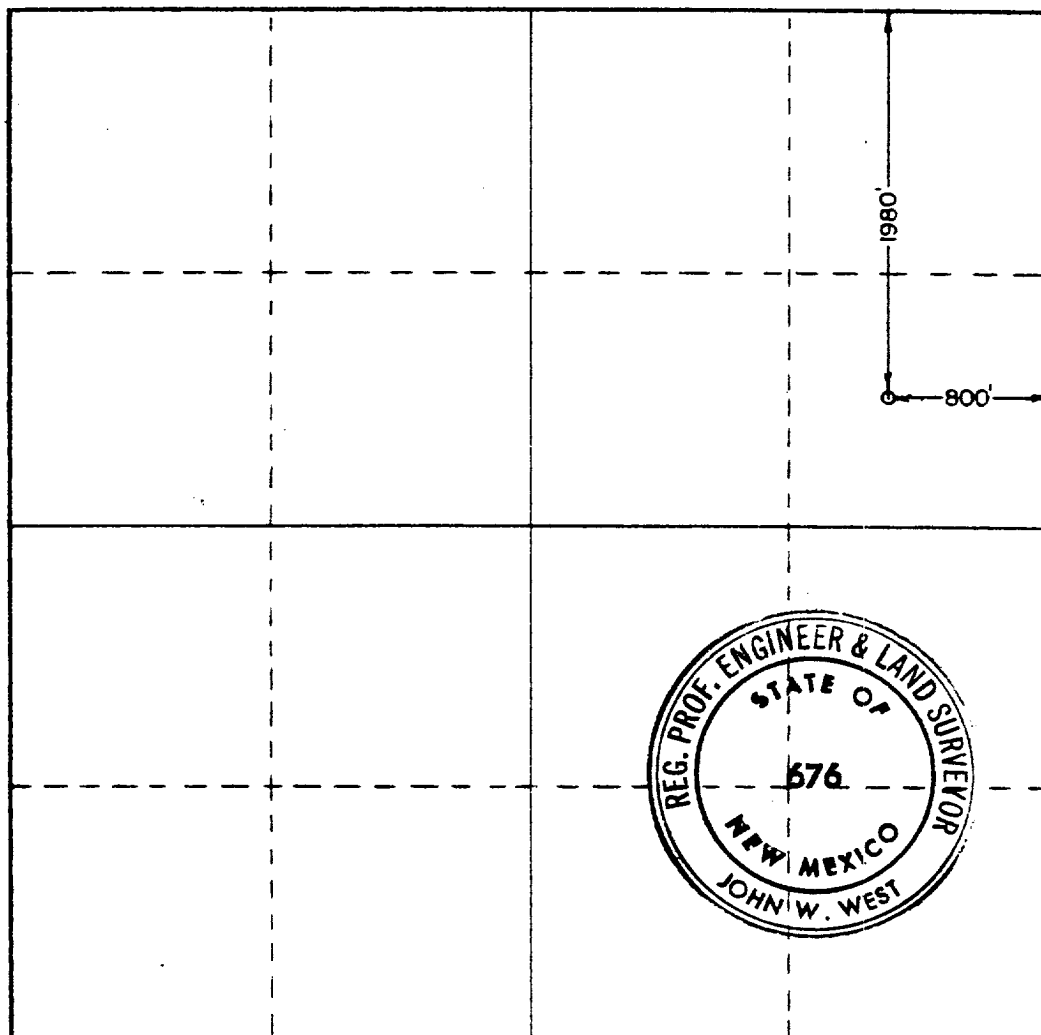

CERTIFICATION

I hereby certify that the information contained herein is true and complete to the best of my knowledge and belief.

G. Bannantine
Name **G. Bannantine**

Position
Regulatory Group Mgr.

The Superior Oil Co.

Company

February 23, 1981

Date

I hereby certify that the well location shown on this plat was plotted from field notes of actual surveys made by me or under my supervision, and that the same is true and correct to the best of my knowledge and belief.

Date Surveyed

June 30, 1980

Registered Professional Engineer:
and/or Land Surveyor

John W. West

Certificate No **JOHN W. WEST 676**
PATRICK A. ROMERO 6865
Ronald J. Eidson 3239

