

NEW MEXICO OIL CONSERVATION COMMISSION
WELL LOCATION AND ACREAGE DEDICATION PLAT

Form C-102
Supersedes C-128
Effective 1-1-65

All distances must be from the outer boundaries of the Section.

Operator The Superior Oil Company			Lease Sims		Well No. 1
Unit Letter H	Section 13	Township 24 South	Range 33 East	County Lea	
Actual Footage Location of Well: 1980 feet from the North line and 800 feet from the East line					
Ground Level Elev. 3580.3'	Producing Formation Morrow	Pool South Bell Lake		Dedicated Acreage: 320 Acres	

1. Outline the acreage dedicated to the subject well by colored pencil or hachure marks on the plat below.
2. If more than one lease is dedicated to the well, outline each and identify the ownership thereof (both as to working interest and royalty).
3. If more than one lease of different ownership is dedicated to the well, have the interests of all owners been consolidated by communitization, unitization, force-pooling, etc?

☒ Yes ☐ No If answer is "yes," type of consolidation Communitization

If answer is "no," list the owners and tract descriptions which have actually been consolidated. (Use reverse side of this form if necessary.)

No allowable will be assigned to the well until all interests have been consolidated (by communitization, unitization, forced-pooling, or otherwise) or until a non-standard unit, eliminating such interests, has been approved by the Commission.

<p><i>Spear et al 160 Ac</i> <i>See attached list for percentages</i> <i>320 Ac. Lease</i></p>		CERTIFICATION	
		<p>I hereby certify that the information contained herein is true and complete to the best of my knowledge and belief.</p>	
<p><i>BASS 160 Ac</i> <i>See attached list for percentages</i></p>		Name G. E. Tate	
		Position Production Superintendent	
		Company The Superior Oil Company	
		Date 1-18-83	
<p><i>BASS 160 Ac</i> <i>See attached list for percentages</i></p>		<p>I hereby certify that the well location shown on this plat was plotted from field notes of actual surveys made by me or under my supervision, and that the same is true and correct to the best of my knowledge and belief.</p>	
		Date Surveyed June 30, 1980	
		Registered Professional Engineer and/or Land Surveyor O/S John West	
<p>Certificate No. 676</p>			

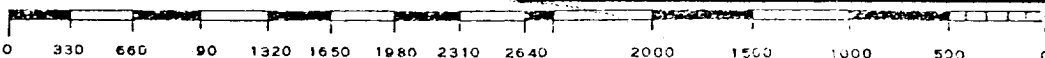

RECEIVED
JAN 21 1983
O.C.D.
HOBBS OFFICE

EXHIBIT "A"

TO COMMUNITIZATION AGREEMENT
DATED: AS OF NOVEMBER 1, 1981
EMBRACING TOWNSHIP 24 SOUTH
RANGE 33 EAST N.M.P.M.
SECTION 13: E/2
LEA COUNTY, NEW MEXICO

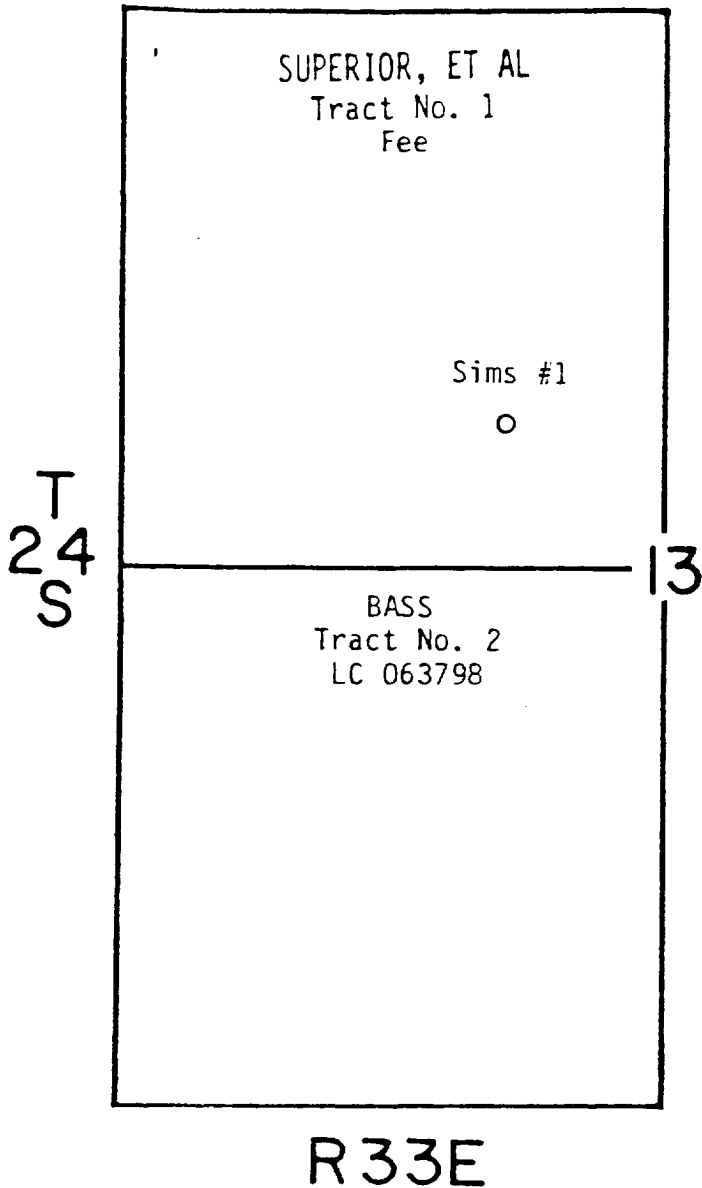

PLAT OF COMMUNITIZED AREA

COVERING THE MORROW, ATOKA, & STRAWN FORMATION
UNDER THE

E/2 SEC. 13, T24S, R33E
LEA COUNTY, NEW MEXICO

SCALE: 1"=1000'

RECEIVED
JAN 21 1983
O.C.D.
HOBBS OFFICE

EXHIBIT "B"

To Communitization Agreement dated November 1, 1981 embracing the East-half (E/2) Section 13, T-24-S, R-33-E, N.M.P.M., Lea County, New Mexico.

Operator of Communitized Area: The Superior Oil Company

DESCRIPTION OF LEASES COMMITTED

	<u>Tract No. 1</u>
<u>No. 1</u>	
<u>Lessors:</u>	Howell Spear et ux, Mary Nan Spear
<u>Original Lessee:</u>	The Superior Oil Company
<u>Lease Serial No.:</u>	Fee (NM-1381)
<u>Lease Date:</u>	October 15, 1974
<u>Description of Lands Committed:</u>	<u>T-24-S, R-33-E, N.M.P.M.</u> <u>Section 13: NE/4</u>
<u>Number of Acres:</u>	3.83
<u>Working Interest & Percentage:</u>	The Superior Oil Company - 100%
<u>O.R.R.I. & Percentage:</u>	None
<u>No. 2</u>	
<u>Lessors:</u>	Jerome T. Hanners et ux, Imogene M. Hanners
<u>Original Lessee:</u>	The Superior Oil Company
<u>Lease Serial No.:</u>	Fee (NM-1381-a)
<u>Lease Date:</u>	October 15, 1974
<u>Description of Lands Committed:</u>	<u>T-24-S, R-33-E, N.M.P.M.</u> <u>Section 13: NE/4</u>
<u>Number of Acres:</u>	1.00
<u>Working Interest & Percentage:</u>	The Superior Oil Company - 100%
<u>O.R.R.I. & Percentage:</u>	None
<u>No. 3</u>	
<u>Lessor:</u>	Betty M. Rogers, a widow
<u>Original Lessee:</u>	The Superior Oil Company
<u>Lease Serial No.:</u>	Fee (NM-1381-b)
<u>Lease Date:</u>	October 15, 1974
<u>Description of Lands Committed:</u>	<u>T-24-S, R-33-E, N.M.P.M.</u> <u>Section 13: NE/4</u>
<u>Number of Acres:</u>	3.34
<u>Working Interest & Percentage:</u>	The Superior Oil Company - 100%
<u>O.R.R.I. & Percentage:</u>	None

RECEIVED

JAN 21 1983

C.C.D.
HOBBS OFFICE

No. 4

Lessors:

Aline Sims, Personal Representative of the
Last Will and Testament of G. P. Sims,
Deceased

Original Lessee:

The Superior Oil Company

Lease Serial No.:

Fee (NM-1381-f)

Lease Date:

January 18, 1980

Description of Lands Committed:

T-24-S, R-33-E, N.M.P.M.
Section 13: NE/4

Number of Acres:

~~98.34~~ 98.33

Working Interest & Percentage:

The Superior Oil Company - 100%

O.R.R.I. & Percentage:

None

Pooling Provision for Leases No. 1-4:

Lessee is hereby granted the right to pool or unitize this lease, the land covered by it or any part thereof with any other land, lease, leases, mineral estates or parts thereof for the production of oil, liquid hydrocarbons and all gases and their respective constituent products, or any of them, such pooling to be into a unit or units not exceeding 40 acres in the event of an oil well, or into a unit or units not exceeding 640 acres each in the event of a gas well, plus a tolerance of ten percent (10%) thereof, provided that if any Federal or State law, Executive order, rule or regulation shall prescribe a spacing pattern for the development of the field or allocate a producing allowable on acreage per well, then any such units may embrace as much additional acreage as may be so prescribed or as may be used in such allocation or allowable. The term "gas well" as used in this paragraph shall be deemed to include wells producing, or capable of producing, natural gas, gas condensate, gas distillate or any gaseous substance, as said terms, or any of them are commonly understood in the oil and gas industry, or as they may be used by any governmental authority. Lessee shall file written unit designations in the county in which the premises are located. Such units may be designated either before or after the completion of wells. Drilling operations and production on any part of the pooled acreage shall be treated as if such drilling operations were upon or such production was from the land described in this lease whether the well or wells be located on the land covered by this lease or not. The entire acreage pooled into a unit shall be treated for all purposes, except the payment of royalties on production from the pooled unit, as if it were included in this lease. In lieu of the royalties herein provided, lessor shall receive on production from a unit so pooled only such portion of the royalty stipulated herein as the amount of his acreage placed in the unit or his royalty interest therein on an acreage basis bears to the total acreage so pooled in the particular unit involved.

No. 5

Lessors:

Leo V. Sims, Ellie Sims Spear, Winnie Sims
Kennann, Elizabeth Sims Daugherty

Original Lessee:

Unleased, mineral owners participating in well.

Lease Serial No.:

None

Lease Date:

None

Description of Lands Committed:

T-24-S, R-33-E, N.M.P.M.
Section 13: NE/4

Number of Acres:

53.50

Working Interest & Percentage:

Leo V. Sims, Ellie Sims Spear,
Winnie Sims Kennann, Elizabeth
Sims Daugherty

- 100%

O.R.R.I. & Percentage:

- None

RECEIVED

JAN 21 1983

O.C.D.
HOBBS OFFICE

Tract No. 2

Lessors: The United States of America
Original Lessee: O. H. Randel & R. S. Magruder
Lease Serial No.: LC-063798
Lease Date: February 1, 1951
Description of Lands Committed: T-24-S, R-33-E, N.M.P.M.
Section 13: SE/4
Number of Acres: 160.00
Working Interest & Percentage: Perry R. Bass 25%
Bass Enterprises Prod. Co. 75%
O.R.R.I. & Percentage: Estate of Oliver H. Randel, Deceased 1.500%
Katherine Kolliker McIntyre .750%
Howard W. Jennings .375%
Sid R. Bass, Edward P. Bass,
Robert M. Bass & Panther City
Investment Company, Trustee .375%
Edward M. Muse .500%

RECAPITULATION

<u>Tract Number/ Instrument Number</u>	<u>No. of Acres Committed</u>	<u>Percentage of Interest in Communitized Area</u>
1 - 1	3.83	1.20%
1 - 2	1.00	.31%
1 - 3	3.34	1.04%
1 - 4	98.33	30.73%
1 - 5	53.50	16.72%
2 - 1	<u>160.00</u>	<u>50.00%</u>
	320.00	100.00%

RECEIVED

JAN 21 1983

O.C.D.
HOBBS OFFICE