

Form 9-331 C
(May 1963)SUBMIT IN 'PLICATE*
(Other instructions on
reverse side)Form approved.
Budget Bureau No. 42-R1425.UNITED STATES
DEPARTMENT OF THE INTERIOR
GEOLOGICAL SURVEY

APPLICATION FOR PERMIT TO DRILL, DEEPEN, OR PLUG BACK

1a. TYPE OF WORK DRILL <input checked="" type="checkbox"/> DEEPEN <input type="checkbox"/> PLUG BACK <input type="checkbox"/>			5. LEASE DESIGNATION AND SERIAL NO. NM 18644	
b. TYPE OF WELL OIL WELL <input checked="" type="checkbox"/> GAS WELL <input type="checkbox"/> OTHER <input type="checkbox"/> SINGLE ZONE <input type="checkbox"/> MULTIPLE ZONE <input type="checkbox"/>			6. IF INDIAN, ALLOTTEE OR TRIBE NAME	
2. NAME OF OPERATOR HNG Oil Company			7. UNIT AGREEMENT NAME	
3. ADDRESS OF OPERATOR P.O. Box 2267, Midland, Texas 79702			8. FARM OR LEASE NAME Wilson 17 Federal	
4. LOCATION OF WELL (Report location clearly and in accordance with any State requirements.)* At surface 1980' FNL & 1930' FEL, Sec. 17 At proposed prod. zone Same			9. WELL NO. 4-Y	
14. DISTANCE IN MILES AND DIRECTION FROM NEAREST TOWN OR POST OFFICE* 6 miles south from Jal, NM			10. FIELD AND POOL, OR WILDCAT Sioux Yates	
15. DISTANCE FROM PROPOSED* LOCATION TO NEAREST PROPERTY OR LEASE LINE, FT. (Also to nearest drlg. unit line, if any) 660'			11. SEC., T., R., M., OR BLK. AND SURVEY OR AREA Sec. 17, T26S, R36E	
16. NO. OF ACRES IN LEASE 480			12. COUNTY OR PARISH Lea	
17. NO. OF ACRES ASSIGNED TO THIS WELL 40			13. STATE NM	
18. DISTANCE FROM PROPOSED LOCATION* TO NEAREST WELL, DRILLING, COMPLETED, OR APPLIED FOR, ON THIS LEASE, FT. 1270'			19. PROPOSED DEPTH 3850'	
20. ROTARY OR CABLE TOOLS Rotary			21. ELEVATIONS (Show whether DF, RT, GR, etc.) 2956' GR	
22. APPROX. DATE WORK WILL START* 7-13-80			23. PROPOSED CASING AND CEMENTING PROGRAM	

SIZE OF HOLE	SIZE OF CASING	WEIGHT PER FOOT	SETTING DEPTH	QUANTITY OF CEMENT
11"	8-5/8"	24#	1400'	850 sacks Circulated
7-7/8"	5-1/2"	14#	3850'	650 sacks

Pressure Control Program

A double blow-out preventor and rotating head with a choke manifold will be installed at the 8-5/8 inch casing setting point. The drill string will be equipped with a safety valve. All equipment will be tested to 3000 pounds after installation. Acreage is dedicated.

RECEIVED

JUL 16 1980

U. S. GEOLOGICAL SURVEY
HOBBS, NEW MEXICO

IN ABOVE SPACE DESCRIBE PROPOSED PROGRAM: If proposal is to deepen or plug back, give data on present productive zone and proposed new productive zone. If proposal is to drill or deepen directionally, give pertinent data on subsurface locations and measured and true vertical depths. Give blowout preventer program, if any.

24. SIGNED Betty A. Gildon TITLE Regulatory Clerk DATE 7-15-80
(This space for Federal or State office use)

PERMIT NO. _____ APPROVAL DATE _____

APPROVED BY _____ TITLE _____

CONDITIONS OF APPROVAL, IF ANY:

*See Instructions On Reverse Side

APPROVED

JUL 23 1980

DISTRICT SUPERVISOR

NEW MEXICO OIL CONSERVATION COMMISSION
WELL LOCATION AND ACREAGE DEDICATION PLAT

Form C-102
Supersedes C-128
Effective 1-1-65

All distances must be from the outer boundaries of the Section

Operator H.N.G. OIL COMPANY			Lease Wilson Federal 17		Well No. 4 Y
Unit Letter G	Section 17	Township 26-S	Range 36-E	County Lea	
Actual Footage Location of Well:					
1980' feet from the North line and		1930' feet from the East line			
Ground Level Elev. 2956'	Producing Formation Yates	Pool Sioux-Lan-Will-Yates	Dedicated Acreage 40 Acres		

1. Outline the acreage dedicated to the subject well by colored pencil or hatchure marks on the plat below.
2. If more than one lease is dedicated to the well, outline each and identify the ownership thereof (both as to working interest and royalty).
3. If more than one lease of different ownership is dedicated to the well, have the interests of all owners been consolidated by communitization, unitization, force-pooling, etc?

☐ Yes ☐ No If answer is "yes," type of consolidation _____

If answer is "no," list the owners and tract descriptions which have actually been consolidated. (Use reverse side of this form if necessary.) _____

No allowable will be assigned to the well until all interests have been consolidated (by communitization, unitization, forced-pooling, or otherwise) or until a non-standard unit, eliminating such interests, has been approved by the Commission.

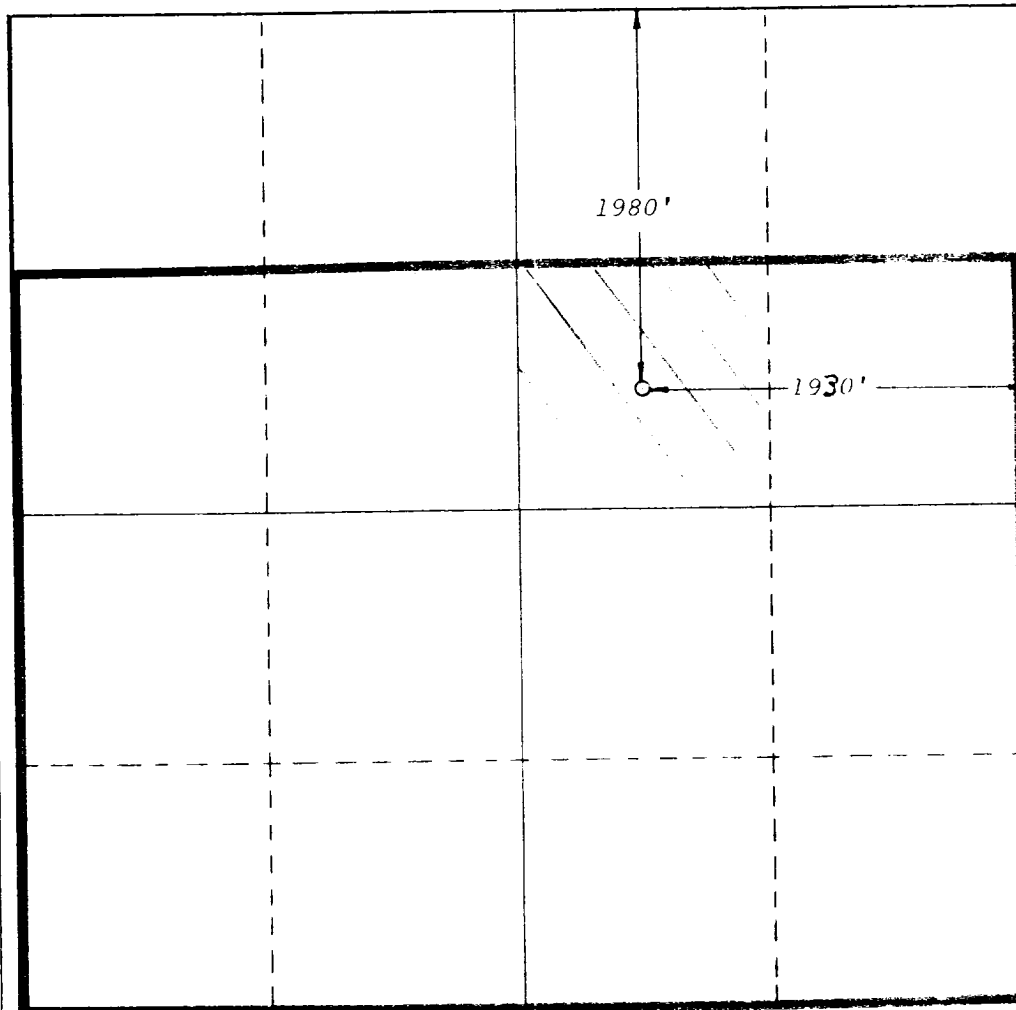

CERTIFICATION

I hereby certify that the information contained herein is true and complete to the best of my knowledge and belief.

Betty A. Gildon

Name
Betty A. Gildon

Position
Regulatory Clerk

Company
HNG Oil Company

Date
July 14, 1980

I hereby certify that the well location shown on this plat was plotted from field notes of actual surveys made by me or under my supervision, and that the same is true and correct to the best of my knowledge and belief.

GARY D. BOSWELL
GARY D. BOSWELL
NO. 6639
REGISTERED LAND SURVEYOR
March 21, 1980

Date Survey
Gary D. Boswell
Registered Professional Engineer
and/or Land Surveyor

Gary D. Boswell
Certificate No.
6689

1. (A) Pressure control equipment to be used.

900 series double Cameron type "U" BOP w/blind rams and pipe rams.
BOP can be activated from closing unit. Drill string safety valve
can be installed at surface casing point.

- (B) Pressure ratings (or API series).

900 series 3000 psi

- (C) Testing procedures and frequency.

BOP's will be tested at installation point.

- (D) Schematic Diagram.

Attached.

2. Mud Program

Type and Characteristics

0-1000 Native
1000-TD 10.0 ppg bring water

Quantities and types of weighting material to be maintained

200 sx Barite on location.