

UNITED STATES
DEPARTMENT OF THE INTERIOR
GEOLOGICAL SURVEY30-025-27002
5. LEASE DESIGNATION AND SERIAL NO.
NM 18644

APPLICATION FOR PERMIT TO DRILL, DEEPEN, OR PLUG BACK

1a. TYPE OF WORK

DRILL ☒DEEPEN ☐PLUG BACK ☐

b. TYPE OF WELL

OIL
WELL ☒GAS
WELL ☐

OTHER

SINGLE
ZONE ☐MULTIPLE
ZONE ☐

2. NAME OF OPERATOR

HNG Oil Company

3. ADDRESS OF OPERATOR

P.O. Box 2267 Midland, Texas 79702

4. LOCATION OF WELL (Report location clearly and in accordance with any State requirements.*)

At surface 1980' FSL & 2050' FWL

At proposed prod. zone 1980' FSL & 2050' FWL

14. DISTANCE IN MILES AND DIRECTION FROM NEAREST TOWN OR POST OFFICE*

6 miles South from Jal

15. DISTANCE FROM PROPOSED* 1980'

LOCATION TO NEAREST
PROPERTY OR LEASE LINE, FT.
(Also to nearest drilg. unit line, if any) 660'18. DISTANCE FROM PROPOSED LOCATION*
TO NEAREST WELL, DRILLING, COMPLETED,
OR APPLIED FOR, ON THIS LEASE, FT.

1320'

16. NO. OF ACRES IN LEASE

480

19. PROPOSED DEPTH

3900'

17. NO. OF ACRES ASSIGNED
TO THIS WELL

40

20. ROTARY OR CABLE TOOLS

Rotary

21. ELEVATIONS (Show whether DF, RT, GR, etc.)

2953' GR

22. APPROX. DATE WORK WILL START*

8-30-80

23.

PROPOSED CASING AND CEMENTING PROGRAM

SIZE OF HOLE	SIZE OF CASING	WEIGHT PER FOOT	SETTING DEPTH	QUANTITY OF CEMENT
11"	8-5/8"	24#	1400'	850 sx Circulated
7-7/8"	5-1/2"	14#	3900'	650 sx

Pressure Control Program

A double blow-out preventer and rotating head with a choke manifold will be installed at the 8-5/8 inch casing setting point. The drill string will be equipped with a safety valve. All equipment will be tested to 3000 pounds after installation.

Acreage is dedicated.

RECEIVED

JUL 7 1980

U. S. GEOLOGICAL SURVEY
HOBBS, NEW MEXICO

IN ABOVE SPACE DESCRIBE PROPOSED PROGRAM: If proposal is to deepen or plug back, give data on present productive zone and proposed new productive zone. If proposal is to drill or deepen directionally, give pertinent data on subsurface locations and measured and true vertical depths. Give blowout preventer program, if any.

24.

SIGNED

Betty A. Gildon

TITLE Regulatory Clerk

DATE June 24, 1980

(This space for Federal or State office use)

PERMIT NO.	APPROVAL DATE
APPROVED	
APPROVED BY	TITLE
CONDITIONS OF APPROVAL, IF ANY:	DATE
AUG 11 1980	
DISTRICT SUPERVISOR	

*See Instructions On Reverse Side

N MEXICO OIL CONSERVATION COMMISS
WELL LOCATION AND ACREAGE DEDICATION PLAT

Form C-102
Supersedes C-128
Effective 1-1-65

All distances must be from the outer boundaries of the Section.

Operator H.N.G. OIL COMPANY			Lease Wilson Federal 17		Well No. 8
Unit Letter K	Section 17	Township 26-S	Range 36-E	County Lea	
Actual Footage Location of Well: 1980' feet from the South line and 2050' feet from the West line					
Ground Level Elev. 2953'	Producing Formation Yates		Pool Sioux		Dedicated Acreage: 40 Acres

1. Outline the acreage dedicated to the subject well by colored pencil or hachure marks on the plat below.
2. If more than one lease is dedicated to the well, outline each and identify the ownership thereof (both as to working interest and royalty).
3. If more than one lease of different ownership is dedicated to the well, have the interests of all owners been consolidated by communitization, unitization, force-pooling, etc?

☐ Yes ☐ No If answer is "yes," type of consolidation _____

If answer is "no," list the owners and tract descriptions which have actually been consolidated. (Use reverse side of this form if necessary.) _____

No allowable will be assigned to the well until all interests have been consolidated (by communitization, unitization, forced-pooling, or otherwise) or until a non-standard unit, eliminating such interests, has been approved by the Commission.

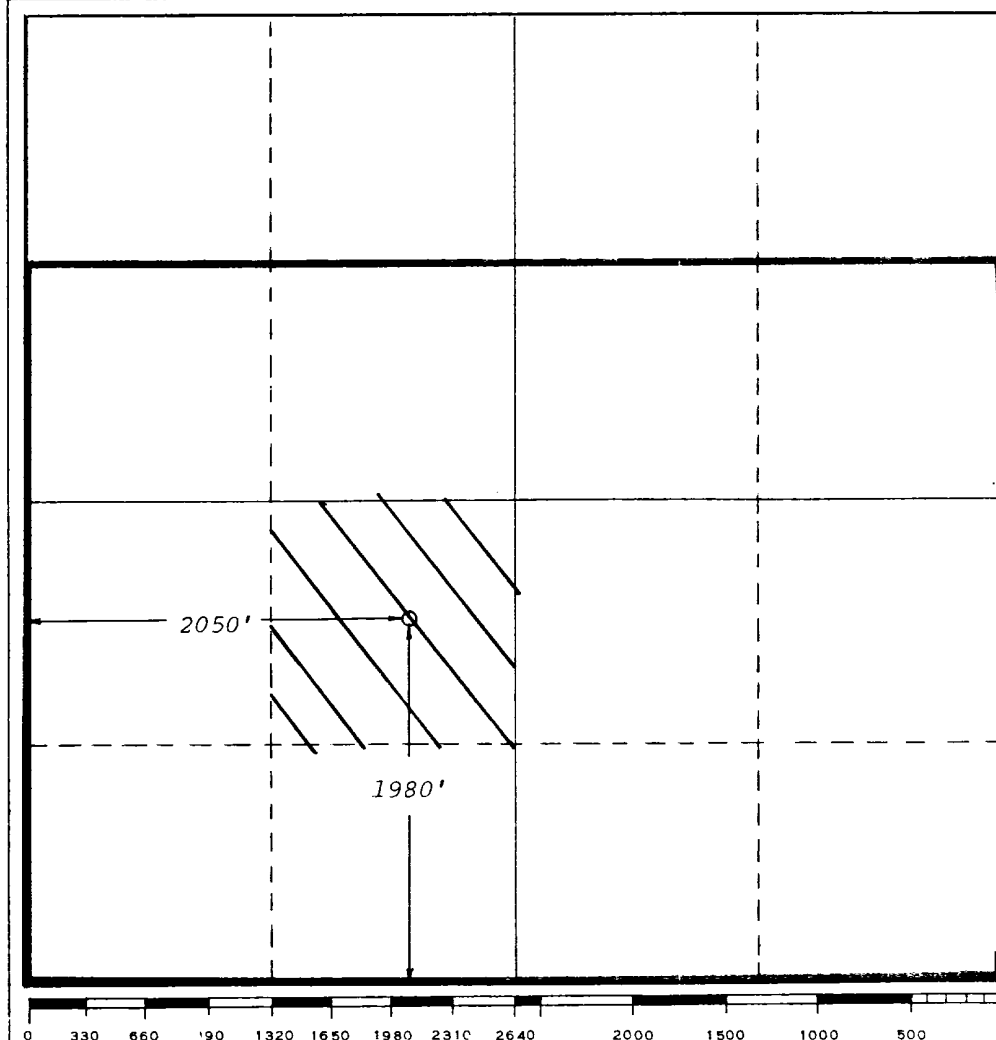

CERTIFICATION

I hereby certify that the information contained herein is true and complete to the best of my knowledge and belief.

Name
Betty A. Gildon

Position
Regulatory Clerk

Company
HNG Oil Company

Date
June 23, 1980

I hereby certify that the well location shown on this plat was plotted from field notes of actual surveys made by me or under my supervision, and that the same is true and correct to the best of my knowledge and belief.

June 10, 1980

Date Surveyed
Gary D. Boswell

Registered Professional Engineer
and/or Land Surveyor

Gary D. Boswell
Certificate No.

6689

Cross section of the H.N.G. Oil Company
 Wilson Federal 17 #8, 1980' FSL & 2050' FWL
 Section 17, T-26-S, R-36-E, Lea County New Mexico

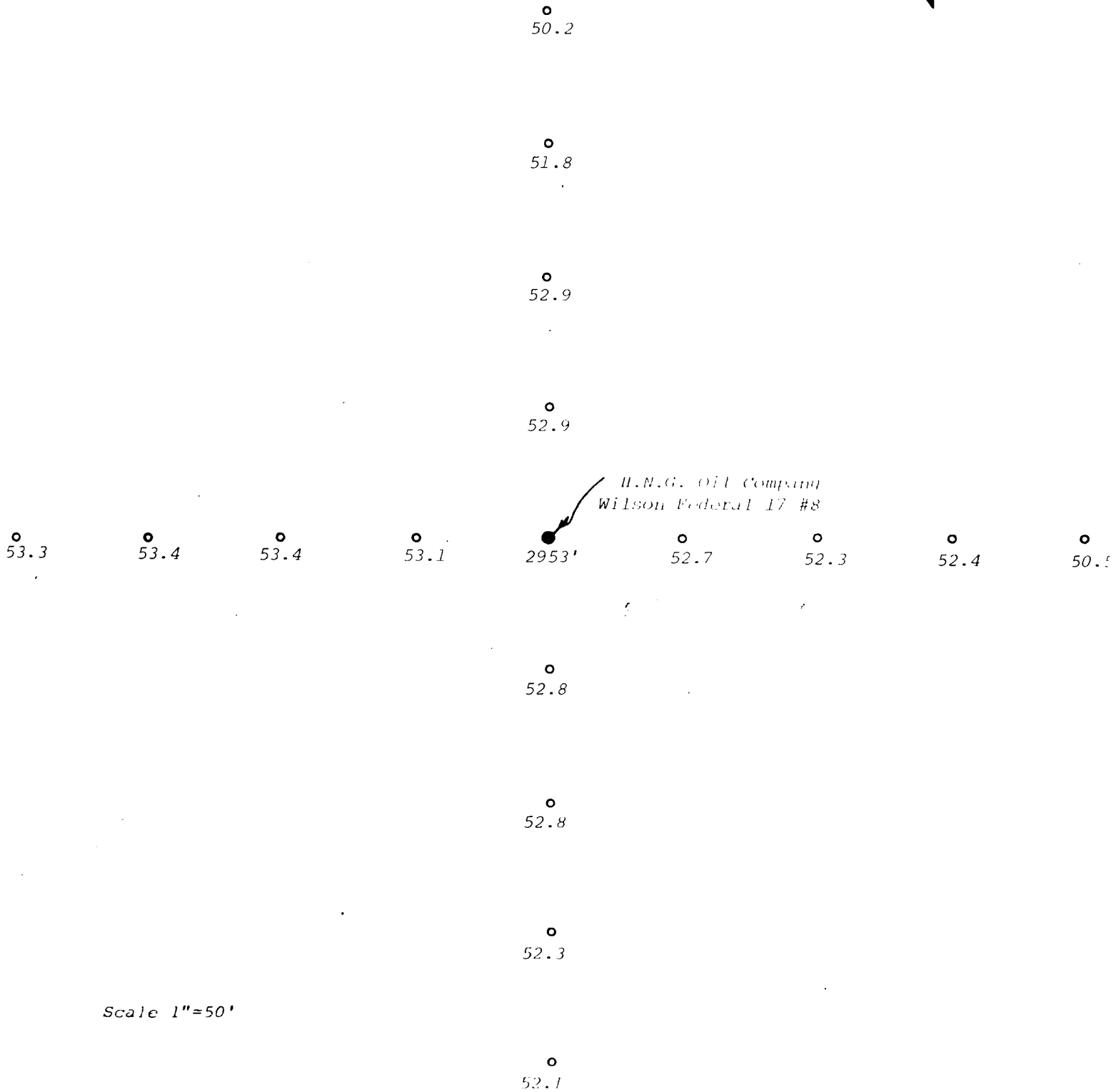

Scale 1"=50'

TOPOGRAPHIC LAND SURVEYORS
 908 W. Wall
 Midland, Texas 79701
 915-682-1653

AUG 19 1980

RECEIVED

APPLICATION FOR PERMIT TO DRILL

1. The geologic surface formation is Quaternary.

2. The estimated tops of important geologic markers are:

- | | |
|--|-----------|
| 1. <u>Tansill - 3200 feet</u> | 6. _____ |
| 2. <u>Yates - 3400 feet</u> | 7. _____ |
| 3. <u>Seven Rivers (Pay) - 3600 feet</u> | 8. _____ |
| 4. _____ | 9. _____ |
| 5. _____ | 10. _____ |

3. Depths at which oil, water, or gas bearing formations are expected to be encountered.

Tansill - 3200 - 3400
Yates - 3400 - 3600
Seven Rivers (Pay) - 3600 to TD

4. Brief description of testing, logging, and coring programs.

Will probably run open hole logs, gamma ray sonic w/ caliper, dual lateral logs (DLL), compensated neutron log (CNL) at TD, pulling the gamma ray to surface thru pipe which will be set at about 1400 feet.

5. Any anticipated abnormal pressures or temperatures expected? Any potential hazards - H2S?

None expected.

1. (A) Pressure control equipment to be used.

900 series double Cameron type "U" BOP/blind rams and pipe rams. BOP can be activated from closing unit. Drill string safety valve can be installed at surface casing point.

- (B) Pressure ratings (or API series).

900 series 3000 psi

- (C) Testing procedures and frequency.

BOP's will be tested at installation point

- (D) Schematic Diagram.

Attached

2. Mud Program

Type and Characteristics

0-1000 Native

1000- TD 10.0 ppg brine water

Quantities and types of weighting material to be maintained

200 sx Barite on location