

30-025-27,60

NO. OF COPIES RECEIVED

## NEW MEXICO OIL CONSERVATION COMMISSION

Form C-101

Revised 11-65

DISTRIBUTION

SANTA FE

FILE

U.S.G.S.

LAND OFFICE

OPERATOR

5A. Indicate Type of Lease

STATE ☒FEL ☐

5. State Oil &amp; Gas Lease No.

L-6947

## APPLICATION FOR PERMIT TO DRILL, DEEPEN, OR PLUG BACK

1. Type of Work

DRILL ☒DEEPEN ☐PLUG BACK ☐

2. Type of Well

OIL WELL ☒GAS WELL ☐

OTHER

SINGLE ZONE ☒MULTIPLE ZONE ☐

3. Name of Operator

Gifford, Mitchell &amp; Wisenbaker

4. Address of Operator

1280 Midland National Bank Tower, Midland, Texas 79701

5. Location of Well

UNIT LETTER B

LOCATED 660

FEET FROM THE

North

LINE

6. 1980

FEET FROM THE

East

LINE OF SEC. 34

TWP. 26-S

RGE. 36-E

NADEN

7. Field Agreement Name

Undesignated

8. Name of Lease Owner

Iron Mountain

9. Well No.

3

10. Field and Post, or District

Comanche Stateline

11. RESERVE DATES

12. County

Lea

13. Deviation (show whether DE, RT, etc.)

2898 GR

21A. Kind &amp; Status Plug. Bond

Blanket

14. Proposed Depth

4000'

15A. Formation

Tansil-Yates

16. History of Well

Rotary

21B. Drilling Contractor

Price Drilling Co.

22. Approx. Date Work will start

12/10/80

23.

## PROPOSED CASING AND CEMENT PROGRAM

SIZE OF HOLE	SIZE OF CASING	WEIGHT PER FOOT	SETTING DEPTH	SACKS OF CEMENT	EST. TOP
12 1/4"	8 5/8"	24	1400'	1125	Surface
7 7/8"	5 1/2"	14	3750'	550	1000'

The Blowout Preventer Program will consist of one 10" 3000 psi WP double BOP (1 pipe ram, 1 blind ram). The BOP will be installed when 8 5/8" casing is set and cemented.

APPROVAL VALID

1. NO OILS UNLESS  
2. NO COMMENCED,

EXPIRE 2/21/81

IN ABOVE SPACE DESCRIBE PROPOSED PROGRAM; IF PROPOSAL IS TO DEEPEN OR PLUG BACK, GIVE DATA ON PRESENT PRODUCTIVE ZONE AND PROPOSED NEW PRODUCTIVE ZONE. GIVE BLOWOUT PREVENTER PROGRAM, IF ANY.

I hereby certify that the information above is true and complete to the best of my knowledge and belief.

Signed L. B. Hitt Title Production Manager

Date 11/19/80

(This space for State Use)

APPROVED BY [Signature] TITLE SUPERVISOR

DATE 11-19-1980

CONDITIONS OF APPROVAL, IF ANY:

NEW MEXICO OIL CONSERVATION COMMISSION  
WELL LOCATION AND ACREAGE DEDICATION PLAT

Form C-102  
Supersedes C-128  
Effective 1-4-65

All distances must be from the outer boundaries of the Section.

Operator <b>GIFFORD, MITCHELL &amp; WISENBAKER</b>			Lease <b>IRON MOUNTAIN</b>		Well No. <b>3</b>
Unit Letter <b>"B"</b>	Section <b>-34-</b>	Township <b>-26-S</b>	Range <b>-36-E</b>	County <b>LEA</b>	
Actual Footage Location of Well: 660 feet from the <b>NORTH</b> line and 1980 feet from the <b>EAST</b> line					
Ground Level Elev. <b>2898</b>	Producing Formation <b>TANSIL YATES</b>		Pool <b>COMANCHE STATE LINE</b>		Dedicated Acreage: <b>40</b> Acres

1. Outline the acreage dedicated to the subject well by colored pencil or hachure marks on the plat below.
2. If more than one lease is dedicated to the well, outline each and identify the ownership thereof (both as to working interest and royalty).
3. If more than one lease of different ownership is dedicated to the well, have the interests of all owners been consolidated by communitization, unitization, force-pooling, etc?

☐ Yes ☐ No If answer is "yes," type of consolidation \_\_\_\_\_

If answer is "no," list the owners and tract descriptions which have actually been consolidated. (Use reverse side of this form if necessary.) \_\_\_\_\_

No allowable will be assigned to the well until all interests have been consolidated (by communitization, unitization, forced-pooling, or otherwise) or until a non-standard unit, eliminating such interests, has been approved by the Commission.

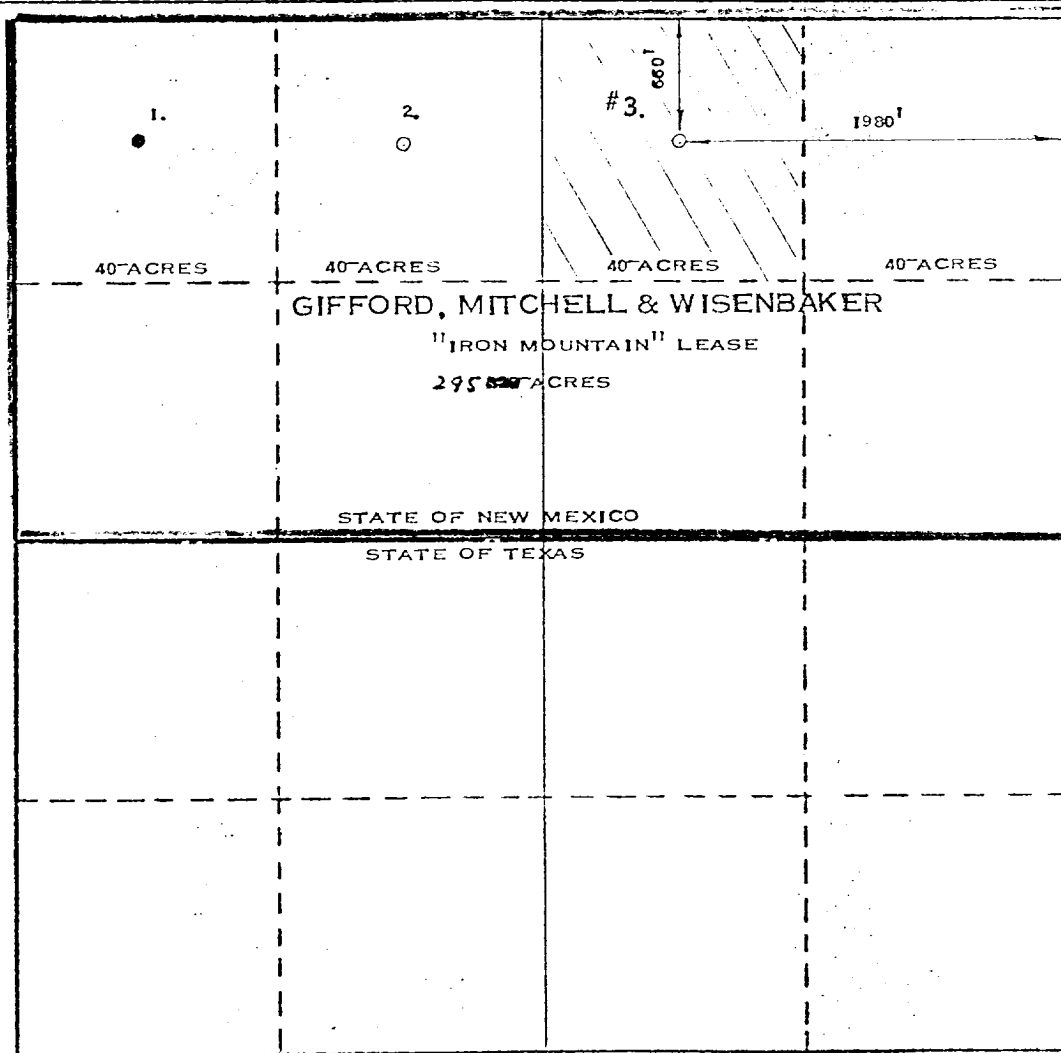

CERTIFICATION

I hereby certify that the information contained herein is true and complete to the best of my knowledge and belief.

Name **L. B. STITT**  
Position **Production Manager**  
Company **Gifford, Mitchell & Wisenbaker**  
Date **11/19/80**

I hereby certify that the well location shown on this plat was plotted from field notes of actual surveys made by me or under my supervision, and that the same is true and correct to the best of my knowledge and belief.

Date Surveyed **SEPTEMBER 30, 1980**  
Registered Professional Engineer and/or Land Surveyor  
**MAX A. SCHUMANN, JR.**  
Certificate No. **1510**