

UNITED STATES  
DEPARTMENT OF THE INTERIOR  
GEOLOGICAL SURVEY

## APPLICATION FOR PERMIT TO DRILL, DEEPEN, OR PLUG BACK

1a. TYPE OF WORK  
DRILL ☒ DEEPEN ☐ PLUG BACK ☐

b. TYPE OF WELL  
OIL WELL ☐ GAS WELL ☒ OTHER ☐ SINGLE ZONE ☒ MULTIPLE ZONE ☐

2. NAME OF OPERATOR  
THE SUPERIOR OIL COMPANY

3. ADDRESS OF OPERATOR  
P.O. Box 4500 The Woodlands, Texas 77380

4. LOCATION OF WELL (Report location clearly and in accordance with any State requirements.)  
At surface 1980' FNL & 1968' FWL  
At proposed prod. zone  
Straight Hole

14. DISTANCE IN MILES AND DIRECTION FROM NEAREST TOWN OR POST OFFICE\*  
20 miles NW of Jal

15. DISTANCE FROM PROPOSED\* LOCATION TO NEAREST PROPERTY OR LEASE LINE, FT.  
(Also to nearest drlg. unit line, if any)

16. NO. OF ACRES IN LEASE  
1520

17. NO. OF ACRES ASSIGNED TO THIS WELL  
320

18. DISTANCE FROM PROPOSED LOCATION\* TO NEAREST WELL, DRILLING, COMPLETED, OR APPLIED FOR, ON THIS LEASE, FT.  
1st Well 15200

20. ROTARY OR CABLE TOOLS  
Rotary

21. ELEVATIONS (Show whether DF, RT, GR, etc.)  
3555.0 GR

22. APPROX. DATE WORK WILL START\*  
October 1, 1981

23. PROPOSED CASING AND CEMENTING PROGRAM

SIZE OF HOLE	SIZE OF CASING	WEIGHT PER FOOT	SETTING DEPTH	QUANTITY OF CEMENT	EST. Top
26"	20" K55	94.0	600'	1250 sxs light & "C"	Surface
17-1/2"	13-3/8" K55	68.0	5,300'	3000 sxs light & "C"	Surface
12-1/4"	9-5/8" S95	47.0	12,900'	1750 sxs light & "C"	10,400
8-1/2"	7-5/8" S95	39.0	14,300'	800 sxs Class "H"	12,900
6-1/2"	5" N80	23.2	15,200'	250 sxs Class "H"	14,300

SEE ATTACHED SHEETS

7-5/8" liner 12,600' - 14,300'  
5" liner 14,000' - 15,200'

NOTE: 7-5/8" liner may be omitted if pressures allow

East half of Section 19 dedicated

GAS NOT DEDICATED.

IN ABOVE SPACE DESCRIBE PROPOSED PROGRAM: If proposal is to deepen or plug back, give data on present productive zone and proposed new productive zone. If proposal is to drill or deepen directionally, give pertinent data on subsurface locations and measured and true vertical depths. Give blowout preventer program, if any.

24. SIGNED G. Bannantine TITLE Regulatory Group Manager DATE June 9, 1981

(This space for Federal or State office use)

PERMIT NO. **APPROVED**  
(Orig. Sgd.) **GEORGE H. STEWART**

APPROVAL DATE

APPROVED BY **JUL 9 1981**  
CONDITIONS OF APPROVAL, IF ANY

TITLE

DATE

FOR  
**JAMES A. GILLHAM**  
DISTRICT SUPERVISOR

## EXHIBIT "A"

N MEXICO OIL CONSERVATION COMMISS  
WELL LOCATION AND ACREAGE DEDICATION PLAT

Form C-102  
Supersedes C-128  
Effective 1-1-65

All distances must be from the outer boundaries of the Section

Operator <b>THE SUPERIOR OIL COMPANY</b>			Lease <b>SMITH FEDERAL</b>			Well No. <b>1</b>		
Unit Letter <b>F</b>	Section <b>19</b>	Township <b>24 SOUTH</b>	Range <b>34 EAST</b>	County <b>LEA</b>				
Actual Footage Location of Well: <b>1980</b> feet from the <b>NORTH</b> line and <b>1968</b> feet from the <b>WEST</b> line								
Ground Level Elev. <b>3555.0</b>	Producing Formation <b>Morrow</b>		Pool			Dedicated Acreage: <b>320</b> Acres		

1. Outline the acreage dedicated to the subject well by colored pencil or hachure marks on the plat below.
2. If more than one lease is dedicated to the well, outline each and identify the ownership thereof (both as to working interest and royalty).
3. If more than one lease of different ownership is dedicated to the well, have the interests of all owners been consolidated by communitization, unitization, force-pooling, etc?

☐ Yes ☐ No If answer is "yes," type of consolidation \_\_\_\_\_

If answer is "no," list the owners and tract descriptions which have actually been consolidated. (Use reverse side of this form if necessary.) \_\_\_\_\_

No allowable will be assigned to the well until all interests have been consolidated (by communitization, unitization, forced-pooling, or otherwise) or until a non-standard unit, eliminating such interests, has been approved by the Commission.

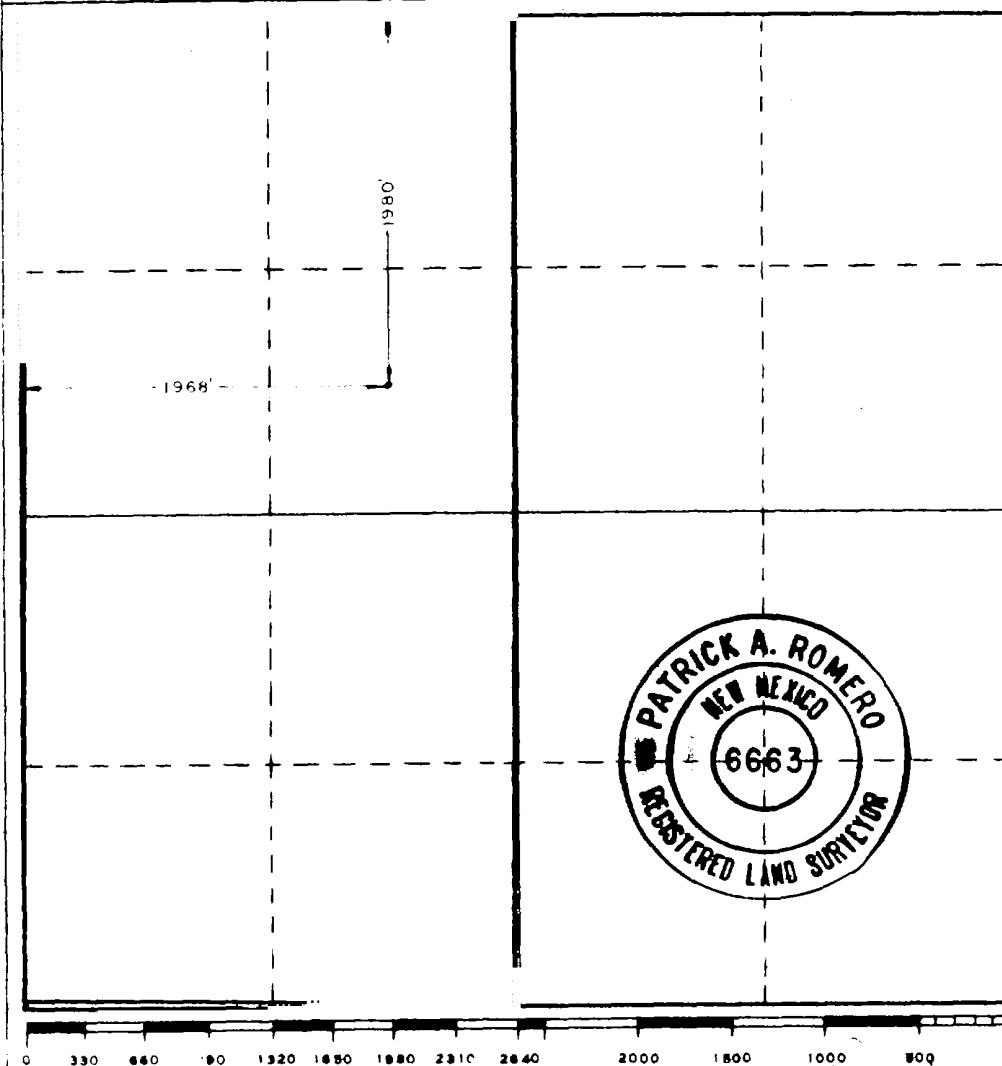

## CERTIFICATION

I hereby certify that the information contained herein is true and complete to the best of my knowledge and belief.

*G. Bannantine*

Name

G. Bannantine

Position

Regulatory Group Manager

Company

THE SUPERIOR OIL COMPANY

Date

June 9, 1981

I hereby certify that the well location shown on this plat was plotted from field notes of actual surveys made by me or under my supervision, and that the same is true and correct to the best of my knowledge and belief.

Date Surveyed

5-5-81

Registered Professional Engineer and/or Land Surveyor

*Patrick A. Romero*

Certificate No. **JOHN W. WEST 676**  
**PATRICK A. ROMERO 6663**  
**Ronald J. Eidsen 3239**

**WRS COMPLETION REPORT**

RE ISSUES SEC 19 TWP 24S RGE 34E  
PI# 30-T-0009 03/21/88 30-025-27491-0000 PAGE 1

NMEX LEA \* 1980FNL 1968FWL SEC SE NW  
STATE COUNTY FOOTAGE SPOT  
SOUTHLAND ROYALTY D D  
OPERATOR WELL CLASS INIT FIM  
1 SMITH FEDERAL  
WELL NO. LEASE NAME  
3579KB 3555GR BELL LAKE S  
OPER ELEV FIELD/POOL/AREA  
API 30-025-27491-0000  
LEASE TYPE/NO. PERMIT OR WELL ID. NO.  
10/19/1981 03/03/1986 ROTARY D&A-OG  
SPUD DATE COMP. DATE TYPE TOOL STATUS  
15200 MORROW RESOURCE INC 6 RIG SUB 23  
PROJ. DEPTH PROJ. FORM CONTRACTOR  
DTD 15120 FM/TD MORROW  
DRILLERS T.D. LOG T.D. PLUG BACK TD OLD T.D. FORM T.D.

**LOCATION DESCRIPTION**

28 MI SE HALFWAY, NM

**WELL IDENTIFICATION/CHANGES**

OPR CHGD FROM SUPERIOR OIL CO  
FINAL CLASS CHGD FROM SUS  
WELL STATUS CHGD FROM SUS

**CASING/LINER DATA**

CSG 30 @ 40 W/ 375 SACKS  
CSG 20 @ 588 W/ 1020 SACKS  
CSG 13 3/8 @ 5203 W/ 4410 SACKS  
CSG 9 5/8 @ 12400 W/ 1250 SACKS  
LNR 5 1/2 12101-15120 W/ 1150S

**TUBING DATA**

TBG 2 7/8 AT 14642

TYPE FORMATION LTH TOP DEPTH/SUB BSE DEPTH/SUB

LOG STRAWN 13232 -9653

**PRODUCTION TEST DATA**

MORROW PERF 14720-14786 GROSS  
PERF 14720-14732 14756-14763 14766-14786  
SWBD 11 BLW

CONTINUED IC# 300257037481

Copyrighted 1988  
Petroleum  
Information Corporation

**Petroleum Information**

**EB** a company of  
The Dun & Bradstreet Corporation

PI-WRS-GET  
Form No 187

REISSUES SEC 19 TWP 24S RGE 34E  
PI# 30-T-0009 03/21/88 30-025-27491-0000 PAGE 2

SOUTHLAND ROYALTY D D  
1 SMITH FEDERAL

-----  
PRODUCTION TEST DATA  
-----

PTF 1UW  
MORROW PERF 14720-14786 GROSS  
WFR 14720-14786 5460GALS  
750 SCF N2  
FLWD WTR & DIED

PTF 295.0MCFD 26BW 10/64CK 24HRS  
MORROW PERF 14720-14786 GROSS

PTF 168.0MCFD 24HRS  
MORROW PERF 14720-14786 GROSS  
FRAC 14720-14786  
ADDTVCO2

26000# BAUXITE

TP 3125  
FLWD 168 MCFG + 2 1/2 BLWPH IN 24 HRS

PTF 590.0MCFD 16/64CK 24HRS  
MORROW PERF 14720-14786 GROSS  
TP 680  
FLWD 590 MCFG + 4 1/2 BLWPH THRU 16/64 CHK, 24 HRS

PTF 1 UG 1UW 8/64CK  
MORROW PERF 14720-14786 GROSS  
FLWG GAS W/WTR MIST THRU 8/64 CHK

PTF 500.0MCFD 1UW 12/64CK 24HRS  
MORROW PERF 14720-14786 GROSS  
TP 1400  
FARO 500 MCFG W/ SPRAY WTR THRU 12/64 CHK, 24 HRS

PTF 3450.0MCFD 12/64CK 24HRS  
MORROW PERF 14476-14503 GROSS  
PERF 14476-14478 14480-14482 14484-14490 14492-14503  
TP 1970  
FARO 3450 MCFG, DECR TO 1000 MCFG THRU 12/64 CHK 24 HR  
NATURAL

PTF 90BW 12/64CK 24HRS  
MORROW REPERF 14476-14503  
PERF 14476-14503  
ACID 14476-14503 7100GALS

CONTINUED

REISSUES SEC 19 TWP 24S RGE 34E  
PI# 30-T-0009 03/21/88 30-025-27491-0000 PAGE 3

SOUTHLAND ROYALTY D D  
1 SMITH FEDERAL

PRODUCTION TEST DATA

PLUG 14476-14503 DEPTH 14020  
FTP - 2900-3725

PTF 20BOPD 80BW 16/64CK 24HRS  
STRAWN PERF 13232-13342 GROSS  
PERF 13232-13254 13270-13274 13282-13286 13294-13302  
PERF 13320-13328 13334-13342  
FTP - 450-200  
NATURAL

PTF 25 MCFD 12/64CK 24HRS  
STRAWN PERF 13232-13342 GROSS  
ACID 13232-13342 5000GALS  
TP 32  
FARO 25-50 MCFGPD THRU 12/64 CK

LOGS AND SURVEYS /INTERVAL,TYPE/

LOGS	FDC	CNL	GRL
LOGS	CBL	VD	CCL

DRILLING PROGRESS DETAILS

SOUTHLAND ROYALTY  
5 DESTA DR  
MIDLAND, TX 79705  
915-686-5600  
ABANDON LOCATION ISSUED 07/20/81  
FORMERLY ABND LOC UNDER API 30-025-27071  
LOCATED 1980 FNL, 1980 FEL SEC

DATE	DESCRIPTION
07/15	LOC/1981/
10/27	588 TD, PREP RUN CSG
11/03	DRLG 3299 (SALT & ANHY)
11/17	DRLG 6081 (SD)
12/01	DRLG 11435 (LM & SH)
12/08	12400 TD, FSG
12/15	DRLG 13350
12/29	13610 TD, FSG
01/05	DRLG 14016 (SH, LM & SD)
01/12	DRLG 14586 (SH)
01/19	DRLG 14984
01/26	15101 TD, RNG 5 1/2 LNR

CONTINUED

REISSUES SEC 19 TWP 24S RGE 34E  
PI# 30-T-0009 03/21/88 30-025-27491-0000 PAGE 4

SOUTHLAND ROYALTY D D  
1 SMITH FEDERAL

DRILLING PROGRESS DETAILS

02/02 15120 TD, RDRT  
02/08 15120 TD, MICU  
02/17 15120 TD, PB 15018, CIRC  
02/23 15120 TD, PB 15018, RNG LOGS  
03/02 15120 TD, PB 15018, SDR  
03/09 15120 TD, PB 15018, SI  
03/30 15120 TD, PB 15018, TSTG  
04/06 15120 TD, PB 15018, TSTG  
04/13 15120 TD, PB 15018, PREP FRAC  
04/20 15120 TD, PB 15108, TSTG  
04/27 15120 TD, PB 15018, SI  
05/05 15120 TD, PB 15018, TEMP ABND  
07/14 15120 TD, PB 15018, TSTG  
07/20 15120 TD, PB 15018, SI EVAL  
08/10 15120 TD, PB 15018, TSTG  
08/17 15120 TD, PB 15018, SI EVAL  
09/01 15120 TD, PB 14020, SWBG  
09/15 15120 TD, PB 14020, SIPBU  
09/21 15120 TD, PB 14020, SI  
01/10 15120 TD, PB 14020, SUSPENDED OPERATIONS  
04/29 LOCAL CALLS: MORROW A-2 14476  
MORROW A-1 14720  
04/29 15120 TD  
COMP 3/3/86, D&A  
NO CORES OR DSTS RPTD  
04/29 REISSUE TO CORRECT TD, FM AT TD, COMP DATE  
FINAL CLASS, WELL STATUS & ADD TBG, KB  
ELEV, LOG TOPS, LOGS RUN & DELETE PB  
REPLACEMENT FOR TCT REISSUED 1/15/83  
03/17 REISSUED TO ADD SPOT, DELETE TITE STATUS  
REPLACEMENT FOR CT ISSUED 5/5/86