

UNIT STATES ~~N. M. OIL CONS. COMMISSION~~
DEPARTMENT OF THE INTERIOR
GEOLOGICAL SURVEY
HOBBS, NEW MEXICO 88240

APPLICATION FOR PERMIT TO DRILL, DEEPEN, OR PLUG BACK

1a. TYPE OF WORK

DRILL ☒

DEEPEN ☐

PLUG BACK ☐

b. TYPE OF WELL

OIL WELL ☒

GAS WELL ☐

OTHER ☐

SINGLE ZONE ☒

MULTIPLE ZONE ☐

2. NAME OF OPERATOR

CONOCO INC.

3. ADDRESS OF OPERATOR

P. O. Box 460, Hobbs, N.M. 88240

4. LOCATION OF WELL (Report location clearly and in accordance with any State requirements.)*

At surface 1930' FSL & 1980' FWL

At proposed prod. zone ☒

14. DISTANCE IN MILES AND DIRECTION FROM NEAREST TOWN OR POST OFFICE*

15. DISTANCE FROM PROPOSED*

LOCATION TO NEAREST PROPERTY OR LEASE LINE, FT. (Also to nearest drlg. unit line, if any)

18. DISTANCE FROM PROPOSED LOCATION*

TO NEAREST WELL, DRILLING, COMPLETED, OR APPLIED FOR, ON THIS LEASE, FT.

21. ELEVATIONS (Show whether DF, RT, GR, etc.)

3164' GL

23.

PROPOSED CASING AND CEMENTING PROGRAM

SIZE OF HOLE

SIZE OF CASING

WEIGHT PER FOOT

SETTING DEPTH

QUANTITY OF CEMENT

12 1/4"
7 7/8"

8 5/8"
5 1/2"

24 #
15.5 #

1500'
4500'

715 sk circulate
810 sk circulate

It is proposed to drill a straight hole to a TD of 4500' and complete it as an East Mason Delaware oil well.

See attachments for 10 point well plan and 13 point surface use plan.

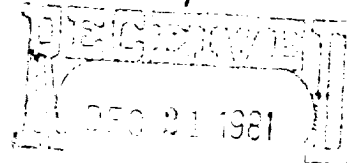

OIL & GAS
U.S. GEOLOGICAL SURVEY
ROSWELL, NEW MEXICO

IN ABOVE SPACE DESCRIBE PROPOSED PROGRAM: If proposal is to deepen or plug back, give data on present productive zone and proposed new productive zone. If proposal is to drill or deepen directionally, give pertinent data on subsurface locations and measured and true vertical depths. Give blowout preventer program, if any.

24.

SIGNED

W. A. Butler

TITLE Administrative Supervisor

DATE Dec 18, 1981

(This space for Federal or State office use)

PERMIT NO.

APPROVED

APPROVAL DATE

APPROVED BY

CONDITIONS OF APPROVAL

83-3642 GEORGE H. STEVENS

JAN 18 1982

FOR
JAMES A. GIMBACH
DISTRICT SUPERVISOR

APPROVAL SUBJECT TO
GENERAL REGULATIONS AND
SPECIAL INSTRUCTIONS

*See Instructions On Reverse Side

NEW MEXICO OIL CONSERVATION COMMISSION
WELL LOCATION AND ACREAGE DEDICATION PLAT

Form O-15
Superseded O-12A
Effective 10-65

All distances must be from the outer boundaries of the Section

Owner Conoco, Inc.		Lease Russell Federal 17 <i>Federal</i>		Well No. 12	
Tract Letter K	Section 17	Township 26 South	Range 32 East	County Lea	
Actual Footage Location of Well: 1980 feet from the South line and 1980 feet from the West line					
Ground Level Elev. 3164.1'	Producing Formation Delaware	Pool East Mason Delaware		Dedicated Acreage 40	

1. Outline the acreage dedicated to the subject well by colored pencil or hatchure marks on the plat below.
2. If more than one lease is dedicated to the well, outline each and identify the ownership thereof (both as to working interest and royalty).
3. If more than one lease of different ownership is dedicated to the well, have the interests of all owners been consolidated by communitization, unitization, force-pooling, etc?

☐ Yes ☐ No If answer is "yes," type of consolidation _____

If answer is "no," list the owners and tract descriptions which have actually been consolidated. (Use reverse side of this form if necessary.) _____

No allowable will be assigned to the well until all interests have been consolidated (by communitization, unitization, forced-pooling, or otherwise) or until a non-standard unit, eliminating such interests, has been approved by the Commission.

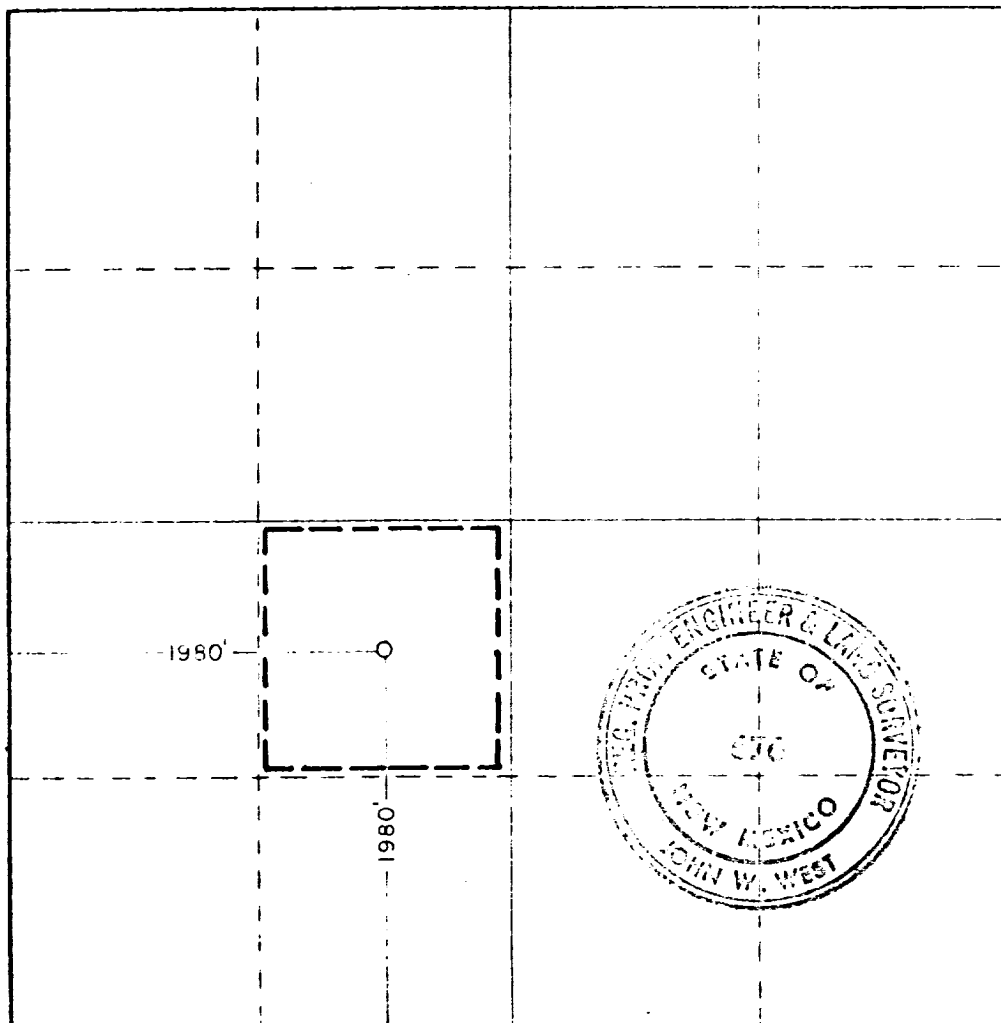

CERTIFICATION

I hereby certify that the information contained herein is true and complete to the best of my knowledge and belief.

Wm A. Butler
Administrative Supervisor
Conoco Inc.

December 18, 1981

I hereby certify that the well location shown on this plat was plotted from field notes of actual surveys made by me or under my supervision, and that the same is true and correct to the best of my knowledge and belief.

Date Surveyed:

Dec. 17, 1981

Registered Professional Engineer
and/or Land Surveyor

John W. West

Certificate No. **JOHN W. WEST 676**
PATRICK A. ROMERO 6633
Ronald J. Edgson 3239

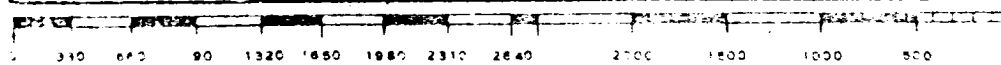

CONTINENTAL OIL COMPANY
Blow-out Preventer Specifications

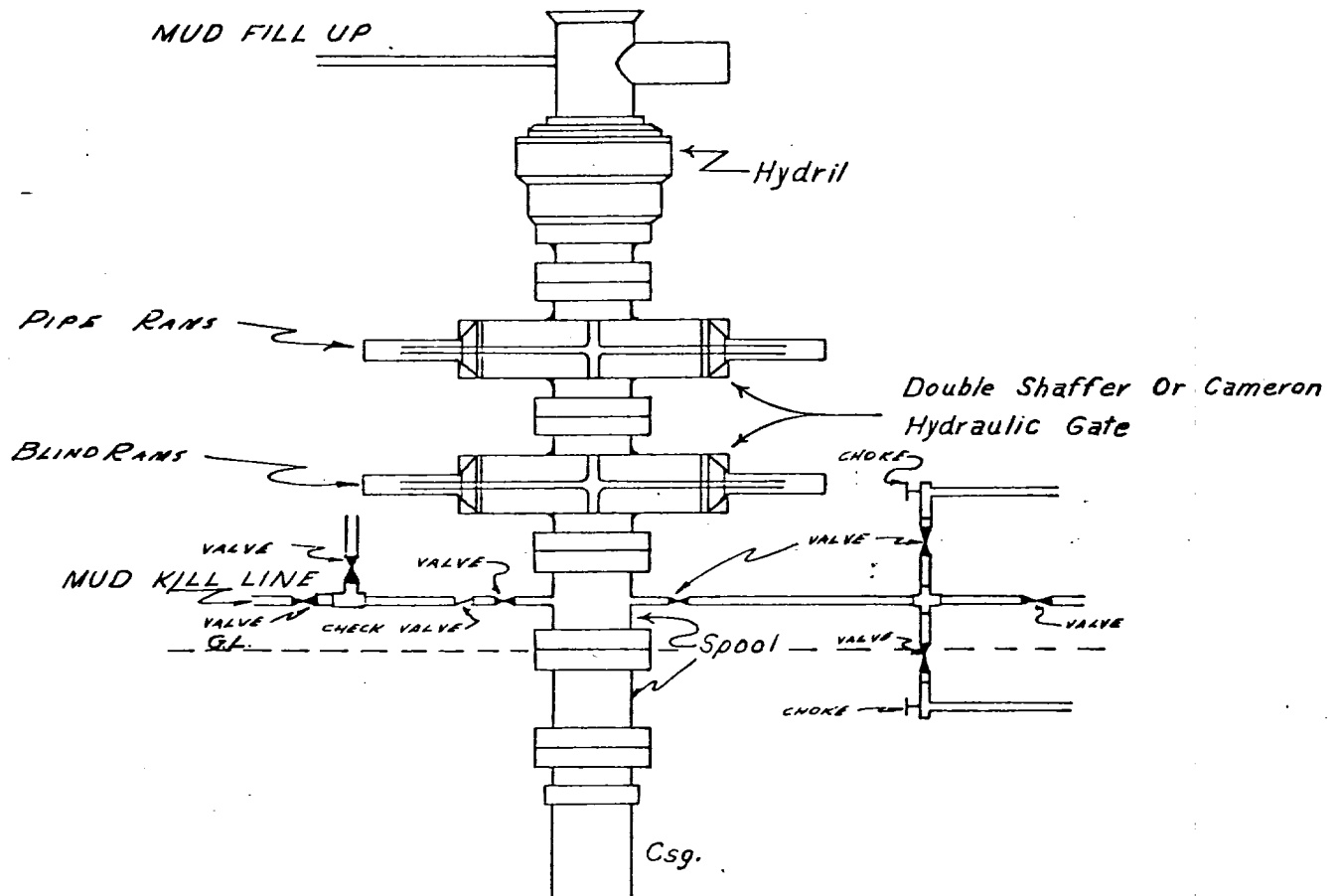

NOTE:

Manual and Hydraulic controls with closing unit no less than 75' from well head.
Remote controls on rig floor.

**DUE TO SUBSTRUCTURE CLEARANCE,
HYDRIL MAY OR MAY NOT BE USED.**

RECEIVED

JAN 21 199

173

21/8/8
for [unclear]
[unclear]