

NEW MEXICO OIL CONSERVATION COMMISSION  
WELL LOCATION AND ACREAGE DEDICATION PLAT

Form C-102  
Supersedes C-128  
Effective 1-1-65

All distances must be from the outer boundaries of the Section.

Operator <b>Texaco Inc.</b>		Lease <b>C. W. Shepherd Federal</b>		Well No. <b>7</b>
Unit Letter <b>B</b>	Section <b>5</b>	Township <b>26-S</b>	Range <b>37-E</b>	County <b>Lea</b>
Actual Footage Location of Well: <b>660</b> feet from the <b>North</b> line and <b>1980</b> feet from the <b>East</b> line				
Ground Level Elev. <b>2977'</b>	Producing Formation <b>Seven Rivers/Queen</b>	Pool <b>Langlie Mattix, Seven Rivers, Queen, Grayburg</b>	Dedicated Acreage: <b>40</b> Acres	

1. Outline the acreage dedicated to the subject well by colored pencil or hachure marks on the plat below.
2. If more than one lease is dedicated to the well, outline each and identify the ownership thereof (both as to working interest and royalty).
3. If more than one lease of different ownership is dedicated to the well, have the interests of all owners been consolidated by communitization, unitization, force-pooling, etc?

☐ Yes ☐ No If answer is "yes," type of consolidation \_\_\_\_\_

If answer is "no," list the owners and tract descriptions which have actually been consolidated. (Use reverse side of this form if necessary.) \_\_\_\_\_

No allowable will be assigned to the well until all interests have been consolidated (by communitization, unitization, forced-pooling, or otherwise) or until a non-standard unit, eliminating such interests, has been approved by the Commission.

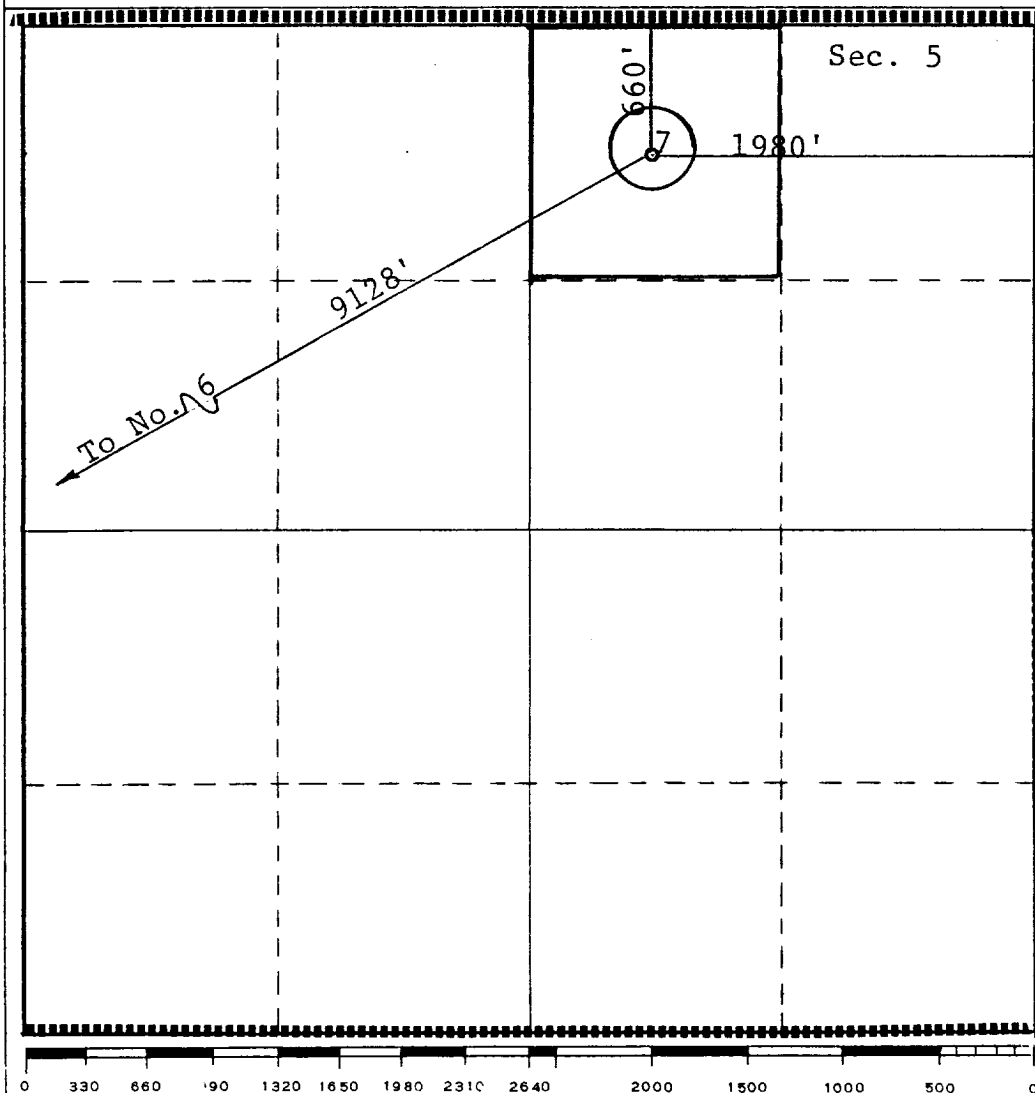

CERTIFICATION

I hereby certify that the information contained herein is true and complete to the best of my knowledge and belief.

*B. L. Eiland*

Name

**B. L. Eiland**

Position

**Division Surveyor**

Company

**Texaco Inc.**

Date

**September 2, 1982**

I hereby certify that the well location shown on this plat was plotted from field notes of actual surveys made by me or under my supervision, and that the same is true and correct to the best of my knowledge and belief.



Certificate  
**4386**

# DRILLING CONTROL CONDITION II-3000 PSI WP

H<sub>2</sub>S TRIM REQUIRED  
YES \_\_\_\_\_ NO \_\_\_\_\_

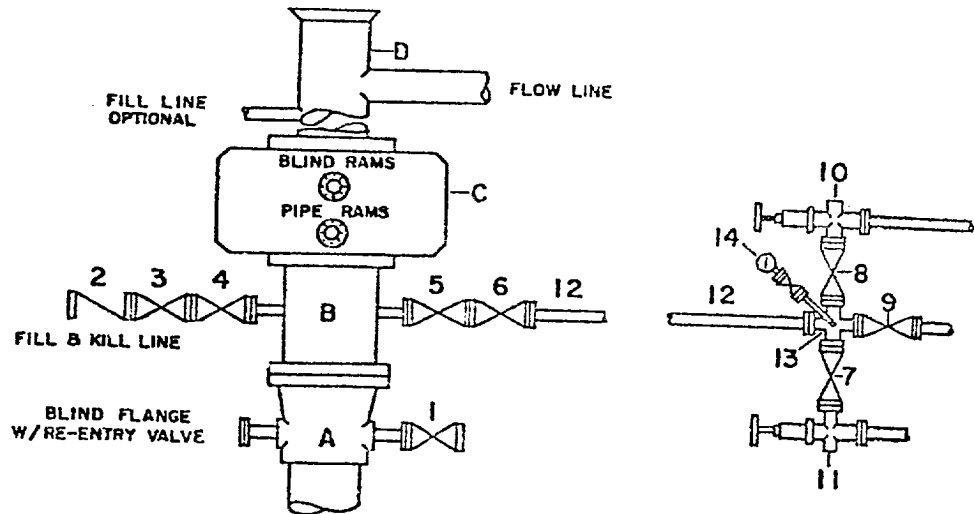

## DRILLING CONTROL

### MATERIAL LIST - CONDITION II

- |           |   |
|-----------|---|
| A         | Texaco Wellhead   |
| B         | 3000# W.P. drilling spool with a 2" minimum flanged outlet for kill-line and 3" minimum flanged outlet for choke line   |
| C         | 3000# W.P. Dual ram type preventer, hydraulic operated with 1" steel, 3000# W.P. control lines (where sub-structure height is adequate, 2-3000# W.P. single ram type preventers may be utilized.) |
| D         | Bell nipple with flowline and fill-up outlets. (Kill line may also be used for fill-up line.)   |
| 1,3,4,7,8 | 2" minimum 3000# W.P. flanged full opening steel gate valve, or Halliburton Lo Torc Plug valve.   |
| 2         | 2" minimum 3000# W.P. back pressure valve   |
| 5,6,9     | 3" minimum 3000# W.P. flanged full opening steel gate valve, or Halliburton Lo Torc Plug valve.   |
| 12        | 3" minimum schedule 80, Grade "B", seamless line pipe   |
| 13        | 2" minimum x 3" minimum 3000# W.P. flanged cross  |
| 10, 11    | 2" minimum 3000# W.P. adjustable choke bodies   |
| 14        | Cameron Mud Gauge or equivalent (location optional in choke line.)  |

SCALE	DATE	EST. NO.	DRG. NO.
DRAWN BY			
CHECKED BY			
APPROVED BY			



TEXACO, INC.  
PRODUCING DEPARTMENT-U.S. (CENT.)  
MIDLAND, TEXAS



EXHIBIT B

RECEIVED

DEC 30 1982

U.S. HOUSE OF REPRESENTATIVES  
HONORARY OFFICE

FILE