

NO. OF COPIES RECEIVED		
DISTRIBUTION		
SANTA FE		
FILE		
U.S.G.S.		
LAND OFFICE		
OPERATOR		

NEW MEXICO OIL CONSERVATION COMMISSION

Form C-101
Revised 1-1-65

API No. 30-025-28250

5A. Indicate Type of Lease	
STATE <input type="checkbox"/>	FEE <input checked="" type="checkbox"/>
5. State Oil & Gas Lease No.	

APPLICATION FOR PERMIT TO DRILL, DEEPEN, OR PLUG BACK

1a. Type of Work		7. Unit Agreement Name	
b. Type of Well OIL WELL <input checked="" type="checkbox"/> GAS WELL <input type="checkbox"/> OTHER <input type="checkbox"/>		8. Farm or Lease Name S. R. Cooper "A"	
2. Name of Operator Sun Exploration & Production Co. - Midland		9. Well No. 3	
3. Address of Operator P. O. Box 1861, Midland, Texas 79702		10. Field and Pool, or Wildcat Jalmat Tansill Yates Seven Rivers	
4. Location of Well UNIT LETTER <u>A</u> LOCATED <u>660</u> FEET FROM THE <u>North</u> LINE AND <u>990</u> FEET FROM THE <u>East</u> LINE OF SEC. <u>23</u> TWP. <u>24-S</u> RGE. <u>36-E</u> NMPM		12. County Lea	
19. Proposed Depth 3700'		19A. Formation *Seven Rivers	
21. Elevations (Show whether DT, RT, etc.) 3341.9'		20. Rotary or C.T. Rotary	
21A. Kind & Status Plug. Bond Blanket on file		22. Approx. Date Work will start ASAP	

PROPOSED CASING AND CEMENT PROGRAM

SIZE OF HOLE	SIZE OF CASING	WEIGHT PER FOOT	SETTING DEPTH	SACKS OF CEMENT	EST. TOP
12 1/2"	8-5/8"	24#	550'	400 sx	Surface
7-7/8"	5-1/2"	14#	3600'	850 sx	Surface

10" hydraulic blowout preventer

19A.* Primary Reservoir - Seven Rivers - Expect top at 3150'
Secondary Reservoir - Yates - Expect top at 2945'

IN ABOVE SPACE DESCRIBE PROPOSED PROGRAM: IF PROPOSAL IS TO DEEPEN OR PLUG BACK, GIVE DATA ON PRESENT PRODUCTIVE ZONE AND PROPOSED NEW PRODUCTIVE ZONE. GIVE BLOWOUT PREVENTER PROGRAM, IF ANY.

I hereby certify that the information above is true and complete to the best of my knowledge and belief.

Signed Maria L. Perry Title Sr. Accounting Asst. Date 6-23-83

(This space for State Use)

ORIGINAL SIGNED BY JERRY SEXTON

APPROVED BY DISTRICT SUPERVISOR

TITLE

DATE

JUN 27 1983

CONDITIONS OF APPROVAL, IF ANY:

APPROVAL VALID FOR 180 DAYS
PERMIT EXPIRES 12/27/83
UNLESS OIL IS UNDERWAY

RECEIVED

JUN 24 1977

U.S. GOVT.
HQSBS OFFICE

BLOWOUT - PREVENTER ASSEMBLY

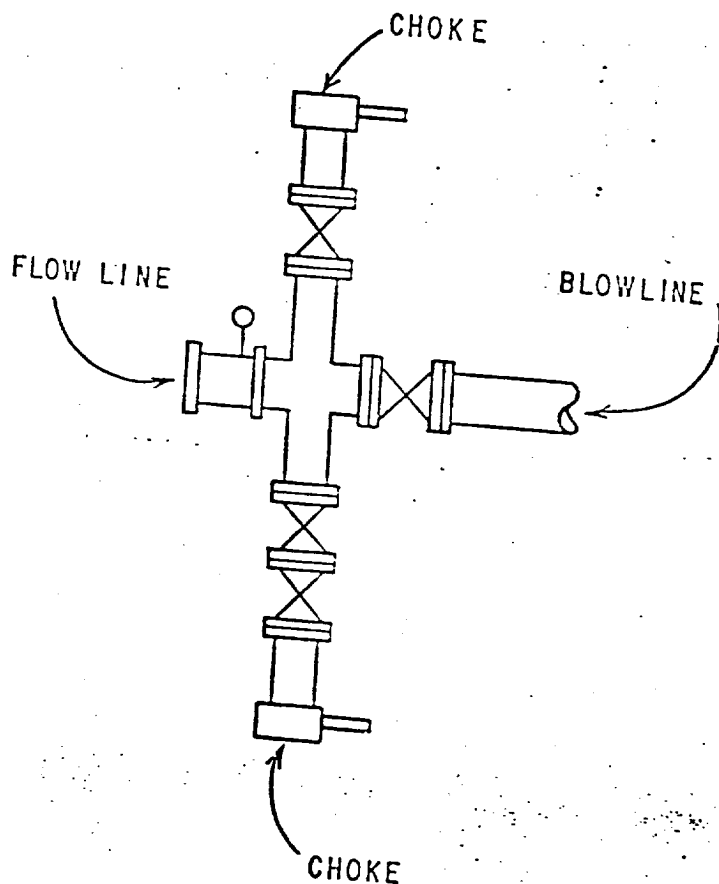
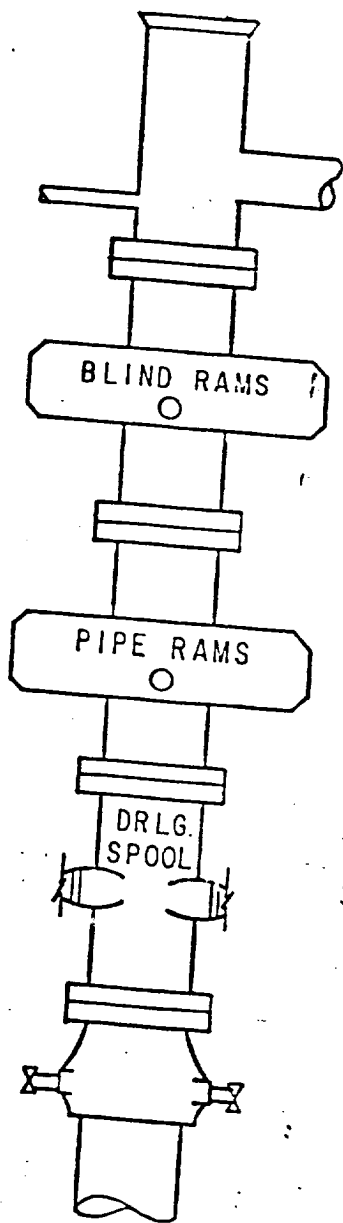

NEW MEXICO OIL CONSERVATION COMMISSION
WELL LOCATION AND ACREAGE DEDICATION PLAT

Form C-102
Supersedes C-128
Effective 1-1-65

All distances must be from the outer boundaries of the Section

Operator Sun Exploration and Production Company			Lease S. R. Cooper "A"		Well No. 3
Unit Letter A	Section 23	Township 24 South	Range 36 East	County Lea County	
Actual Footage Location of Well:					
990 feet from the East line and		660 feet from the North line			
Ground Level Elev. 3345.4	East of Section Corner Jalmar Tansill Yates Seven Rivers		Foot Seven Rivers		Dedicated Acreage: 40 Acres

1. Outline the acreage dedicated to the subject well by colored pencil or hatchure marks on the plat below.
2. If more than one lease is dedicated to the well, outline each and identify the ownership thereof (both as to working interest and royalty).
3. If more than one lease of different ownership is dedicated to the well, have the interests of all owners been consolidated by communitization, unitization, force-pooling, etc?

☐ Yes ☐ No If answer is "yes," type of consolidation _____

If answer is "no," list the owners and tract descriptions which have actually been consolidated. (Use reverse side of this form if necessary.) _____

No allowable will be assigned to the well until all interests have been consolidated (by communitization, unitization, forced-pooling, or otherwise) or until a non-standard unit, eliminating such interests, has been approved by the Commission.

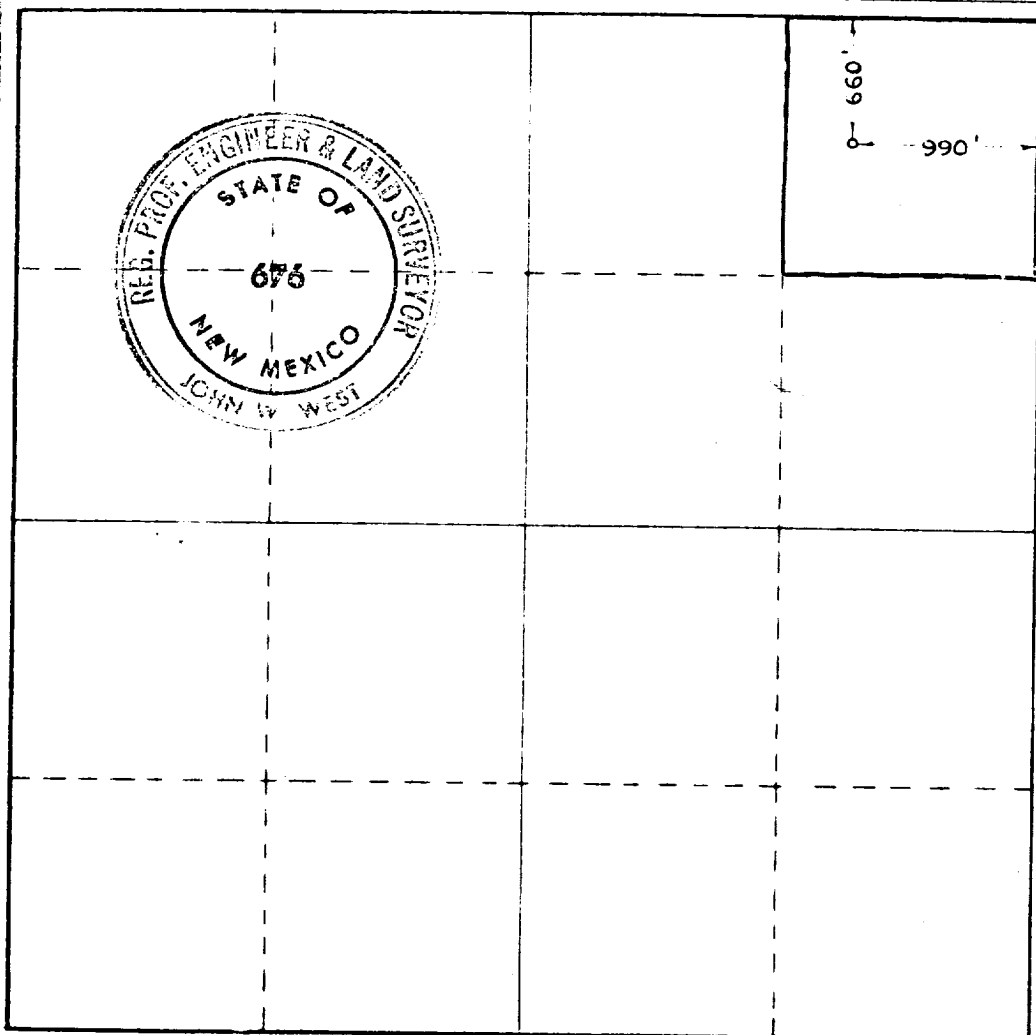

CERTIFICATION

I hereby certify that the information contained herein is true and complete to the best of my knowledge and belief.

Maria L. Perez
Name

Maria L. Perez

Position
Sr. Accounting Assistant

Company
Sun Exploration & Prod. Co.

Date
6-23-83

I hereby certify that the well location shown on this plat was plotted from field notes of actual surveys made by me or under my supervision, and that the same is true and correct to the best of my knowledge and belief.

Date Surveyed
June 13, 1983

Registered Professional Engineer
and or Land Surveyor

John W. West

Certificate No.
JOHN W. WEST NO. 676

RECEIVED

JUN 26 1967

U.S. AIR FORCE
HAGERSVILLE

173