

**MEXICO OIL CONSERVATION COMMISSION
WELL LOCATION AND ACREAGE DEDICATION PLAT**

Form C-124
Supersedes C-124
Effective 12-65

All distances must be from the outer boundaries of the Section

Owner: SOUTHLAND ROYALTY CO.			Lease: MADERA RIDGE 22 STATE		Well No: 1
Section: 22	Township: 24 SOUTH	Range: 1 EAST	County: LEA		
Section Boundary Location of Wells: 180 feet from the SOUTH line and 180 feet from the EAST line					
Ground Level Elev: 5555.2'	Producing Formation: Wolfcamp	Pool: Undesignated	Designated Acreage: 320		

1. Outline the acreage dedicated to the subject well by colored pencil or hachure marks on the plat below.
2. If more than one lease is dedicated to the well, outline each and identify the ownership thereof (both as to working interest and royalty).
3. If more than one lease of different ownership is dedicated to the well, have the interests of all owners been consolidated by communitization, unitization, force-pooling, etc?

☐ Yes ☒ No If answer is "yes," type of consolidation _____

If answer is "no," list the owners and tract descriptions which have actually been consolidated. (Use reverse side of this form if necessary.) _____

No allowable will be assigned to the well until all interests have been consolidated (by communitization, unitization, forced-pooling, or otherwise) or until a non-standard unit, eliminating such interests, has been approved by the Commission.

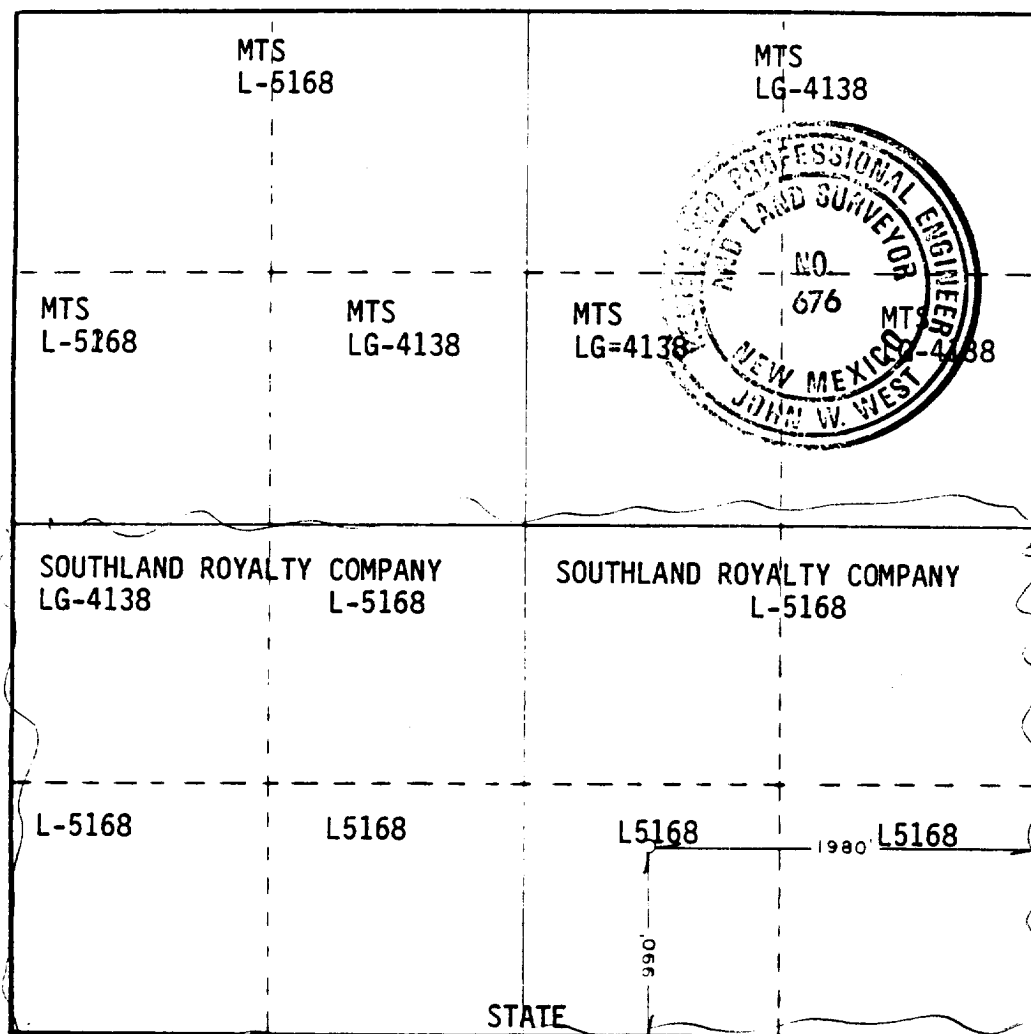

CERTIFICATION

I hereby certify that the information contained herein is true and complete to the best of my knowledge and belief

Darrell Roberts

Darrell Roberts

Operations Engineer

Southland Royalty Company

9/20/85

I hereby certify that the well location shown on this plat was plotted from field notes of actual surveys made by me or under my supervision, and that the same is true and correct to the best of my knowledge and belief.

Date Surveyed: **SEPTEMBER 17, 1985**

Registered Professional Engineer and/or Land Surveyor

John W. West

Certificate No. **JOHN W. WEST, 676**
RONALD J. EIDSON, 3239

RECEIVED

JAN 29 1986

HOUSE OF REPRESENTATIVES