

EXHIBIT "A"

OIL CONSERVATION DIVISION

STATE OF NEW MEXICO
ENERGY AND MINERALS DEPARTMENTP. O. BOX 2088
SANTA FE, NEW MEXICO 87501Form C-102
Revised 10-1-78

All distances must be from the outer boundaries of the Section.

Operator TAHOE OIL & CATTLE COMPANY			Lease WIMBERLY		Well No. 6
Unit Letter N	Section 11	Township 24-S	Range 32-E	County LEA	
Actual Footage Location of Well: 660 feet from the South line and 2310 feet from the West line					
Ground Level Elev. 3629	Producing Formation Delaware		Pool Double X Delaware		Dedicated Acreage: 40 Acres

1. Outline the acreage dedicated to the subject well by colored pencil or hachure marks on the plat below.
2. If more than one lease is dedicated to the well, outline each and identify the ownership thereof (both as to working interest and royalty).
3. If more than one lease of different ownership is dedicated to the well, have the interests of all owners been consolidated by communitization, unitization, force-pooling, etc?

☐ Yes ☐ No If answer is "yes," type of consolidation _____

If answer is "no," list the owners and tract descriptions which have actually been consolidated. (Use reverse side of this form if necessary.) _____

No allowable will be assigned to the well until all interests have been consolidated (by communitization, unitization, forced-pooling, or otherwise) or until a non-standard unit, eliminating such interests, has been approved by the Division.

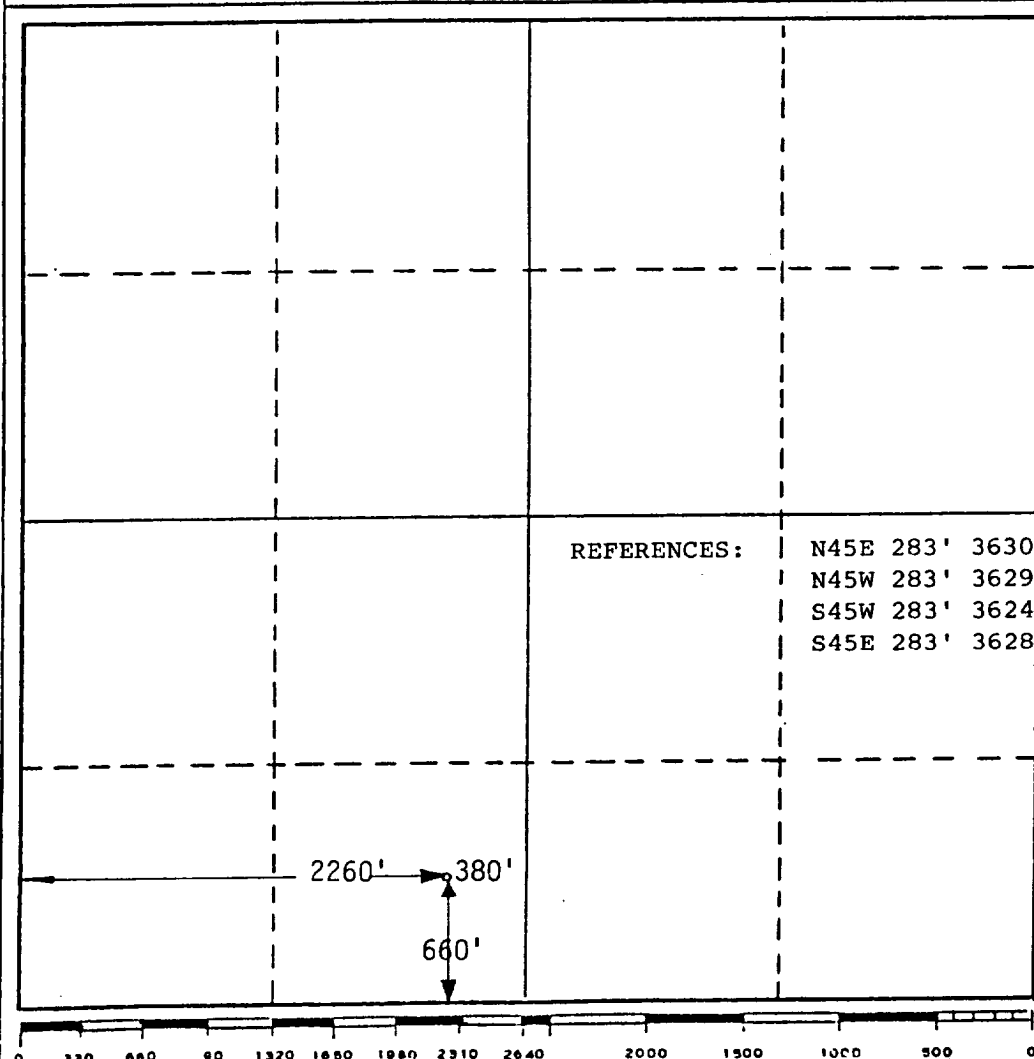

CERTIFICATION

I hereby certify that the information contained herein is true and complete to the best of my knowledge and belief.

Name

Owner/Petroleum Engineer

Position

Tahoe Oil & Cattle Co.

Company

October 1, 1987

Date

I hereby certify that the well location shown on this plat was plotted from field notes of actual surveys made by me or under my supervision, and that the same is true and correct to the best of my knowledge and belief.

September 28, 1987

Date Surveyed

RICHARD B. DUNIVEN

Registered Professional Engineer
and/or Land Surveyor

Certificate No.

4882

RECEIVED

OCT 21 1987

OCCD
HOBBS OFFICE

(1)

EXHIBIT "B"

DRILLING PROGRAM TO
ACCOMPANY A.P.D. FORM 3160-3

Attached to Form 3160-3
Tahoe Oil & Cattle Company
Wimberly #6
SE SW Section 11, T-24-S, R-32-E
2310' FWL & 660' FSL
Lea County, New Mexico

1. The Geologic Surface Formation:

The surface formation is Alluvian.

2. Estimated Tops and Bottoms of Important Geologic Markers:

Salt	4850 → 1500'	4670'
Lamar Lime	4905'	4955'
Ramsey Sand	4955' SJS	5030'
Total Depth:	<u>5100'</u>	

3. Estimated Depth of Anticipated Water, Oil, Gas or Minerals and Lessee's or Operator's Plans for Protection of Such Resources:

Ramsey Sand 4955'

Oil - protected by 4½" production casing and cement.

Fresh water above 400 feet will be cased off before drilling deeper.

4. The Proposed Casing Program:

<u>Hole Size</u>	<u>Setting Depth Interval</u>	<u>Section Length</u>	<u>Size (OD)</u>	<u>Weight, Grade, & Joint</u>	<u>Condition</u>
11"	0-415'	415'	7 5/8"	24#, H-40-STC	New
6 3/4"	0-5100'	5100'	4 1/2"	9.5#, J-55-STC	New

Cement Program:

Surface

Casing: 250 sx class "c" plus 2% Ca Cl, circulated to surface.

Production → 300 sx

Casing: 125 sx class "c" plus 5 lbs per sack salt, calculated cement top 4,000'.

88-41-8 800
173