

50-025 50241

STATE OF NEW MEXICO
ENERGY AND MINERALS DEPARTMENT

OIL CONSERVATION DIVISION

P. O. BOX 2088
SANTA FE, NEW MEXICO 87501

Form C-101
Revised 10-1-78

NO. OF COPIES RECEIVED	
DISTRIBUTION	
SANTA FE	
FILE	
U.S.G.S.	
LAND OFFICE	
OPERATOR	

5A. Indicate Type of Lease STATE <input checked="" type="checkbox"/> FEE <input type="checkbox"/>
5. State Oil & Gas Lease No. B-9312

APPLICATION FOR PERMIT TO DRILL, DEEPEN, OR PLUG BACK

1a. Type of Work
 DRILL ☒ DEEPEN ☐ PLUG BACK ☐
 b. Type of Well
 OIL WELL ☒ GAS WELL ☐ OTHER ☐
 SINGLE ZONE ☒ MULTIPLE ZONE ☐

7. Unit Agreement Name West Dollarhide Queen Sand Unit
8. Farm or Lease Name

2. Name of Operator
Sirgo-Collier, Inc.

9. Well No. 117

3. Address of Operator
P. O. Box 3531, Midland, Texas 79702

10. Field and Pool, or Wildcat Dollarhide Queen
--

4. Location of Well
 UNIT LETTER D LOCATED 100 FEET FROM THE North LINE
 AND 1210 FEET FROM THE West LINE OF SEC. 5 TWP. 25S RGE. 38E NMPM

12. County Lea

11. Elevations (Show whether DF, RT, etc.) 3137' GR 3148.5' KB	21A. Kind & Status Plug. Bond Cash Statewide	19. Proposed Depth 3950'	19A. Formation Queen	20. Rotary or C.T. Rotary	22. Approx. Date Work will start February 29, 1988
21B. Drilling Contractor Peterson Drilling					

23. PROPOSED CASING AND CEMENT PROGRAM

SIZE OF HOLE	SIZE OF CASING	WEIGHT PER FOOT	SETTING DEPTH	SACKS OF CEMENT	EST. TOP
12-1/4"	8-5/8"	24#	420'	250	Surface
7-7/8"	5-1/2"	15.5 & 17#	3950'	1200	Surface

The Queen zone will be selectively perforated and stimulated as needed for optimum production.

Texaco Producing, Inc. operates the Mexico "L" #26 and the West Dollarhide Drinkard Unit #79, also located in this quarter quarter section.

ABOVE SPACE DESCRIBE PROPOSED PROGRAM; IF PROPOSAL IS TO DEEPEN OR PLUG BACK, GIVE DATA ON PRESENT PRODUCTIVE ZONE AND PROPOSED NEW PRODUCTIVE ZONE. GIVE BLOWOUT PREVENTER PROGRAM, IF ANY.

hereby certify that the information above is true and complete to the best of my knowledge and belief.

Signed Amy L. Whitley Title Agent Date February 18, 1988
 (This space for State Use)

ORIGINAL SIGNED BY JERRY SEXTON

APPROVED BY DISTRICT 1 SUPERVISOR TITLE DATE MAR 10 1988

CONDITIONS OF APPROVAL, IF ANY:

NSL-2469 (2nd Amendment)

Permit Expires 6 Months From Approval
Date Unless Drilling Underway.

**NEW MEXICO OIL CONSERVATION COMMISSION
WELL LOCATION AND ACREAGE DEDICATION PLAT**

Form C-102
Supersedes C-128
Effective 1-1-65

All distances must be from the outer boundaries of the Section.

Operator SIRGO-COLLIER, INC.			Lease West Dollarhide Queen WDQSU Sand Unit		Well No. 117
Unit Letter D	Section 5	Township 25 South	Range 38 East	County Lea County, N.M.	
Actual Footage Location of Well: 100 feet from the North line and 1210 feet from the West line					
Ground Level Elev. 3137.	Producing Formation Queen		Pool Dollarhide Queen		Dedicated Acreage: 40 Acres

1. Outline the acreage dedicated to the subject well by colored pencil or hachure marks on the plat below.
2. If more than one lease is dedicated to the well, outline each and identify the ownership thereof (both as to working interest and royalty).
3. If more than one lease of different ownership is dedicated to the well, have the interests of all owners been consolidated by communitization, unitization, force-pooling, etc?

☒ Yes ☐ No If answer is "yes," type of consolidation **Unitization, R-2356**

If answer is "no," list the owners and tract descriptions which have actually been consolidated. (Use reverse side of this form if necessary.) _____

No allowable will be assigned to the well until all interests have been consolidated (by communitization, unitization, forced-pooling, or otherwise) or until a non-standard unit, eliminating such interests, has been approved by the Commission.

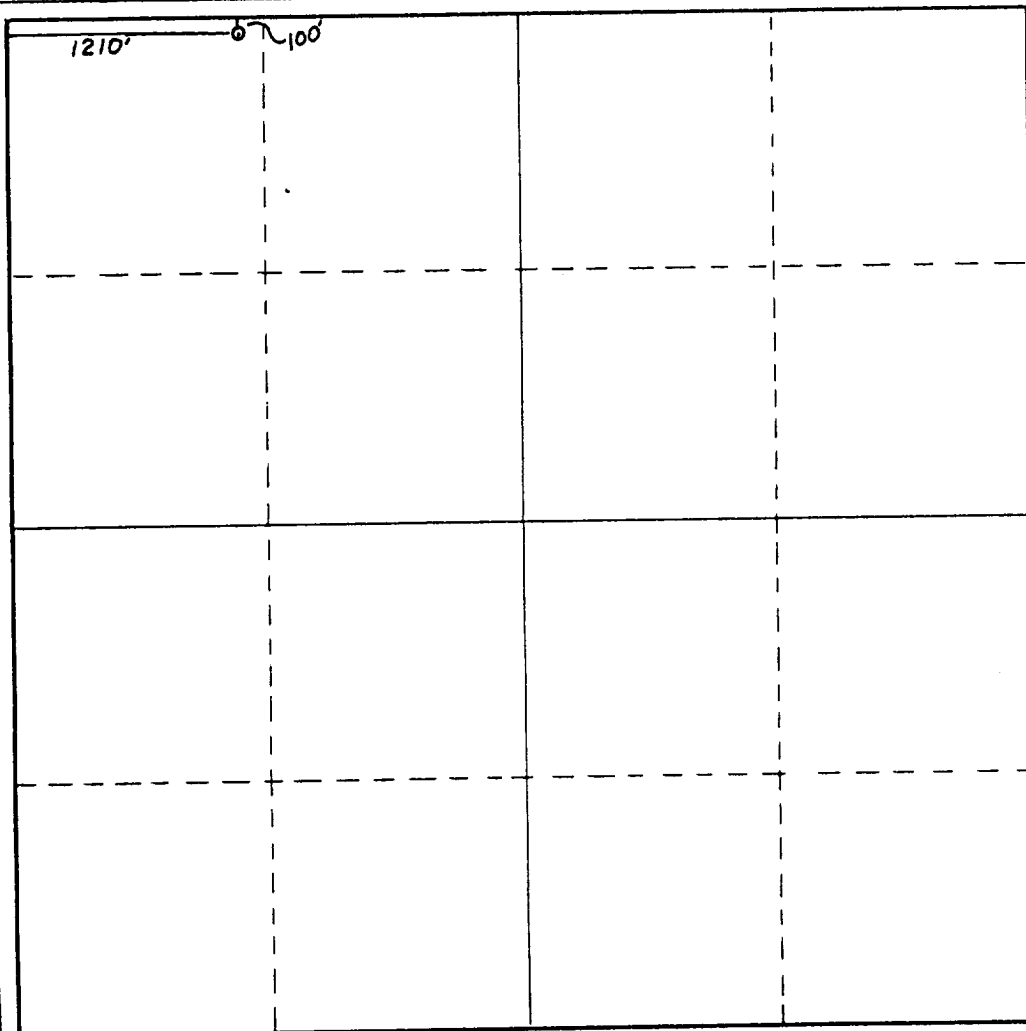

CERTIFICATION

I hereby certify that the information contained herein is true and complete to the best of my knowledge and belief.

Amy L. Whitley

Name

Amy L. Whitley

Position

Agent

Company

Sirgo-Collier, Inc.

Date

February 18, 1988

I hereby certify that the well location shown on this plat was plotted from field notes of actual surveys made by me or under my supervision, and that the same is true and correct to the best of my knowledge and belief.

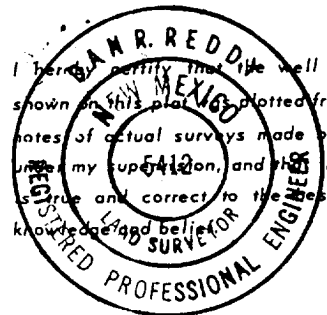

Date Surveyed

February 12, 1988

Registered Professional Engineer and/or Land Surveyor

Dan R. Reddy

Certificate No.

NM PE&LS NO. 5412

0 330 660 990 1320 1650 1980 2310 2640 2970 3300 3630 3960 4290 4620 4950 5280 5610 5940 6270 6600

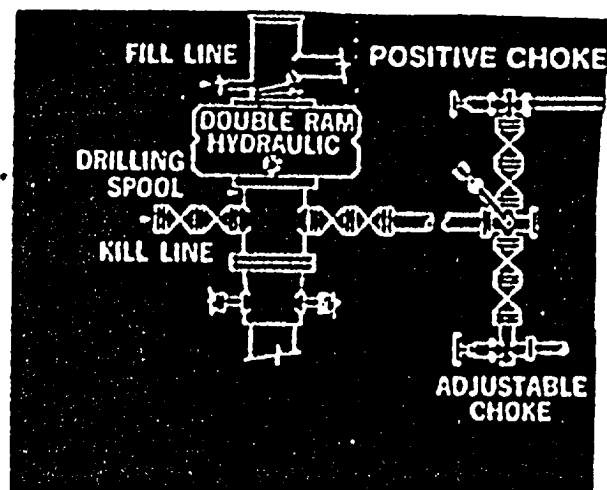

RECEIVED
FEB 19 1988
OCD
HOBBS OFFICE

88-82-7 1004
173