

Submit to Appropriate  
District Office  
State Lease - 4 copies  
Fee Lease - 3 copies

State of New Mexico  
Energy, Minerals and Natural Resources Department

Form C-102  
Revised 1-1-89

OIL CONSERVATION DIVISION

DISTRICT I  
P.O. Box 1980, Hobbs, NM 88240

P.O. Box 2088

Santa Fe, New Mexico 87504-2088

DISTRICT II  
P.O. Drawer DD, Artesia, NM 88210

DISTRICT III  
1000 Rio Brazos Rd., Aztec, NM 87410

WELL LOCATION AND ACREAGE DEDICATION PLAT

All Distances must be from the outer boundaries of the section

Operator MERIDIAN OIL INC.			Lease C.W. SHEPHERD FED.		Well No. 9
Unit Letter K	Section 5	Township 26 SOUTH	Range 37 EAST	County LEA	

Actual Footage Location of Well:

1980 feet from the WEST line and		1930 feet from the SOUTH line	
Ground level Elev. 2979.7	Producing Formation Yates Sand	Pool Rhodes-Yates-7 Rvrs-Gas	Dedicated Acreage: 160 Acres

- Outline the acreage dedicated to the subject well by colored pencil or hatchure marks on the plat below.
- If more than one lease is dedicated to the well, outline each and identify the ownership thereof (both as to working interest and royalty).
- If more than one lease of different ownership is dedicated to the well, have the interest of all owners been consolidated by communitization, unitization, force-pooling, etc.?  
☐ Yes ☐ No If answer is "yes" type of consolidation \_\_\_\_\_  
If answer is "no" list the owners and tract descriptions which have actually been consolidated. (Use reverse side of this form if necessary). \_\_\_\_\_  
No allowable will be assigned to the well until all interests have been consolidated (by communitization, unitization, forced-pooling, or otherwise) or until a non-standard unit, eliminating such interest, has been approved by the Division.

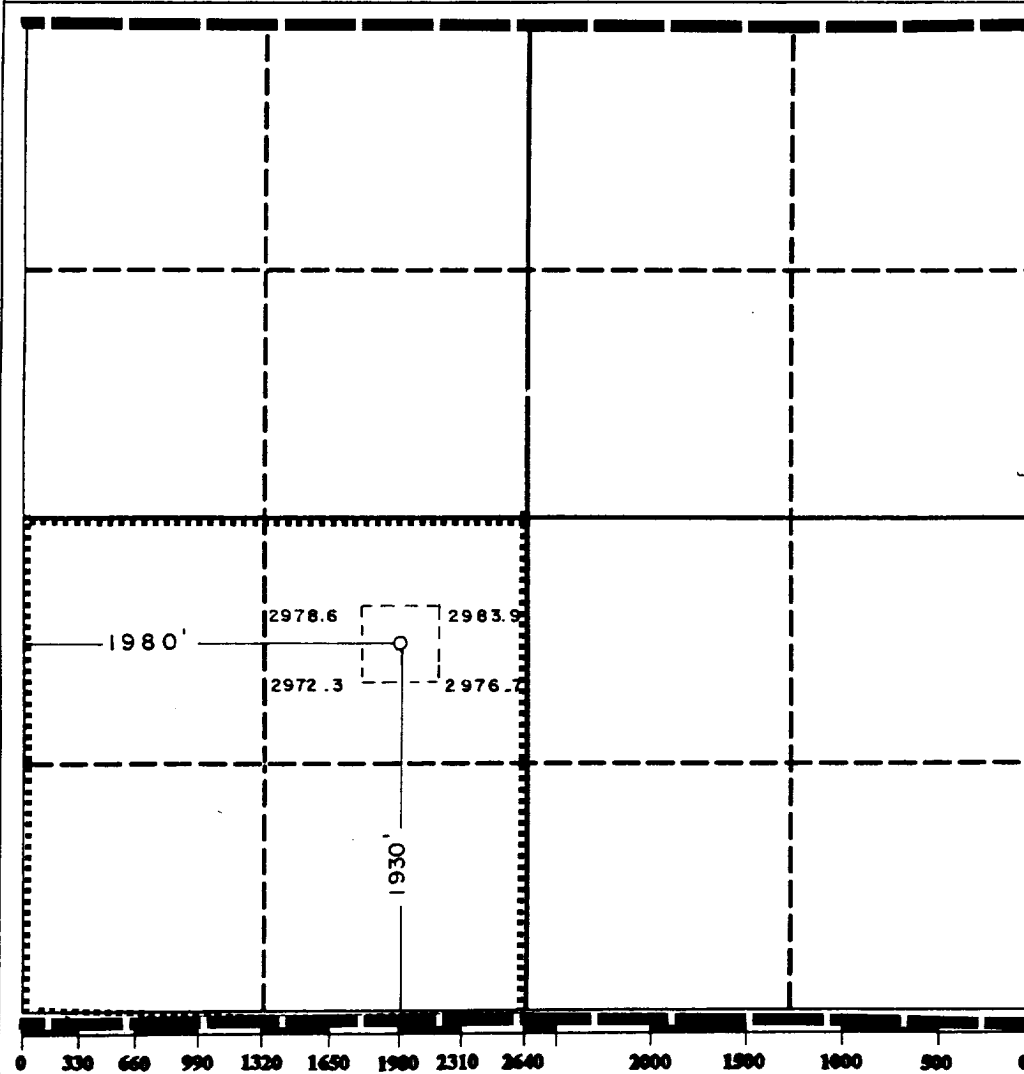

OPERATOR CERTIFICATION

I hereby certify that the information contained herein in true and complete to the best of my knowledge and belief.

Signature  
Printed Name  
Connie L. Malik  
Position  
Reg. Compliance Rep.  
Company  
Meridian Oil Inc.  
Date  
10-15-91

SURVEYOR CERTIFICATION

I hereby certify that the well location shown on this plat was plotted from field notes of actual surveys made by me or under my supervision, and that the same is true and correct to the best of my knowledge and belief.

Date Surveyed  
9-24-91  
Signature & Seal of Professional Surveyor  
No. 3239  
Certificate No. 676  
DONALD J. EIDSON

91-11-0015

REF ID: A6

NOV 20 1981

62-40  
HQBBS OFFICE

BLOW OUT PREVENTION EQUIPMENT  
 10" 900s ALL FLANGED CONNECTIONS  
 3,000# WORKING PRESSURE - 6,000# TEST

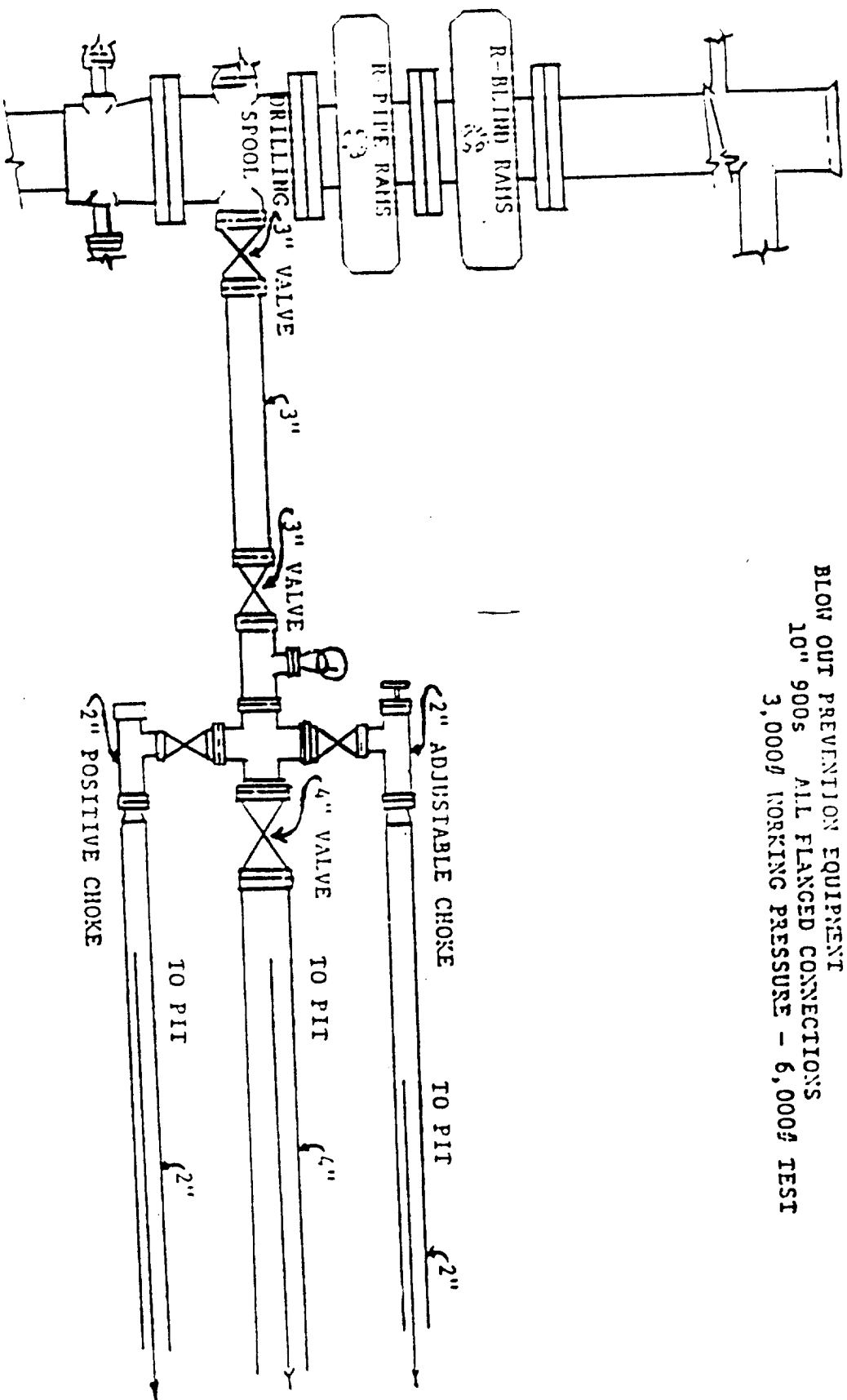

ATTACHMENT TO FORM C-101

Rec'd 12-32-91

ELF

RECEIVED

NOV 20 1991

OFF  
HOUSE LIAISON