

30-025-31664
BLM Roswell District
Modified Form No.
NM60-3160-2

UNITED STATES
DEPARTMENT OF THE INTERIOR
BUREAU OF LAND MANAGEMENT

APPLICATION FOR PERMIT TO DRILL, DEEPEN, OR PLUG BACK

1a. TYPE OF WORK DRILL <input checked="" type="checkbox"/> DEEPEN <input type="checkbox"/> PLUG BACK <input type="checkbox"/>		5. LEASE DESIGNATION AND SERIAL NO. NM 27508	
b. TYPE OF WELL OIL WELL <input checked="" type="checkbox"/> GAS WELL <input type="checkbox"/> OTHER <input type="checkbox"/>		6. IF INDIAN, ALLOTTEE OR TRIBE NAME	
2. NAME OF OPERATOR Topat Oil Corporation		7. UNIT AGREEMENT NAME	
3. ADDRESS OF OPERATOR 505 N. Big Spring - Ste. 204 - Midland, TX 79701		8. FARM OR LEASE NAME Conoco Federal	
4. LOCATION OF WELL (Report location clearly and in accordance with any State requirements.)* At surface 1650 FWL, 660 FNL At proposed prod. zone Same as surface location		9. WELL NO. #1	
14. DISTANCE IN MILES AND DIRECTION FROM NEAREST TOWN OR POST OFFICE* 20 Miles SW Jal, NM		10. FIELD AND POOL, OR WILDCAT East Mason Delaware	
15. DISTANCE FROM PROPOSED* LOCATION TO NEAREST PROPERTY OR LEASE LINE, FT. (Also to nearest drilg. unit lline, if any) 660		11. SEC., T., R., M., OR BLK. AND SURVEY OR AREA Sec. 29, T26S, R 32E	
16. NO. OF ACRES IN LEASE 160		12. COUNTY OR PARISH Lea	
17. NO. OF ACRES ASSIGNED TO THIS WELL 40		13. STATE NM	
18. DISTANCE FROM PROPOSED LOCATION* TO NEAREST WELL, DRILLING, COMPLETED, OR APPLIED FOR, ON THIS LEASE, FT. ~4340'		20. ROTARY OR CABLE TOOLS Rotary to 4300 Cable tool to 4320	
21. ELEVATIONS (Show whether DF, RT, GR, etc.) 3150 GL		22. APPROX. DATE WORK WILL START* August 1	

PROPOSED CASING AND CEMENTING PROGRAM

HOLE SIZE	CASING SIZE	WEIGHT/FOOT	GRADE	THREAD TYPE	SETTING DEPTH	QUANTITY OF CEMENT
12 1/4	8 5/8	24#	J 55	ST&C CIRCULATE	1000	450sx (30%xcss)
7 7/8	5 1/2	15.5	J 55	ST&C	4350	125sx

Proposed program:

- 1) prepare location and access
- 2) move in rotary, drill to 1000', set 1000' 8 5/8 surface pipe
- 3) drill to 4300' set long string 4300' 5 1/2 csg, move off rotary
- 4) move in cable tool. Drill out from under long string into the top of Delaware sand.

IN ABOVE SPACE DESCRIBE PROPOSED PROGRAM: If proposal is to deepen or plug back, give data on present productive zone and proposed new productive zone. If proposal is to drill or deepen directionally, give pertinent data on subsurface locations and measured and true vertical depths. Give blowout preventer program, if any.

SIGNED [Signature] TITLE Operator Rep. DATE 6-17-92

PERMIT NO. _____ APPROVAL DATE _____

APPROVED BY _____ TITLE _____ DATE 7-29-92

APPROVAL SUBJECT TO
GENERAL REQUIREMENTS AND
SPECIAL STIPULATIONS

*See Instructions On Reverse Side

Submit to Appropriate
District Office
State Lease - 4 copies
Fee Lease - 3 copies

State of New Mexico
Energy, Minerals and Natural Resources Department

Form C-102
Revised 1-1-89

OIL CONSERVATION DIVISION

P.O. Box 2088
Santa Fe, New Mexico 87504-2088

DISTRICT I
P.O. Box 1980, Hobbs, NM 88240

DISTRICT II
P.O. Drawer DD, Artesia, NM 88210

DISTRICT III
1000 Rio Brazos Rd., Aztec, NM 87410

WELL LOCATION AND ACREAGE DEDICATION PLAT

All Distances must be from the outer boundaries of the section

Operator Topat Oil Corp.			Lease Conoco Federal		Well No. 1
Unit Letter C	Section 29	Township 26 - South	Range 32 - East	County Lea	
Actual Footage Location of Well: 1650 feet from the West line and 660 feet from the North line					
Ground level Elev. 3150		Producing Formation Delaware		Pool East Mason	Dedicated Acreage: 40 Acres

1. Outline the acreage dedicated to the subject well by colored pencil or hachure marks on the plat below.
2. If more than one lease is dedicated to the well, outline each and identify the ownership thereof (both as to working interest and royalty).
3. If more than one lease of different ownership is dedicated to the well, have the interest of all owners been consolidated by communitization, unitization, force-pooling, etc.?
☐ Yes ☐ No If answer is "yes" type of consolidation _____
If answer is "no" list the owners and tract descriptions which have actually been consolidated. (Use reverse side of this form if necessary.)
No allowable will be assigned to the well until all interests have been consolidated (by communitization, unitization, forced-pooling, or otherwise) or until a non-standard unit, eliminating such interest, has been approved by the Division.

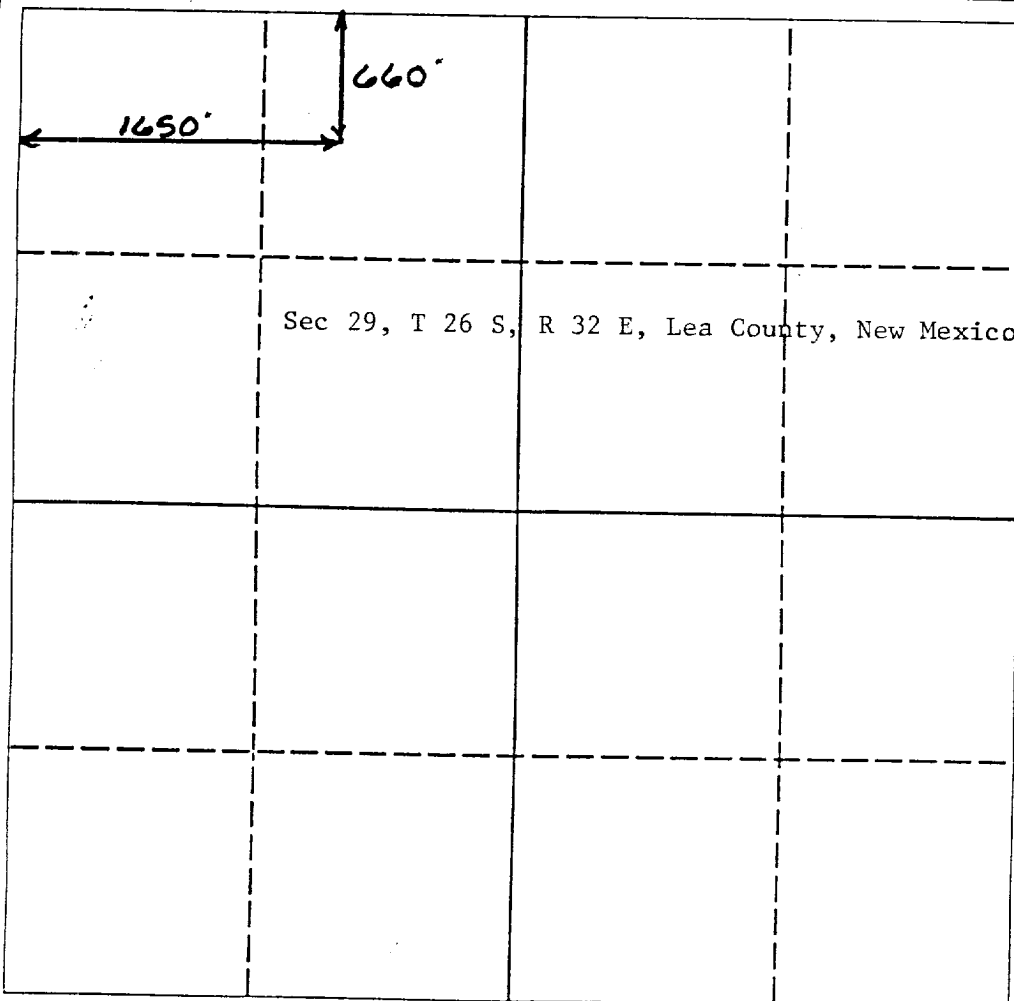

OPERATOR CERTIFICATION

I hereby certify that the information contained herein is true and complete to the best of my knowledge and belief.

Signature
Thomas Schneider
Printed Name
Thomas Schneider
Position
Topat Oil Corporation
Company
Date
6/24/92

SURVEYOR CERTIFICATION

I hereby certify that the well location shown on this plat was plotted from field notes of actual surveys made by me or under my supervision, and that the same is true and correct to the best of my knowledge and belief.

Date Surveyed
6-17-92
Signature & Seal of Professional Surveyor
Thurman Gaskin
Certificate No.
2126



DRILLING PROGRAM

Attached to Form 3160-3
Topat Oil Corporation
Conoco Federal #1
660' FNL & 1656' FWL,
Sec. 29, T265, R32E
Lea Co., N.M.

1. Geologic Name of Surface Formation:

Tertiary

2. Estimated Tops of Important Geologic Markers:

Tertiary	Surface
Rustler	950
Anhydrate	1000
Base Shale	1300
Yates	3000
Lower Lime?	4100
Delaware Top	4300

3. Estimated Depths of Anticipated Fresh Water, Oil or Gas:

Upper Tertiary	100'	Fresh Water
Yates	2980'	
Delaware	4300'	oil

No further formations are expectations to give up oil or gas. Fresh water sands will be protected by setting 8 5/8 csg at 1000' and circulating cement back to surface.

4. Casing Program:

Hole Size	Interval	OD csg	Weight, Grade, Jt. Cond, Type
12-1/4	0-1000	8-5/8"	24# J55 ST&C used R2-3
7-7/8	0-TD(4300)	5-1/2"	15.15# J55 ST&C used R2-3

Cement Program:

8-5/8" Surface

Cemented to surface with 500 sx of
Premium + Class "C" w/2% CaCl₂
& 1/4 # flocele per sx.

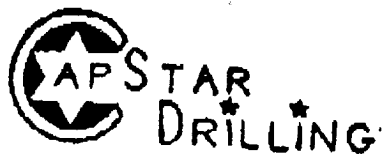

301 BOYD, E
ALLEN, TEXAS 75002
(214) 727-8367

P. O. BOX 589
ALLEN, TEXAS 75002
In Texas (800) 442-5224

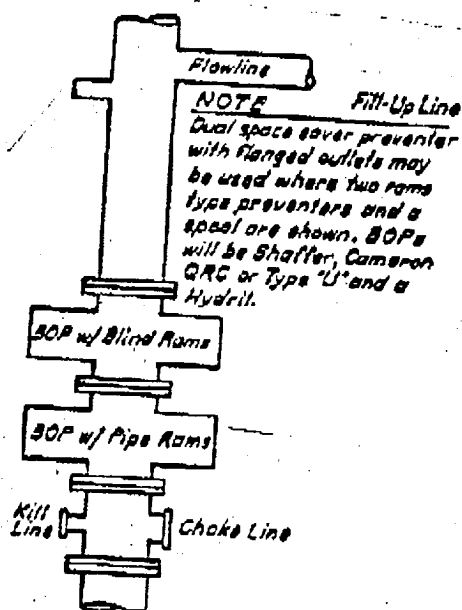

2M

58

CASE I
BLOWOUT PREVENTER HOOKUP