

Submit to Appropriate  
District Office  
State Lease - 6 copies  
Fee Lease - 5 copies

State of New Mexico  
Energy, Minerals and Natural Resources Department

Form C-101  
Revised 1-1-89

DISTRICT I  
P.O. Box 1980, Hobbs, NM 88240

DISTRICT II  
P.O. Drawer DD, Artesia, NM 88210

DISTRICT III  
1000 Rio Brazos Rd., Aztec, NM 87410

## OIL CONSERVATION DIVISION

P.O. Box 2088  
Santa Fe, New Mexico 87504-2088

API NO. (assigned by OCD on New Wells)

30-125-32110

5. Indicate Type of Lease

STATE ☒

FEE ☐

6. State Oil & Gas Lease No.  
VA-140

### APPLICATION FOR PERMIT TO DRILL, DEEPEN, OR PLUG BACK

1a. Type of Work:

DRILL ☒

RE-ENTER ☐

DEEPEN ☐

PLUG BACK ☐

b. Type of Well:

OIL  
WELL ☒

GAS  
WELL ☐

OTHER ☐

SINGLE  
ZONE ☐

MULTIPLE  
ZONE ☐

7. Lease Name or Unit Agreement Name

Triste Draw ANH State

2. Name of Operator

Yates Petroleum Corporation

8. Well No.

2

3. Address of Operator

105 South Fourth Street, Artesia, New Mexico 88210

9. Pool name or Wildcat

Triste Draw Delaware

4. Well Location

Unit Letter E : 1650' Feet From The North Line and 330' Feet From The West Line

Section 2

Township 24 South

Range 32 East

NMPM

Lea

County

10. Proposed Depth  
9200'

11. Formation  
Delaware

12. Rotary or C.T.  
Rotary

13. Elevations (Show whether DF, RT, GR, etc.)  
3598' GR

14. Kind & Status Plug. Bond -  
Blanket

15. Drilling Contractor  
Undesignated

16. Approx. Date Work will start  
ASAP

17.

### PROPOSED CASING AND CEMENT PROGRAM

SIZE OF HOLE	SIZE OF CASING	WEIGHT PER FOOT	SETTING DEPTH	SACKS OF CEMENT	EST. TOP
17 1/2"	13 3/8"	54.5#	1250'	950	Circulate
11"	8 5/8"	32#	4750'	1900	Circulate
7 7/8"	5 1/2"	15.5# & 17#	TD	1125	Tie Back

Yates Petroleum Corporation proposes to drill and test the Delaware and intermediate formations. Approximately 1250' of surface casing will be set and cement circulated. Approximately 4750' of intermediate casing will be set and cement circulated. If commercial, production casing will be run and cemented with adequate cover, perforated and stimulated as needed for production.

MUD PROGRAM: FW/GEL to 1250'; Brine to 4750'; Cut Brine to TD.

BOPE PROGRAM: BOPE will be installed on the 13 3/8" casing.

IN ABOVE SPACE DESCRIBE PROPOSED PROGRAM: IF PROPOSAL IS TO DEEPEN OR PLUG BACK, GIVE DATA ON PRESENT PRODUCTIVE ZONE AND PROPOSED NEW PRODUCTIVE ZONE. GIVE BLOWOUT PREVENTER PROGRAM, IF ANY.

I hereby certify that the information above is true and complete to the best of my knowledge and belief.

SIGNATURE

*Clifton R. May*  
Clifton R. May

TITLE

Permit Agent

DATE

7/8/93

TYPE OR PRINT NAME

TELEPHONE NO.

748-1471

(This space for State Use)

APPROVED BY

TITLE

DATE

JUL 14 1993

CONDITIONS OF APPROVAL, IF ANY:

Permit Expires 6 Months From Approval  
Date Unless Drilling Underway.

Submit to Appropriate  
District Office  
State Lease - 4 copies  
Fee Lease - 3 copies

State of New Mexico  
Energy, Minerals and Natural Resources Department

Form C-102  
Revised 1-1-89

OIL CONSERVATION DIVISION

P.O. Box 2088

Santa Fe, New Mexico 87504-2088

DISTRICT I

P.O. Box 1980, Hobbs, NM 88240

DISTRICT II

P.O. Drawer DD, Artesia, NM 88210

DISTRICT III

1000 Rio Brazos Rd., Aztec, NM 87410

WELL LOCATION AND ACREAGE DEDICATION PLAT

All Distances must be from the outer boundaries of the section

Operator YATES PETROLEUM CORPORATION			Lease TRISTE DRAW "ANH" STATE		Well No. 2
Unit Letter E	Section 2	Township 24 SOUTH	Range 32 EAST	County LEA	
Actual Footage Location of Well: 330 feet from the WEST line and 1650 feet from the NORTH line					
Ground level Elev. 3598	Producing Formation DELAWARE		Pool TRISTE DRAW DELAWARE	Dedicated Acreage: 40 Acres	

1. Outline the acreage dedicated to the subject well by colored pencil or hatchure marks on the plat below.
2. If more than one lease is dedicated to the well, outline each and identify the ownership thereof (both as to working interest and royalty).
3. If more than one lease of different ownership is dedicated to the well, have the interest of all owners been consolidated by communization, unitization, force-pooling, etc.?  
☐ Yes ☐ No If answer is "yes" type of consolidation \_\_\_\_\_  
If answer is "no" list the owners and tract descriptions which have actually been consolidated. (Use reverse side of this form if necessary). \_\_\_\_\_  
No allowable will be assigned to the well until all interests have been consolidated (by communization, unitization, forced-pooling, or otherwise) or until a non-standard unit, eliminating such interest, has been approved by the Division.

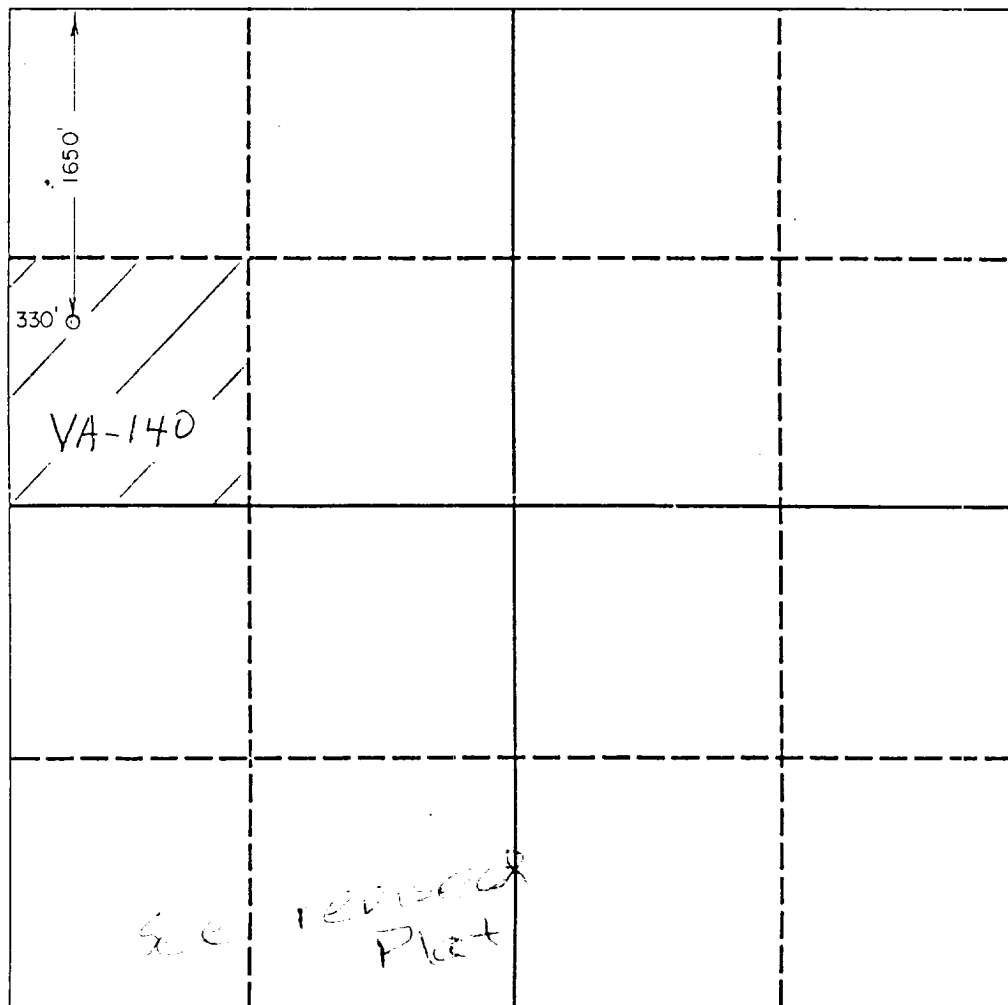

OPERATOR CERTIFICATION

I hereby certify that the information contained herein is true and complete to the best of my knowledge and belief.

Signature Clifton R. May  
Printed Name Clifton R. May  
Position Permit Agent  
Company Yates Petroleum Corporation  
Date 7/8/93

SURVEYOR CERTIFICATION

I hereby certify that the well location shown on this plat was plotted from field notes of actual surveys made by me or under my supervision, and that the same is true and correct to the best of my knowledge and belief.

Date Surveyed  
7/05/93

Signature of Professional Surveyor  
Herschel Jones  
Certificate No. 3640

# YATES PETROLEUM CORPORATION

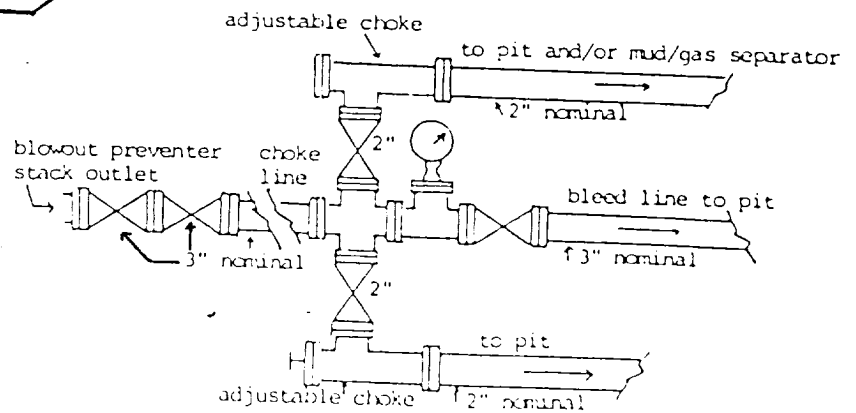
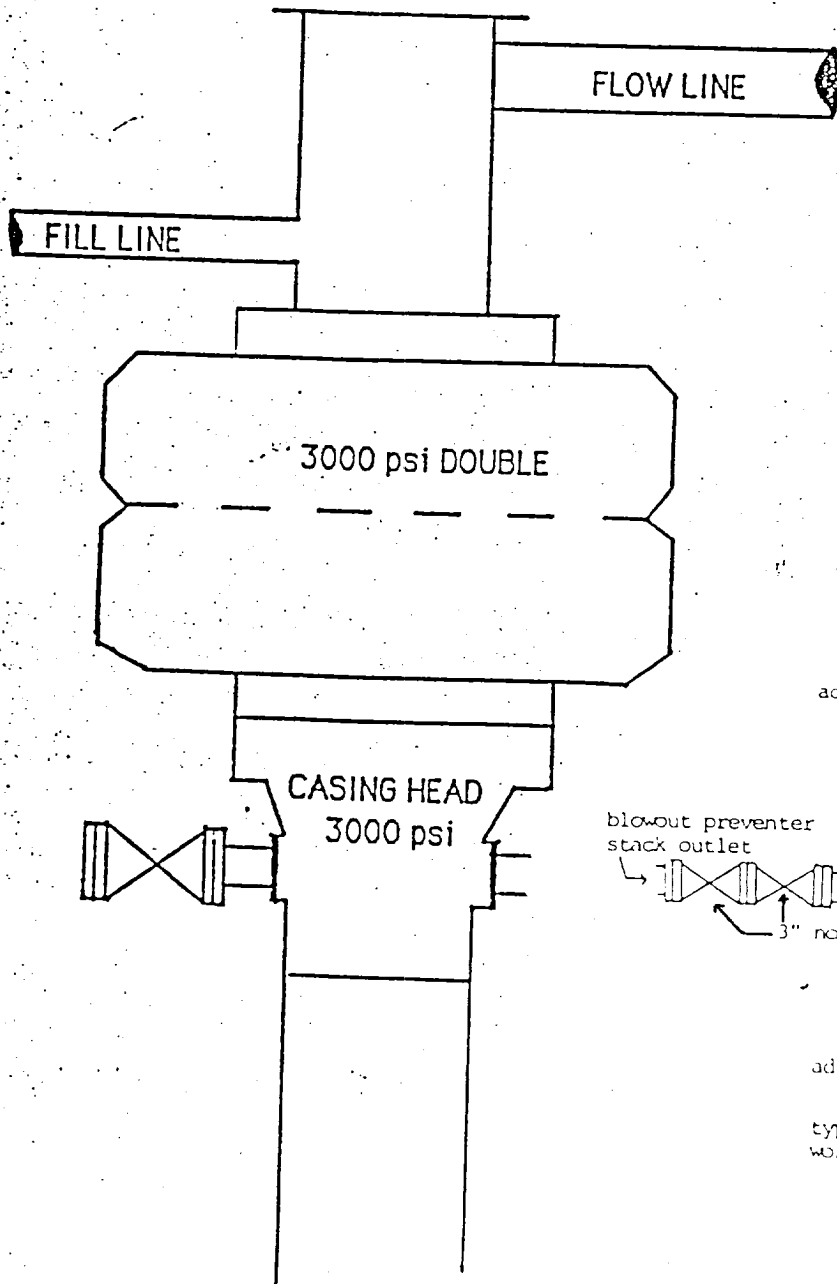

typical choke manifold assembly for 3M rated  
working pressure service-surface installation

**BLOWOUT PREVENTER  
3M SYSTEM**