

DISTRICT I
P.O. Box 1980, Hobbs, NM 88241-1980
DISTRICT II
P.O. Box Drawer DD, Artesia, NM 88211-0719
DISTRICT III
1000 Rio Brazos Rd., Aztec, NM 87410
DISTRICT IV
P.O. Box 2088, Santa Fe, NM 87504-2088

State of New Mexico
Energy, Minerals and Natural Resources Department

OIL CONSERVATION DIVISION

P.O. Box 2088
Santa Fe, New Mexico 87504-2088

Form C-107
Revised February 10, 1999
Instructions on back
Submit to Appropriate District Office
State Lease - 6 Copie
Fee Lease - 5 Copie
☐ AMENDED REPORT

APPLICATION FOR PERMIT TO DRILL, RE-ENTER, DEEPEN, PLUGBACK, OR ADD A ZONE

¹ Operator Name and Address TEXACO EXPLORATION & PRODUCTION INC. 205 E. Bender, HOBBS, NM 88240		² OGRID Number 022351
⁴ Property Code 11060	⁵ Property Name SIMS, R. R. "A"	³ API Number 30 025 32225
		⁶ Well No. 4

⁷ Surface Location									
UI or lot no	Section	Township	Range	Lot.Idn	Feet From The	North/South Line	Feet From The	East/West Line	County
M	4	23-SO	37-EA		330	SOUTH	960	WEST	LEA

⁸ Proposed Bottom Hole Location If Different From Surface									
UI or lot no	Section	Township	Range	Lot.Idn	Feet From The	North/South Line	Feet From The	East/West Line	County
⁹ Proposed Pool 1 Teague Lower Paddock Blinebry N Assoc					¹⁰ Proposed Pool 2				

¹¹ Work Type Code P	¹² WellType Code O	¹³ Rotary or C.T. R	¹⁴ Lease Type Code P	¹⁵ Ground Level Elevation GR-3324', KB-3338'
¹⁶ Multiple No	¹⁷ Proposed Depth 7700'	¹⁸ Formation Paddock Blinebry	¹⁹ Contractor	²⁰ Spud Date 3/6/00

²¹ Proposed Casing and Cement Program					
SIZE OF HOLE	SIZE OF CASING	WEIGHT PER FOOT	SETTING DEPTH	SACKS OF CEMENT	EST. TOP
14 3/4	11 3/4	42#	1215'	CL-C 750 SX,CIRC. 90	
11	8 5/8	32#	3750'	CL-H 1825 SX,TOC @ 1	
				BY T.S.	
7 7/8	5 1/2	15.5#	7700'	CL-H 1630 SX,CIRC. 3	
				D.V. TOOL @ 6975'	

²² Describe the proposed program. If this application is to DEEPEN or PLUG BACK give the data on the present productive zone and proposed new productive zone.
Describe the blowout prevention program, if any. Use additional sheets if necessary.

Texaco intends to perforate, fracture treat and test the Blinebry. (The RR Sims A #7 is producing DHC from the Blinebry, Drinkard & Abo on this same 40 acres and will be shut in when this well is completed. The intended procedure is as follows:

1. MIRU PU. INSTL BOP. RU SPOOL TRUCK FOR CABLE.
2. TOH W/TBG & PMP. TIH W/BIT & SCRAPER TO 7400'. TIH W/CIBP & SET @ 7400' TO ABANDON THE DEVONIAN.
3. MIRU TO RUN CSG INSPECTION LOG FROM 6000-2000'. TOP CIBP W/35' CMT & PRESS TEST FOR NMOC. OBTAIN CHART.
4. TIH W/GUNS & PERF BLINEBRY INTERVAL 5582-86, 5618-22, 5638-42, 5698-5710, 5724-42, 5758-60, 5836-40, 5850-54. TIH W/TBG & PKR. PSA 5400'. LOAD & PRESS BACKSIDE TO 1000#. ACIDIZE BLINEBRY PERFS W/5000 GALS 15% NEFE HCL. TIH W/FAC TBG & PKR. RU 10,000# TREE. LOAD & TEST CSG TO 1000#.
5. FRAC TREAT BLINEBRY INTERVAL W/60,000 GALS XLG CARRYING 180,000# 20/40 SAND. RU COILED TBG. FLOW BACK. OBTAIN TEST.
6. LD FRAC TBG & REM FRAC TREE. TIH W/PROD TBG. OPT.

²³ I hereby certify that the rules and regulations of the Oil Conservation Division have been complied with and that the information given above is true and complete to the best of my knowledge and belief.

Signature

Printed Name

J. Denise Leake

Title

Engineering Assistant

Date

2/29/00

Telephone

397-0405

OIL CONSERVATION DIVISION

ORIGINAL SIGNED BY CHRIS WILLIAMS
DISTRICT I SUPERVISOR
Approved By:

Title:

Approval Date:

Expiration Date:

Conditions of Approval:

Attached ☐

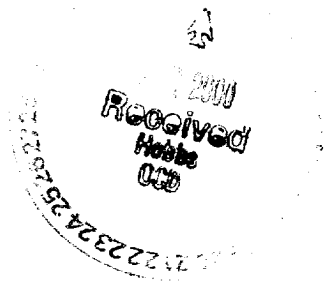

DISTRICT I

P.O. Box 1980, Hobbs, NM 88241-1980

DISTRICT II

P.O. Box Drawer DD, Artesia, NM 88211-0719

DISTRICT III

1000 Rio Brazos Rd., Aztec, NM 87410

DISTRICT IV

P.O. Box 2088, Santa Fe, NM 87504-2088

State of New Mexico

Energy, Minerals and Natural Resources Department

OIL CONSERVATION DIVISION

P.O. Box 2088

Santa Fe, New Mexico 87504-2088

Form C-102

Revised February 10, 1999

Instructions on back

Submit to Appropriate District Office

State Lease - 4 Copie

Fee Lease - 3 Copie

☐ AMENDED REPORT

WELL LOCATION AND ACREAGE DEDICATION PLAT

¹ API Number 30 025 32225		² Pool Code 96314		³ Pool Name TEAGUE LOWER PADDOCK BLINEBRY N. ASSOC. (Oil)	
⁴ Property Code 11060		⁵ Property Name SIMS, R. R. "A"			⁶ Well No. 4
⁷ OGRID Number 022351		⁸ Operator Name TEXACO EXPLORATION & PRODUCTION INC.			⁹ Elevation GR-3324', KB-3338'

¹⁰ Surface Location

UI or lot no	Section	Township	Range	Lot.Idn	Feet From The	North/South Line	Feet From The	East/West Line	County
M	4	23-SO	37-EA		330	SOUTH	960	WEST	LEA

¹¹ Bottom Hole Location If Different From Surface

UI or lot no	Section	Township	Range	Lot.Idn	Feet From The	North/South Line	Feet From The	East/West Line	County

¹² Dedicated Acre 40	¹³ Joint or Infill No	¹⁴ Consolidation Code	¹⁵ Order No.
------------------------------------	-------------------------------------	----------------------------------	-------------------------

NO ALLOWABLE WILL BE ASSIGNED TO THIS COMPLETION UNTIL ALL INTERESTS HAVE BEEN CONSOLIDATED
OR A NON-STANDARD UNIT HAS BEEN APPROVED BY THE DIVISION

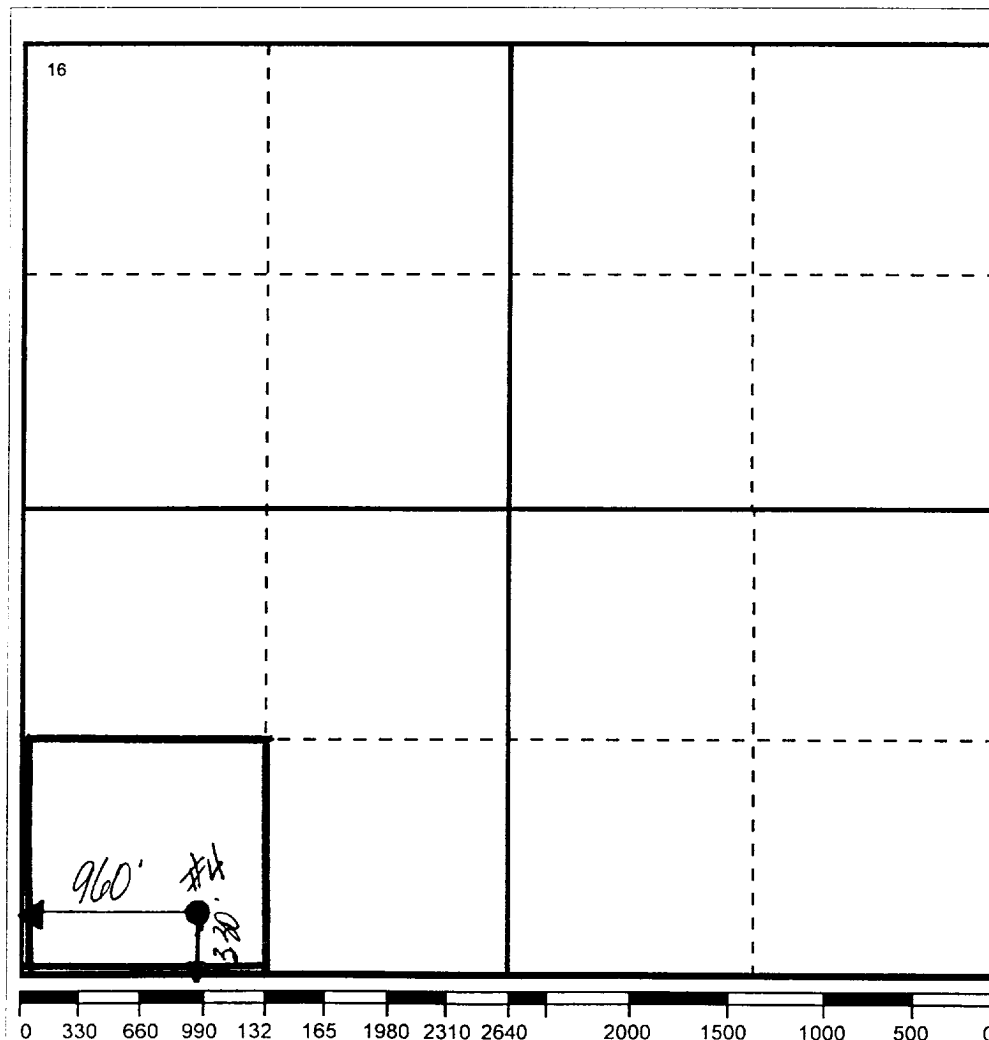
¹⁷ OPERATOR CERTIFICATION

I hereby certify that the information contained herein is true and complete to the best of my knowledge and belief

Signature

Printed Name

J. Denise Leake

Positio

Engineering Assistant

Date

2/29/00

¹⁸ SURVEYOR CERTIFICATION

I hereby certify that the well location shown on this plat was plotted from field notes of actual surveys made by me or under my supervision, and that the same is true and correct to the best of my knowledge and belief.

Date Surveyed

Signature & Seal of
Professional Surveyor

Certificate No.

Received
10/10/10
23
24
25
26
27
28
29
30
31
32
33
34
35
36
37
38
39
40
41
42
43
44
45
46
47
48
49
50
51
52
53
54
55
56
57
58
59
60
61
62
63
64
65
66
67
68
69
70
71
72
73
74
75
76
77
78
79
80
81
82
83
84
85
86
87
88
89
90
91
92
93
94
95
96
97
98
99
100