

## NM OIL CONS. COMMISSION

DRAWER DD

ARTESIA, NM, UNITED STATES

DEPARTMENT OF THE INTERIOR

BUREAU OF LAND MANAGEMENT

SUBMIT IN TRIPLICATE\*

(Other instructions on  
reverse side)

FORM APPROVED

OMB NO. 1004-0136

Expires: February 28, 1995

## APPLICATION FOR PERMIT TO DRILL OR DEEPEN

## 1a. TYPE OF WORK

DRILL ☒DEEPEN ☐

## b. TYPE OF WELL

OIL  
WELL ☒GAS  
WELL ☐OTHER ☐SINGLE  
ZONE ☒MULTIPLE  
ZONE ☐

## 2. NAME OF OPERATOR

Enron Oil &amp; Gas Company

## 3. ADDRESS AND TELEPHONE NO.

P. O. Box 2267, Midland, Texas 79702

RECEIVED

## 4. LOCATION OF WELL (Report location clearly and in accordance with any State requirements.)\*

At surface

1980' FNL &amp; 1980' FEL

At proposed prod. zone

1980' FNL &amp; 1980' FEL

## 14. DISTANCE IN MILES AND DIRECTION FROM NEAREST TOWN OR POST OFFICE\*

35 miles SE of Carlsbad

O. C. D.

## 15. DISTANCE FROM PROPOSED\*

LOCATION TO NEAREST

PROPERTY OR LEASE LINE, FT.

(Also to nearest drlg. unit line, if any)

1980

660

## 16. NO. OF ACRES IN LEASE

640

17. NO. OF ACRES ASSIGNED  
TO THIS WELL

40

## 18. DISTANCE FROM PROPOSED LOCATION\*

TO NEAREST WELL, DRILLING, COMPLETED,

OR APPLIED FOR, ON THIS LEASE, FT.

1320'

## 19. PROPOSED DEPTH

8750

## 20. ROTARY OR CABLE TOOLS

Rotary

## 21. ELEVATIONS (Show whether DF, RT, GR, etc.)

3554.7' GR

## 22. APPROX. DATE WORK WILL START\*

3/1/94

## 23.

## PROPOSED CASING AND CEMENTING PROGRAM

## Carlsbad Controlled Water Basin

SIZE OF HOLE	GRADE SIZE OF CASING	WEIGHT PER FOOT	SETTING DEPTH	QUANTITY OF CEMENT
14-3/4	11-3/4 H-40 A	ST&C 42#	600	275 Sx Circulated
11	8-5/8 J-55 LT&C	32#	4600	725 Sx Circulated
7-7/8	5-1/2 J-55 LT&C	15.5# & 17#	8750	350 Sx TOC est at 4000'

OPER. OGRID NO. 7377PROPERTY NO. 13236POOL CODE 66203 96191EFF. DATE 6-21-94API NO. 30-025-32552

Acreage is dedicated to pipeline

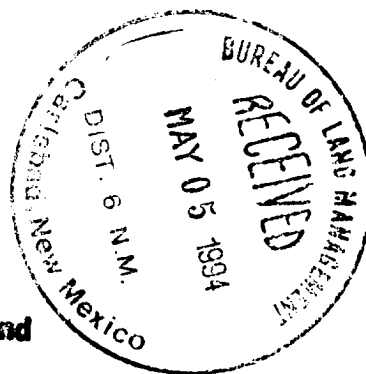
Approval Subject to  
General Requirements and  
Special stipulations  
Attached

IN ABOVE SPACE DESCRIBE PROPOSED PROGRAM: If proposal is to deepen, give data on present productive zone and proposed new productive zone. If proposal is to drill or deepen directionally, give pertinent data on subsurface locations and measured and true vertical depths. Give blowout preventer program, if any.

## 24.

SIGNED

Betty GildonTITLE Regulatory AnalystDATE 5/5/94

(This space for Federal or State office use)

PERMIT NO. \_\_\_\_\_

APPROVAL DATE \_\_\_\_\_

Application approval does not warrant or certify that the applicant holds legal or equitable title to those rights in the subject lease which would entitle the applicant to conduct operations thereon.  
CONDITIONS OF APPROVAL, IF ANY:

APPROVED BY

Ron Duntton

TITLE

ten  
AREA MANAGER

DATE

10/9/94

\*See Instructions On Reverse Side

RECEIVED

MAY 1 1971

COMMUNICATIONS  
OFFICE

Submit to Appropriate  
District Office  
State Lease - 4 copies  
Fee Lease - 3 copies

State of New Mexico  
Energy, Minerals and Natural Resources Department

Form C-102  
Revised 1-1-89

OIL CONSERVATION DIVISION

P.O. Box 2088  
Santa Fe, New Mexico 87504-2088

DISTRICT I

P.O. Box 1980, Hobbs, NM 88240

DISTRICT II

P.O. Drawer DD, Artesia, NM 88210

DISTRICT III

1000 Rio Brazos Rd., Aztec, NM 87410

WELL LOCATION AND ACREAGE DEDICATION PLAT

All Distances must be from the outer boundaries of the section

Operator ENRON OIL & GAS CO.			Lease MESA VERDE "7" FEDERAL		Well No. 3
Unit Letter G	Section 7	Township 24 SOUTH	Range 32 EAST	County LEA	
Actual Footage Location of Well:					
1980 feet from the NORTH line and		1980 feet from the EAST line			
Ground Level Elev. 3554.7'	Producing Formation Delaware		Pool Und.	Dedicated Acreage: 40 Acres	

- Outline the acreage dedicated to the subject well by colored pencil or hatchure marks on the plat below.
- If more than one lease is dedicated to the well, outline each and identify the ownership thereof (both as to working interest and royalty).
- If more than one lease of different ownership is dedicated to the well, have the interest of all owners been consolidated by communitization, unitization, force-pooling, etc.?

☐ Yes ☐ No If answer is "yes" type of consolidation \_\_\_\_\_

If answer is "no" list of owners and tract descriptions which have actually been consolidated. (Use reverse side of this form necessary.) \_\_\_\_\_

No allowable will be assigned to the well unit all interests have been consolidated (by communitization, unitization, forced-pooling, otherwise) or until a non-standard unit, eliminating such interest, has been approved by the Division.

OPERATOR CERTIFICATION

I hereby certify the the information contained herein is true and complete to the best of my knowledge and belief.

Signature

Printed Name

Betty Gildon

Position

Regulatory Analyst

Company

Enron Oil & Gas Company

Date

1/26/94

SURVEYOR CERTIFICATION

I hereby certify that the well location shown on this plat was plotted from field notes of actual surveys made by me or under my supervision, and that the same is true and correct to the best of my knowledge and belief.

Date Surveyed

OCTOBER 11, 1993

Signature & Seal of  
Professional Surveyor

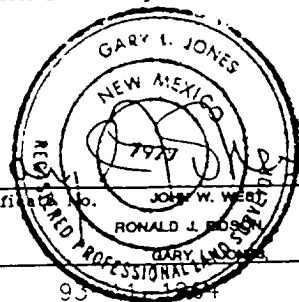

Certified No.

JOHN W. WEBB 078

RONALD J. BOSS 3239

GARY L. JONES 7977

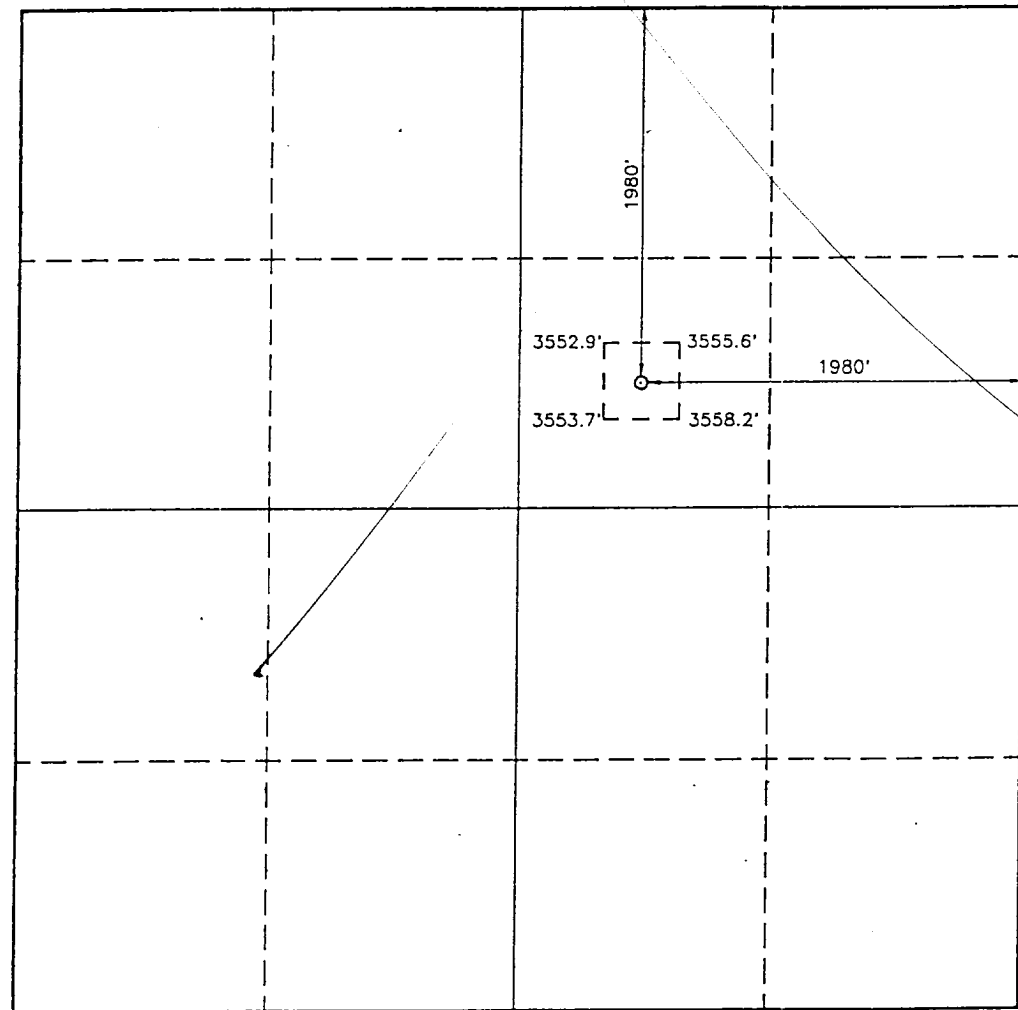

0 330 660 990 1320 1650 1980 2310 2640 2000 1500 1000 500 0

N.M. OIL & GAS COMMISSION  
P.O. BOX 1980  
HOBBS, NEW MEXICO 88240  
UNITED STATES

Form 3160-5  
(June 1990)

DEPARTMENT OF THE INTERIOR  
BUREAU OF LAND MANAGEMENT

FORM APPROVED  
Budget Bureau No. 1004-0135  
Expires: March 31, 1993

5. Lease Designation and Serial No.

NM-68084

6. If Indian, Allottee or Tribe Name

7. If Unit or CA, Agreement Designation

8. Well Name and No.

Mesa Verde 7 Federal No. 3

9. API Well No.

10. Field and Pool, or Exploratory Area

Und. Delaware

11. County or Parish, State

Lea, NM

SUNDRY NOTICES AND REPORTS ON WELLS

Do not use this form for proposals to drill or to deepen or reentry to a different reservoir.  
Use "APPLICATION FOR PERMIT—" for such proposals

SUBMIT IN TRIPLICATE

1. Type of Well

☒ Oil Well ☐ Gas Well ☐ Other

2. Name of Operator

Enron Oil & Gas Company

3. Address and Telephone No.

P. O. Box 2267, Midland, TX 79702

4. Location of Well (Footage, Sec., T., R., M., or Survey Description)

1980' FNL & 1780' FEL  
Sec 7, T24S, R32E

12. CHECK APPROPRIATE BOX(S) TO INDICATE NATURE OF NOTICE, REPORT, OR OTHER DATA

TYPE OF SUBMISSION

- ☐ Notice of Intent  
☐ Subsequent Report  
☐ Final Abandonment Notice

TYPE OF ACTION

- ☐ Abandonment  
☐ Recompletion  
☐ Plugging Back  
☐ Casing Repair  
☐ Altering Casing  
☐ Other

- ☐ Change of Plans  
☒ New Construction  
☐ Non-Routine Fracturing  
☐ Water Shut-Off  
☐ Conversion to Injection  
☐ Dispose Water

(Note: Report results of multiple completion on Well Completion or Recompletion Report and Log form.)

13. Describe Proposed or Completed Operations (Clearly state all pertinent details, and give pertinent dates, including estimated date of starting any proposed work. If well is directionally drilled, give subsurface locations and measured and true vertical depths for all markers and zones pertinent to this work.)\*

Amend location 200' East per Barry Hunt. New Exhibit "4" and plat attached.

14. I hereby certify that the foregoing is true and correct

Signed

*Barry Sildon*

Title Regulatory Analyst

Date May 25, 1994

(This space for Federal or State office use)

Approved by

Conditions of approval, if any:

Title

AREA MANAGER

Date

Title 18 U.S.C. Section 1001, makes it a crime for any person knowingly and willfully to make to any department or agency of the United States any false, fictitious or fraudulent statements or representations as to any matter within its jurisdiction.

\*See Instruction on Reverse Side

DISTRICT I  
P.O. Box 1980, Hobbs, NM 88240

DISTRICT II  
P.O. Drawer DD, Artesia, NM 88210

DISTRICT III  
1000 Rio Brazos Rd., Aztec, NM 87410

State of New Mexico  
Energy, Minerals and Natural Resources Department

Form C-102  
Revised February 10, 1994  
Instruction on back  
Submit to Appropriate District Office  
State Lease - 4 Copies  
Fee Lease - 3 Copies

OIL CONSERVATION DIVISION

P.O. Box 2088  
Santa Fe, New Mexico 87504-2088

☐ AMENDED REPORT

WELL LOCATION AND ACREAGE DEDICATION PLAT

API Number	Pool Code	Pool Name
		Und. Delaware
Property Code	Property Name	Well Number
	MESA VERDE 7 FEDERAL	3
OGRID No.	Operator Name	Elevation
7377	ENRON OIL & GAS	3557'

Surface Location

UL or lot No.	Section	Township	Range	Lot Idn	Feet from the	North/South line	Feet from the	East/West line	County
G	7	24S	32E		1980	NORTH	1780	EAST	LEA

<sup>11</sup> Bottom Hole Location If Different From Surface

UL or lot No.	Section	Township	Range	Lot Idn	Feet from the	North/South line	Feet from the	East/West line	County
Dedicated Acres	Joint or Infill	Consolidation Code	Order No.						
40									

NO ALLOWABLE WILL BE ASSIGNED TO THIS COMPLETION UNTIL ALL INTERESTS HAVE BEEN CONSOLIDATED  
OR A NON-STANDARD UNIT HAS BEEN APPROVED BY THE DIVISION

LOT 1			
45.53 ACRES			
LOT 2			
45.44 ACRES			
LOT 3			
45.34 ACRES			
LOT 4			
45.25 ACRES			

OPERATOR CERTIFICATION

I hereby certify the the information contained herein is true and complete to the best of my knowledge and belief.

*Betty Gildon*  
Signature

Betty Gildon  
Printed Name

Regulatory Analyst  
Title

5/25/94  
Date

SURVEYOR CERTIFICATION

I hereby certify that the well location shown on this plat was plotted from field notes of actual surveys made by me or under my supervision, and that the same is true and correct to the best of my belief.

MAY 20 1994  
Date Surveyed

Signature & Seal of Professional Surveyor

W.O. Num. 94-11-0912

Certificate No. JOHN W. WEST, 676  
RONALD J. EIDSON, 3239  
GARY L. JONES, 7977

ENRON OIL & GAS COMPANY  
MESA VERDE 7 FEDERAL #3

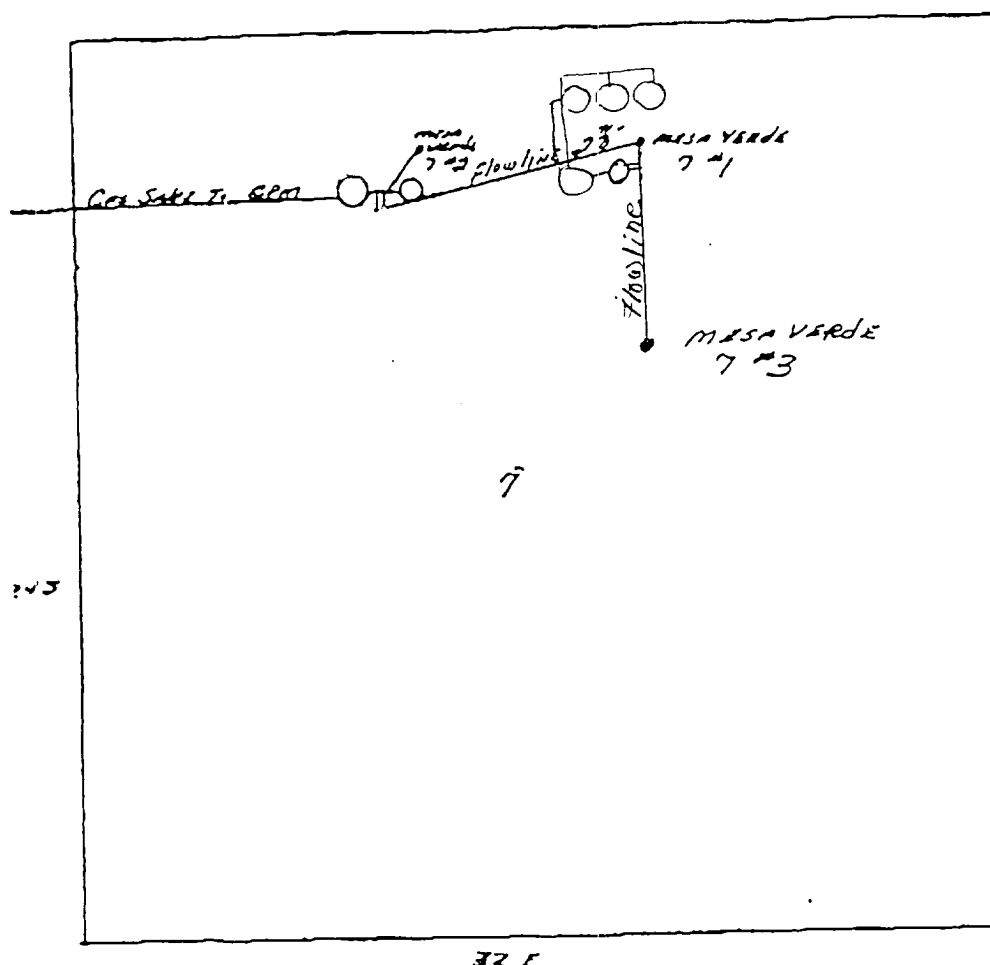
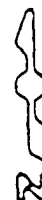

EXHIBIT "4"

RECEIVED

OCD PLANNING  
OFFICE

DRILLING PROGRAM

Enron Oil & Gas Company  
Mesa Verde 7 Federal No. 3  
1980' FNL & 1980' FEL  
Sec. 7, T24S, R32E  
Lea County, New Mexico

1. Geologic Name of Surface Formation:

Permian

2. Estimated Tops of Important Geologic Markers:

Rustler	930'
Delaware	4600'
Bell Canyon	4580'
Cherry Canyon	5650'
Bone Spring	8500'

3. Estimated Depths of Anticipated Fresh Water, Oil or Gas:

Delaware	4600'	Water & Oil
----------	-------	-------------

No other formations are expected to give up oil, gas or fresh water in measurable quantities. The surface fresh water sands will be protected by setting 11-3/4" casing at 600' and circulating cement back to surface, and 8-5/8" casing will be set at 4600' with cement circulating back to surface.



Enron Oil & Gas Company  
Mesa Verde 7 Federal No. 3  
1980' FNL & 1980' FEL  
Sec. 7, T24S, R32E  
Lea County, New Mexico

4. Casing Program:

<u>Hole Size</u>	<u>Interval</u>	<u>OD csg</u>	<u>Weight Grade Jt. Cond. Type</u>
14-3/4	0- 600'	11-3/4	42# H-40 A ST&C
11	0- 4600'	8-5/8	32# J-55 LT&C
7-5/8	0- 8750'	5-1/2	15.5# J-55 LT&C & 17# J-55 LT&C

Cementing Program:

11-3/4" Surface casing: Cement to surface with 275 sx of Class C + 2% CaCl<sub>2</sub> + 1/4#/sx flocele.

8-5/8" Intermediate: Cement to surface with 425 sx of Premium Plus lite + 15#/sx salt + 1/4#/sx Flocele and 300 sx Cl C + 2% CaCl<sub>2</sub>

5-1/2" Prod casing: Cement with 350 sx 50/50 Cl H/Poz + 0.8% Halad 9 + 1/4#/sx Flocele. This cement slurry is designed to bring TOC to 4000'.

5. Minimum Specifications for Pressure Control:

The blowout preventer equipment (BOP) shown in Exhibit #1 will consist of a double ram-type (3000 psi WP) preventer and an annular preventer (3000 psi WP). Units will be hydraulically operated and the ram-type will be equipped with blind rams on top and drill pipe rams on bottom. All will be installed on the 11-3/4" surface casing and used continuously until TD is reached. All BOP's and accessory equipment will be tested to 1000 psi before drilling out of surface casing. Before drilling out of intermediate casing, the ram-type BOP and accessory equipment will be tested to 3000 psi and the annular to 70% of rated working pressure (2100 psi).

Pipe rams will be operationally checked each 24 hour period. Blind rams will be operationally checked on each trip out of the hole. These checks will be noted on the daily tour sheets. A 2" kill line and 4" choke line will be included in the drilling spool located below the ram-type BOP. Other accessories to the BOP equipment will include a kelly cock and floor safety valve (inside BOP) and choke lines and choke manifold with 3000 psi WP rating.

RECEIVED  
JUN 2 1964  
OCEANOGRAPHY  
OFFICE

ENRON OIL & GAS COMPANY  
Mesa Verde 7 Federal #3

ATTACHMENT

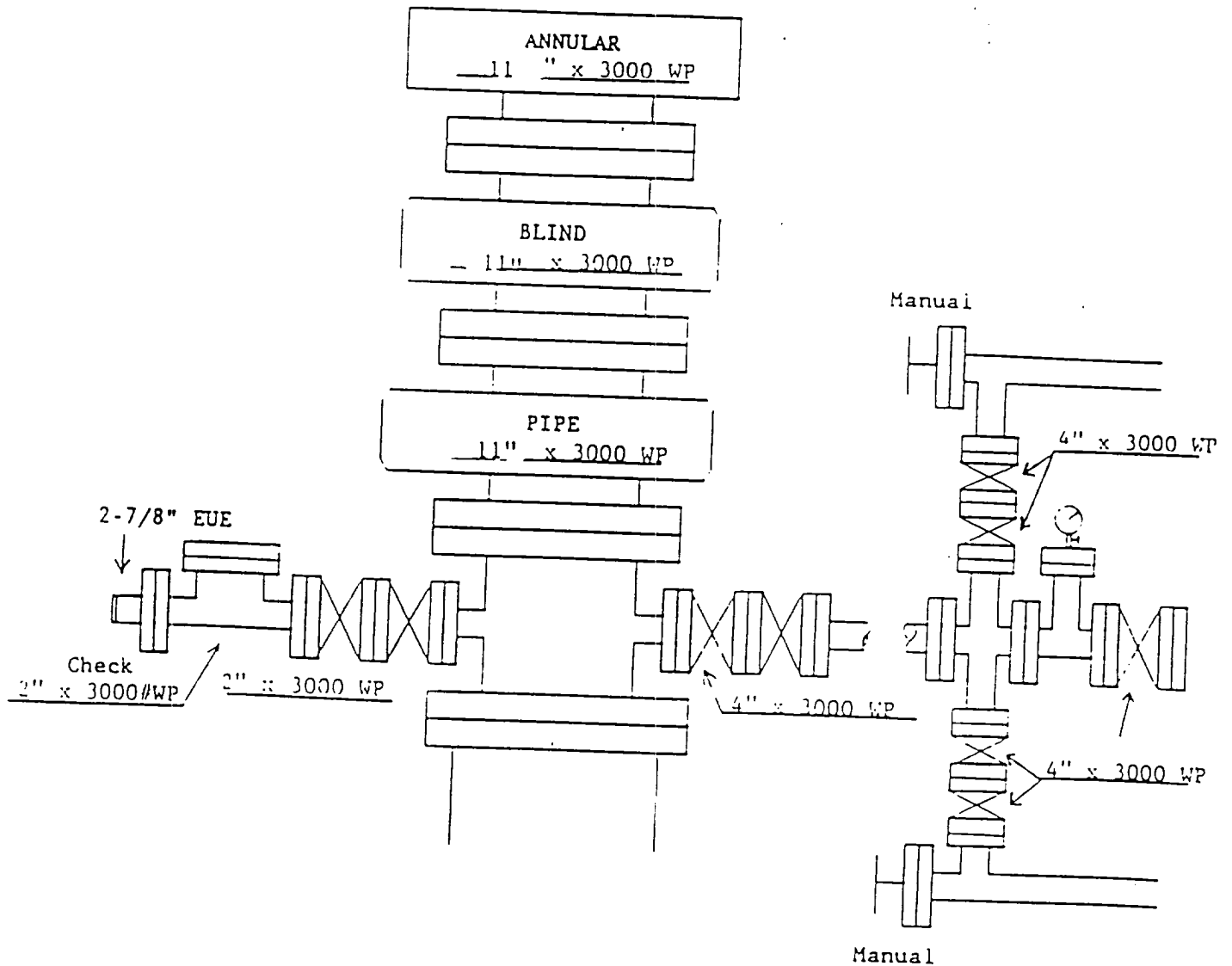

EXHIBIT "1"

RECEIVED

OUR OFFICE