

I
Box 1980
Jbs, NM 88241-1980

State of New Mexico
Encl Minerals, and Natural Resources De ment

Form C-102
Revised 02-10-94
Instructions on back

DISTRICT II
P. O. Drawer DD
Artesia, NM 88211-0719

DISTRICT III
1000 Rio Brazos Rd.
Aztec, NM 87410

DISTRICT IV
P. O. Box 2088
Santa Fe, NM 87507-2088

OIL CONSERVATION DIVISION

P. O. Box 2088
Santa Fe, New Mexico 87504-2088

Submit to the Appropriate
District Office
State Lease - 4 copies
Fee Lease - 3 copies

☐ AMENDED REPORT

WELL LOCATION AND ACREAGE DEDICATION PLAT

1 API Number 30-025-33195		2 Pool Code 96279		3 Pool Name Mesa Verde South Sand Dunes Bone Spring/Mesa Verde Delaware					
4 Property Code 20964		5 Property Name NAFTA FEDERAL '8'						6 Well Number 1	
7 OGRID No. 26485		8 Operator Name Pogo Producing BURLINGTON RESOURCES OIL & GAS COMPANY						9 Elevation 3597'	
10 SURFACE LOCATION									
UL or lot no. I	Section 8	Township 24 SOUTH	Range 32 EAST, N.M.P.M.	Lot Ida	Feet from the 1650'	North/South line SOUTH	Feet from the 990'	East/West line EAST	County LEA
11 BOTTOM HOLE LOCATION IF DIFFERENT FROM SURFACE									
UL or lot no.	Section	Township	Range	Lot Ida	Feet from the	North/South line	Feet from the	East/West line	County
12 Dedicated Acres 40		13 Joint or Infill		14 Consolidation Code		15 Order No.			
NO ALLOWABLE WELL BE ASSIGNED TO THIS COMPLETION UNTIL ALL INTERESTS HAVE BEEN CONSOLIDATED OR A NON-STANDARD UNIT HAS BEEN APPROVED BY THE DIVISION									

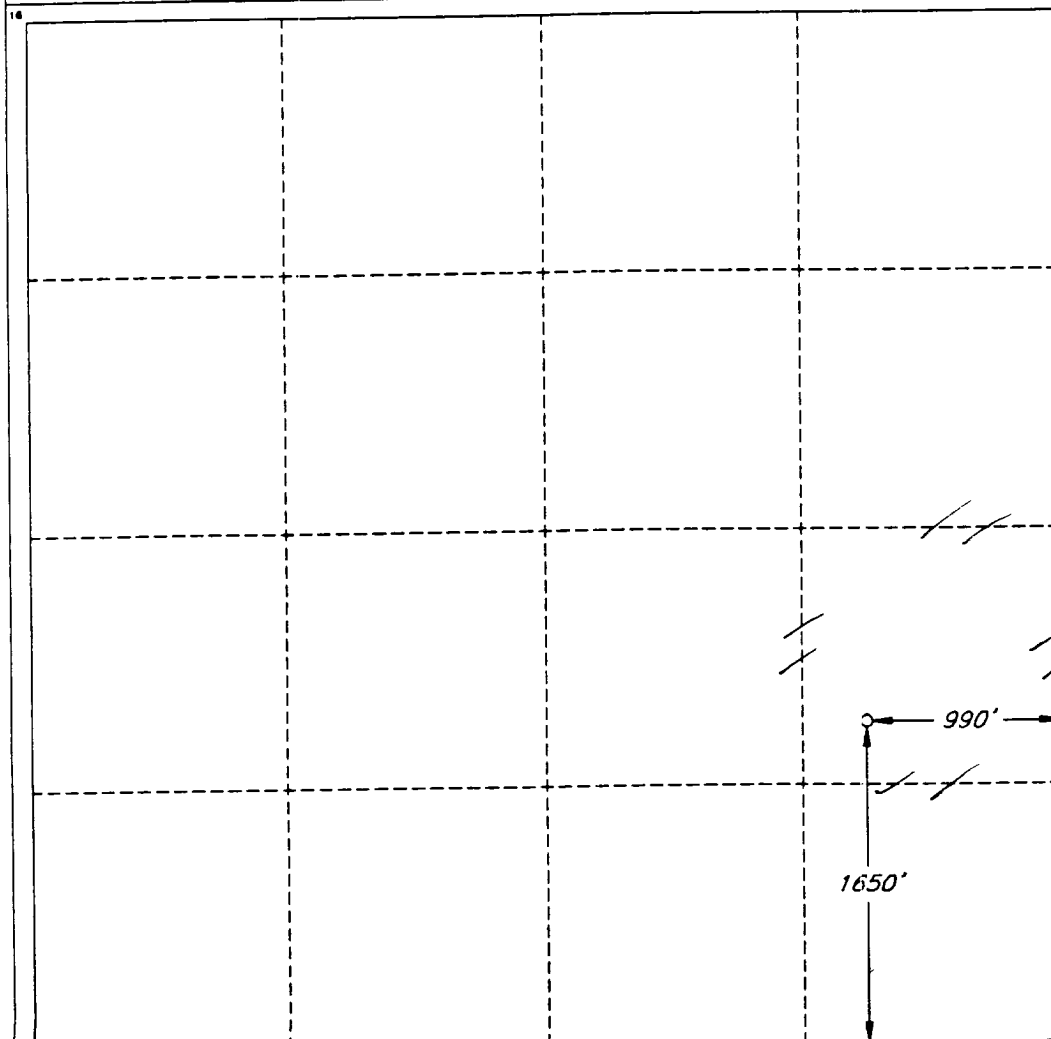

OPERATOR CERTIFICATION

I hereby certify that the information contained herein is true and complete to the best of my knowledge and belief.

Signature

Donna Williams

Printed Name

Regulatory Compliance

Title

4/9/97

Date

SURVEYOR CERTIFICATION

I hereby certify that the well location shown on this plat was plotted from field notes of actual surveys made by me or under my supervision, and that the same is true and correct to the best of my belief.

Date of Survey

MARCH 25, 1997

Signature and Seal of Professional Surveyor

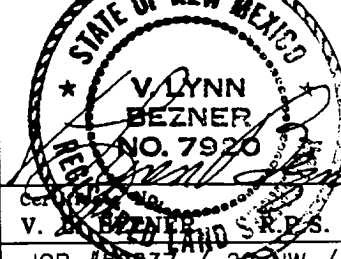

Certified by V. LYNN BEZNER, S.P.S. #7920

FOR #1017-20 NW / V.H.R.