

SECTION 15, TOWNSHIP 24 SOUTH, RANGE 33 EAST, N.M.P.M.
LEA COUNTY, NEW MEXICO

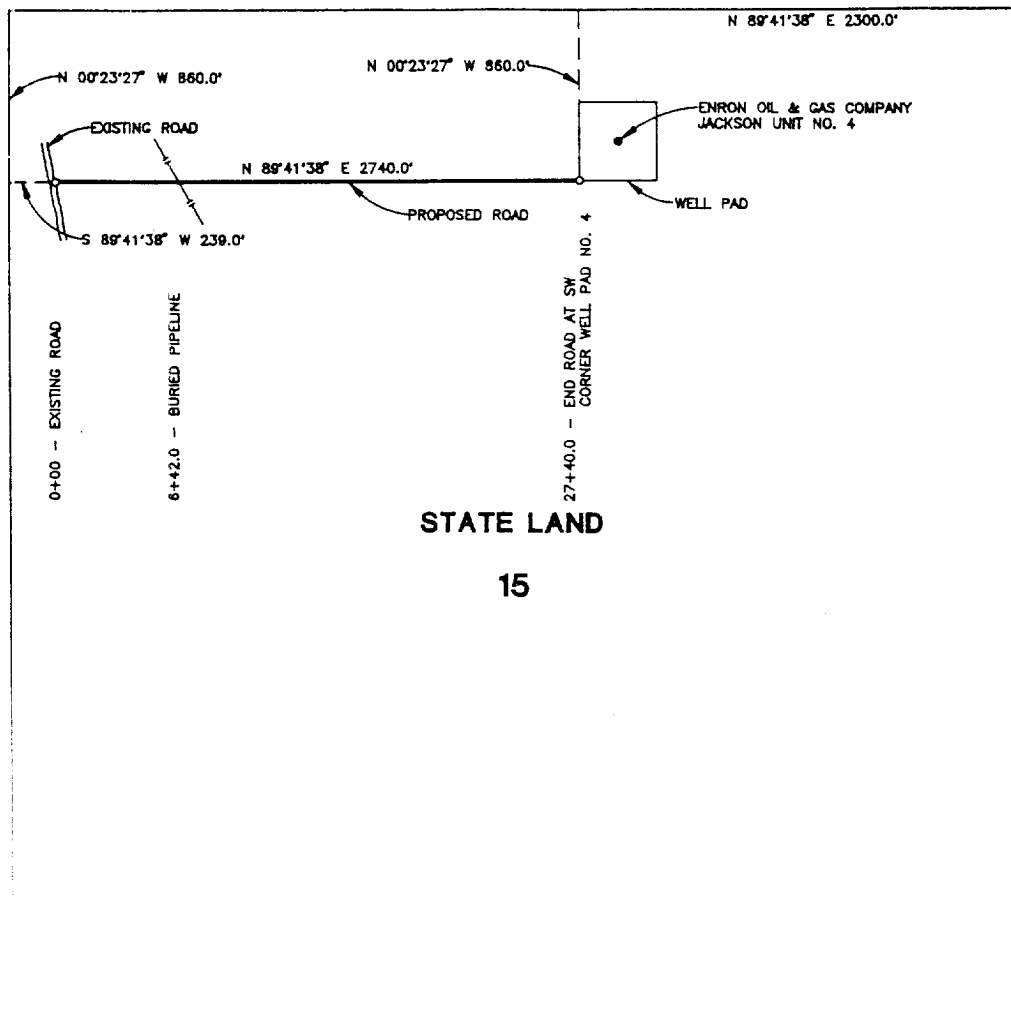

CENTERLINE DESCRIPTION FOR A PROPOSED ROAD:

BEGINNING at a point in an existing road, from which point the Northwest corner of Section 15, T-24-S, R-33-E, NMPM, Lea County, New Mexico bears S 89° 41' 38" W, 239.0 feet and N 00° 23' 17" W, 860.0 feet;

THENCE N 89° 41' 38" E, 2740.0 feet to the Southwest corner of a 400' x 400' well site for the end of this road, from which point the Northwest corner of Section 15 bears N 00° 23' 27" W, 860.0 feet and N 89° 41' 38" E, 2300.0 feet.

PROPOSED ROAD TO SERVE
JACKSON UNIT WELL NO. 4

I hereby certify that this plat was prepared from an actual survey made on the ground and meets or exceeds all requirements for land surveys as specified by the state of New Mexico.

ENRON OIL AND GAS COMPANY

Proposed Road in Section 15, T-24-S,
R-33-E, NMPM, Lea County, New Mexico

WEST TEXAS CONSULTANTS, INC.

ENGINEERS-PLANNERS-SURVEYORS

MIDLAND, TEXAS

Survey Date: 1-15-96

Date: 1-17-96

Scale: 1" = 1000'

WTC No. 44362

Drawn By: R.S.

Sheet 1 of 1

Earl Foote
Registered Professional Surveyor
New Mexico Certificate No. 8278

