

DISTRICT I
P. O. Box 1980
Hobbs, NM 88241-1980

State of New Mexico
Energy, Minerals, and Natural Resources Department

Form C-102
Revised 02-10-94

Instructions on back

DISTRICT II
P. O. Drawer DD
Artesia, NM 88211-0719

OIL CONSERVATION DIVISION

P. O. Box 2088
Santa Fe, New Mexico 87504-2088

Submit to the Appropriate
District Office
State Lease - 4 copies
Fee Lease - 3 copies

☐ AMENDED REPORT

DISTRICT III
1000 Rio Brazos Rd.
Aztec, NM 87410

DISTRICT IV
P. O. Box 2088
Santa Fe, NM 87507-2088

WELL LOCATION AND ACREAGE DEDICATION PLAT

1 API Number 30-025-33493		2 Pool Code 58300		3 Pool Name TEAGUE BLINEBRY			
4 Property Code 58300 9280		5 Property Name E. C. HILL 'B' FEDERAL				6 Well Number 18	
7 OGRID No. 017805		8 Operator Name PLAINS PETROLEUM OPERATING COMPANY				9 Elevation 3275'	

10 SURFACE LOCATION

UL or lot no. G	Section 34	Township 23 SOUTH	Range 37 EAST, N.M.P.M.	Lot 1da	Feet from the 1400'	North/South line NORTH	Feet from the 2280'	East/West line EAST	County LEA
--------------------	---------------	----------------------	----------------------------	---------	------------------------	---------------------------	------------------------	------------------------	---------------

11 "BOTTOM HOLE LOCATION IF DIFFERENT FROM SURFACE

UL or lot no.	Section	Township	Range	Lot 1da	Feet from the	North/South line	Feet from the	East/West line	County
---------------	---------	----------	-------	---------	---------------	------------------	---------------	----------------	--------

12 Dedicated Acres	13 Joint or Infill	14 Consolidation Code	15 Order No.
--------------------	--------------------	-----------------------	--------------

NO ALLOWABLE WELL BE ASSIGNED TO THIS COMPLETION UNTIL ALL INTERESTS HAVE BEEN CONSOLIDATED OR A NON-STANDARD UNIT HAS BEEN APPROVED BY THE DIVISION

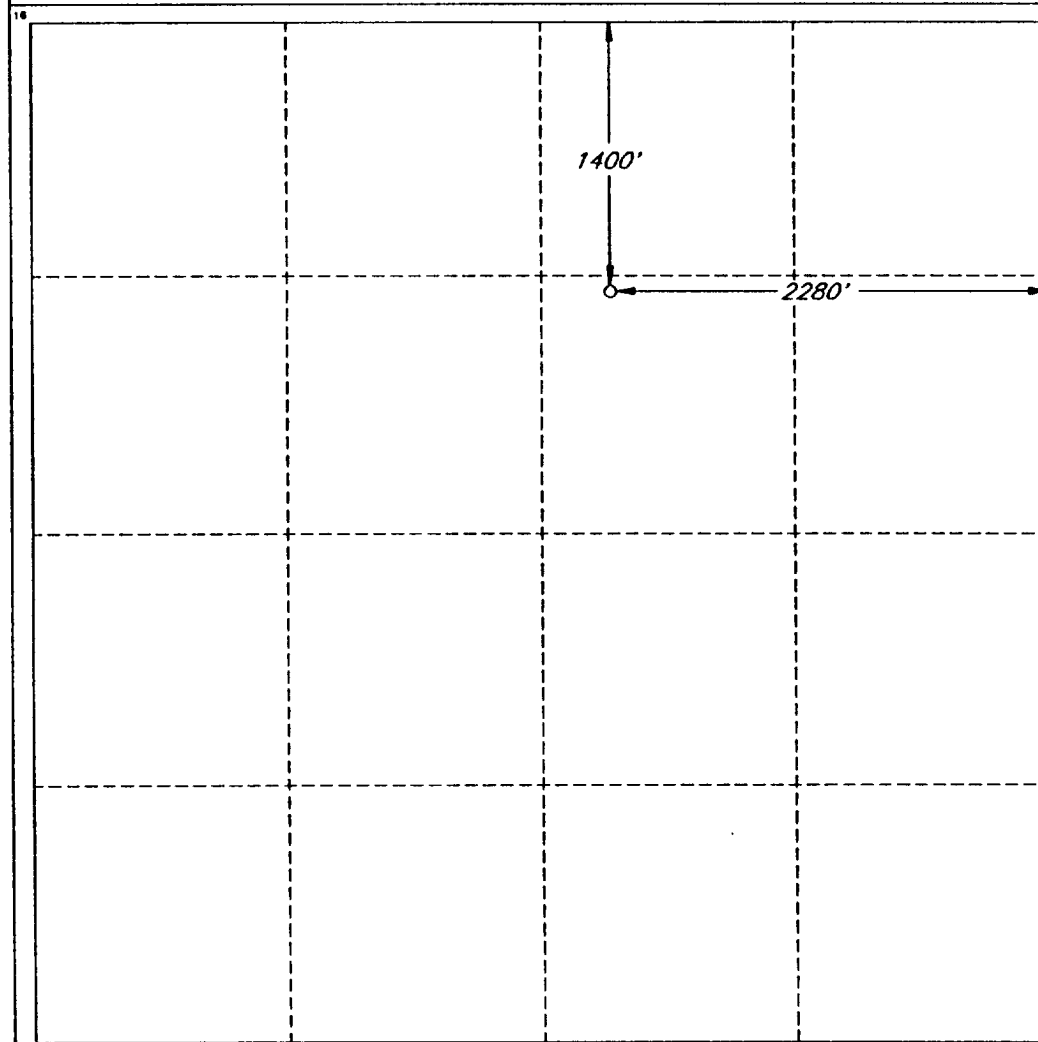

OPERATOR CERTIFICATION

I hereby certify that the information contained herein is true and complete to the best of my knowledge and belief.

Signature

Stephen D. Owen

Printed Name

Stephen D. Owen

Title

Area Engineer

Date

May 8, 1996

SURVEYOR CERTIFICATION

I hereby certify that the well location shown on this plat was plotted from field notes of actual surveys made by me or under my supervision, and that the same is true and correct to the best of my belief.

Date of Survey

APRIL 29, 1996

Signature and Seal of Professional Engineer

V. LYNN BEZNER

NO. 7920

Certified by

V. L. BEZNER

NO. 7920

JOB #43226-34-45 SW / JSJ