

DISTRICT I
P. O. Box 1980
Hobbs, NM 88241-1980

State of New Mexico
Energy, Minerals, and Natural Resources Department

Form C-102
Revised 02-10-94

Instructions on back

DISTRICT II
P. O. Drawer DD
Artesia, NM 88211-0719

OIL CONSERVATION DIVISION
P. O. Box 2088
Santa Fe, New Mexico 87504-2088

Submit to the Appropriate
District Office
State Lease - 4 copies
Fee Lease - 3 copies

☐ AMENDED REPORT

DISTRICT IV
P. O. Box 2088
Santa Fe, NM 87507-2088

WELL LOCATION AND ACREAGE DEDICATION PLAT

1 API Number 30-025-33494		2 Pool Code 58300		3 Pool Name TEAGUE BLINEBRY			
4 Property Code 58300 9280		5 Property Name E. C. HILL 'B' FEDERAL				6 Well Number 19	
7 OGRID No. 017805		8 Operator Name PLAINS PETROLEUM OPERATING COMPANY				9 Elevation 3274'	

10 SURFACE LOCATION

UL or lot no. J	Section 34	Township 23 SOUTH	Range 37 EAST, N.M.P.M.	Lot Ida	Feet from the 2800'	North/South line SOUTH	Feet from the 2280'	East/West line EAST	County LEA
--------------------	---------------	----------------------	----------------------------	---------	------------------------	---------------------------	------------------------	------------------------	---------------

11 BOTTOM HOLE LOCATION IF DIFFERENT FROM SURFACE

UL or lot no.	Section	Township	Range	Lot Ida	Feet from the	North/South line	Feet from the	East/West line	County
---------------	---------	----------	-------	---------	---------------	------------------	---------------	----------------	--------

12 Dedicated Acres	13 Joint or Infill	14 Consolidation Code	15 Order No.
--------------------	--------------------	-----------------------	--------------

NO ALLOWABLE WELL BE ASSIGNED TO THIS COMPLETION UNTIL ALL INTERESTS HAVE BEEN
CONSOLIDATED OR A NON-STANDARD UNIT HAS BEEN APPROVED BY THE DIVISION

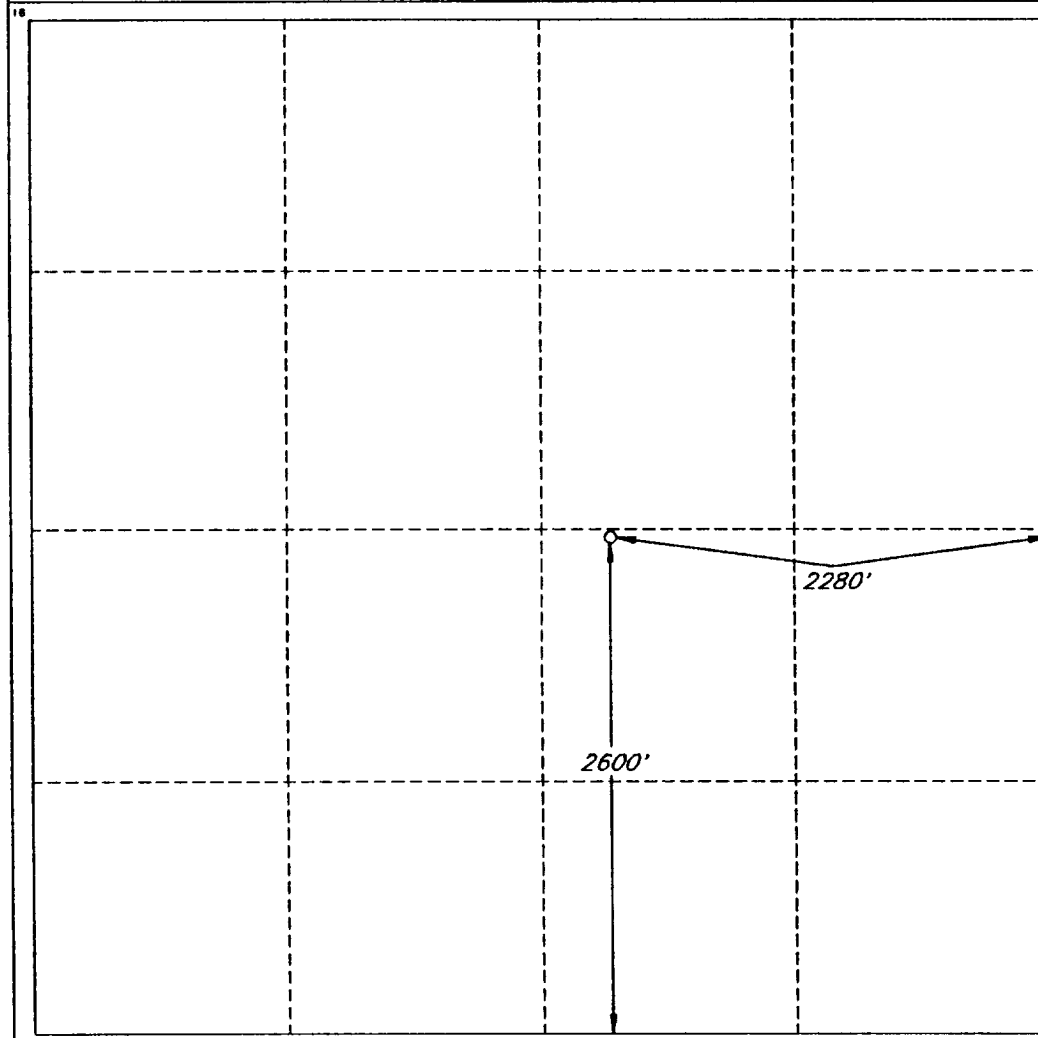

OPERATOR CERTIFICATION

I hereby certify that the information
contained herein is true and complete
to the best of my knowledge and belief.

Signature
Stephen D. Owen

Printed Name
Stephen D. Owen

Title
Area Engineer

Date
May 8, 1996

SURVEYOR CERTIFICATION

I hereby certify that the well
location shown on this plat was
plotted from field notes of actual
surveys made by me or under
my supervision, and that the
same is true and correct to the
best of my belief.

Date of Survey
APRIL 30, 1996

Signature and Seal of
Professional Surveyor

V. LYNN
BEZNER
NO. 7920

Certification No.
V. L. BEZNER AND P.C. #7920

JOB #45226 15 SW / V.H.B.

APPLICATION TO DRILL
PLAINS PETROLEUM OPERATING COMPANY
E. C. HILL "B" Federal #19
2600' FSL & 2280' FEL
Sec 34 (J), T23S, R37E
Lea County, New Mexico
Lease No. NMLC 064118
May 8, 1996

In addition with Form 3160-2, Application to Drill the above well, Plains Petroleum Operating Company submits the following in accordance with BLM requirements.

1. ESTIMATED GEOLOGICAL MARKERS

GL: 3274' KB: 3286'

<u>FORMATION</u>	<u>TOP</u>	<u>SS</u>
Penrose	3404'	-137'
Glorietta-Paddock	4927'	-1680'
Blinebry	5307'	-2060'

2. CASING DETAIL

	Casing Size OD	Interval	Length of Interval	Weight #/Ft	Interval Weight	Casing Grade	Joint
Intermediate	8-5/8"	0'- 1175'	1175'	24#/ft	28,200	K-55	STC
Production	5-1/2"	0'- 5850'	5850'	15.5#/ft	90,975	K-55	LTC
Tubing	2-7/8"	0'- 5800'	5800'	6.4#/ft	27,260	J-55	EUE

3. CEMENTING & FLOAT EQUIPMENT DETAIL

<u>WELL DATA</u>	<u>SURFACE</u>	<u>PRODUCTION (TD 5850')</u>
Depth	1175'	5850'
Casing Size	8-5/8"	5-1/2"
Hole Size	12-1/4"	7-7/8"
Desired Fill	Surface	4900', Surface
Hole Volume	485 Ft ³	165 Ft ³ , 872 Ft ³
Recommended Volume	970 FT ³	247 Ft ³ , 1308 Ft ³
DV Tool Depth	N/A	2900'