



STATE OF NEW MEXICO
ENERGY, MINERALS AND NATURAL RESOURCES DEPARTMENT

OIL CONSERVATION DIVISION
HOBBS DISTRICT OFFICE

5/31/96

GOVERNOR

POST OFFICE BOX 1980
HOBBS, NEW MEXICO 88241-1980
(505) 393-6161

OIL CONSERVATION DIVISION
P. O. BOX 2088
SANTA FE, NEW MEXICO 87501

NSL 3674 (SD)
5/31/96

RE: Proposed:

MC	_____
DHC	_____
NSL	_____ <i>X</i>
NSP	_____
SWD	_____
WFX	_____
PMX	_____

Gentlemen:

I have examined the application for the:

Arch Petroleum Inc CE Lamunyon Fed #61-C 28-23s-37e
Operator Lease & Well No. Unit S-T-R

and my recommendations are as follows:

OK

Yours very truly,

Jerry Sexton
Supervisor, District 1

/ed



Arch Petroleum Inc.

May 29, 1996

Application for Administrative Approval of
Unorthodox Well Location - C. E. Lamunyon #61
Lea County, New Mexico

William J. LeMay, Director
Oil Conservation Division
New Mexico Department of Energy,
Minerals and Natural Resources
2040 South Pacheco Street
Santa Fe, New Mexico 87505

Dear Mr. LeMay:

Arch Petroleum Inc. hereby seeks administrative approval pursuant to the provisions of Division Rule 104 F(2) adopted on January 18, 1996, of the unorthodox well located at 1216' FNL, 2620' FWL, Unit C, Sect. 28, T23S, R37E and shown on the attached Exhibit A.

Exhibit B is lease Base Map showing the proposed location. This location does encroach on an immediately adjacent existing spacing unit in the same pool. This adjacent spacing unit is in the same lease as the subject well and is also operated by Arch Petroleum. Therefore, there are no affected parties to whom notice is required pursuant to the NMOCD rules.

Exhibit B also shows the first seven infill wells drilled as Phase I wells pursuant to OCD Order #R-10453. The initial potential tests from the NMOCD Form C-105 are listed on Exhibit C. The results have been encouraging to date although it is too early to project an estimated ultimate recovery.

This unorthodox location in the Blinebry formation is necessary for geological reasons. Exhibit D is a porosity isopach map of the Blinebry. It shows the areal extent of the porosity development in the field. This development is made up of thin porosity stringers that are very discontinuous between wellbores. This discontinuity, coupled with the low average porosity of five to eight percent and low average permeability of 0.5 millidarcies causes low ultimate recoveries and inadequate drainage of the field based on current 40 acre locations.

Exhibit E is a Drainage Map showing the areas estimated to be drained by the existing wells in the Blinebry. The drainage areas shown were calculated and are listed on Exhibit F. The parameters used to make these calculations are also shown. On average, it is seen that the

existing wells are expected to drain a little over 13 acres per well. It is therefore necessary to drill the subject well to avoid waste and efficiently recover the available reserves.

Your attention to this request is appreciated.

Very truly yours,

A handwritten signature in cursive script that reads "Chris N. Bezner".

Chris N. Bezner, P. E.

Engineer

CNB/

Attachments

cc: Mr. Jerry Sexton, District Supervisor

Oil Conservation Division

Mr. William F. Carr

Attorney for Arch Petroleum Inc.

DISTRICT I

P.O. Box 1980, Hobbs, NM 88241-1980

State of New Mexico

Energy, Minerals and Natural Resources Department

DISTRICT II

P.O. Drawer DD, Artesia, NM 88211-0719

DISTRICT III

1000 Rio Brazos Rd., Aztec, NM 87410

DISTRICT IV

P.O. Box 2068, Santa Fe, NM 87504-2068

OIL CONSERVATION DIVISION

P.O. Box 2088

Santa Fe, New Mexico 87504-2088

Form C-102

Revised February 10, 1994

Submit to Appropriate District Office

State Lease - 4 Copies

Fee Lease - 3 Copies

☐ AMENDED REPORT

WELL LOCATION AND ACREAGE DEDICATION PLAT

API Number		Pool Code 58300		TEAGUE BLINEBRY		Pool Name	
Property Code 014898		Property Name C. E. LAMUNYON FEDERAL				Well Number 61	
OGRID No. 000962		Operator Name ARCH PETROLEUM INC.				Elevation 3303	

Surface Location									
UL or lot No. C	Section 28	Township 23 S	Range 37 E	Lot Idn	Feet from the 1216	North/South line NORTH	Feet from the 2620	East/West line WEST	County LEA

Bottom Hole Location If Different From Surface									
UL or lot No.	Section	Township	Range	Lot Idn	Feet from the	North/South line	Feet from the	East/West line	County
Dedicated Acres 40	Joint or Infill Infill	Consolidation Code		Order No.					

NO ALLOWABLE WILL BE ASSIGNED TO THIS COMPLETION UNTIL ALL INTERESTS HAVE BEEN CONSOLIDATED
OR A NON-STANDARD UNIT HAS BEEN APPROVED BY THE DIVISION

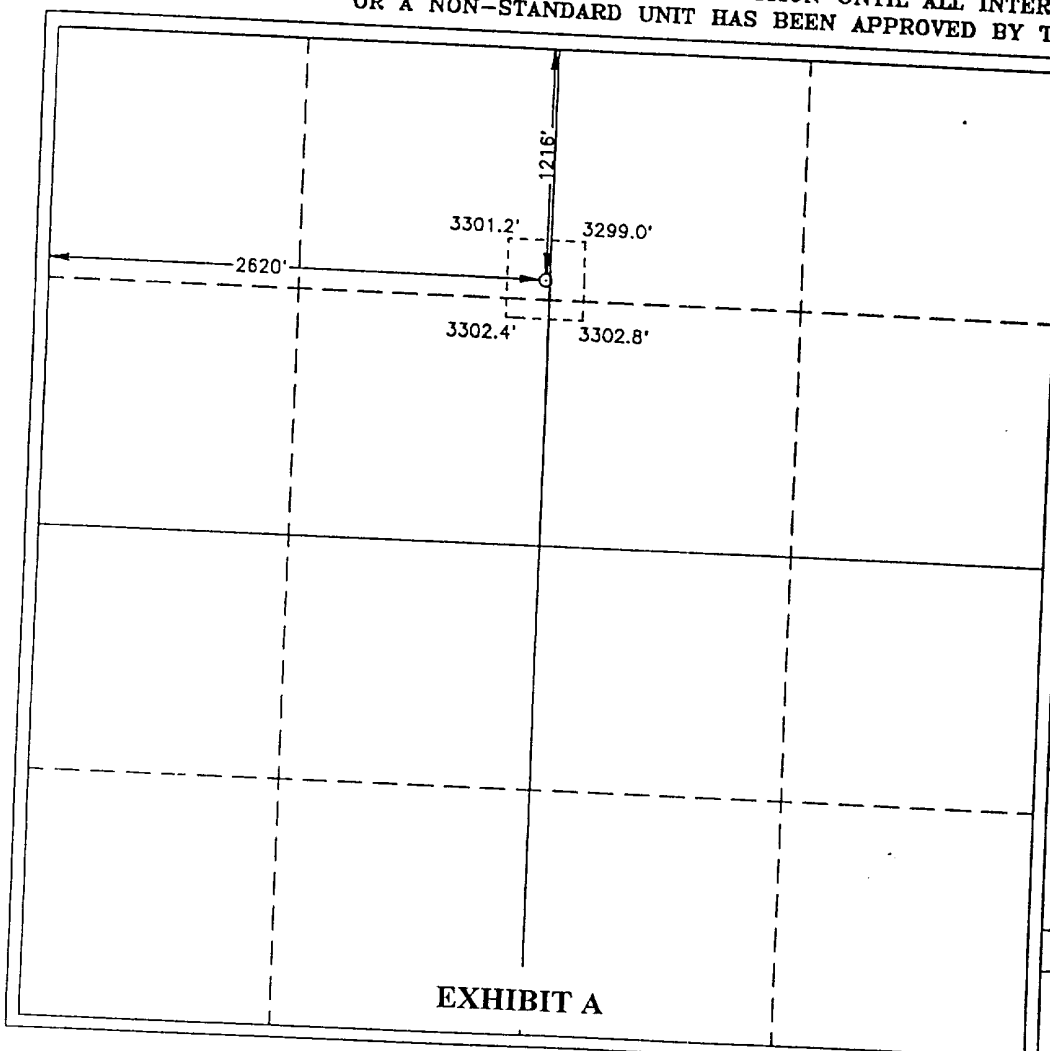

OPERATOR CERTIFICATION

I hereby certify the the information
contained herein is true and complete to the
best of my knowledge and belief.

Bobbie Brooks
Signature

Bobbie Brooks
Printed Name

Production Analyst
Title

5-29-96
Date

SURVEYOR CERTIFICATION

I hereby certify that the well location shown
on this plat was plotted from field notes of
actual surveys made by me or under my
supervision, and that the same is true and
correct to the best of my belief.

MAY 13, 1996

Date Surveyed
Signature & Seal of Professional Surveyor
JLP

Professional Surveyor
NEW MEXICO

Gary G. Eidson
Signature

5-26-96
Date

940. Num 96-11-0571
Certificate No.

JOHN W. WEST, 676
RONALD J. EIDSON, 3239
GARY G. EIDSON, 12841

TEAGUE BLINEBRY - INFILL WELLS

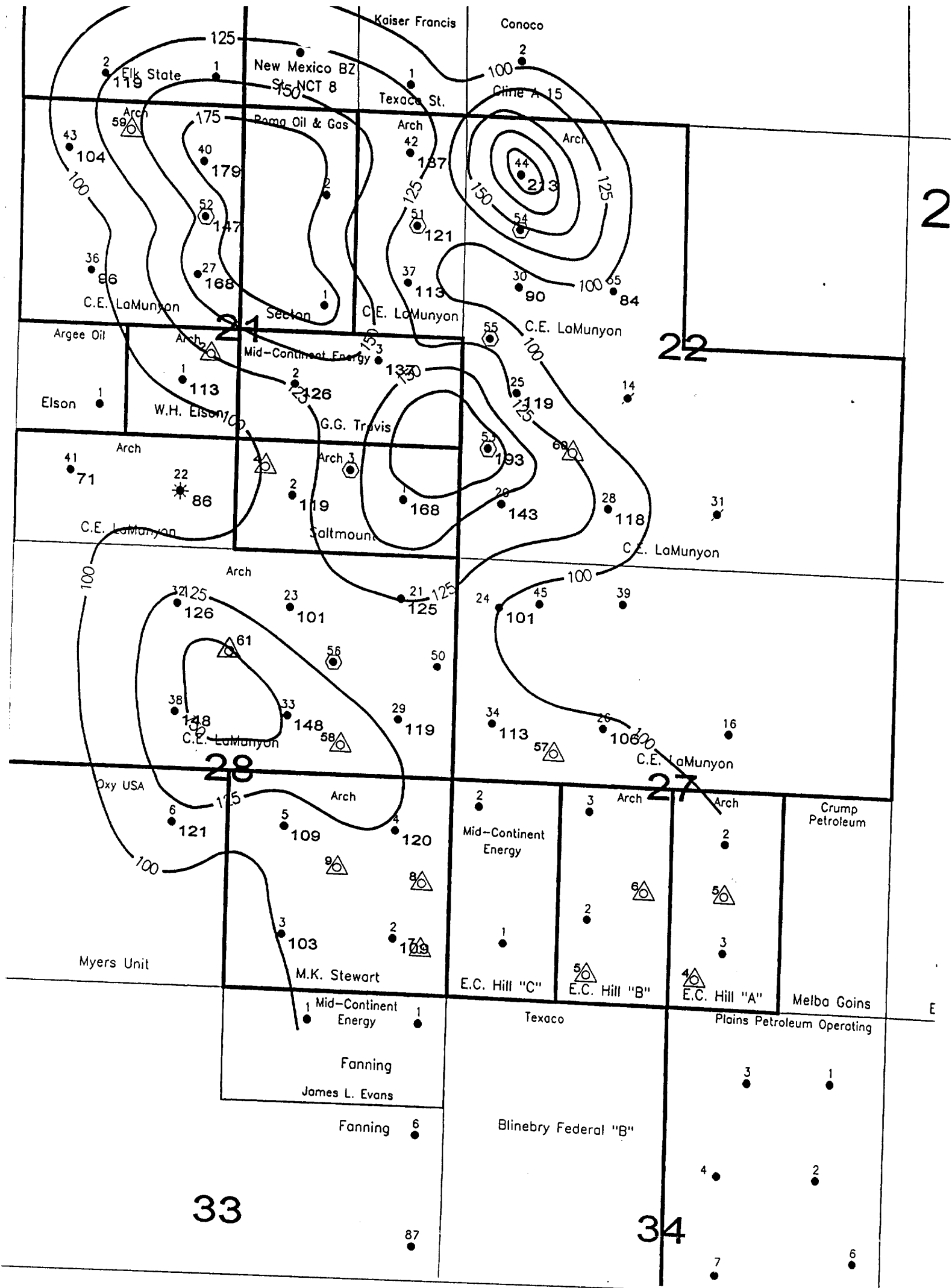

WELL NAME	INITIAL POTENTIAL TEST (C-105)			
	DATE	BOPD	BWPD	MCFPD
C. E. LAMUNYON #51	10/22/95	115	102	706
C. E. LAMUNYON #52	11/09/95	127	10	222
C. E. LAMUNYON #53	11/19/95	180	142	802
C. E. LAMUNYON #54	03/05/96	56	118	181
C. E. LAMUNYON #55	02/13/96	162	93	709
C. E. LAMUNYON #56	03/10/96	250	341	467

SALTMOUNT #3	02/02/96	105	413	200
--------------	----------	-----	-----	-----



LEGEND

EXHIBIT D

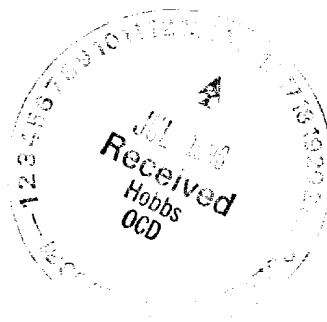

-  Phase 1 Infill Wells
-  Proposed Phase 2 Infill Wells
-  Blinebry Producer

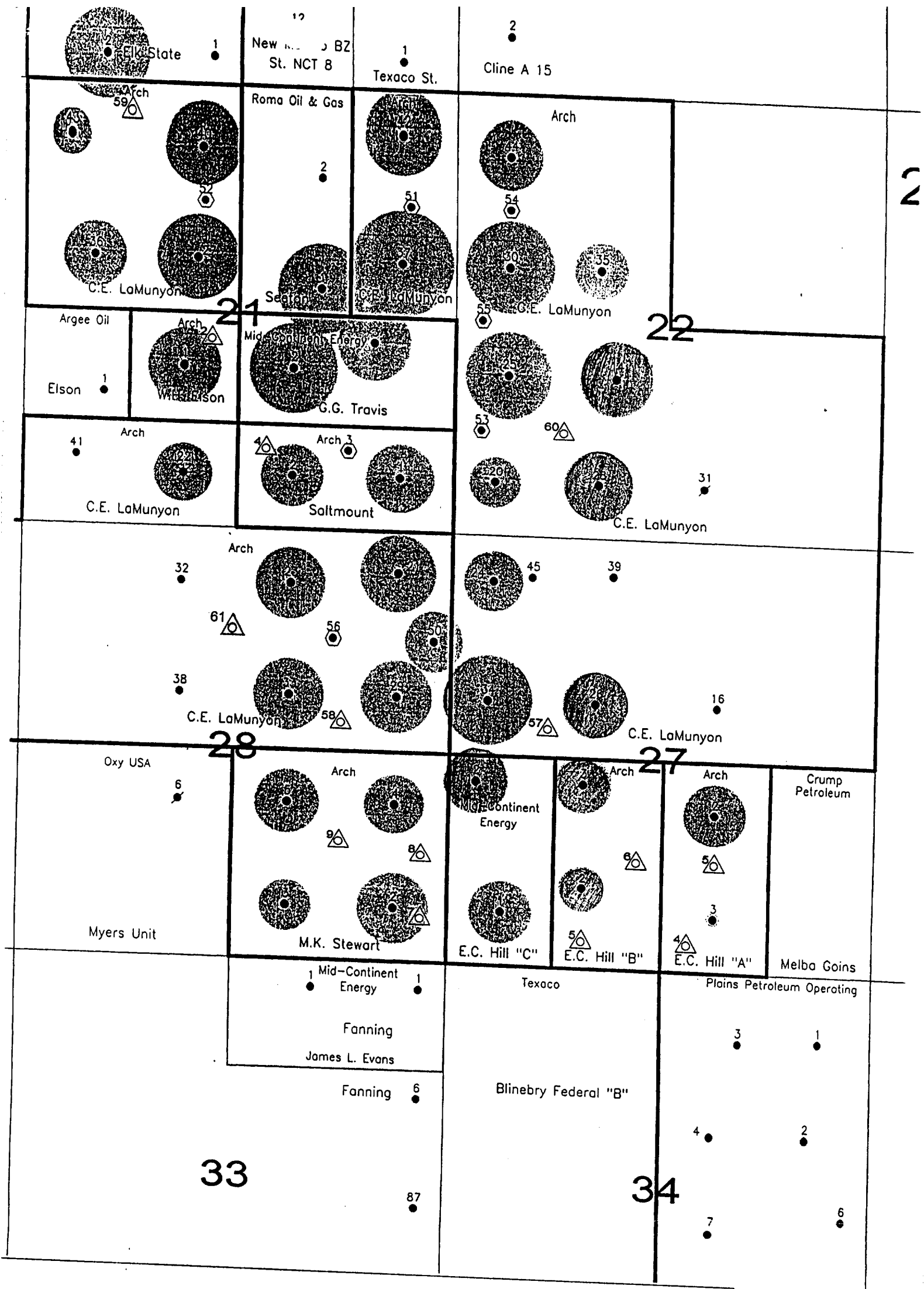



LEGEND

EXHIBIT E

-  Phase 1 Infill Wells
-  Proposed Phase 2 Infill Wells
-  Drainage Area

11/11/11

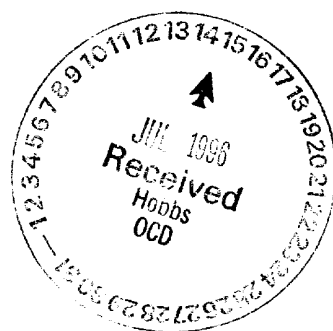

TEAGUE BLINEBRY FIELD - INFILL WELLS
Estimated Ultimate Recovery-Drainage Radius

	Current Well	Net Pay, h net, ft.	Est. Ult. Prim. Rec., MSTB	Drainage Acres	Drainage Radius, ft.
1	GG Travis 2	126	151.3	21.4	545
2	GG Travis 3	137	112.7	14.7	451
3	Lamunyon 14	90	73.8	14.6	450
4	Lamunyon 20	143	58.9	7.3	319
5	Lamunyon 21	125	111.7	15.9	470
6	Lamunyon 22	86	46.8	9.7	367
7	Lamunyon 23	101	76.5	13.5	433
8	Lamunyon 24	101	55.0	9.7	367
9	Lamunyon 25	119	134.0	20.1	528
10	Lamunyon 26	106	69.1	11.6	402
11	Lamunyon 27	168	177.2	18.8	511
12	Lamunyon 28	118	86.6	13.1	426
13	Lamunyon 29	119	95.1	14.3	445
14	Lamunyon 30	90	109.7	21.7	549
15	Lamunyon 33	148	114.9	13.9	438
16	Lamunyon 34	113	137.7	21.7	549
17	Lamunyon 35	84	37.7	8.0	333
18	Lamunyon 36	96	59.9	11.1	393
19	Lamunyon 37	113	184.6	29.1	636
20	Lamunyon 39	110	1.6	0.3	60
21	Lamunyon 40	179	158.9	15.8	469
22	Lamunyon 42	137	124.3	16.2	474
23	Lamunyon 43	104	24.8	4.3	243
24	Lamunyon 44	213	135.7	11.4	397
25	Lamunyon 50*	123	64.6	9.4	360
26	Elk State 2	119	138.4	20.8	536
27	W H Elson 1	113	94.8	15.0	456
28	E C Hill A 2	110	67.7	11.0	390
29	E C Hill A 3	115	3.4	0.5	86
30	E C Hill B 2	120	39.0	5.8	284
31	E C Hill B 3	115	59.0	9.2	356
32	E C Hill C 1	120	73.1	10.9	388
33	E C Hill C 2	120	78.1	11.6	401
34	M K Stewart 2	109	87.2	14.3	445
35	M K Stewart 3	103	42.9	7.4	321
36	M K Stewart 4	120	66.7	9.9	371
37	M K Stewart 5	109	70.7	11.6	401
38	Saltmount 1	168	124.7	13.2	429
39	Saltmount 2	119	73.2	11.0	390
40	Seeton 1	187	221.9	21.2	542
Total/Average		4,896	3,643.9	13.3	429

Assumes: Swi=18%, Avg. Porosity=7.4%, Boi=1.26 RB/STB

Recovery Factor=15%

* First 20-Acre Infill Drilled

2000

