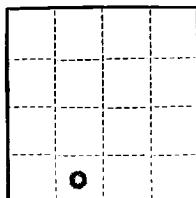

APPROVED

Form 9-331a
(Feb. 1951)Budget Bureau No. 42-R358.4.
Approval expires 12-31-60.S. W. STANLEY
DISTRICT ENGINEER

(SUBMIT IN TRIPLICATE)

 UNITED STATES
DEPARTMENT OF THE INTERIOR
GEOLOGICAL SURVEY

Land Office

Lease No. **LC-061936 A**

Unit

SUNDRY NOTICES AND REPORTS ON WELLS

NOTICE OF INTENTION TO DRILL.....	XX	SUBSEQUENT REPORT OF WATER SHUT-OFF.....	
NOTICE OF INTENTION TO CHANGE PLANS.....		SUBSEQUENT REPORT OF SHOOTING OR ACIDIZING.....	
NOTICE OF INTENTION TO TEST WATER SHUT-OFF.....		SUBSEQUENT REPORT OF ALTERING CASING.....	
NOTICE OF INTENTION TO RE-DRILL OR REPAIR WELL.....		SUBSEQUENT REPORT OF RE-DRILLING OR REPAIR.....	
NOTICE OF INTENTION TO SHOOT OR ACIDIZE.....		SUBSEQUENT REPORT OF ABANDONMENT.....	
NOTICE OF INTENTION TO PULL OR ALTER CASING.....		SUPPLEMENTARY WELL HISTORY.....	
NOTICE OF INTENTION TO ABANDON WELL.....			

(INDICATE ABOVE BY CHECK MARK NATURE OF REPORT, NOTICE, OR OTHER DATA)

 Lease No. **192741**
E. F. Ray-Federal NCT-1
This well is in the Cotton Draw Unit
December 13, 19**60**

 Well No. **1** is located **660** ft. from **XXN** line and **1980** ft. from **XXE** line of sec. **10**
SE/4 SW/4 Sec. 10 **T-25-S R-32-E** **NMPT**
 (1/4 Sec. and Sec. No.) (Twp.) (Range) (Meridian)

Undesignated Dela. Sd. **Lea** **New Mexico**
 (Field) (County or Subdivision) (State or Territory)

 The elevation of the derrick floor above sea level is **Not Avail.** ft.

DETAILS OF WORK

(State names of and expected depths to objective sands; show sizes, weights, and lengths of proposed casings; indicate mudding jobs, cementing points, and all other important proposed work)

FORMATION TOPS EXPECTED:		SIZE CASINO			CASING PROGRAM (APPROX.)	
Anhydrite	765'				Set At	Cement
Salt	1140'	7-5/8	24#	New	350'	300 ex
Delaware Line	4660'	4-1/2	9.5#	New	4785'	150 4% Gel
Delaware Sand	4685'					
Total Depth	4985'					

I understand that this plan of work must receive approval in writing by the Geological Survey before operations may be commenced.

Company **TEXACO Inc.**Address **P. O. Box 3109****Midland, Texas**By **J. J. Velten**Title **Division Civil Engineer**

GPO 862040

NEW MEXICO OIL CONSERVATION COMMISSION
WELL LOCATION AND ACREAGE DEDICATION PLAT

FORM C-128
Revised 5/1/57

SEE INSTRUCTIONS FOR COMPLETING THIS FORM ON THE REVERSE SIDE

SECTION A

Operator TEXACO Inc.		Lease E. F. Ray Federal NCT-1		Well No. 1
Unit Letter N	Section 10	Township 25 South	Range 32 East	County Lea
Actual Footage Location of Well: 660 feet from the South line and 1980 feet from the West line Sec. 10				
Ground Level Elev.	Producing Formation Delaware Sand		Pool Undesignated	Dedicated Acreage: 40 Acres

1. Is the Operator the only owner in the dedicated acreage outlined on the plat below? YES X NO ____ . ("Owner" means the person who has the right to drill into and to produce from any pool and to appropriate the production either for himself or for himself and another. (65-3-29 (e) NMSA 1935 Comp.)
2. If the answer to question one is "no," have the interests of all the owners been consolidated by communitization agreement or otherwise? YES ____ NO ____ . If answer is "yes," Type of Consolidation _____
3. If the answer to question two is "no," list all the owners and their respective interests below:

Owner	Land Description
	RECEIVED DEC 14

SECTION B

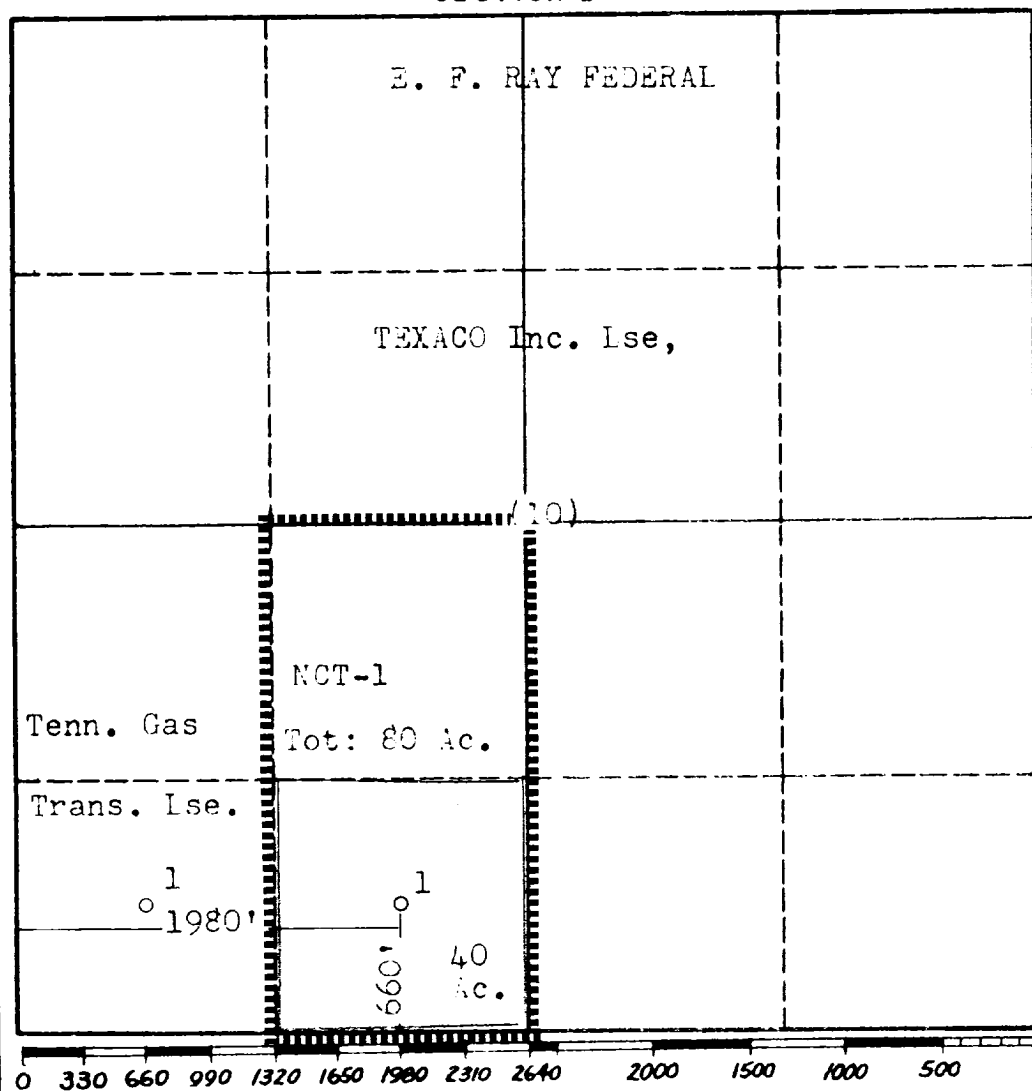

CERTIFICATION

I hereby certify that the information in SECTION A above is true and complete to the best of my knowledge and belief.

Name J. J. Velten
 Position Division Civil Engineer
 Company TEXACO Inc.
 Date 12-13-60

I hereby certify that the well location shown on the plat in SECTION B was plotted from field notes of actual surveys made by me or under my supervision, and that the same is true and correct to the best of my knowledge and belief.

Date Surveyed 12-13-60
 Registered Professional Engineer and/or Land Surveyor J. J. Velten
 Certificate No. 8174