

Form 9-381a
(Feb. 1951)

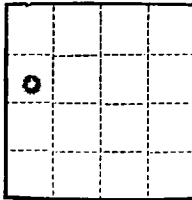

(SUBMIT IN TRIPLICATE)

UNITED STATES
DEPARTMENT OF THE INTERIOR
GEOLOGICAL SURVEY

Land Office _____
Lease No. LC-061930 A
Unit _____

SUNDRY NOTICES AND REPORTS ON WELLS

NOTICE OF INTENTION TO DRILL.....	<input checked="" type="checkbox"/>	SUBSEQUENT REPORT OF WATER SHUT-OFF.....	
NOTICE OF INTENTION TO CHANGE PLANS.....		SUBSEQUENT REPORT OF SHOOTING OR ACIDIZING.....	
NOTICE OF INTENTION TO TEST WATER SHUT-OFF.....		SUBSEQUENT REPORT OF ALTERING CASING.....	
NOTICE OF INTENTION TO RE-DRILL OR REPAIR WELL.....		SUBSEQUENT REPORT OF RE-DRILLING OR REPAIR.....	
NOTICE OF INTENTION TO SHOOT OR ACIDIZE.....		SUBSEQUENT REPORT OF ABANDONMENT.....	
NOTICE OF INTENTION TO PULL OR ALTER CASING.....		SUPPLEMENTARY WELL HISTORY.....	
NOTICE OF INTENTION TO ABANDON WELL.....			

(INDICATE ABOVE BY CHECK MARK NATURE OF REPORT, NOTICE, OR OTHER DATA)

Lease No. 192741 THIS WELL IS IN THE COTTON CRAW UNIT
S. P. Ray Federal W-7-2 AREA 3, 19 61

Well No. Z 37 is located 1200 ft. from N line and 400 ft. from EW line of sec. 10

SW/4 NW/4 Sec. 10 T-25-S R-32-W NMNM
(Section No.) (Twp.) (Range) (Meridian)
Undesignated Lea New Mexico
(Field) (County or Subdivision) (State or Territory)

The elevation of the derrick floor above sea level is 3471 ft.

DETAILS OF WORK

(State names of and expected depths to objective sands; show sizes, weights, and lengths of proposed casings; indicate mudding jobs, cementing points, and all other important proposed work)

OBJECTIVE FORMATIONS	DEPTH	SIZE CASING	WEIGHT	MATERIAL	CASING PROGRAM (Approx.)	
					Set at	Cement
Top of Anhydrite	751'	7-5/8"	24#	Now	350'	250 sx.
" " Salt	1134'	8-7/8"	3.4#	Now	475'	200 sx.
" " Lamar Lime	4039'					
" " Dela. Sand	4667'					
Total Depth	4765'					

I understand that this plan of work must receive approval in writing by the Geological Survey before operations may be commenced.

Company TEXACO Inc.
P. O. Box 3109
Address Midland, Texas

TEXACO Inc.
By J. J. Veiton
Title Division Civil Engineer

NEW MEXICO OIL CONSERVATION COMMISSION
WELL LOCATION AND ACREAGE DEDICATION PLAT

FORM C-128
 Revised 5/1/57

SEE INSTRUCTIONS FOR COMPLETING THIS FORM ON THE REVERSE SIDE

SECTION A

Operator TEXACO Inc.		Lease <i>Cottonwood Unit</i> B. F. Ray Federal NCT-2		Well No. 2 37
Unit Letter E	Section 10	Township 25 South	Range 32 East	County Lea
Actual Footage Location of Well: 1980' feet from the North line and 660' feet from the West line Sec. 10				
Ground Level Elev. 3460'	Producing Formation Delaware Sand	Pool Undesignated	Dedicated Acreage: 40 Acres	

1. Is the Operator the only owner in the dedicated acreage outlined on the plat below? YES NO . ("Owner" means the person who has the right to drill into and to produce from any pool and to appropriate the production either for himself or for himself and another. (65-3-29 (e) NMSA 1935 Comp.)
2. If the answer to question one is "no," have the interests of all the owners been consolidated by communitization agreement or otherwise? YES NO . If answer is "yes," Type of Consolidation _____
3. If the answer to question two is "no," list all the owners and their respective interests below:

Owner	Land Description

SECTION B

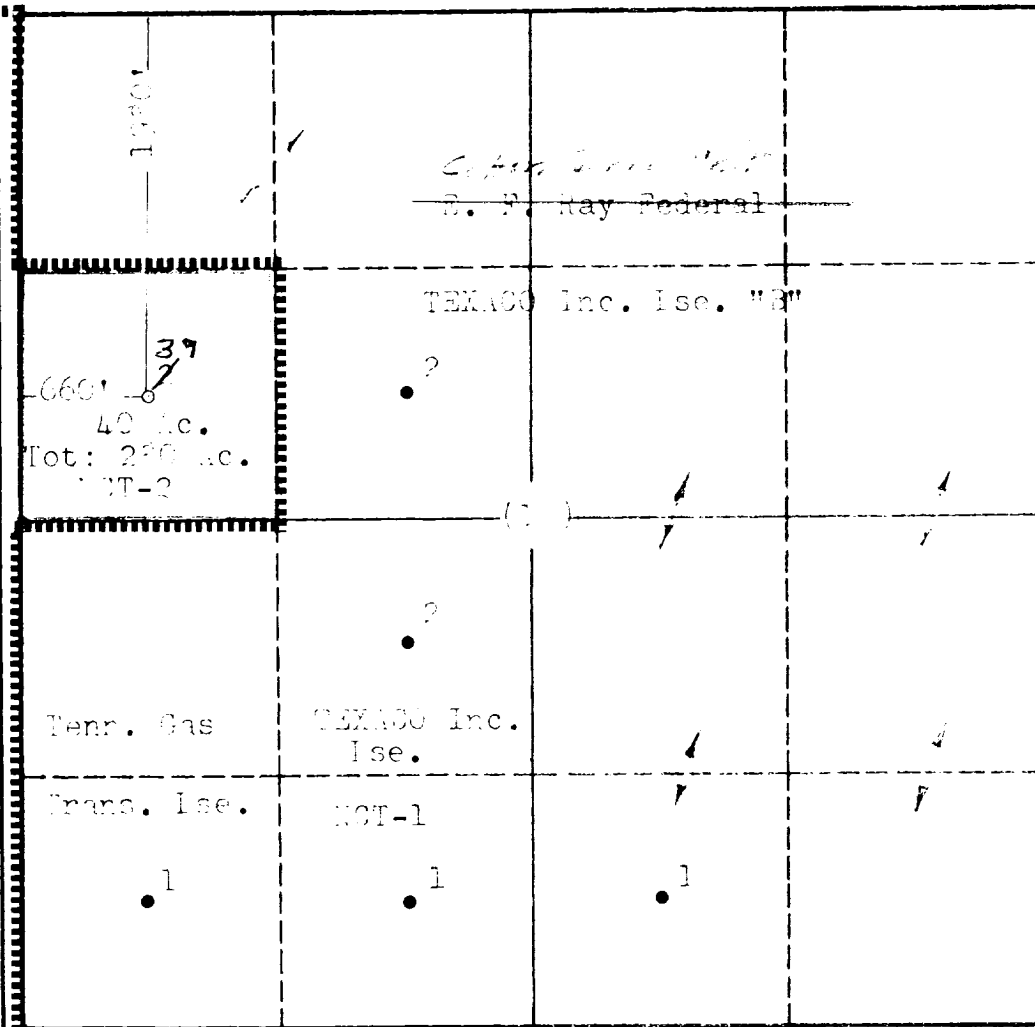

CERTIFICATION

I hereby certify that the information in SECTION A above is true and complete to the best of my knowledge and belief.

Name J. J. Velten
Position Division Civil Engineer
Company TEXACO Inc.
Date 3-3-61

I hereby certify that the well location shown on the plat in SECTION B was plotted from field notes of actual surveys made by me or under my supervision, and that the same is true and correct to the best of my knowledge and belief.

Date Surveyed 3-3-61
Registered Professional Engineer and/or Land Surveyor J. J. Velten
Certificate No. 8174

0 330 660 990 1320 1650 1980 2310 2640 2000 1500 1000 500 0