

COPY TO G.O.C.
HOBBS

Budget Bureau No. 42-R358.4.
Approval expires 12-31-60.

(SUBMIT IN TRIPLICATE)

UNITED STATES
DEPARTMENT OF THE INTERIOR
GEOLOGICAL SURVEY

Land Office

Lease No. **LC-061936**

Unit

SUNDRY NOTICES AND REPORTS ON WELLS

NOTICE OF INTENTION TO DRILL	<input checked="" type="checkbox"/> SUBSEQUENT REPORT OF WATER SHUT-OFF
NOTICE OF INTENTION TO CHANGE PLANS	SUBSEQUENT REPORT OF SHOOTING OR ACIDIZING
NOTICE OF INTENTION TO TEST WATER SHUT-OFF	SUBSEQUENT REPORT OF ALTERING CASING
NOTICE OF INTENTION TO RE-DRILL OR REPAIR WELL	SUBSEQUENT REPORT OF RE-DRILLING OR REPAIR
NOTICE OF INTENTION TO SHOOT OR ACIDIZE	SUBSEQUENT REPORT OF ABANDONMENT
NOTICE OF INTENTION TO PULL OR ALTER CASING	SUPPLEMENTARY WELL HISTORY
NOTICE OF INTENTION TO ABANDON WELL	

(INDICATE ABOVE BY CHECK MARK NATURE OF REPORT, NOTICE, OR OTHER DATA)

Lease No. **136457** **THIS WELL IS IN THE COTTON DRAW UNIT**
E. P. Ray Federal "B" **March 3**, 19 **61**

Well No. **X 40** is located **600** ft. from **[N]** line and **1000** ft. from **[E]** line of sec. **10**

NE/4 NW/4 Sec. 10

T-25-S

R-32-E

NADN

(Twp. and Sec. No.)

(Twp.)

(Range)

(Meridian)

Undesignated

Lee

New Mexico

(Field)

(County or Subdivision)

(State or Territory)

The elevation of the derrick floor above sea level is **3478** ft.

DETAILS OF WORK

(State names of and expected depths to objective sands; show sizes, weights, and lengths of proposed casings; indicate mudding jobs, cementing points, and all other important proposed work)

OBJECTIVE FORMATIONS		SIZE CASING			CASING PROGRAM (APPROX.)	
					Set at	Cement
Top of Anhydrite	763'	7-5/8"	24#	New	350'	250 sx.
" " Salt	1138'	2-7/8"	6.4#	New	4790'	200 sx.
" " Lassar Lime	4646'					
" " Dela. Sand	4673'					
Total Depth	4790'					

I understand that this plan of work must receive approval in writing by the Geological Survey before operations may be commenced.

Company **TEXACO Inc.**
P. O. Box 3109
Address **Midland, Texas**

TEXACO Inc.
By **J. J. Velten**
Title **Division Civil Engineer**

NEW MEXICO OIL CONSERVATION COMMISSION
WELL LOCATION AND ACREAGE DEDICATION PLAT

FORM C-128
 Revised 5/1/57

SEE INSTRUCTIONS FOR COMPLETING THIS FORM ON THE REVERSE SIDE

SECTION A

Operator TEXACO Inc.		Lease Cotton Branch Unit E. F. Ray Federal "B"		Well No. X 40
Unit Letter C	Section 10	Township 25 South	Range 32 East	County Lea
Actual Footage Location of Well: 660 feet from the North line and 1980 feet from the West line Sec. 10				
Ground Level Elev. 3467	Producing Formation Delaware Sand	Pool Undersaturated	Dedicated Acreage: 40 Acres	

1. Is the Operator the only owner in the dedicated acreage outlined on the plat below? YES ☒ NO ____ . ("Owner" means the person who has the right to drill into and to produce from any pool and to appropriate the production either for himself or for himself and another. (65-3-29 (e) NMSA 1935 Comp.)
2. If the answer to question one is "no," have the interests of all the owners been consolidated by communitization agreement or otherwise? YES ____ NO ____ . If answer is "yes," Type of Consolidation _____
3. If the answer to question two is "no," list all the owners and their respective interests below:

Owner	Land Description
	1061
	HOBBS, NEW MEXICO

SECTION B

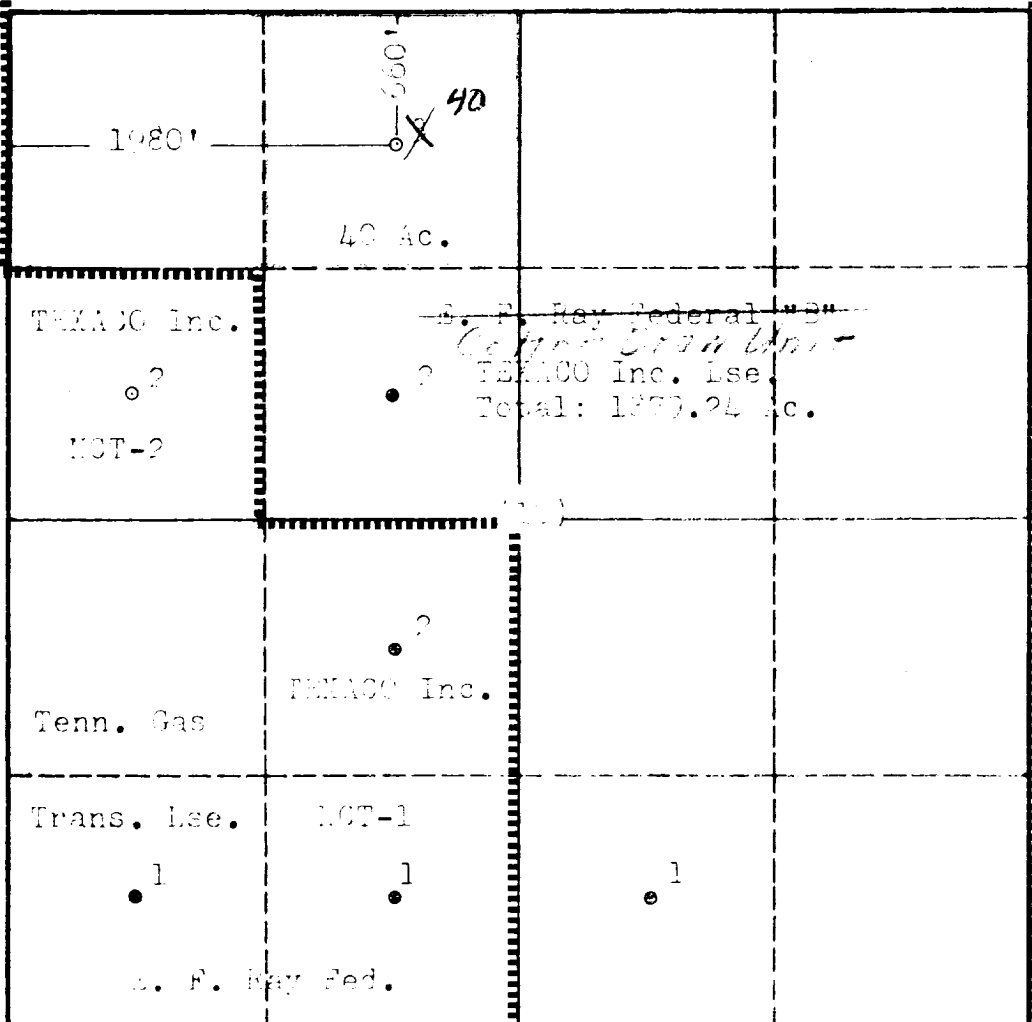

CERTIFICATION

I hereby certify that the information in SECTION A above is true and complete to the best of my knowledge and belief.

Name J. J. Velten
Position Division Civil Engineer
Company TEXACO Inc.
Date 5-2-61

I hereby certify that the well location shown on the plat in SECTION B was plotted from field notes of actual surveys made by me or under my supervision, and that the same is true and correct to the best of my knowledge and belief.

Date Surveyed 5-2-61
Registered Professional Engineer and/or Land Surveyor J. J. Velten
Certificate No. 8174