

APPROVED

COPY TO O. C. C.

Budget Bureau No. 42-R358.4.
Approval expires 12-31-60.Form 9-331a
(Feb. 1951)

DEC 12 1960

HOBBS

(SUBMIT IN TRIPLICATE)

Land Office

Lease No. **10-062300**

Unit

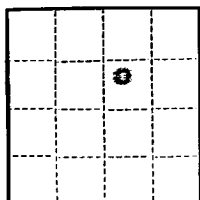
E. W. STANDLEY
DISTRICT ENGINEERUNITED STATES
DEPARTMENT OF THE INTERIOR
GEOLOGICAL SURVEY

DEC 12 1960

U. S. GEOLOGICAL SURVEY

HOBBS, NEW MEXICO

SUNDRY NOTICES AND REPORTS ON WELLS

NOTICE OF INTENTION TO DRILL	XX	SUBSEQUENT REPORT OF WATER SHUT-OFF
NOTICE OF INTENTION TO CHANGE PLANS		SUBSEQUENT REPORT OF SHOOTING OR ACIDIZING
NOTICE OF INTENTION TO TEST WATER SHUT-OFF		SUBSEQUENT REPORT OF ALTERING CASING
NOTICE OF INTENTION TO RE-DRILL OR REPAIR WELL		SUBSEQUENT REPORT OF RE-DRILLING OR REPAIR
NOTICE OF INTENTION TO SHOOT OR ACIDIZE		SUBSEQUENT REPORT OF ABANDONMENT
NOTICE OF INTENTION TO PULL OR ALTER CASING		SUPPLEMENTARY WELL HISTORY
NOTICE OF INTENTION TO ABANDON WELL		

(INDICATE ABOVE BY CHECK MARK NATURE OF REPORT, NOTICE, OR OTHER DATA)

Lease No. **186466**
G. E. Jordan Federal NCT-1**THIS WELL IS IN THE COTTON DRAW UNIT**

December 8, 1960

Well No. **6** is located **1980** ft. from **N** line and **1980** ft. from **E** line of sec. **15**SW/4 NE/4 Sec. **15** T-25-S R-32-E N.M.P.M.

(1/4 Sec. and 1/4 Sec. No.)

(Twp.)

(Range)

(Meridian)

Undesignated
Delaware Sand

Lee

New Mexico

(Field)

(County or Subdivision)

(State or Territory)

The elevation of the derrick floor above sea level is **Not**
Avail ft.

DETAILS OF WORK

(State names of and expected depths to objective sands; show sizes, weights, and lengths of proposed casings; indicate mudding jobs, cementing points, and all other important proposed work)

OBJECTIVE FORMATIONS:

Top of Anhydrite	803
Salt	1198
Base of Salt	4428
Top Delaware Lime	4658
Top of Delaware Sand	4683
Total Depth	4790

SIZE CASING

7 5/8"	24#	New
4 1/2"	9.5#	New

CASING PROGRAM (Approx.)

Set at	Cement
350'	300' ex
4790'	150' ex 4% gel.

I understand that this plan of work must receive approval in writing by the Geological Survey before operations may be commenced.

Company **TEXACO Inc.****TEXACO Inc.**Address **P. O. Box 3109****Midland, Texas**

By

J. J. Velten

Title **Division Civil Engineer**

NEW MEXICO OIL CONSERVATION COMMISSION
WELL LOCATION AND ACREAGE DEDICATION PLAT

FORM C-128
Revised 5/1/57

SEE INSTRUCTIONS FOR COMPLETING THIS FORM ON THE REVERSE SIDE

SECTION A

Operator TEXACO Inc.		Lease G. E. Jordan Federal NCT-1		Well No. 6
Unit Letter G	Section 15	Township 25 South	Range 32 East	County Lea
Actual Footage Location of Well: 1980 feet from the North line and 1980 feet from the East line Sec. 15				
Ground Level Elev.	Producing Formation Delaware Sand	Pool Undesignated	Dedicated Acreage: 40 Acres	

1. Is the Operator the only owner in the dedicated acreage outlined on the plat below? YES ☒ NO ☐ . ("Owner" means the person who has the right to drill into and to produce from any pool and to appropriate the production either for himself or for himself and another. (65-3-29 (e) NMSA 1935 Comp.)
2. If the answer to question one is "no," have the interests of all the owners been consolidated by communitization agreement or otherwise? YES ☐ NO ☐ . If answer is "yes," Type of Consolidation _____
3. If the answer to question two is "no," list all the owners and their respective interests below:

Owner	Land Description
	DEC 12 1960 G. E. JORDAN FEDERAL

○-S Marker

SECTION B

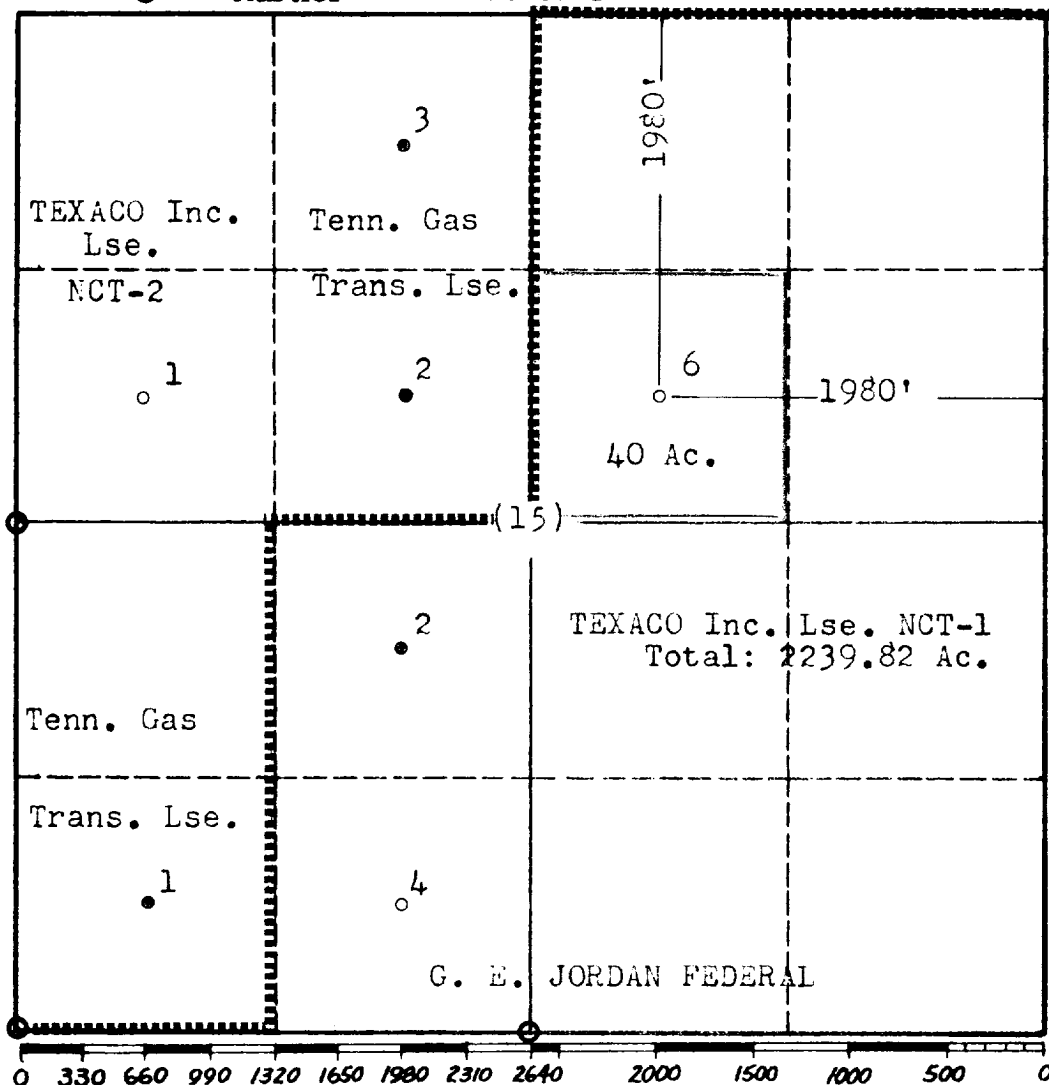

CERTIFICATION

I hereby certify that the information in SECTION A above is true and complete to the best of my knowledge and belief.

Name
J. J. Velten
Position
Division Civil Engineer
Company
TEXACO Inc.
Date
12-8-60

I hereby certify that the well location shown on the plat in SECTION B was plotted from field notes of actual surveys made by me or under my supervision, and that the same is true and correct to the best of my knowledge and belief.

Date Surveyed
12-8-60
Registered Professional Engineer
and/or Land Surveyor
J. J. Velten
Certificate No.
8174